

# DOUBLE HUNG BAYS

30° Bay Center Picture

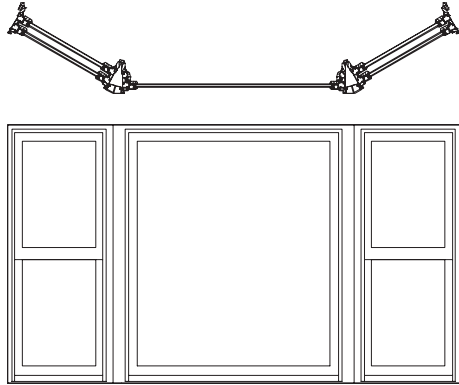

30° Bay Center Operator

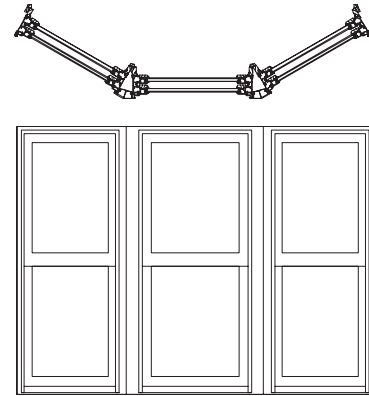

CN Width	RO Width		Projection	
	Inches	(mm)	Inches	(mm)
22-22-22	64 27/64	(1636)	11 3/8	(289)
22-26-22	68 27/64	(1738)	11 3/8	(289)
22-30-22	72 27/64	(1839)	11 3/8	(289)
22-32-22	74 27/64	(1890)	11 3/8	(289)
22-34-22	76 27/64	(1941)	11 3/8	(289)
22-36-22	78 27/64	(1992)	11 3/8	(289)
22-38-22	80 27/64	(2043)	11 3/8	(289)
22-42-22	84 27/64	(2144)	11 3/8	(289)
22-48-22	90 27/64	(2297)	11 3/8	(289)
22-50-22	92 27/64	(2347)	11 3/8	(289)
22-54-22	96 27/64	(2449)	11 3/8	(289)
22-62-22	104 27/64	(2652)	11 3/8	(289)
26-22-26	71 11/32	(1812)	13 3/8	(340)
26-26-26	75 11/32	(1914)	13 3/8	(340)
26-30-26	79 11/32	(2015)	13 3/8	(340)
26-32-26	81 11/32	(2066)	13 3/8	(340)
26-34-26	83 11/32	(2117)	13 3/8	(340)
26-36-26	85 11/32	(2168)	13 3/8	(340)
26-38-26	87 11/32	(2219)	13 3/8	(340)
26-42-26	91 11/32	(2320)	13 3/8	(340)
26-48-26	97 11/32	(2473)	13 3/8	(340)
26-50-26	99 11/32	(2523)	13 3/8	(340)
26-54-26	103 11/32	(2625)	13 3/8	(340)
26-62-26	111 11/32	(2828)	13 3/8	(340)
30-22-30	78 9/32	(1988)	15 3/8	(391)
30-26-30	82 9/32	(2090)	15 3/8	(391)
30-30-30	86 9/32	(2191)	15 3/8	(391)
30-32-30	88 9/32	(2242)	15 3/8	(391)
30-34-30	90 9/32	(2293)	15 3/8	(391)
30-36-30	92 9/32	(2344)	15 3/8	(391)
30-38-30	94 9/32	(2395)	15 3/8	(391)
30-42-30	98 9/32	(2496)	15 3/8	(391)
30-48-30	104 9/32	(2649)	15 3/8	(391)
30-50-30	106 9/32	(2699)	15 3/8	(391)
30-54-30	110 9/32	(2801)	15 3/8	(391)

CN Width	RO Width		Projection	
	Inches	(mm)	Inches	(mm)
32-22-32	81 3/8	(2067)	16 3/8	(416)
32-26-32	85 3/8	(2169)	16 3/8	(416)
32-30-32	89 3/8	(2270)	16 3/8	(416)
32-32-32	91 47/64	(2330)	16 3/8	(416)
32-34-32	93 47/64	(2381)	16 3/8	(416)
32-36-32	95 47/64	(2432)	16 3/8	(416)
32-38-32	97 47/64	(2483)	16 3/8	(416)
32-42-32	101 47/64	(2584)	16 3/8	(416)
32-48-32	107 47/64	(2737)	16 3/8	(416)
32-50-32	109 47/64	(2787)	16 3/8	(416)
34-22-34	85 13/64	(2164)	17 3/8	(441)
34-26-34	89 13/64	(2266)	17 3/8	(441)
34-30-34	93 13/64	(2367)	17 3/8	(441)
34-32-34	95 13/64	(2418)	17 3/8	(441)
34-34-34	97 13/64	(2469)	17 3/8	(441)
34-36-34	99 13/64	(2520)	17 3/8	(441)
34-38-34	101 13/64	(2571)	17 3/8	(441)
34-42-34	105 13/64	(2672)	17 3/8	(441)
34-48-34	111 13/64	(2825)	17 3/8	(441)
34-50-34	113 13/64	(2875)	17 3/8	(441)
36-22-36	88 43/64	(2252)	18 3/8	(467)
36-26-36	92 43/64	(2354)	18 3/8	(467)
36-30-36	96 43/64	(2455)	18 3/8	(467)
36-32-36	98 43/64	(2506)	18 3/8	(467)
36-34-36	100 43/64	(2557)	18 3/8	(467)
36-36-36	102 43/64	(2608)	18 3/8	(467)
36-38-36	104 43/64	(2659)	18 3/8	(467)
36-42-36	108 43/64	(2760)	18 3/8	(467)
38-22-38	92 1/8	(2340)	19 3/8	(492)
38-26-38	96 1/8	(2442)	19 3/8	(492)
38-30-38	100 1/8	(2543)	19 3/8	(492)
38-32-38	102 1/8	(2594)	19 3/8	(492)
38-34-38	104 1/8	(2645)	19 3/8	(492)
38-36-38	106 1/8	(2696)	19 3/8	(492)
38-38-38	108 1/8	(2747)	19 3/8	(492)
38-42-38	112 1/8	(2848)	19 3/8	(492)
42-22-42	99 1/16	(2516)	21 3/8	(543)
42-26-42	103 1/16	(2618)	21 3/8	(543)
42-30-42	107 1/16	(2719)	21 3/8	(543)
42-32-42	109 1/16	(2770)	21 3/8	(543)
42-34-42	111 1/16	(2821)	21 3/8	(543)
42-36-42	113 1/16	(2872)	21 3/8	(543)
42-38-42	115 1/16	(2923)	21 3/8	(543)

Details and Elevations not to scale.

For rough opening height of a Bay, add 1 7/16" to the Double Hung rough opening height.

\* Not available with 6 9/16" (167 mm) or 6 13/16" (173 mm) jambs.

## Construction Details

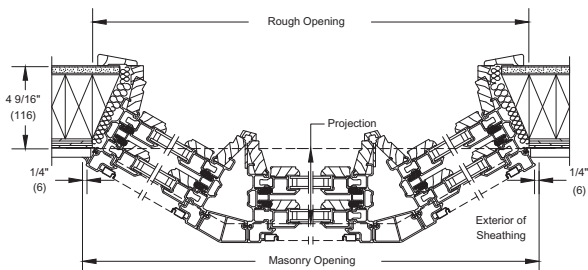

30° Bay with Center Picture Unit Jamb

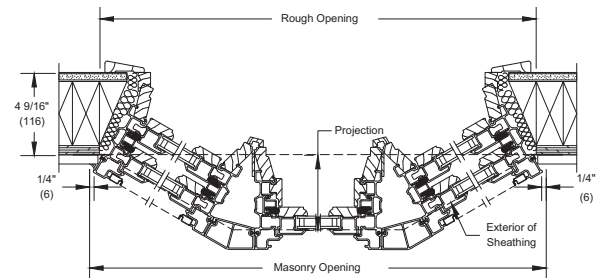

30° Bay with Operator Center Unit Jamb

MARVIN ELEVATE™ COLLECTION  
**DOUBLE HUNG BAYS**

45° Bay Center Picture

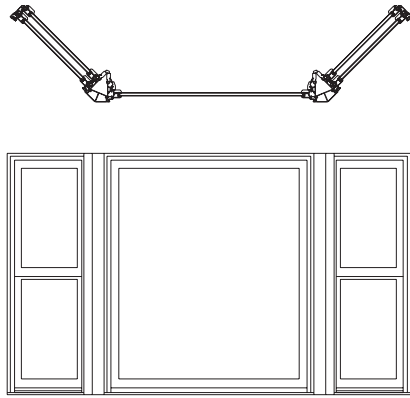

45° Bay Center Operator

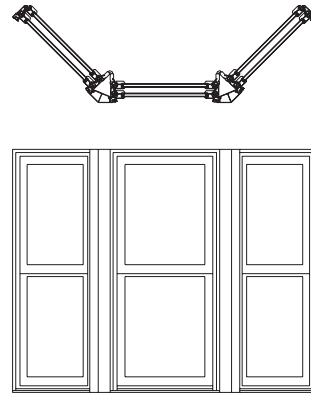

CN Width	RO Width		Projection	
	Inches	(mm)	Inches	(mm)
22-22-22	59 29/64	(1510)	16 9/16	(421)
22-26-22	63 29/64	(1612)	16 9/16	(421)
22-30-22	67 29/64	(1713)	16 9/16	(421)
22-32-22	69 29/64	(1764)	16 9/16	(421)
22-34-22	71 29/64	(1815)	16 9/16	(421)
22-36-22	73 29/64	(1866)	16 9/16	(421)
22-38-22	75 29/64	(1917)	16 9/16	(421)
22-42-22	79 29/64	(2018)	16 9/16	(421)
22-48-22	85 29/64	(2171)	16 9/16	(421)
22-50-22	87 29/64	(2221)	16 9/16	(421)
22-54-22	91 29/64	(2323)	16 9/16	(421)
22-62-22	99 29/64	(2526)	16 9/16	(421)
26-22-26	65 7/64	(1654)	19 25/64	(492)
26-26-26	69 7/64	(1755)	19 25/64	(492)
26-30-26	73 7/64	(1857)	19 25/64	(492)
26-32-26	75 7/64	(1908)	19 25/64	(492)
26-34-26	77 7/64	(1959)	19 25/64	(492)
26-36-26	79 7/64	(2009)	19 25/64	(492)
26-38-26	81 7/64	(2060)	19 25/64	(492)
26-42-26	85 7/64	(2162)	19 25/64	(492)
26-48-26	91 7/64	(2314)	19 25/64	(492)
26-50-26	93 7/64	(2365)	19 25/64	(492)
26-54-26	97 7/64	(2467)	19 25/64	(492)
26-62-26	105 7/64	(2670)	19 25/64	(492)

CN Width	RO Width		Projection	
	Inches	(mm)	Inches	(mm)
30-22-30	70 49/64	(1797)	22 7/32	(564)
30-26-30	74 49/64	(1899)	22 7/32	(564)
30-30-30	78 49/64	(2001)	22 7/32	(564)
30-32-30	80 49/64	(2051)	22 7/32	(564)
30-34-30	82 49/64	(2102)	22 7/32	(564)
30-36-30	84 49/64	(2153)	22 7/32	(564)
30-38-30	86 49/64	(2204)	22 7/32	(564)
30-42-30	90 49/64	(2305)	22 7/32	(564)
30-48-30	96 49/64	(2458)	22 7/32	(564)
30-50-30	98 49/64	(2509)	22 7/32	(564)
30-54-30	102 49/64	(2610)	22 7/32	(564)
30-62-30	110 49/64	(2813)	22 7/32	(564)

CN Height	RO Height	
	Inches	(mm)
24	25 11/16	(652)
36	37 11/16	(957)
40	41 11/16	(1059)
44	45 11/16	(1160)
48	49 11/16	(1262)
52	53 11/16	(1364)
56	57 11/16	(1465)
60	61 11/16	(1567)
64	65 11/16	(1668)
68	69 11/16	(1770)
72	73 11/16	(1872)
76	77 11/16	(1973)

Details and Elevations not to scale.

For rough opening height of a Bay, add 1 7/16" to the Double Hung rough opening height.

\* Not available with 6 9/16" (167 mm) or 6 13/16" (173 mm) jambs.

Note: When using Marvin Bays and Bows to replace products within existing openings, you will want to contact your local Marvin dealer for assistance and field verification of dimensions.

For further details and drawings visit the 'Tools and Documents' section at Marvin.com.

**Construction Details**

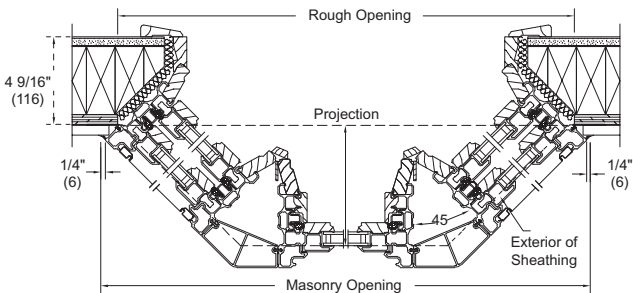

45° Bay with Stationary/Center Picture Unit Jamb

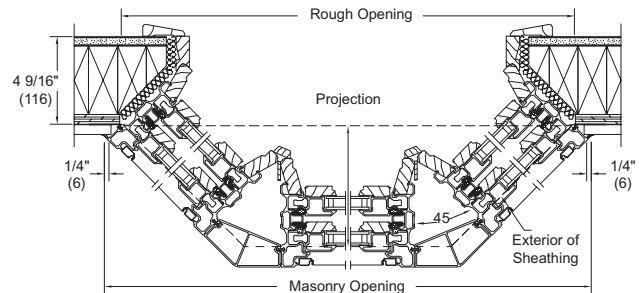

45° Bay with Center Operator Unit Jamb