

MARVIN ESSENTIAL™ COLLECTION  
**CASEMENT TRANSOM**

<b>MO (mm)</b>	1' - 6" (457)	2' - 0" (610)	2' - 6" (762)	3' - 0" (914)	3' - 6" (1067)	4' - 0" (1219)	5' - 0" (1524)	6' - 0" (1829)
<b>RO (mm)</b>	1' - 6" (457)	2' - 0" (610)	2' - 6" (762)	3' - 0" (914)	3' - 6" (1067)	4' - 0" (1219)	5' - 0" (1524)	6' - 0" (1829)
<b>FS (mm)</b>	1' - 5 1/2" (445)	1' - 11 1/2" (597)	2' - 5 1/2" (749)	2' - 11 1/2" (902)	3' - 5 1/2" (1054)	3' - 11 1/2" (1207)	4' - 11 1/2" (1511)	5' - 11 1/2" (1816)
<b>DLO (mm)</b>	11 53/64" (300)	17 53/64" (453)	23 53/64" (605)	29 53/64" (757)	35 53/64" (910)	41 53/64" (1062)	53 53/64" (1367)	65 53/64" (1672)

0' - 11 3/4" (298)								
1' - 0" (305)								
1' - 5 3/4" (451)								
1' - 6" (457)								
1' - 11 1/2" (292)								
1' - 5 1/2" (445)								
1' - 11 1/2" (587)								
17 53/64" (453)								

**Construction Details**

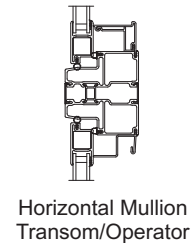
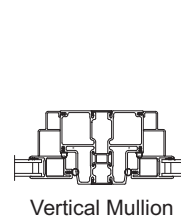
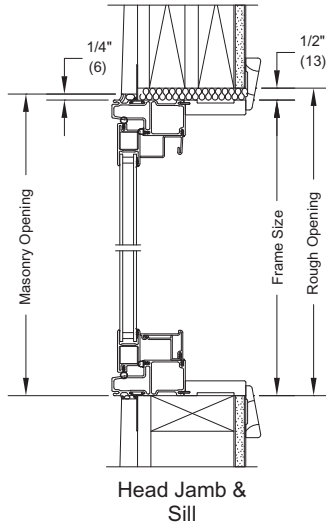
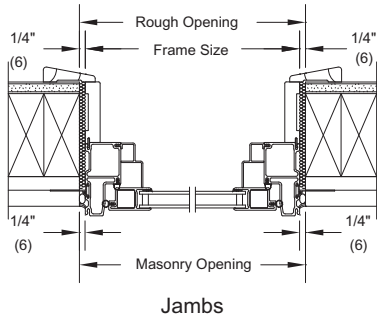

**MULTIPLE ASSEMBLIES**

Multiple assemblies can be factory mullied.

**MAXIMUM ROUGH OPENING** not to exceed 114" x 78".

Maximum up to 6 units wide by 1 unit high.

**MAXIMUM ROUGH OPENING** not to exceed 96" x 96".

Maximum up to 5 units wide by 5 units high.

Field mull kits are available. Structural mullion reinforcement is required for some assemblies.

Please consult your local Marvin representative for more information.