



Ultimate and Ultimate Wood Bow and Bay

Replacement Parts

Specifications and technical data are subject to change without notice.

Numbers listed in () parentheses are metric equivalents in millimeters rounded to the nearest whole number.

Suggested fasteners are not included and must be ordered separately.

Illustrations are not to scale.

Contents

Product History.....	2
Part Identification - Bow or Bay - Ultimate Casement.....	4
Part Identification - 45 Degree Bay - Ultimate Casement.....	5
Part Identification - 90 Degree Bay - Ultimate Casement	6
Part Identification - Bow - Ultimate Casement.....	7
Part Identification - Bow or Bay - Ultimate Casement Push Out	8
Part Identification - 45 Degree Bay - Ultimate Casement Push Out.....	9
Part Identification - 90 Degree Bay - Ultimate Casement Push Out.....	10
Part Identification - Bow - Ultimate Casement Push Out.....	11
Part Identification - Bow or Bay - Ultimate Wood Casement	12
Part Identification - 45 Degree Bay - Ultimate Wood Casement.....	13
Part Identification - 90 Degree Bay - Ultimate Wood Casement.....	14
Part Identification - Bow - Ultimate Wood Casement.....	15
Part ID - Bow or Bay - Ultimate Wood Casement Push Out.....	16
Part ID - 45 Degree Bay - Ultimate Wood Casement Push Out.....	17
Part ID - 90 Degree Bay - Ultimate Wood Casement Push Out.....	18
Part Identification - Bow - Ultimate Wood Casement Push Out.....	19
Part ID - Bay - Ultimate Wood Double Hung - Head Jamb and Sill	20
Part ID - Bay - Ultimate Wood Double Hung - Jamb Details.....	21
Aluminum Parts	22
Wood Parts.....	23
Head or Seat Boards	26
Miscellaneous Parts	27

Produced	Unit Type	Features and Changes
1962	Casement Bows	Introduced 4, 5 and 6 wide bow units with head and seat board.
1971	Wood Double Hung Bays	Introduced 30 and 45 degree bay units with head and seat board.
1974	Wood Casemaster Bows and Bays	Introduced 45 degree bay and 5 wide bow units with head and seat board.
1976	Wood Casemaster Bow	Added 4 and 6 wide bow units.
1978	Clad Casemaster Bows and Bay	Introduced 45 degree bay and 4, 5 and 6 wide bow units with head and seat board.
1979	Clad Double Hung Bay	Introduced 45 degree bay unit with head and seat board.
1981	Wood Casemaster and Double Hung Bay	Introduced 60 degree bay units with head and seat board.
1982	Wood Casemaster Bay	Introduced 30 and 90 degree bay units with head and seat board. The 90 degree bay features 1 7/8" top and side flat casing.
1983	Clad Double Hung and Clad Casemaster Bays	Introduced 30 degree bay units with head and seat board.
	Sun Bays	Unit featured a 90 degree bay configuration with polygon shaped operating flankers, 1" direct glazed center section and a 1" direct glazed sloped top. Unit was complete with seat board, lever operators, cam locks, butt hinges, 3" top flat casing and 1 1/2" side flat casing.
1987	Clad Casemaster Bay	Introduced 90 degree bay units with head and seat board.
1991	Wood 90 Degree Bent Glass Triangle Bay	Unit features 1" direct glazed bent glass, clear brick mould casing and clear sill. Head and seat board included.
1992	Sun Bays	Weather strip upgraded.
2003	Wood and Clad Casemaster Bow and Bay	03/31/03: Satin Taupe (TP) hardware replaces bronze as standard. New interior stops, Satin Taupe aluminum screens, optional wood surround screens are available. New screen location and fastening system. New one-piece clad sash extrusion.
	Wood and Clad Ultimate Double Hung	03/31/03: Satin Taupe (TP) hardware replaces bronze as standard.
	Wood and Clad Casemaster Bow and Bay	04/14/03: Newly designed Satin Taupe (TP) folding handle is standard.
2004	Wood and Clad Bow & Bay	01/2004: Added Oil Rubbed Bronze and Satin Chrome to available hardware finishes
2005	Wood and Clad Bow & Bay	02/2005: Added cable support system
2008	Clad Bow and Bay	01/26/2009: Added Wood Ultimate Casement and Ultimate and Ultimate Wood Push out.
2009	All	03/23/2009: Added LoE3-366 as a standard option for all products. Added Cedro Macho as a standard option for all clad products.
2011	All	04/25/2011: Added LoE-180 as a standard option for all products. White painted interior finish option introduced for all products
2012	All	12/17/2012: Clear interior finish option introduced for all products.
2016	All	04/29/2013: Introduced interior stain options. Stain colors are Wheat, Honey, Leather, Hazelnut, Cabernet and Espresso.
		10/31/2016: Obsolescence of the wood species Cedro Macho for all products.

Produced	Unit Type	Features and Changes
2017	All	10/30/2017: Energy panel colors discontinued with exception of bronze and stone white.

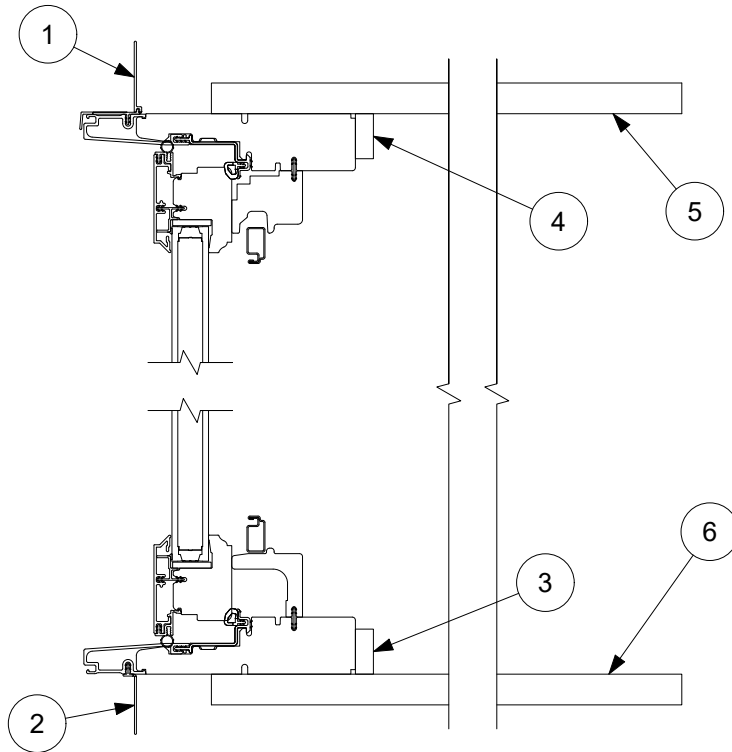

1. Hinged Vinyl Nail Fin with Drip Cap, V119
2. Hinged Sill Nail Fin, V112
3. Bottom Interior Trim, W6110
4. Top Interior Trim, W6110
5. Headboard
6. Seatboard

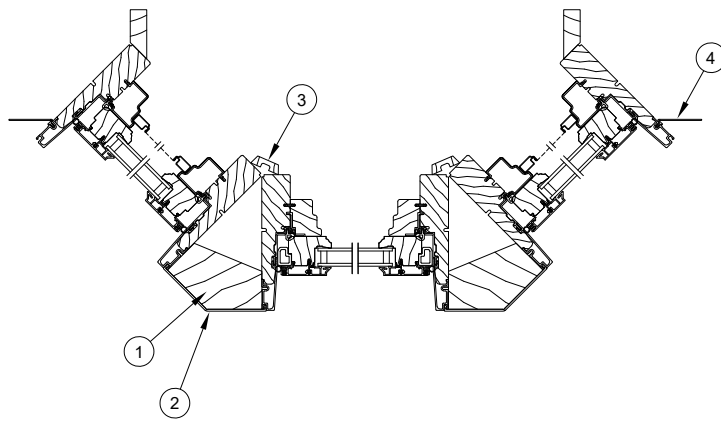

45 Degree Jamb Detail

1. Mull Block, W7310
2. Mull Cap, A123
3. Interior Trim, W1187
4. Hinged Jamb Nailing Fin, V112

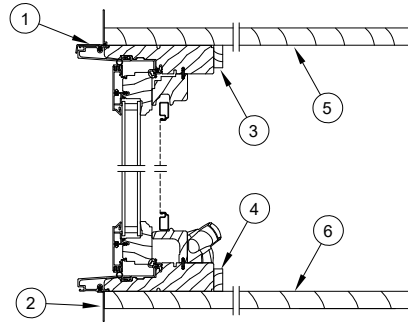

Head Jamb and Sill Detail

1. Interior Mull Trim, W1179
2. 3" Frame Expander, A109
3. 2" Mullion Expander, A108
4. Corner Cover 90 Degree Bay, A127
5. Hinged Jamb Nailing Fin, V112

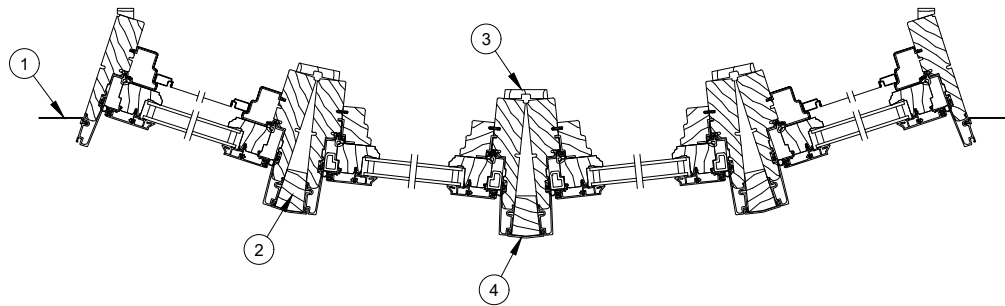

1. Hinged Jamb Nailing fin, V112
2. Mull Block, W7318
3. Interior Mull Trim, W1189
4. Mull Cap Bow, A124

Jamb Detail

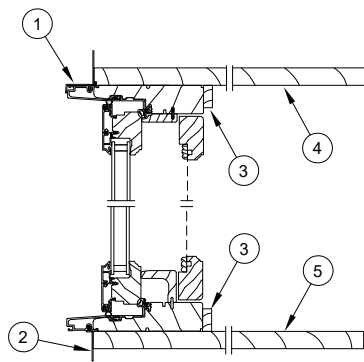

- 1. Hinged Jamb Nailing Fin/Drip Cap, V119
- 2. Hinged Sill Nailing Fin, V112
- 3. Top and Bottom Interior Trim, W6110
- 4. Headboard
- 5. Seatboard

Head Jamb
and Sill Detail

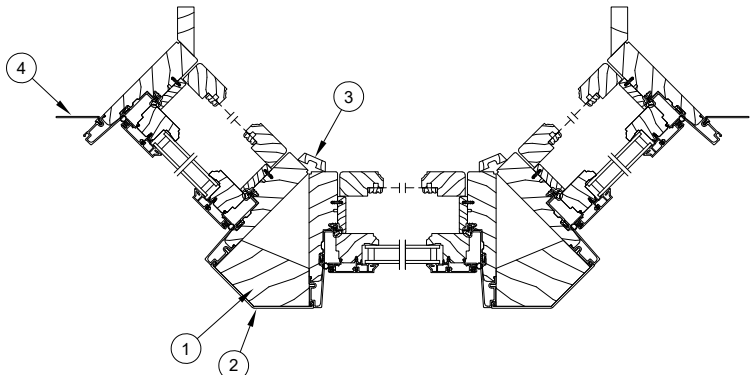

45 Degree Jamb Detail

- 1. Mull Block, W7310
- 2. Mull Cap, A123
- 3. Interior Mull Trim, W1187
- 4. Hinged Jamb Nailing Fin, V112

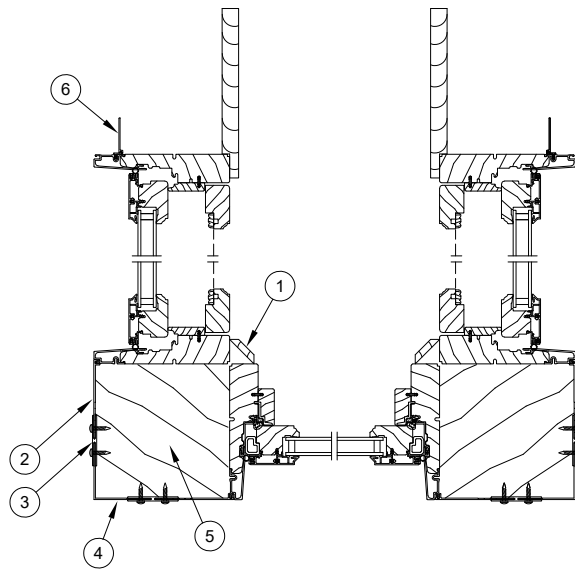

90 Degree Jamb Detail

- 1. Interior Mull Trim, W1179
- 2. 3" Frame Expander, A109
- 3. 2" Mullion Expander, A108
- 4. Corner Cover 90 Degree Bay, A127
- 5. Mull Block
- 6. Hinged Jamb Nailing Fin, V112

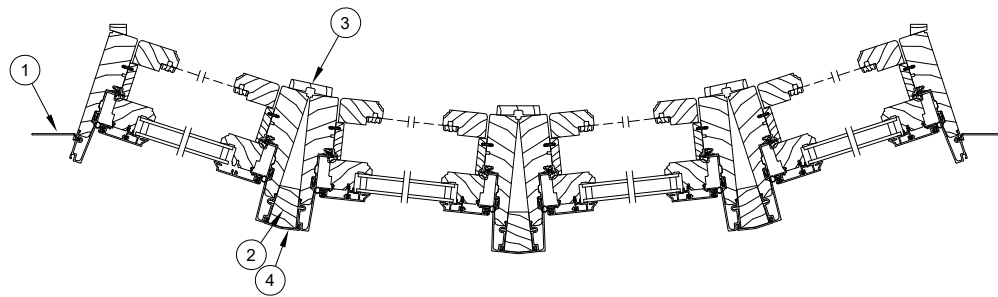

Jamb Detail

- 1. Head Jamb Nailing Fin/Drip Cap, V119
- 2. Mull Block, W7318
- 3. Interior Mull Trim, W1189
- 4. Mull Cap, A124

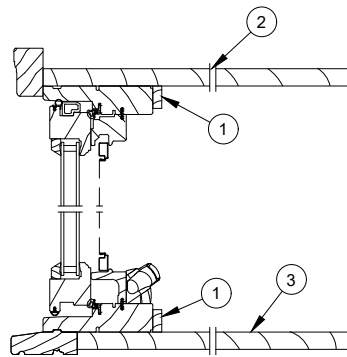

1. Head Jamb and Sill Stop, W6110
2. Headboard
3. Seatboard

Head Jamb And Sill Detail

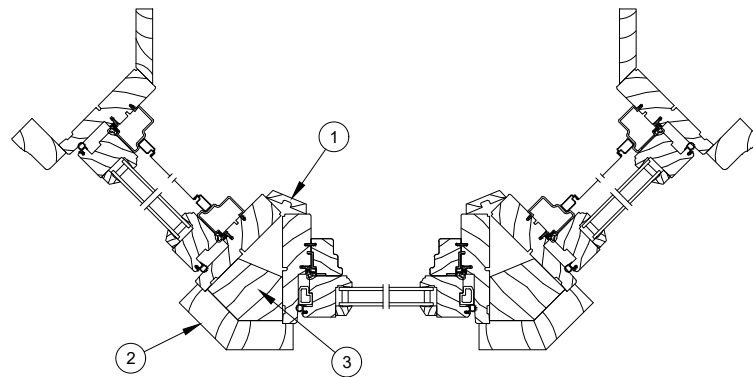

1. Interior Mull Trim, W1187
2. Exterior Mull Casing, W1104
3. Mull Block, W7310

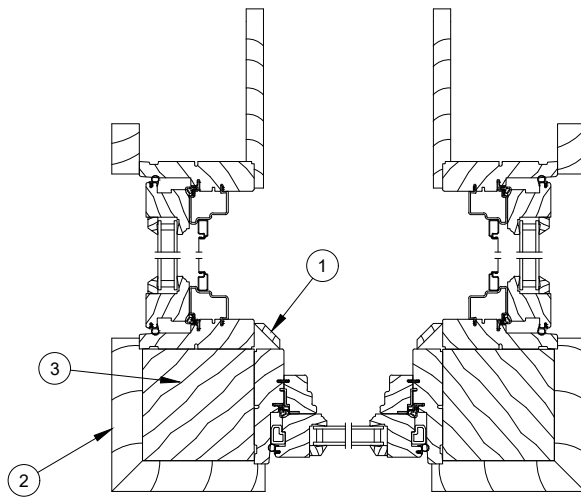

1. Interior Mull Trim, W1179
2. Exterior Mull Casing, W1108
3. Mull Block

Head Jamb And Sill Detail

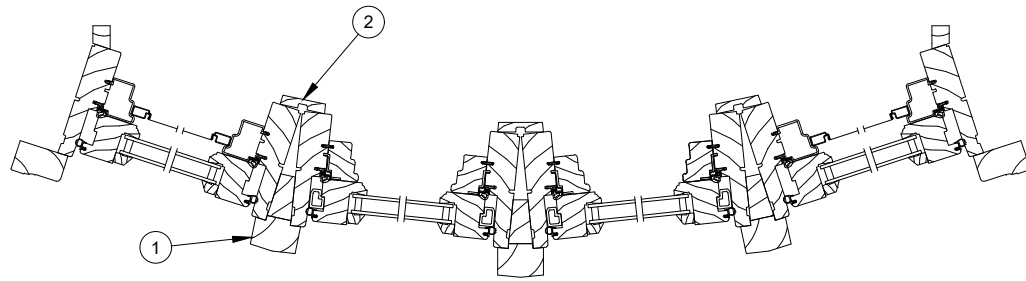

- 1. Exterior Mull Casing, W1132
- 2. Interior Mull Trim, W1189

Jamb Detail

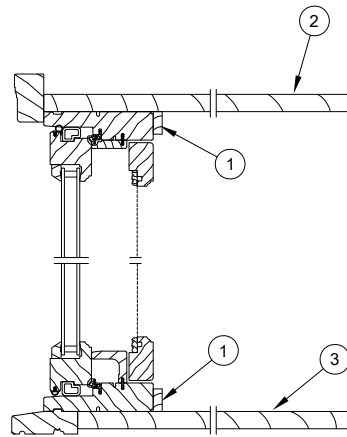

1. Interior Trim, W6110
2. Headboard
3. Seatboard

Head Jamb And Sill

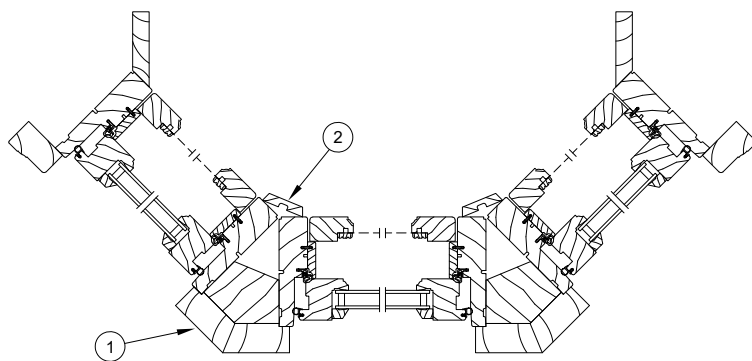

- 1. Exterior Mull Casing, W1104
- 2. Interior Mull Trim, W1187

Jamb Detail

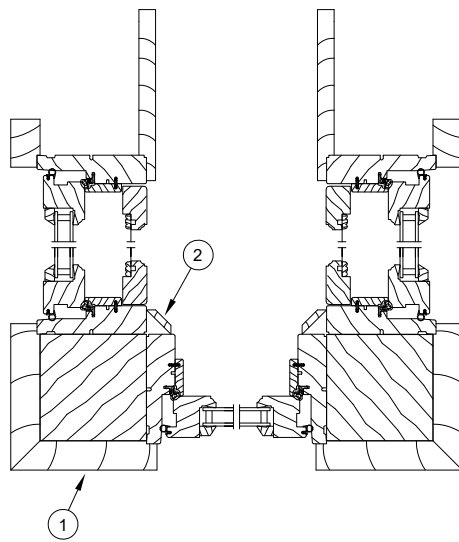

Jamb Detail

- 1. Exterior Mull Casing, W1108
- 2. Interior Mull Trim, W1179

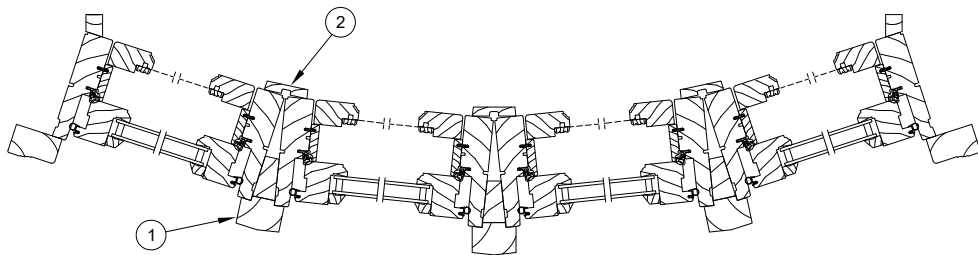

- 1. Exterior Mull Casing, W1132
- 2. Interior Mull Trim, W1189

Jamb Detail

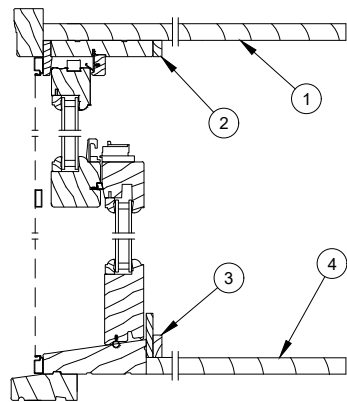

- 1. Headboard
- 2. Top Interior Trim, W1181
- 3. Bottom Interior Trim, W6110
- 4. Seatboard

Head Jamb And Sill

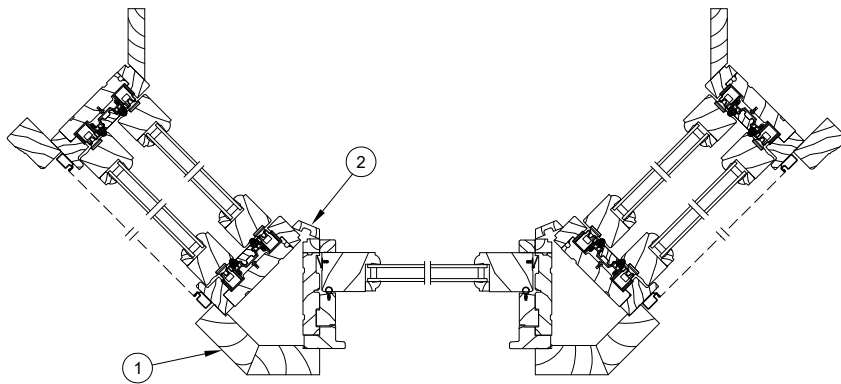

- 1. Exterior Mull Casing, W1112
- 2. Interior Trim, W1184

Jamb Detail

To order, specify:

1. Profile number
2. Finish

NOTE: Bows or Bays utilize many of the parts found in their respective Replacement Parts sections. Please refer to these for additional information.

NOTE: See Miscellaneous Mouldings section for available part numbers.

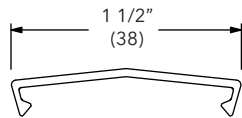

Mull Cap Bows, A124

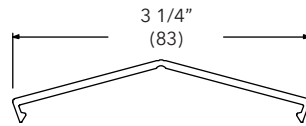

Mull Cap 30-degree Bays, A122

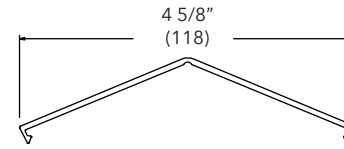

Mull Cap 45-degree Bays, A123

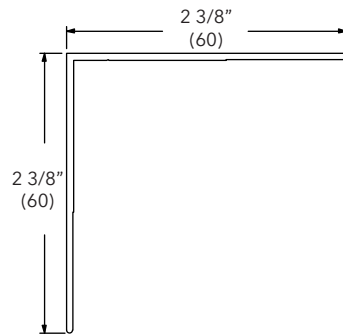

Corner Cover 90-degree Bays, A127

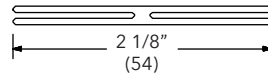

2" Mullion Expander, A108

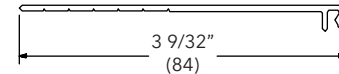

3" Frame Expander, A109

To order, specify:

1. Profile number
2. Size (call number or length)
3. Finish

NOTE: Some interior mull trims notched for cable as shown.

NOTE: Wood bay exterior mull casing is shipped as an assembled pair.

	Ultimate	Ultimate Wood
Interior Trim – UWDH/UDHDISC62915 Bay (bottom) UCA/UWCA Bow/Bay (top or bottom)	W6110	W6110
Interior Trim – UWDH/UDHDISC62915 Bay (top)	W1181	W1181
Interior Mull Trim – Bow –UCA & UDHDISC62915	W1189	W1189
Interior Mull Trim – 30 degree UCA/UWCA Bay	W1185	W1185
Interior Mull Trim – 45 degree UCA/UWCA Bay	W1187	W1187
Interior Mull Trim – 60 degree UCA/UWCA Bay		W1176
Interior Mull Trim – 90 degree UCA/UWCA Bay	W1179	W1179
Interior Mull Trim – 30 degree Bay UWDH/UDHDISC62915	W1182	W1182
Interior Mull Trim – 45 degree Bay UWDH/UDHDISC62915	W1184	W1184
Interior Mull Trim – 90 degree Bay UWDH/UDHDISC62915	W1178	W1178
Interior Mull Trim – 60 degree Bay – UWDH		W1177

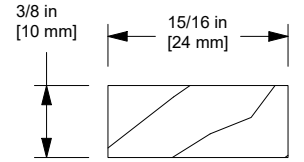

Interior Trim, W6110

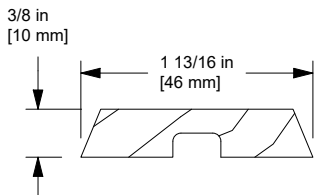

Interior Mull Trim, W1187

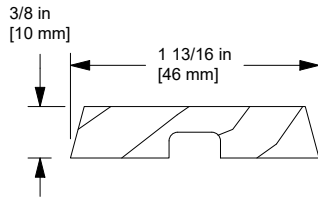

Interior Mull Trim, W1185

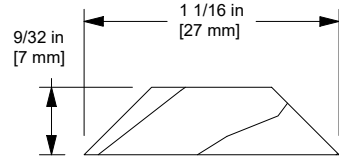

Interior Mull Trim, W1178

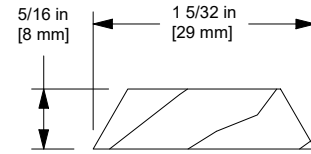

Interior Mull Trim, W1177

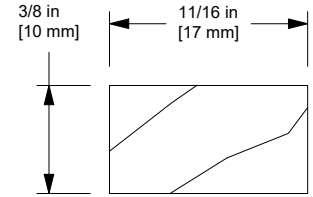

Interior Mull Trim, W1181

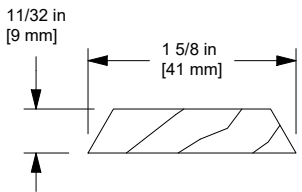

Interior Mull Trim, W1176

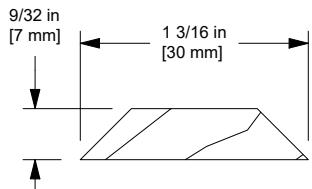

Interior Mull Trim, W1179

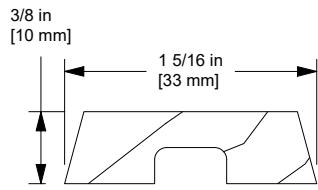

Interior Mull Trim, W1182

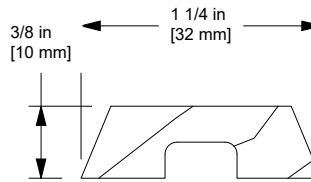

Interior Mull Trim, W1184

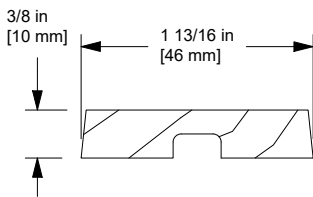

Interior Mull Trim, W1189

To order, specify:

1. Profile number
2. Size (call number or length)
3. Finish

NOTE: Some interior mull trims notched for cable as shown.

NOTE: Wood bay exterior mull casing is shipped as an assembled pair.

	Ultimate
Mull Block - UCA Bow	W7318
Mull Block - 30 degree Ultimate Bay	W7308
Mull Block - 45-degree Ultimate Bay	W7310

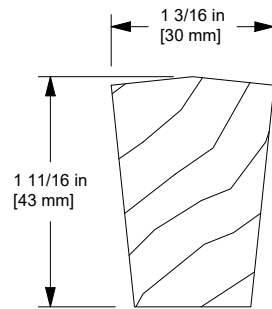

Mull Block, W7318

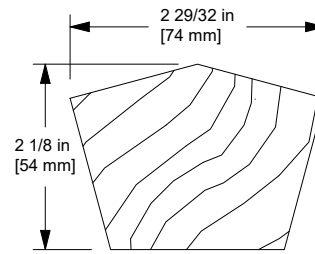

Mull Block, W7308

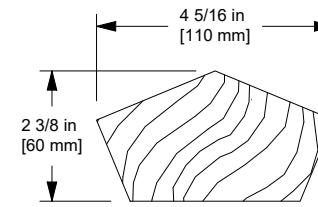

Mull Block, W7310

To order, specify:

1. Profile number
2. Size (call number or length)
3. Finish

NOTE: Some interior mull trims notched for cable as shown.

NOTE: Wood bay exterior mull casing is shipped as an assembled pair.

	Ultimate Wood
Exterior Mull Casing - UWCA Bow	W1132
Exterior Mull Casing – 30 degree UWCA Bay	W1102
Exterior Mull Casing – 45 degree UWCA Bay	W1104
Exterior Mull Casing – 60 degree UWCA Bay	W1106
Exterior Mull Casing – 90 degree UWCA Bay	W1108
Exterior Mull Casing – 30 degree UWDH Bay	W1110
Exterior Mull Casing – 45 degree UWDH Bay	W1112
Exterior Mull Casing – 60 degree UWDH Bay	W1114
Exterior Mull Casing – 90 degree UWDH Bay	W1116

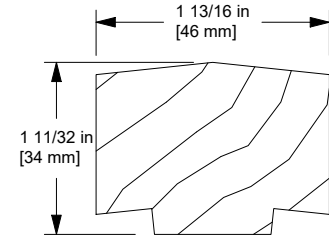

Exterior Mull Casing, W1132

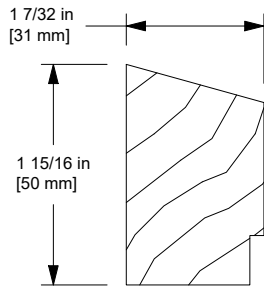

Exterior Mull Casing, W1102

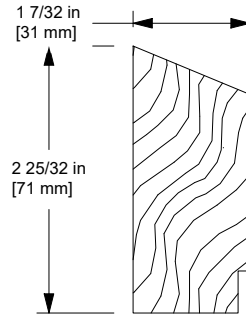

Exterior Mull Casing, W1104

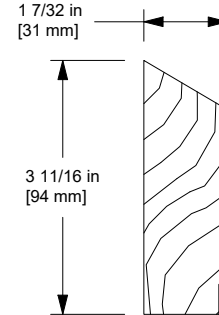

Exterior Mull Casing, W1106

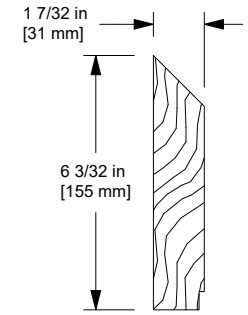

Exterior Mull Casing, W1108

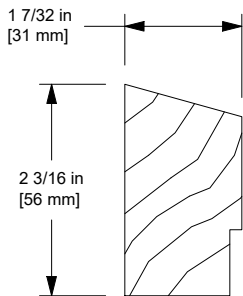

Exterior Mull Casing, W1110

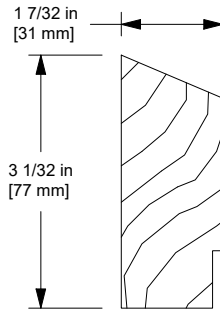

Exterior Mull Casing, W1112

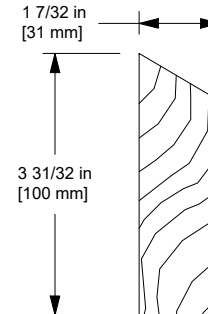

Exterior Mull Casing, W1114

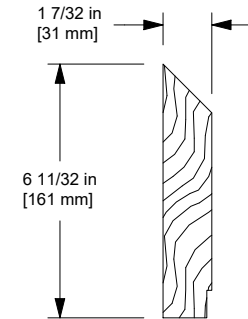

Exterior Mull Casing, W1116

Plywood Core/Non Finger-Jointed Veneer Head and Seat Board Availability Chart

NOTE: Part number is for one board only - must order two if needed for head and seat board.

NOTE: Replacement head and seat board material is rectangular in shape. For assistance in determining size required contact Marvin Technical Support with the unit type (bow/bay), finish (aluminum/wood), angle (30/45/90), unit size, projection and jamb depth.

Stock Size	PN
16 x 72	18218202
16 x 96	18218204
16 x 108	18218206
18 x 72	18218402
18 x 84	18218404
18 x 108	18218406
20 x 84	18218602
20 x 96	18218604
20 x 108	18218606
20 x 120	18218608
22 x 72	18218702
22 x 84	18218704
22 x 96	18218706
22 x 108	18218708
22 x 132	18218710

Stock Size	PN
24 x 72	18218902
24 x 84	18218904
24 x 96	18218906
24 x 120	18218910
24 x 132	18218912
24 x 144	18218914
26 x 84	18219002
26 x 108	18219004
27 x 120	18219104
28 x 96	18219202
28 x 108	18219204
30 x 108	18219302
30 x 132	18219304
30 x 144	18219306
42 x 168	18219510

Cable Support System - Field Installation Kit

Includes:

- 2 - Cable clamps 1/4" x 3 1/8" (zinc die-cast) - a
- 4 - Heave-shank mounting screws #12 x 3" - b
- 1 - #3 Phillips drive bit - c
- 2 - Adjustment hole plugs - d
- 2 - Cable assemblies - 9' or 12' x 1/8" diameter - e
- 2 - Fender washers - f
- 2 - T-nuts, 3 prong - g
- 4 - Heavy hex nuts - h
- 2 - Installation plates (Ultimate or Ultimate Wood Double Hung units only) - i
- 4 - #7 x 7/8" screws (Ultimate or Ultimate Wood Double Hung units only) - j

Unit	Length	PN
Casement	9 ft	11850134
	12 ft	11850135
Double Hung	9 ft	11850136
	12 ft	11850137

Bow/Bay Installation Plate Package

Ultimate or Ultimate Wood Double Hung units only

Includes:

- 2 - Installation plates- i
- 4 - #7 x 7/8" screws - j

PN
11850133

