

Please load correctly to access the standard sizes contained in the TXT file (From open project, Insert tab/Load Family). Refer to the Architectural Detail Manual document for a listing of standard sizes

Bi-fold Door Families: Panel Configuration

- The number of panels needed must be correct when the family is loaded but the configuration can be changed after the door is in your project
- Options are listed in Properties/Construction
- Please refer to the Configurations images at the end of this document *
- Example: When the ELBFLD19080-6P is loaded, the default configuration is Option 13 (3L3R). To change that to 6L0R, the Option Choice_Configuration parameter will need to be changed to 14

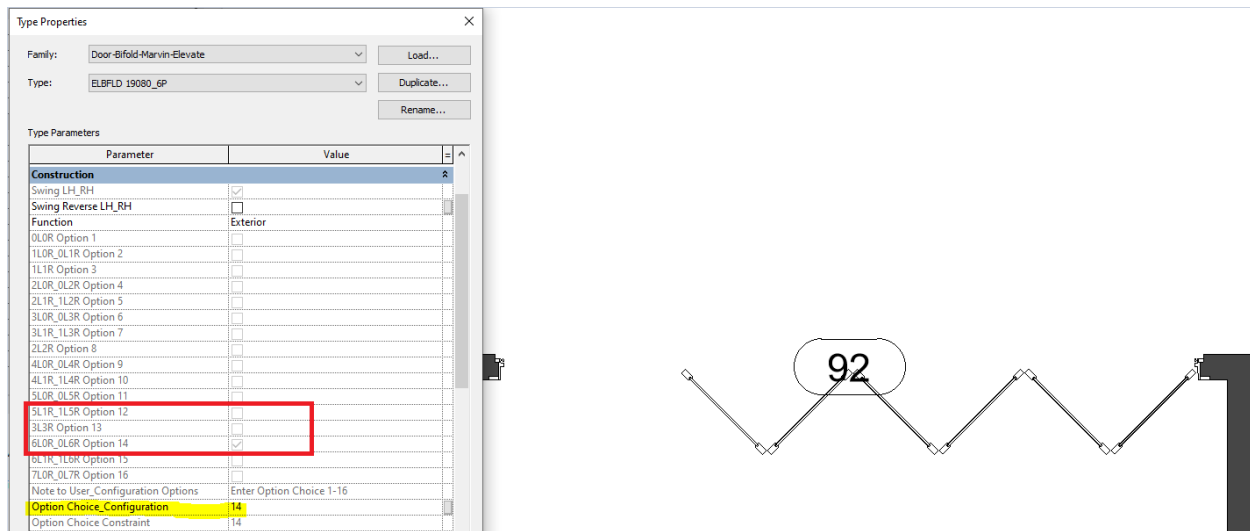

- If the unequal sided panels are opening the wrong direction, use the Swing Reverse LH_RH parameter

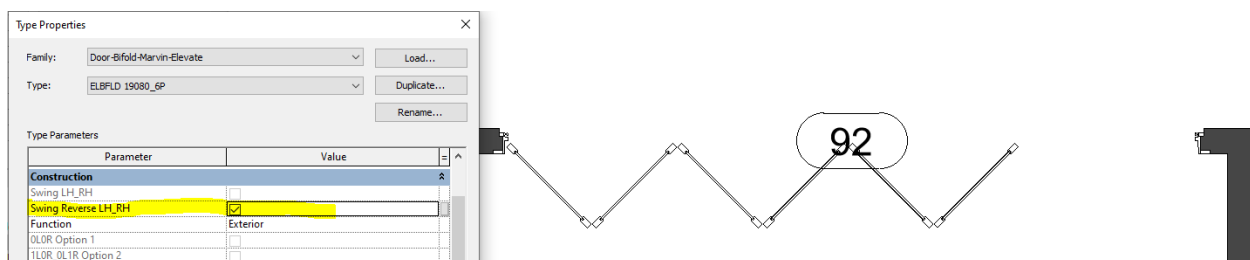

Bifold Door Families: Screen

- There are two interior retractable screen options: unidirectional and bi-parting
- Changes to the screen can be made in the Graphics portion of the Type Properties
- Uncheck the Screen Visibility parameter if no screen is needed
- If using the screen, please note the maximum allowable sizes of each screen listed in gray

Type Properties



Family: Door-Bifold-Marvin-Elevate

Load...

Type: ELBFLD 19080_6P

Duplicate...

Rename...

Type Parameters

Parameter	Value	=	^
Graphics			
Jamb Extension Visibility	<input type="checkbox"/>		
Elevation Swing Visibility	<input checked="" type="checkbox"/>		
Muntins Visibility	<input checked="" type="checkbox"/>		
Label Visibility	<input type="checkbox"/>		
Casing Visibility	<input checked="" type="checkbox"/>		
Note to User_Casing Options	Enter Option Choice Casings 1-3		
Option Choice Casings	3		
Option Choice Casings Constraint	3		
BMC Option 1	<input type="checkbox"/>		
Flat Casing Option 2	<input type="checkbox"/>		
Ranch Style Option 3	<input checked="" type="checkbox"/>		
Screen Visibility	<input checked="" type="checkbox"/>		
Screen Uni_Directional	<input type="checkbox"/>		
Screen Bi_Parting	<input checked="" type="checkbox"/>		
Screen Uni_Directional MaxWidth	14' 9"		
Screen Bi_Parting MaxWidth	26' 3"		
Screen MaxHeight	9' 10"		

Configurations

Uni-directional Left
or Right Units

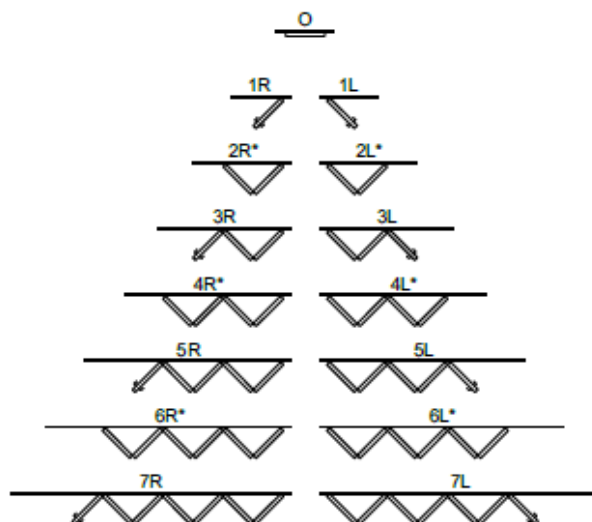

Uni-directional Left
or Right Units with
Operating Panel/s

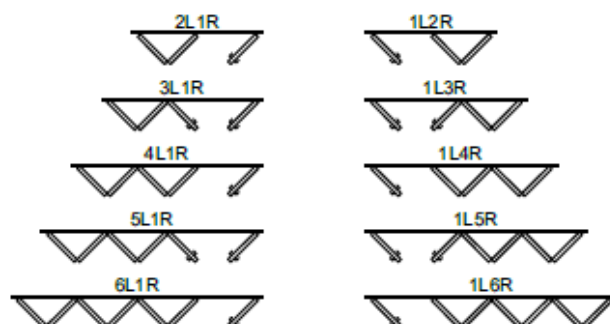

Bi-parting (equal)
Units

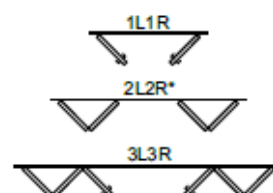

* Not accessible from the exterior.