



Modern MultiSlide Door

Replacement Parts

Specifications and technical data are subject to change without notice.

Numbers listed in () parentheses are metric equivalents in millimeters rounded to the nearest whole number.

Suggested fasteners are not included and must be ordered separately.

Illustrations are not to scale.

Contents

Product History.....	2
Part Identification - Pocket/Stacked Head Jamb and Sill Details	3
Part Identification - Stacked Jamb Details.....	4
Part Identification - Pocket Jamb Details.....	5
Replacement Panels and Sills	6
Installation Parts.....	7
Installation Kit Parts - Uni-Directional Stacked Kit.....	11
Installation Kit Parts - Uni-Directional Pocket Kit.....	12
Installation Kit Parts - Bi-Parting Stacked Kit.....	13
Installation Kit Parts - Bi-Parting Pocket Kit	14
Handles	15
Operators.....	16
Locking Hardware.....	17
Lock Status Sensor Parts.....	19
Automatic Control Parts	20
Automatic Control Parts - Locally Sourced.....	25
Miscellaneous Parts	26
Miscellaneous Parts - Discontinued No Availability (NA).....	33
Aluminum Parts	34
Aluminum Parts - Fabricated.....	36
Vinyl Parts.....	40
Vinyl Parts - Fabricated	42
Vinyl Parts - Discontinued No Availability (NA)	43
Weather Strip.....	44
Screen Handing Diagram.....	45
Retractable Screen SE4 Parts Configured Parts in OMS.....	46
Retractable Screen SE4 Parts.....	47
Scenic Door Sliding Screen Parts - Disc LA Pre 4/27/20	51

Produced	Unit Type	Features and Changes
2018	Modern MultiSlide Door	10/29/2018: Introduced the Modern MultiSlide Door.
2019	Modern MultiSlide Door	4/29/2019: Added Stone White Hardware, Exterior Jamb/Head Jamb cover F2065 was replaced with A3476.
2020	Modern MultiSlide Door	4/27/2020: Scenic Door Modern Sliding Screen transitions to the SE4 Retractable Screen.
2021	Modern MultiSlide Door	12/13/2021: A new Sliding Door Automatic Control (SDAC) system will be available on Ultimate and Modern multi-slide door products with the OMS version 3.12 on December 13, 2021. See Product Bulletin #805 for more information and Product Bulletin #837 for installation requirements.
2023	Modern MultiSlide Door	10/30/2023: An ERS coating became available as a standard option for current Triple Pane offerings. See Product Bulletin 904 for more details.
2024	Modern MultiSlide Door	2/26/2024: Additional 2-track configurations became available. See Product Bulletin 917 for additional information. Automated parts added to allow the MultiSlide door to integrate with the Marvin Connected Home app. See Product Bulletin 906 for additional information. 8/26/2024: The Scenic Retractable Screen is now available up to Nominal 12 ft height. See Product Bulletin 944 for more information.

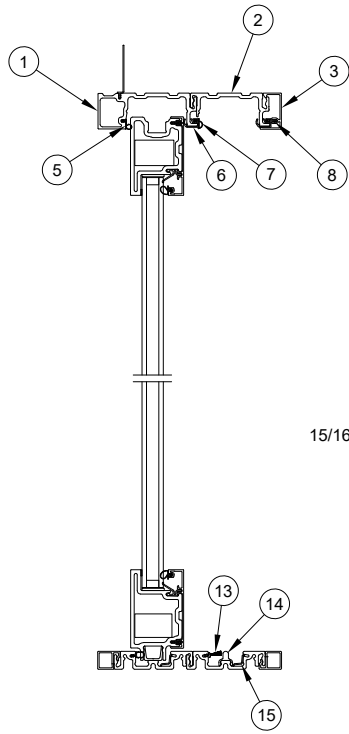

15/16" Glass

Stationary/Pocket Panel
Head Jamb and Sill

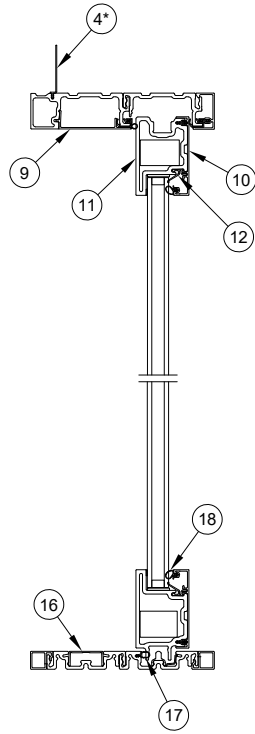

Primary/Inactive Panel
Head Jamb and Sill

1. Exterior Frame
2. Frame
3. Frame Liner, A3248
4. Nail Fin, V2920*
5. Frame Weather Strip, V2475
6. Frame Clip, V03263
7. Head Jamb Weather Strip, V2977
8. Connecting Barb, V803
9. Jamb/Head Jamb Exterior Cover, A3476
10. Clad, Locking/Stationary Stile, 15/16" Glass, A3362
11. Stile, Locking/Stationary
12. Glazing Clip, V2874
13. Pile Weather Strip, V2493
14. Roller Track, V2426
15. Sill Slot Cover, A3420
16. Sill Track Cover, A2736
17. Sill Bulb Weather Strip, V2564
18. Interior Glazing Seal, V2949
19. High Performance Sill Liner Nosing, A2863
20. Clad, Locking/Stationary Stile, 1 1/4" Glass, A3349

*Not included on Pocket Door

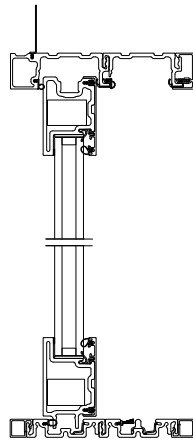

1 1/4" Glass

Stationary/Pocket Panel
Head Jamb and Sill

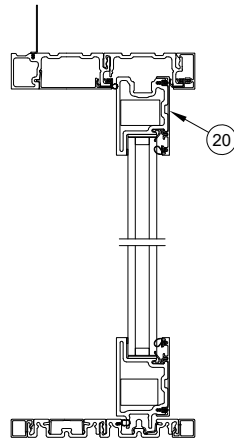

Primary/Inactive Panel
Head Jamb and Sill

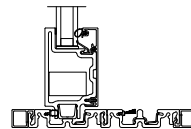

Modular Sill Option

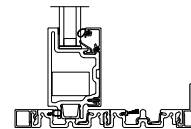

Performance Sill Option

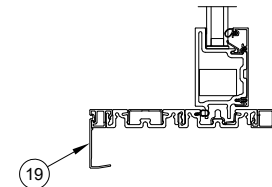

High Performance Sill Option

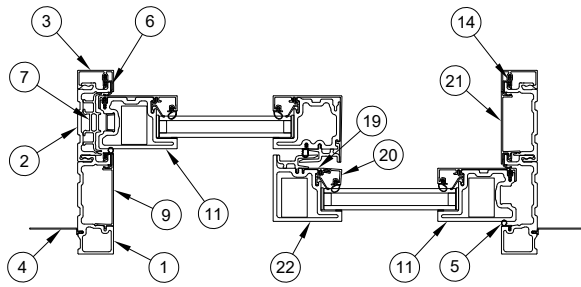

Stacked Uni-directional Jamb Detail

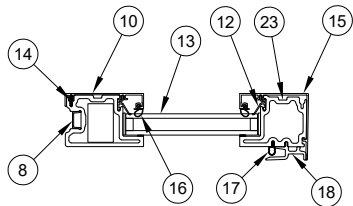

1 5/16" Uni-directional Panel

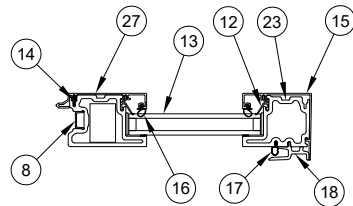

1 5/16" Bi-parting Panel

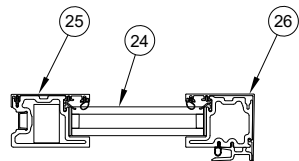

1 1/4" Uni-directional Panel

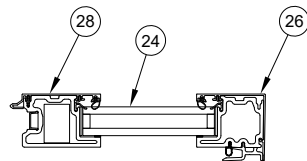

1 1/4" Bi-parting Panel

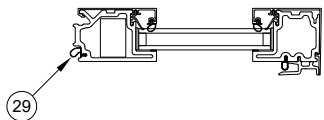

Inactive Panel

1. Exterior Frame
2. Frame
3. Frame Liner, A3248
4. Nail Fin, V2920
5. Frame Weather strip, V2475
6. Frame Clip, V03263
7. Jamb Filler, V2915
8. Cover, Locking Stile, V2885
9. Jamb/Head Jamb Exterior Cover, A3476
10. Clad, Locking/Stationary Stile 15/16" Glass, A3362
11. Stile, Locking/Stationary
12. Glazing Clip, V2874
13. 15/16" Insulating Glass
14. Connecting Barb, V803
15. Clad, Interlocking Stile, 15/16" Glass, A3363
16. Interior Glazing Seal, V2949
17. Bulb Weather Strip, Sill and Panel, V2564
18. Interlock, V2875
19. Exterior, Interlocking Stile Clad Connector, V2966
20. Clad, Exterior Interlocking Stile, A3409
21. Jamb/Head Jamb Interior Cover, A3244
22. Stile, Exterior Interlocking
23. Stile, Interior Interlocking
24. 1 1/4" Insulating Glass
25. Clad, Locking/Stationary Stile, 1 1/4" Glass, A3349
26. Clad, Interior Interlocking Stile, 1 1/4" Glass, A3350
27. Clad, Locking Stile, Bi-Parting 15/16" Glass, A3366
28. Clad, Locking Stile, Bi-Parting 1 1/4" Glass, A3352
29. Bi-parting Meeting Stile Weather Strip, V2968

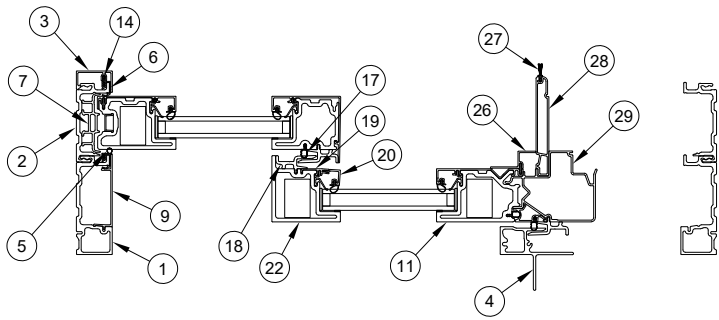

Pocket Uni-directional Jamb Detail

1. Exterior Frame
2. Frame
3. Frame Liner, A3248
4. Pocket Interlock
5. Frame Weather Strip, V2475
6. Frame Clip, V03263
7. Jamb Filler, V2915
8. Cover, Locking Stile, V2885
9. Jamb/Head Jamb Exterior Cover, A3476
10. Clad, Locking/Stationary Stile 15/16" Glass, A3362
11. Stile, Locking/Stationary
12. Glazing Clip, V2874
13. 15/16" Insulating Glass
14. Connecting Barb, V803
15. Clad, Interlocking Stile, 15/16" Glass, A3363
16. Interior Glazing Seal, V2949
17. Bulb Weather Strip, Sill and Panel, V2564
18. Interlock, V2875
19. Exterior, Interlocking Stile Clad Connector, V2966
20. Clad, Exterior Interlocking Stile, A3409
21. 1 1/4" Insulating Glass
22. Stile, Exterior Interlocking
23. Stile, Interior Interlocking
24. Clad, Locking/Stationary Stile, 1 1/4" Glass, A3354
25. Clad, Interior Interlocking Stile 1 1/4" Glass, A3350
26. Pocket Cover Trim, A3291
27. Pile Weather Strip, V2493
28. Pocket Cover, A3293
29. Pocket Interlock Support Block, A3313
30. Clad, Locking Stile, Bi-Parting 15/16" Glass, A3366
31. Clad, Locking Stile, Bi-Parting 1 1/4" Glass, A3352

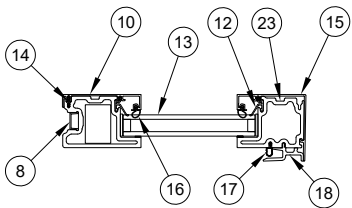

15/16 Uni-directional Panel

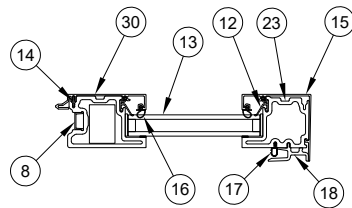

15/16 Bi-parting Panel

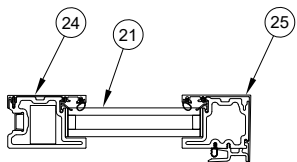

1 1/4 Uni-directional Panel

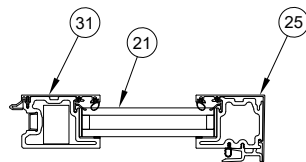

1 1/4 Bi-parting Panel

To order complete Replacement Panels and/or Replacement Sills, refer to Configured Parts in OMS.

Sill Corner Key

Includes:

- 1 - Key, jamb to sill
- 2 - #8 x 1 3/4", TEK 2, Torx, Pan head stainless steel screws
- 2 - #8 x 1/2" full thread, Torx, Pan head stainless steel screws

Handing	Color	PN
LH	Black	11862438
RH		11862439

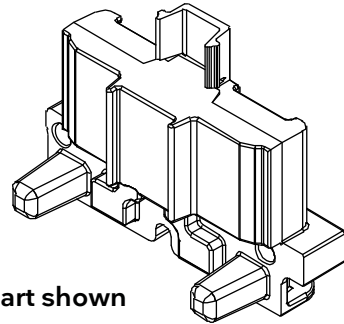

LH part shown

Exterior Frame Hollow Corner Key Kit

Includes:

- 1 - Key, exterior frame hollow
- 4 - #8 x 1/2" full thread, Torx, Pan head stainless steel screw

Color	PN
Black	11862440

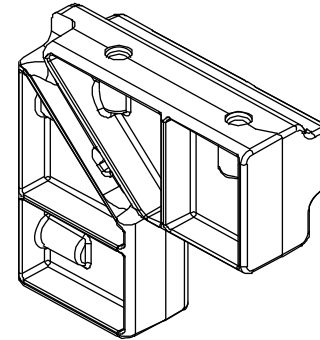

Head Jamb Corner Key Kit

Includes:

- 1 - Key, Jamb to head jamb
- 4 - #8 x 1/2" full thread, Torx, Pan head stainless steel screws

Color	PN
Black	11862441

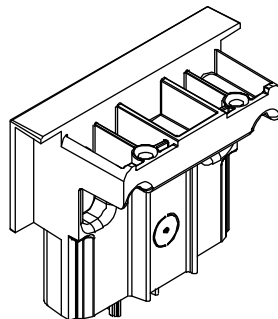

Head Jamb Corner Key, Exterior

Includes:

- 1 - Key, jamb to head jamb, exterior
- 4 - #8 x 1/2" full thread, Torx, Pan head stainless steel screws

Color	PN
Black	11862442

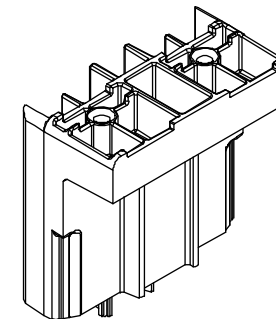

Exterior Frame Hollow Splice Key

Includes:

- 1 - Key, splice, frame, exterior
- 2 - #8 x 1/2" full thread, Torx, Pan head stainless steel screws

Color	PN
Black	11862443

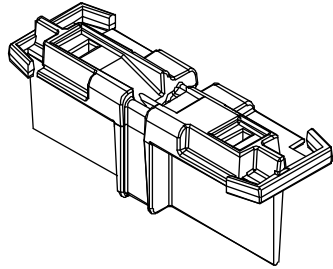

Exterior Flat Shim

Adhesive backed

Qty	PN
Pkg of 20	11102179

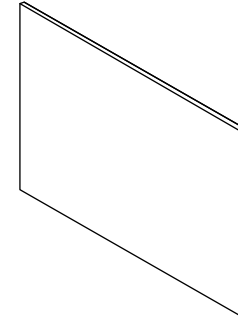

Interior Flat Shim

Adhesive backed

Qty	PN
Pkg of 20	11102180

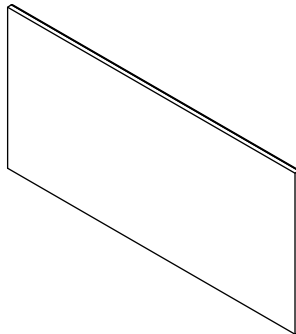

Interior Counter Shim

Color	PN
Black	11102175

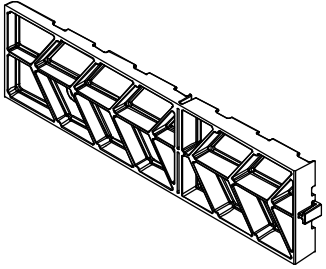

Middle Counter Shim

Color	PN
Black	11102174

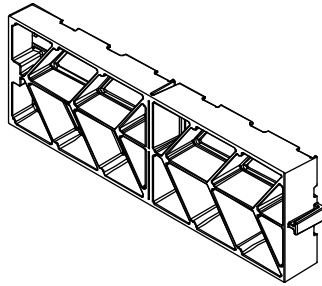

Exterior Counter Shim

Color	PN
Black	11102176

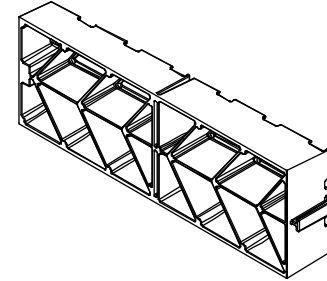

Installation Tools Kit

Includes:

1 - Long arm Allen wrench, M5

Usage dates:

4/26/2021 to present

PN
11862829

No illustration available

Fastener Kit, Black Bag*

Includes:

25 - #8-12 x 3" Torx T20, pan head, 2/3 thread screws

Products:

All windows and doors

Color	PN 25/bag	PN 200/box
Matte Black	11862478	11862477

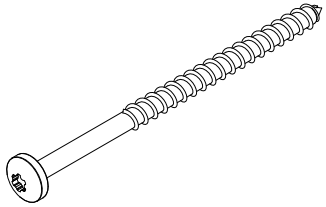

Fastener Kit, Green Bag*

Includes:

16 - #8-18 x 1 3/4" Tek-2, pan head, Torx T20, full thread screws

Products:

All windows and doors

Color	PN 16/bag
Stainless Steel	11862476

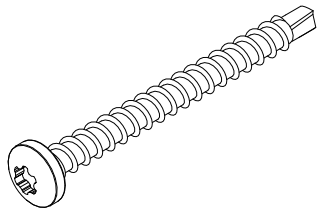

Fastener Kit, Red Bag*

Includes:

16 - #8-18 x 1/2" Type AB, full thread screws

Products:

All windows and doors

Color	PN 16/bag
Stainless Steel	11862475

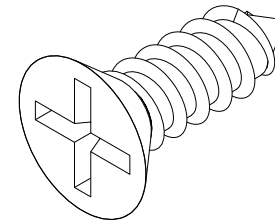

*NOTE: Colors refer to color coded bags.

Parts in Kit	Uni-Directional Stacked				
	OX/XO	OXO/XXO	OXXX/ XXXXO	OXXXX/ XXXXXO	OXXXXX/ XXXXXXO
	Part Number				
	11862449	11862450	11862451	11862452	11862453
	Quantity in Kit				
Pocket Bumper/2 per kit	0	0	0	0	0
Pocket Cover Support Bracket Kit	0	0	0	0	0
Bumper, .532"	0	0	0	0	0
Gasket, Pocket Interlock (Includes both LH and RH gasket)	0	0	0	0	0
Screw, #8 x 15 x 2.500" 2/3 thread	0	0	0	0	0
Stationary Bracket Kit	1	1	1	1	1
Shoot Bolt Strike Kit	0	0	0	0	0
Screw, #8 x 15 x 3", 2/3 thread	1	1	1	1	1
Header Part Stop Foam Seal	1	2	3	4	5
Sill Drain Filter	1	2	3	4	5
Bumper, .125"	2	0	0	0	0
Panel Bumper Kit (Panel A to B)	0	1	1	1	1
Panel Bumper Kit (Panel B to B)	0	0	1	2	3
Stile Plug, Inactive Interior Interlock	1	2	3	4	5
Screw, #8 x 1.750, Tek-2	1	1	2	2	2
Screw, #8 x .500 Torx	1	2	2	2	2
Dust Block, 1/2" x 1 1/2" x 1/2" Pile	4	4	4	4	4

Parts in Kit	Uni-Directional Pocket					
	PX/XP	PXX/XXP	PXXX/XXXP	PXXXX/XXXXP	PXXXXX/XXXXXX	PXXXXXX/XXXXXXP
	Part Number					
	11862454	11862455	11862456	11862457	11862458	11862459
	Quantity in Kit					
Pocket Bumper/2 per kit	1	1	1	1	1	1
Pocket Cover Support Bracket Kit	0	0	0	1	1	1
Bumper, .532"	0	0	2	2	2	2
Gasket, Pocket Interlock (Includes both LH and RH gasket)	1	1	1	1	1	1
Screw, #8 x 15 x 2.500" 2/3 thread	1	1	1	1	1	1
Stationary Bracket Kit	0	0	0	0	0	0
Shoot Bolt Strike Kit	0	0	0	0	0	0
Screw, #8 x 15 x 3", 2/3 thread	1	1	1	1	1	1
Header Part Stop Foam Seal	0	1	2	3	4	5
Sill Drain Filter	0	1	2	3	4	5
Bumper, .125"	0	2	0	0	0	0
Panel Bumper Kit (Panel A to B)	0	0	1	1	1	1
Panel Bumper Kit (Panel B to B)	0	0	0	1	2	3
Stile Plug, Inactive Interior Interlock	0	1	2	3	4	5
Screw, #8 x 1.750, Tek-2	3	3	3	3	4	4
Screw, #8 x .500 Torx	1	1	2	2	2	2
Dust Block, 1/2" x 1 1/2" x 1/2" Pile	4	4	4	4	4	4

Parts in Kit	Bi-Parting Stacked			
	Ox/XO	OXX/XXO	OXXX/XXXO	OXXXX/XXXXO
	Part Number			
	11862460	11862461	11862462	11862463
	Quantity in Kit			
Pocket Bumper/2 per kit	0	0	0	0
Pocket Cover Support Bracket Kit	0	0	0	0
Bumper, .532"	0	0	0	0
Gasket, Pocket Interlock (Includes both LH and RH gasket)	0	0	0	0
Screw, #8 x 15 x 2.500" 2/3 thread	0	0	0	0
Stationary Bracket Kit	2	2	2	2
Shoot Bolt Strike Kit	1	1	1	1
Screw, #8 x 15 x 3", 2/3 thread	0	0	0	0
Header Part Stop Foam Seal	2	4	6	8
Sill Drain Filter	2	4	6	8
Bumper, .125"	4	0	0	0
Panel Bumper Kit (Panel A to B)	0	2	2	2
Panel Bumper Kit (Panel B to B)	0	0	2	4
Stile Plug, Inactive Interior Interlock	2	4	6	8
Screw, #8 x 1.750, Tek-2	1	1	2	2
Screw, #8 x .500 Torx	1	2	2	2
Dust Block, 1/2" x 1 1/2" x 1/2" Pile	0	0	0	0

Parts in Kit	Uni-Directional Pocket				
	PX/XP	PXX/XXP	PXXX/XXXP	PXXXX/XXXXP	PXXXXX/XXXXXX
	Part Number				
	11862464	11862465	11862466	11862467	11862468
	Quantity in Kit				
Pocket Bumper/2 per kit	1	1	1	1	1
Pocket Cover Support Bracket Kit	2	2	2	2	2
Bumper, .532"	0	0	0	2	2
Gasket, Pocket Interlock (Includes both LH and RH gasket)	0	0	4	4	4
Screw, #8 x 15 x 2.500" 2/3 thread	1	1	1	1	1
Stationary Bracket Kit	2	2	2	2	2
Shoot Bolt Strike Kit	0	0	0	0	0
Screw, #8 x 15 x 3", 2/3 thread	1	1	1	1	1
Header Part Stop Foam Seal	0	0	0	0	0
Sill Drain Filter	0	2	4	6	8
Bumper, .125"	0	2	4	6	8
Panel Bumper Kit (Panel A to B)	0	4	0	0	0
Panel Bumper Kit (Panel B to B)	0	0	2	2	2
Stile Plug, Inactive Interior Interlock	0	2	4	6	8
Screw, #8 x 1.750, Tek-2	5	5	5	6	6
Screw, #8 x .500 Torx	1	1	2	2	2
Dust Block, 1/2" x 1 1/2" x 1/2" Pile	0	0	0	0	0

Trim Set, Active Keyed

Handing	Color	PN
LH	Matte Black	10501558
	Matte Bronze	10501559
	Satin Nickel	10501560
	Silver	10501561
	Stone White	10501571
RH	Matte Black	10501562
	Matte Bronze	10501563
	Satin Nickel	10501564
	Silver	10501565
	Stone White	10501572

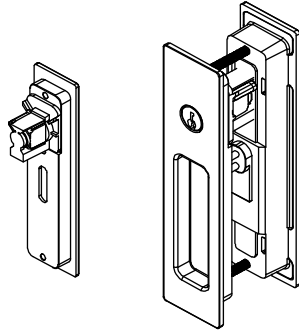

Trim Set, Active, Non-Keyed

Color	PN
Matte Black	10501583
Matte Bronze	10501584
Satin Nickel	10501585
Silver	10501586
Stone White	10501574

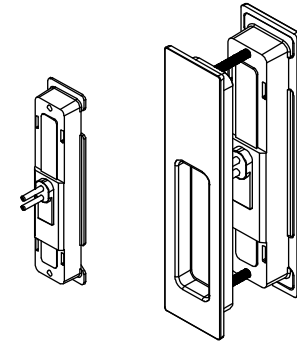

Trim Set, Inactive

Color	PN
Matte Black	10501566
Matte Bronze	10501567
Satin Nickel	10501568
Silver	10501569
Stone White	10501573

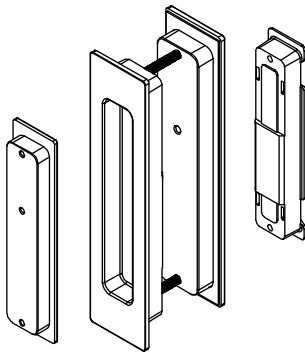

Edge Pull Kit - Pocketing Units

Includes:

- 1 - Edge pull
- 2 - #7-19 x 7/8" Type AB Phillips head screws

Color	PN
Satin Chrome	11862432

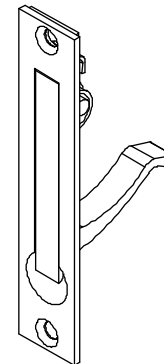

Trim Set, Keyed Cylinder

Includes:

- 2 - Keys

NOTE: For keyed alike cylinders, please contact your Marvin representative. Please supply the original order number, if available.

PN
10830174

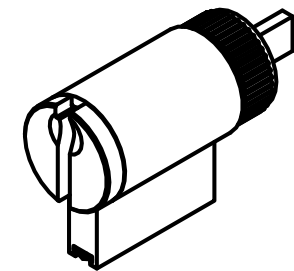

Roller, Hoppe (Series 360) Kit

Includes:

- 1 - Roller
- 2 - #8 -19 x 1/2" Torx Phillips head screws

Color	PN
Stainless Steel	11862431

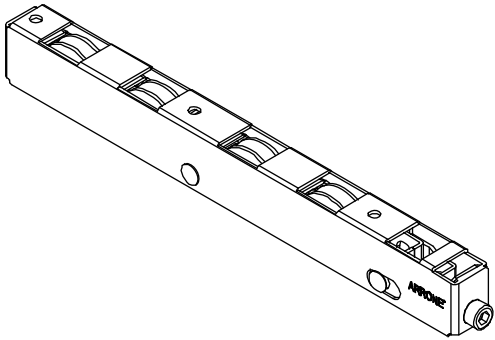

Lock Box, Hoppe Kit

Includes:

- 1 - Lock box
- 7 - #7-10 x 7/8" Type AB Phillips head screws

PN
11862430

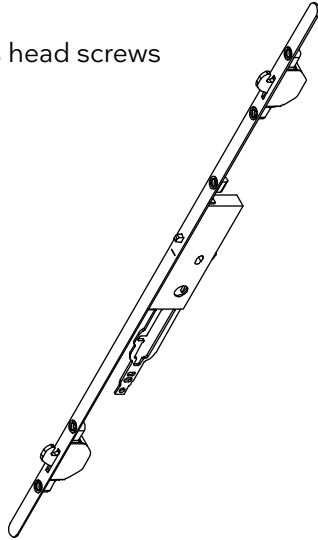

Flush Bolt Rod

Includes:

- 1 - Locking rod with end bolt

Length	PN
11 1/32"	05700180
27 1/32"	05700185
34 9/32"	05700170
41 15/16"	05700177
51 7/16"	05700179
63 7/16"	05700191

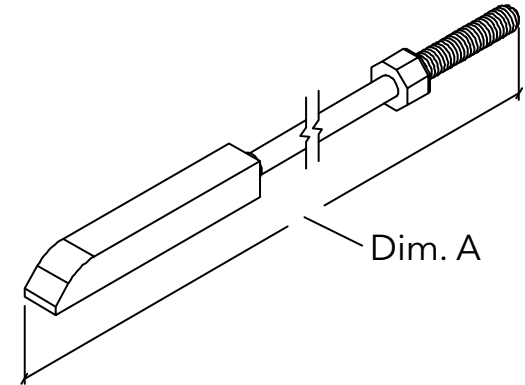

Jamb Strike, Hoppe Kit

Includes:

- 1 - Strike
- 3 - #8-18 x 1/2" type AB Phillips head screws
- 4 - #8-15 x 3" 2/3 thread Phillips head screws

Color	PN
Stainless Steel	11862435

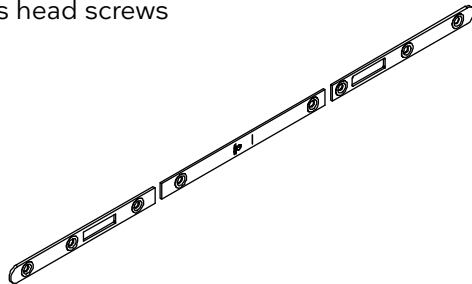

Panel Strike, Hoppe Kit

Includes:

- 1 - Strike
- 7 - #7-19 x 7/8" type AB Phillips head screws

Color	PN
Stainless Steel	11862434

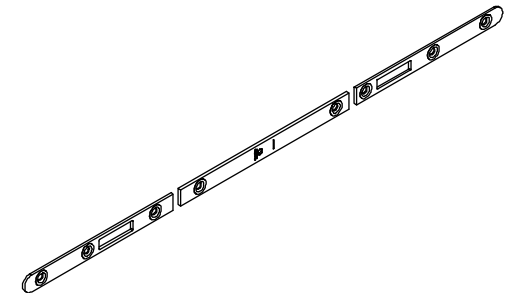

Shoot Bolt Strike Kit

Includes:

- 1 - Strike, shoot bolt
- 2 - #10-12 x 3", 2/3 thread, Torx T20 head screws

Color	PN
Black	11862425

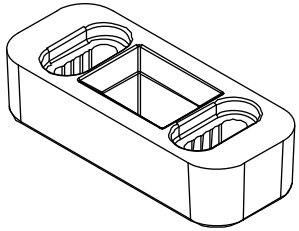

Shoot Bolt Guide

PN
10501544

Suggested Fasteners	PN
1 - #8 x 1" TEK-3, Phillips, pan head screw	11800180

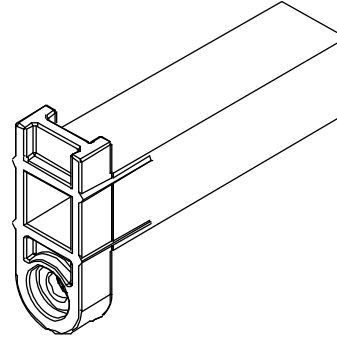

Flush Bolt Assembly

Color	PN
Black	11101780

Suggested Fasteners	PN
2 - #7-19 x 7/8" Type AB, full thread, P2, Phillips head, stainless steel screws	11800777

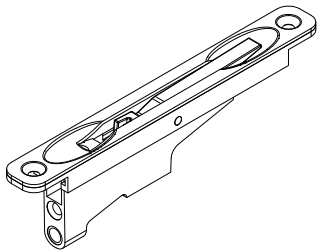

Flush Bolt Trim Cover

Includes:

- 1 - Flush bolt trim cover
- 2 - #7-19 x 7/8" Type AB, full thread, P2, Phillips head, stainless steel screws

PN
11862433

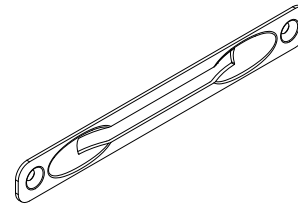

Magnet Assembly Housing

Color	PN
Black	10815371

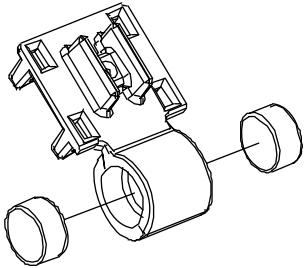

Turnbuckle Assembly

Includes:

- 1 - Turnbuckle
- 2 - 1/4-20 x 1" full thread, flat head P3 screw

Handing	PN
LH	10507605
RH	10507606

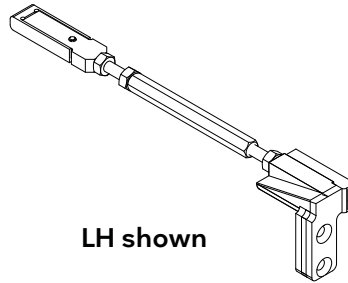

LH shown

Turnbuckle Barrel

Length	PN
4"	15007628
10"	10507629

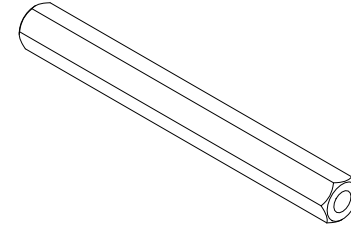

Transmitter Housing

Color	PN
Black	10501896

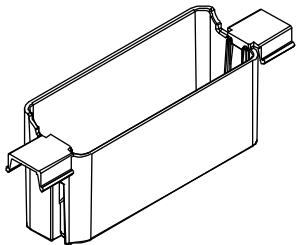

Transmitter Cover

Color	PN
Black	10501898

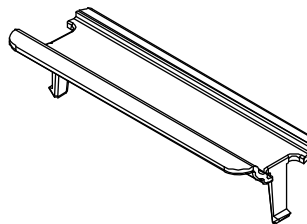

Bracket, Sensor

Color	PN
Black	10501899

Suggested Fasteners	PN
1 - #8-18 x 7/16" TEK-2 Phillips, full thread, pan head screw	11800177

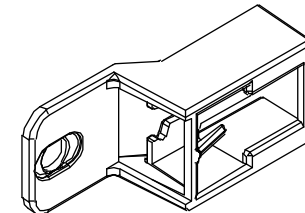

Reed Capsule

Color	PN
Black	10501846

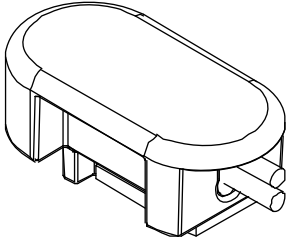

Pulley Corner Key

Includes:

- 1 - Bracket
- 4 - #8-15 x 3" type A/TF, 2/3 thread screw

PN
10507609

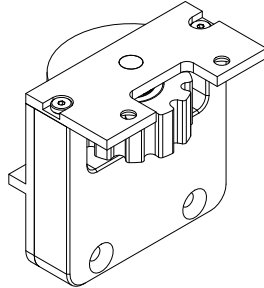

Bi-Parting Belt Clamp

Includes:

- 1 - Bracket
- 2 - 1/4-20 x 1" full thread, flat head P3 screw

Handing	PN
LH	10507607
RH	10507608

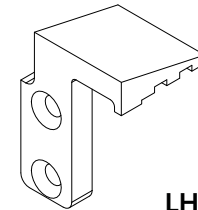

LH shown

Motor

Model	PN
Everest	10507610
Peak	10507600



Control Box

(Configurable to Motor)

PN
10507601



C13 18" Power Cord

PN
10507621

No illustration available

Closing Ramp Assembly

Includes:

- 1 - Bracket
- 2 - #8-18 x 3" type AB, Phillips head, full thread screw

PN
10507611

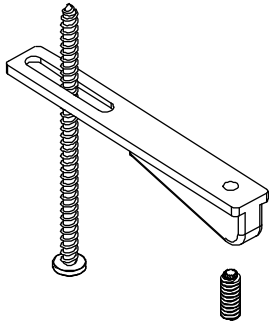

Exterior Wall Switch

Color	PN
Black	10507612
White	10507613



Interior Wall Switch

PN
10507614



T1 Sensor

PN
10507615



H1 Sensor

PN
10507616



Android/IOS Bluetooth Module

PN
10507618



Voice Command Module

PN
10507617



Belt

NOTE: Order by foot - belt calculation is frame width x 2 + 4'

Color	PN
Black	10507620

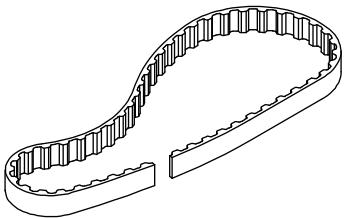

Belt Clip

Color	PN
Black	10507619

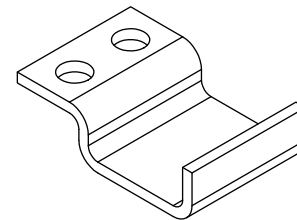

Power Transfer Device Kit, Panel

Includes:

- 1 - Power Transfer Device
- 1 - Magnet
- 2 - #8 x 1" TEK-3, Phillips pan head stainless steel screws

PN
11862384

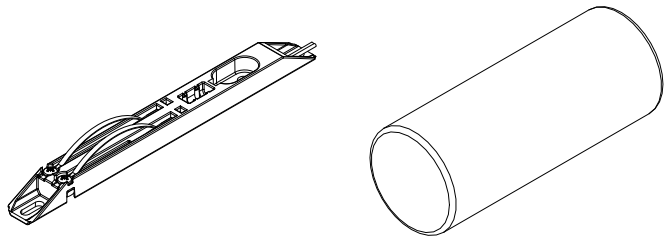

Power Transfer Device Kit, Frame

Includes:

- 1 - Power Transfer Device
- 1 - Reed Capsule
- 2 - #10-12 x 3" Torx, T20, pan head, 2/3 thread screws

PN
11862383

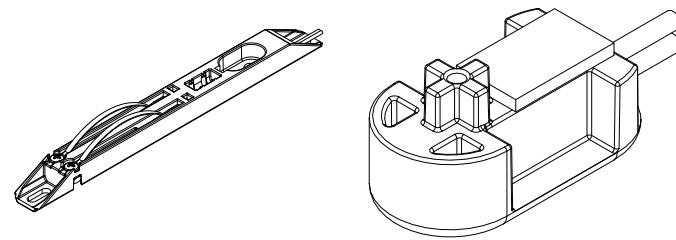

Power Transfer Device Wire Kit, Bi-Parting

Includes:

- 4 - Wire Connector
- 2 - Wire Lock/Close, 25'

PN
11862385

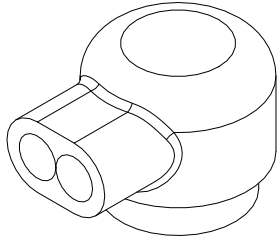

Marvin Control Module Kit

Includes:

- 1 - Marvin Control Module
- 1 - 18" Wire, aux to brake
- 1 - 2' CAT5E wire
- 2 - #8-32 x 5/16" Phillips, pan head stainless steel screws

PN
11852598

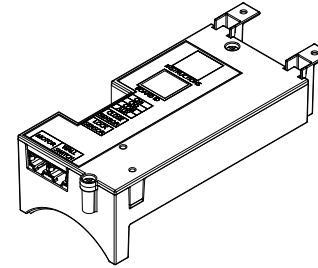

Wire Harness, CAT5E, 2'

PN
10810035

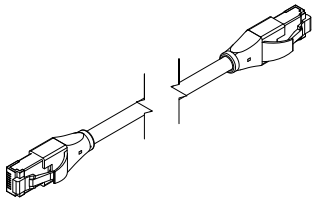

NOTE: The following cables are required, and should be locally sourced for purchase.

Communication Cables

Shielded Cat5e cable with shielded RJ45 connections

Motor Power Cable

Shielded Stranded 14-2 Cable

Stationary Bracket Kit

Includes:

- 1 - Upper stationary bracket
- 1 - #10-12 x 3", Torx T20, 2/3 thread screw
- 1 - #8 x 1", TEK 3, full thread, P2, Phillips pan head screw
- 2 - Lower stationary bracket
- 1 - #8-18 x 7/16" TEK-2 Phillips, full thread, pan head screw
- 1 - #8-18 x 1 1/2", 2/3 thread, A/TF flat head screw

Color	PN
Aluminum	11862424

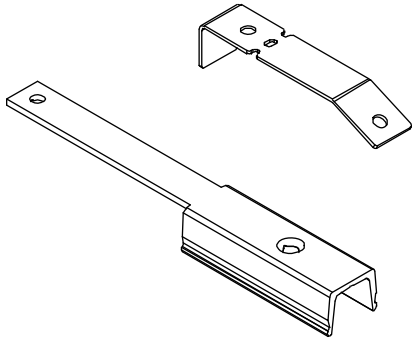

Upper Stationary Bracket (Top)
Lower Stationary Bracket (Bottom)

Pocket Cover Support Bracket Kit

Includes:

- 2 - Pocket support cover brackets
- 4 - #8-18 x 7/16" TEK-2 Phillips, full thread, pan head screw

PN
11862426

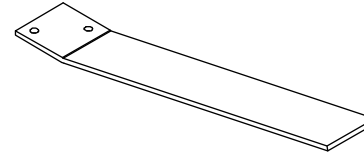

Bumper, .532"

PN
10501592

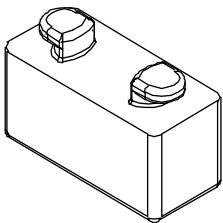

Bumper, .125"

PN
10501591

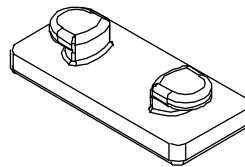

Pocket Bumper Kit

Includes:

- 2 - Bumper, pocket jamb
- 2 - #10-12 x 3" Torx T20, 2/3 thread screws

Color	PN
Black	11862429

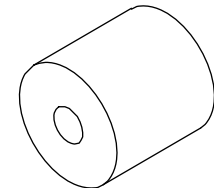

Panel Bumper Kit (panel A to panel B)

Includes:

- 2 - Bumper, secondary to primary
- 2 - Bumper, .375"
- 4 - #10-16 x 1 1/2" P2 flat head, full thread, TEK 2 screws

Color	PN
Black	11862427

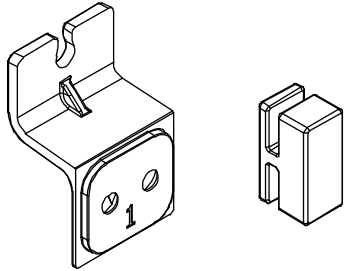

Panel Bumper Kit (panel B to panel B)

Includes:

- 2 - Bumper, secondary to secondary
- 2 - Bumper, .375"
- 4 - #10-16 x 1 1/2" P2 flat head, full thread, TEK 2 screws

Color	PN
Black	11862428

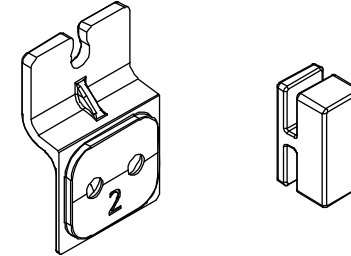

Sill Drain Filter

Color	PN
Black	10500240

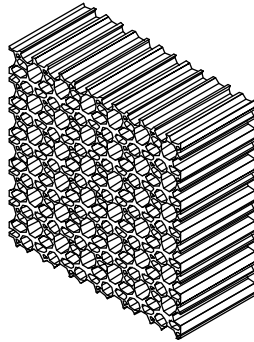

Header Part Stop Foam Seal

Color	PN
Black	10500436

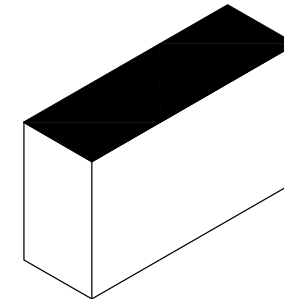

Gasket, Pocket Interlock

Color	PN
Black	10501546

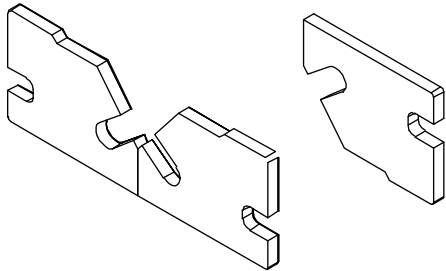

End Cap, HP Sill Liner

Handing	Color	PN
LH	Black	10501543
RH		10501542

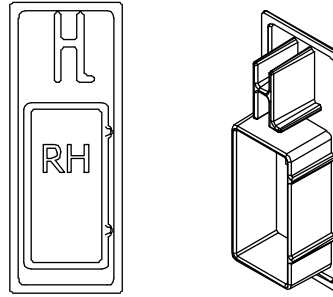

RH part shown

Sill Liner Splice Key, Flush Performance, Kit

Includes:

- 1 - Splice key
- 2 - #8-18 x 1/2", Type AB, full thread, Phillips head, stainless steel screws

Color	PN
Black	11862436

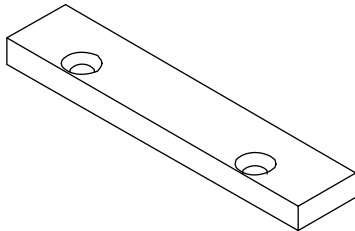

Sill Liner Splice Key, High Performance, Kit

Includes:

- 1 - Splice key, High Performance
- 2 - #8-18 x 1/2", Type AB, full thread, Phillips head, stainless steel screws

Color	PN
Black	11862437

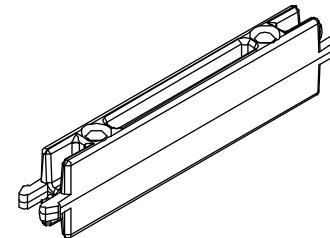

Stile Hole Cover, Exterior, Kit

Includes:

- 2 - Stile hole covers
- 2 - Cover retainer bracket
- 2 - #8-18 x 1 3/4" full thread pan head screws

Color	PN
Bronze	11862444
Ebony	11862445
Gunmetal	11862446
Silver	11862447
Stone White	11862448

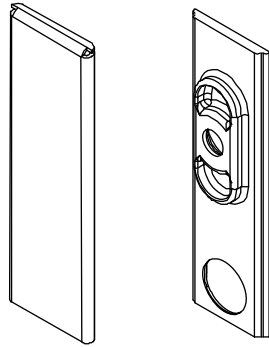

Cover Retainer Bracket

Color	PN
Black	10501594

Suggested Fasteners	PN
1 - #8-18 x 1 3/4" full thread pan head screw	11808176

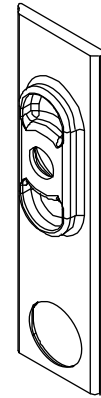

Stile Plug, Inactive Interior Interlock

Color	PN
Black	10500412

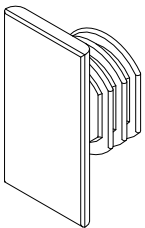

Weep Hole Cover

Color	PN
Black	10501910

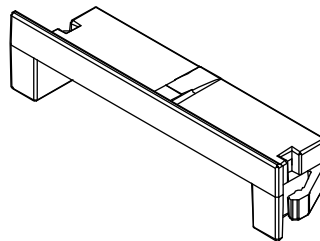

Dust Block Holder, Interior

Color	PN
Black	10500725

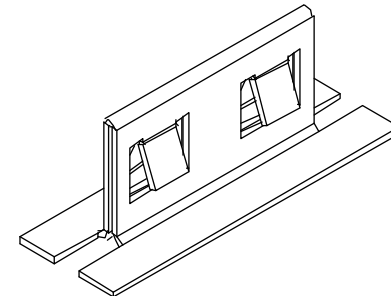

Dust Block, 1/2" x 2 1/4" x 1/2" Pile

Bottom of Exterior Interlock

Color	PN
Black	10500483

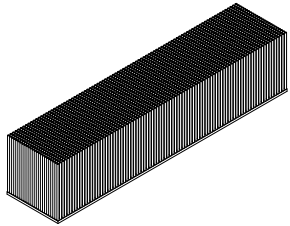

Dust Block, 1/2" x 1 1/2" x 1/2" Pile

Top and bottom of Interior Interlock

Top of Exterior Interlock

Inactive Panel Shoe

Locking/Stationary Jamb

Head Jamb

Pocket Sill

Color	PN
Black	10500443

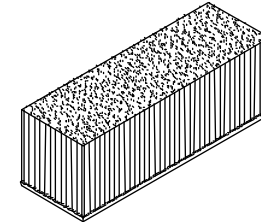

Dust Block, 1/2" x 1 1/8" x 1/2" Pile

Primary Bi Parting Panel Shoe

Color	PN
Black	10500448

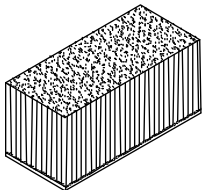

Dust Block, 1/2" x 13/16" x 1/4" Pile

Primary Bi Parting Panel Shoe

Color	PN
Black	10500449

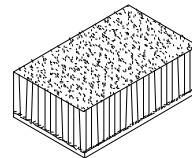

Dust Block
1/2" x 1 1/2" x 3/4" Pile

Bi Parting Sill

Color	PN
Black	10500482

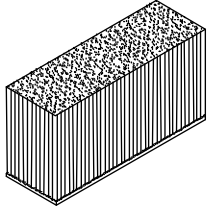

Dust Block
3/4" x 1/2" x 1/2" Pile

Color	PN
Black	10500499

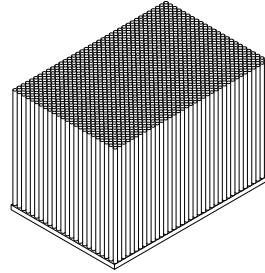

Dust Block
1/4" x 2 1/4" x 1/2" Pile

Color	PN
Black	10500468

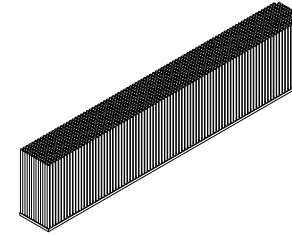

#8-18 x 1/2" Phillips, Pan Head, Tek 2 Screw

PN
11800277

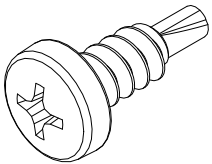

Panel Leveling Block Kit, Stationary Panel

A2810

Modern MultiSlide Door Stacked

Includes:

- 2 - Leveling blocks
- 2 - #8-15 x 1 1/2" 2/3 thread, A.TF, P2, flat head screws

Color	PN
Bronze	11862387

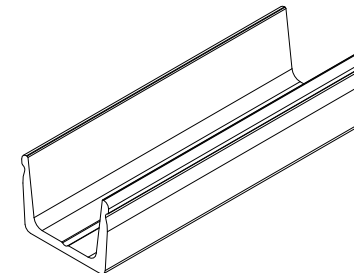

Head Jamb Bracket Kit, Stationary Panel

Modern MultiSlide Door Stacked

Includes:

- 1 - Head jamb bracket
- 4 - #10-12 x 3" 2/3 thread, Torx T20 head screws

Color	PN
Black	11852559

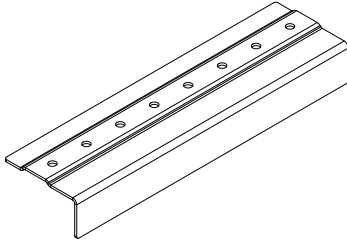

Sill Bracket Kit, Stationary Panel

Modern MultiSlide Door Stacked

Includes:

- 1 - Sill bracket
- 1 - #8-18 x 1/2" Phillips, pan head, Tek 2 screw

Color	PN
Black	11852558

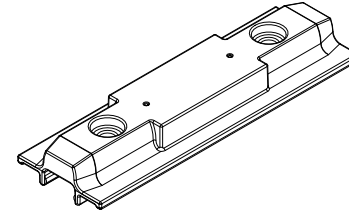

Bumper Bracket Kit, Stationary Sill

Modern MultiSlide Door Stacked

Includes:

- 2 - Bumper brackets
- 2 - Bumpers
- 4 - #10-16 x 1 1/2" P2, flat head, full thread Tek 2 screws

Color	PN
Black	11852556

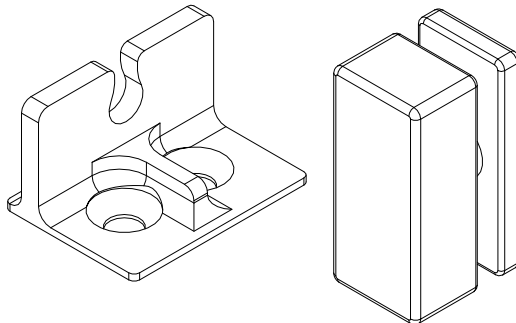

Upper Bracket Kit, Stationary Panel

Modern MultiSlide Door Stacked

Includes:

- 1 - Upper bracket
- 1 - #10-12 x 3" Torx T20, Phillips, 2/3 thread screws
- 1 - #8 x 1" Tek-3 flat head, P2, Phillips, stainless steel screw

Color	PN
Bronze	11852557

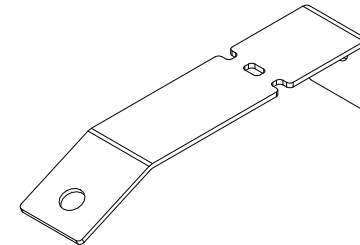

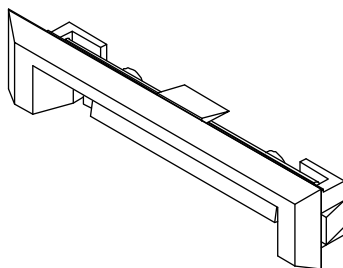

Weep Hole Cover

No longer available, use current.

Jamb Cover, Interior

A3244

Length	Color	PN
200" (5080)	Gunmetal	18818170
	Stone White	18818165
	Bronze	18818160
	Clear Anodize	18818155
	Ebony	18818150



Frame Liner (Head Jamb and Jamb)

A3248

Length	Color	PN
200" (5080)	Gunmetal	18818120
	Stone White	18818115
	Bronze	18818110
	Clear Anodize	18818105
	Ebony	18818100

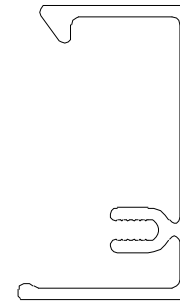

Clad, Locking/Stationary Stile 15/16" Glass

A3362

Length	Color	PN
200" (5080)	Gunmetal	18818220
	Stone White	18818215
	Bronze	18818210
	Clear Anodize	18818205
	Ebony	18818200

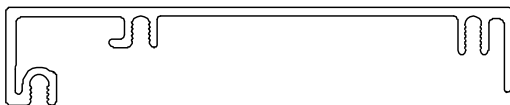

Clad, Locking/Stationary Stile 1 1/4" Glass

A3349

Length	Color	PN
200" (5080)	Gunmetal	18819420
	Stone White	18819415
	Bronze	18819410
	Clear Anodize	18819405
	Ebony	18819400



Trim, Pocket, 1 Deep

A3312

Length	Color	PN
200" (5080)	Gunmetal	18818870
	Stone White	18818865
	Bronze	18818860
	Clear Anodize	18818855
	Ebony	18818850



Pocket Interlock Support Block

A3313

Length	Color	PN
200" (5080)	Black	18818900

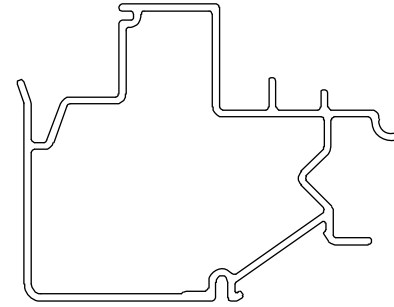

Sill Slot Cover

A3420

Length	Color	PN
98" (2489)	Black	18819900

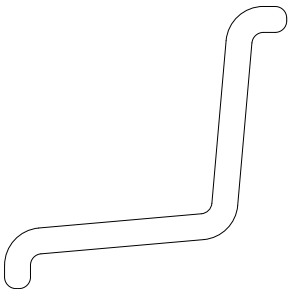

Sill Track Cover

A2736

Length	Color	PN
200" (5080)	Ebony	18818050
	Bronze	18818060

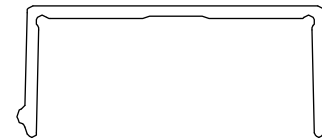

When ordering replacement aluminum parts, specify:

1. Order number/line number (if available);
2. Type of unit;
3. Description;
4. Color;
5. Length.

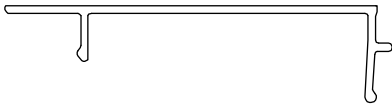

A3476

Jamb/Head Jamb Cover, Exterior

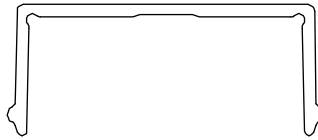

A2736

Sill Track Cover



A2863

Sill Liner Nosing, HP

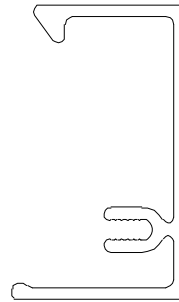

A3248

Frame Liner (Head Jamb and Jamb)

When ordering replacement aluminum parts, specify:

1. Order number/line number (if available)
2. Type of unit
3. Description
4. Color
5. Length



Jamb Cover, Interior , A3244

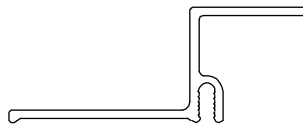

Trim, Pocket Cover A3291

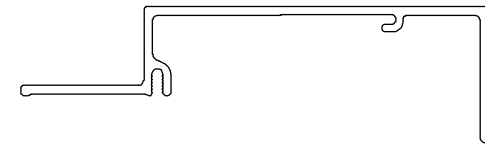

Trim, Pocket, 1 Deep , A3312

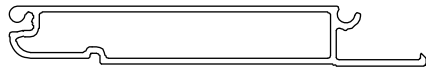

Pocket Cover, Modular, A3292

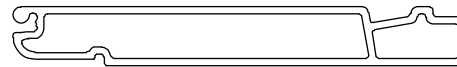

Pocket Cover, A3293

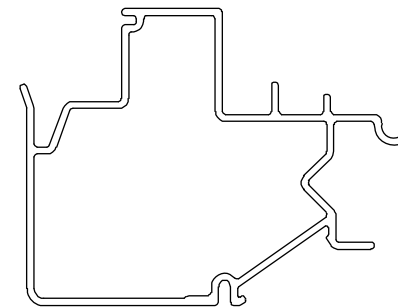

Pocket, Interlock Support Block, A3313

When ordering replacement aluminum parts for, specify:

1. Order number/line number (if available)
2. Type of unit
3. Description
4. Color
5. Length



Clad, Locking/Stationary Stile, A3362
15/16" Glass



Clad, Locking Stile Bi-Parting, A3366
15/16" Glass



Clad, Inactive Stile, A3367
15/16" Glass

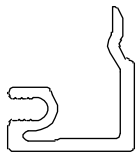

Clad, Exterior Interlock Stile, A3410
15/16" Glass



Clad, Pocket Stile, A3368
15/16" Glass

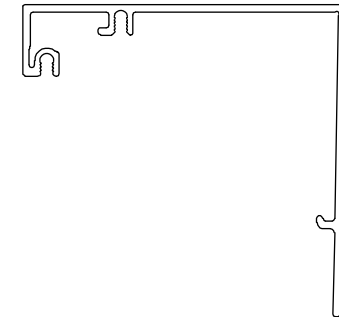

Clad, Interior Interlock Stile, A3363
15/16" Glass

When ordering replacement aluminum parts, specify:

1. Order number/line number (if available)
2. Type of unit
3. Description
4. Color
5. Length

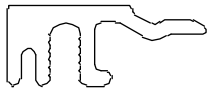

Clad, Exterior Interlock Stile, A3409
1 1/4" Glass

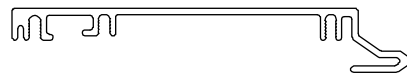

Clad, Locking Stile Bi-Parting, A3352
1 1/4" Glass

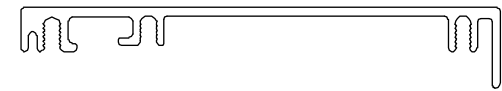

Clad, Locking/Stationary Stile, A3349
1 1/4" Glass



Clad, Inactive Stile, A3354
1 1/4" Glass

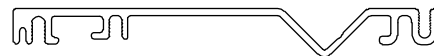

Clad, Pocket Stile, A3355
1 1/4" Glass

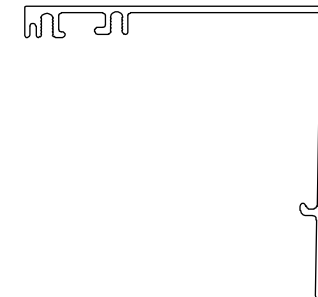

Clad, Interior Interlock Stile, A3350
1 1/4" Glass

Jamb Filler

V2915

Length	PN
200" (5080)	16219225

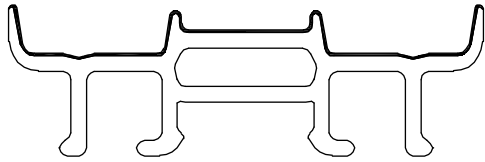

Interlock

V2875

Length	Color	PN
203" (5156)	Black	16219215

Suggested Fasteners	PN
#8-1" full thread, phillips pan head screw, black	11800180

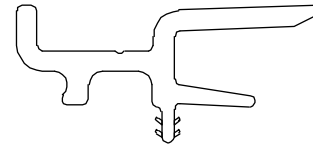

Frame Clip

V03263

Length	Color	PN
203" (5156)	Black	16219212

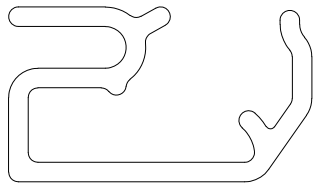

Clad Connector, Exterior Interlock Stile

V2966

Length	Color	PN
200" (5080)	Black	16219260

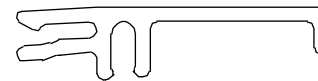

Glazing Clip, 15/16" Glass

V2874

Length	Color	PN
200" (5080)	Black	16219205

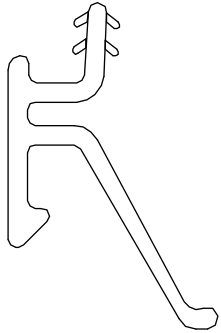

Glazing Clip, 1 1/4" Glass

V2886

Length	Color	PN
200" (5080)	Black	16219230

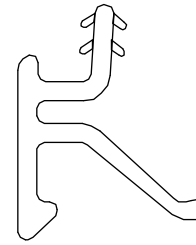

Interior Glazing Seal

V2949

Length	Color	PN
200" (5080)	Black	16219235



Roller Track

V2426

Length	Color	PN
150" (3810)	Black	15984899

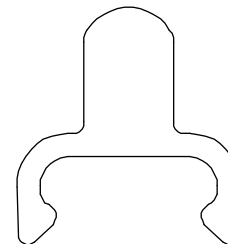

When ordering replacement vinyl parts, specify:

1. Order number/line number (if available)
2. Type of unit
3. Description
4. Length

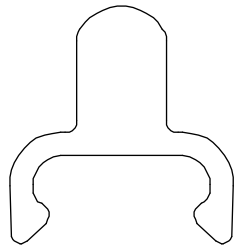

Roller Track, V2426

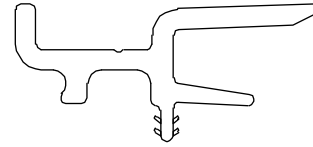

Interlock, V2875

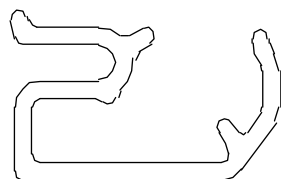

Frame Clip, V2884

No longer available, replaced with V03263

Weather Strip, 1/2" Pile

V2493

Length	Color	PN
500' (152,400) roll	Black	11209999



Bi-Parting Meeting Stile Weather Strip

V2968

Length	Color	PN
144" (3658)	Black	16219265

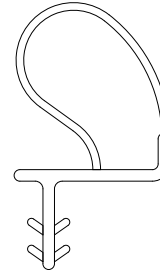

Jamb Bulb Weather Strip

V2475

Length	Color	PN
144" (3658)	Black	11209699

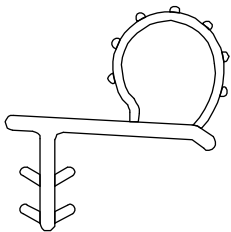

Weather Strip, Head Jamb

V2977

Length	Color	PN
200" (5080)	Black	16219275

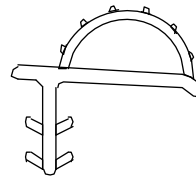





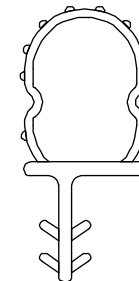

Sill Bulb Weather Strip

V2564

Length	Color	PN
150" (3810)	Black	11211299



		Left Hand Screen	Right Hand Screen
Single Screen	Inside Building	<p>Inside</p> <p>P2  _____  P1</p> <p>Outside</p>	<p>Inside</p> <p>P2  _____  P1</p> <p>Outside</p>
Double Screen	Inside Building	<p>Inside</p> <p>P2  _____  P1</p> <p>Outside</p>	

To order full unit sill covers and screen cartridges, refer to configured parts in OMS.

When ordering replacement screen parts, specify:

1. Original order number/line number.

NOTE: Single screens: Marvin order number is found under the bottom stile cover on the opposite side of the tensioning springs. Double screens: Marvin order number is found under the bottom left hand stile cover on the opposite side of the tensioning springs (left hand when viewing from exterior).

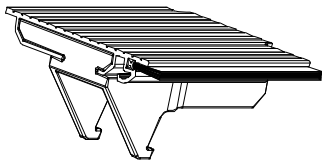

Sill Cover, Short End

Operation	Color	PN
LH	Clear Anodized	10504034
	Gunmetal	10504036
	Stone White	10504038
	Bronze	10504040
	Ebony	10504042
RH	Clear Anodized	10504035
	Gunmetal	10504037
	Stone White	10504039
	Bronze	10504041
	Ebony	10504043

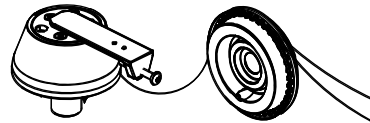

Cone Assembly

Operation	PN
LH	10504102
RH	10504103

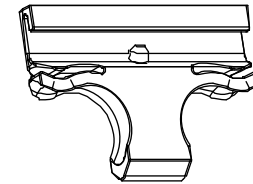

Screen Stop, Header, Bi-Parting

PN
10504106

When ordering replacement screen parts, specify:

1. Original order number/line number.

NOTE: Single screens: Marvin order number is found under the bottom stile cover on the opposite side of the tensioning springs. Double screens: Marvin order number is found under the bottom left hand stile cover on the opposite side of the tensioning springs (left hand when viewing from exterior).

Illustration not available

Cable

Color	PN
Black	10504098
Red	10504099
Yellow	10504100
Green	10504101



Splice Joiner

PN
10504139

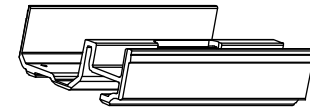

Splice Joiner, Sill

PN
10504175

When ordering replacement aluminum parts, specify:

1. Original order number/line number;
2. Total rough opening;
3. Part length;
4. Handing;
5. Finish/Color (where applicable),

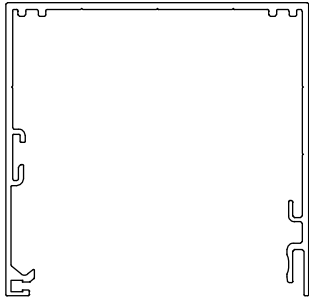

Head Jamb Frame
Head Jamb Frame, Spliced

Note: Spliced is available in LH or RH configurations

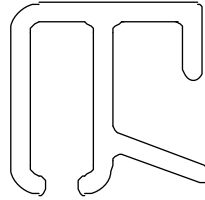

Tab Retainer, Head Jamb

Includes: Retainer clips



Cover, Head Jamb
Cover, Head Jamb, Spliced

Includes: Pile weather strip and retainer clips

Note: Spliced is available in LH or RH configurations.



Sill Cover, Spliced

Includes: Pile weather strip and end caps

Note: Available in LH or RH configurations

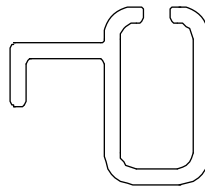

Tab Retainer, Sill
Tab Retainer, Sill, Spliced

Note: Spliced is available in LH or RH configurations.

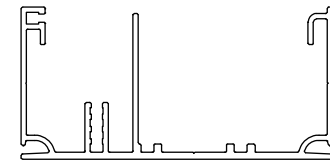

Sill, Frame
Sill, Spliced

Note: Spliced is available in LH or RH configurations

When ordering replacement aluminum parts, specify:

1. Original order number/line number;
2. Total rough opening;
3. Part length;
4. Handing;
5. Finish (where applicable),

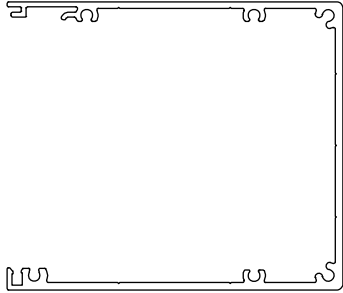

Frame, Jamb, No Cartridge
Jamb, Cartridge Side
Jamb, Bi-Parting

Note: Available in LH or RH configurations



Jamb Cover, Cartridge

Includes: Pile weather strip and retainer clips



Jamb Cover, Stationary

Includes: Magnets and retainer clips

When ordering replacement aluminum parts, specify:

1. Original order number/line number;

NOTE: Single screens: Marvin order number is found under the bottom stile cover on the opposite side of the tensioning springs. Double screens: Marvin order number is found under the bottom left hand stile cover on the opposite side of the tensioning springs (left hand when viewing screen from exterior).

Top Cartridge Bearing

Includes:

- 1 - Cable tensioner
- 1 - Top block slide pulley/bearing
- 4 - Screws

Product usage:

Used prior to 04/27/2020

Operation	Color	PN
LH	Black	10501287
RH	Black	10501288



Bottom Handle Pull Assembly

Includes:

- 1 - Bottom stile cap
- 2 - Screws/cable crimp

Product usage:

Used prior to 04/27/2020

Operation	Color	PN
LH	Black	10501289
RH	Black	10501290



When ordering replacement aluminum parts, specify:

1. Original order number/line number;

NOTE: Single screens: Marvin order number is found under the bottom stile cover on the opposite side of the tensioning springs. Double screens: Marvin order number is found under the bottom left hand stile cover on the opposite side of the tensioning springs (left hand when viewing screen from exterior).

Top Handle Pull Assembly

Includes:

- 1 - Top stile cap
- 2 - Screws/cable crimp

Product usage:

Used prior to 04/27/2020

Operation	Color	PN
LH	Black	10501291
RH	Black	10501292



Bi-Parting Screen Stop

Includes:

- 1 - Double screen stop

Product usage:

Used prior to 04/27/2020

Color	PN
Black	10501296



When ordering replacement aluminum parts, specify:

1. Original order number/line number;

NOTE: Single screens: Marvin order number is found under the bottom stile cover on the opposite side of the tensioning springs. Double screens: Marvin order number is found under the bottom left hand stile cover on the opposite side of the tensioning springs (left hand when viewing screen from exterior).

Bottom Cartridge Bearing

Includes:

- 1 - Bottom bearing/pulley assembly
- 2 - Screws

Product usage:

Used prior to 04/27/2020

Operation	PN
LH	10501299
RH	10501298



Spool Kit

Includes:

- 1 - LH/RH Cone
- 1 - Cable/crimp
- 1 - Cable connector
- 4 - Screws

NOTE: Modern MultiSlide Door will use 13ft (cable) for each cone to connector. Top Cables: width of screen + 1/2 the height. Bottom Cables: 2 times the width of the screen + 1 1/2 times the height

Product usage:

Used prior to 04/27/2020

Length	Operation	Color	PN
Specify LF length	LH	Black	10501294
	RH	Gray	10501293



When ordering replacement aluminum parts, specify:

1. Original order number/line number;

NOTE: Single screens: Marvin order number is found under the bottom stile cover on the opposite side of the tensioning springs. Double screens: Marvin order number is found under the bottom left hand stile cover on the opposite side of the tensioning springs (left hand when viewing screen from exterior).

Cable

NOTE: Modern MultiSlide Door will use 13ft (cable) for each cone to connector. Top Cables: width of screen + 1/2 the height. Bottom Cables: 2 times the width of the screen + 1 1/2 times the height

Product usage:

Used prior to 04/27/2020

Length	PN
Specify LF length	10501259



Handle Pull Covers/Spring Kit

Includes:

- 4 - Stile covers
- 2 - Springs
- 4 - Spring keepers

Product usage:

Used prior to 04/27/2020

PN
10501297



When ordering replacement aluminum parts, specify:

1. Original order number/line number;
2. Total rough opening;
3. Part length;
4. Handing;
5. Finish/color (where applicable),

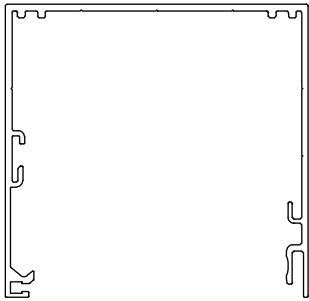

Head Jamb Frame

Includes: Weather strip
Used prior to 04/27/2020

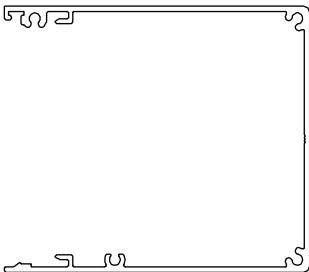

Jamb Frame

Includes: Weather strip
Used prior to 04/27/2020

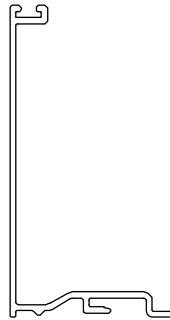

Head Jamb/Jamb Cover

Includes: Weather strip
Used prior to 04/27/2020

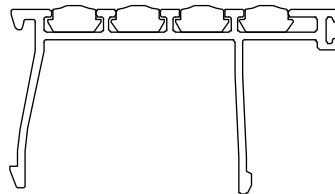

Sill

Includes: Weather strip
Used prior to 04/27/2020



Cartridge

Includes: 1 Complete cartridge assembly
Used prior to 04/27/2020

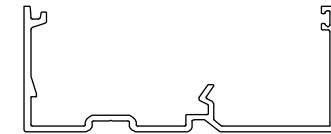

Sill

Includes: Weather strip
Used prior to 04/27/2020



Jamb Stop

Includes: Magnet strip
Used prior to 04/27/2020