

Elevate and Essential Accessories

Elevate Installation Brackets and Nailing Fin	1
Elevate Interior Accessories	2
Essential Installation Brackets and Nailing Fin	3
Essential Exterior Accessories	4
Essential Interior Accessories	5
Elevate and Essential Exterior Casing Elevations	6
Elevate and Essential Exterior Casing Profiles and Parts	7
Elevate Exterior Casing Measurement Conversions	8
Essential Exterior Casing Measurement Conversions	9
Elevate and Essential Exterior Casing Applications for Windows	10
Elevate and Essential Exterior Casing Applications for Doors	11

Elevate Installation Brackets and Nailing Fin

Installation Brackets / Nailing Fin / Drip Cap

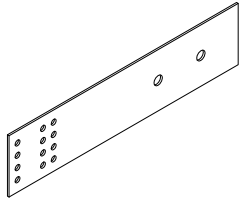

Masonry Bracket

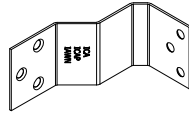

Installation Clip

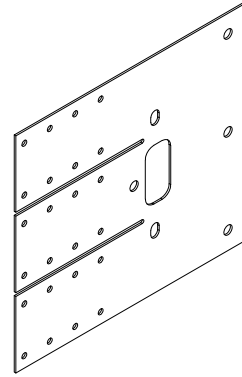

Masonry Bracket

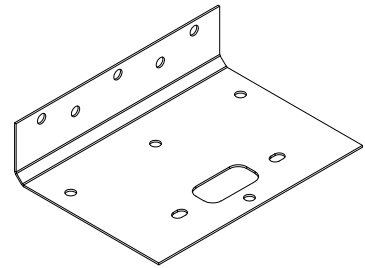
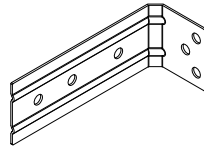
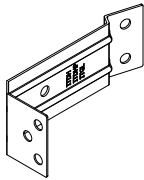
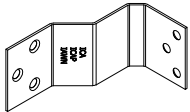

Nail Fin Installation Kit - Impact

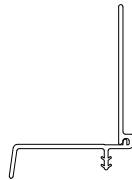

V119
Head Jamb Nailing
Fin/DripCap
Note: Drip Cap is Clear

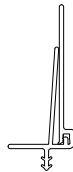

V110
Radius Head Jamb
Nailing Fin/DripCap



V104
Jamb Nailing Fin



V084
Sill Nailing Fin

Elevate Interior Accessories

Jamb Extension

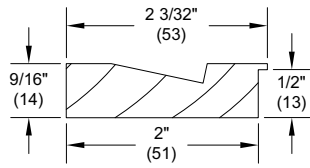

W13310
6 9/16" Jamb Extension

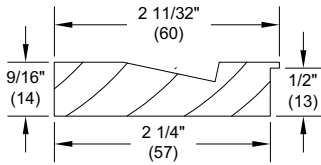

W13328
6 13/16" Jamb Extension

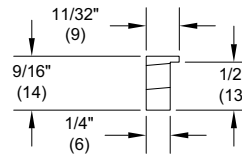

W13329
IIFD 1/4" Jamb Extension
For 6 13/16"

Interior Mull Trim

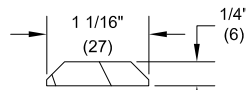

W1241
Interior Mull Trim

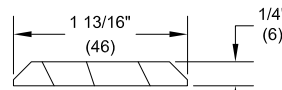

W9159
Horizontal Mull Trim

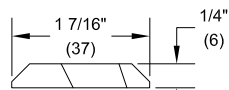

W1242
Interior Mull Trim

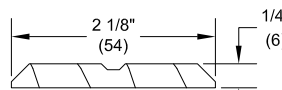

W1243
Interior Mull Trim

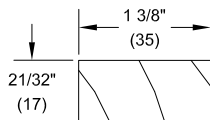

W6172
Mull Filler Block

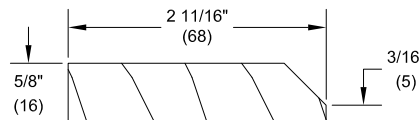

W7004
Sill Standing Block & Mull Tie

Essential Installation Brackets and Nailing Fin

Installation Bracket

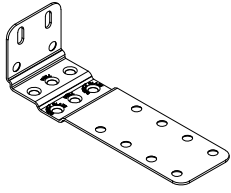

4 9/16" Structural Bracket

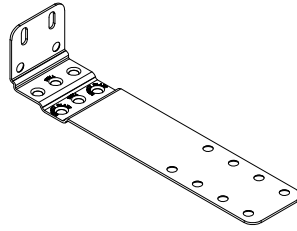

6 9/16" Structural Bracket

Nailing Fin / Drip Cap



V1428
Nailing Fin
Windows and Doors



V2067
Nailing Fin Radius
Windows

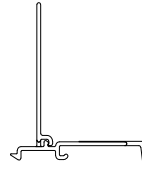

V2395
Nailing Fin With Drip Cap
Windows and Doors

Essential Exterior Accessories

Frame Expander

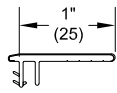

V2034
1" Frame Expander

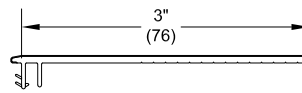

V1780
3" Frame Expander

Flush Fin

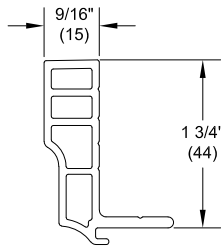

V2056
1 3/4" Flush Fin

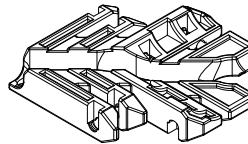

Flush Fin Corner Key

J-Channel

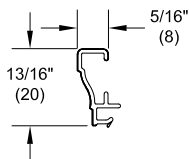

V1458
J-Channel
Note: Mitered Corners

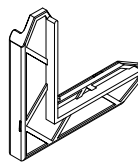

J-Channel
Corner Key

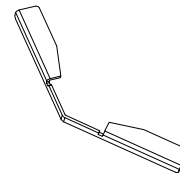

J-Channel
Corner Key
Adjustable

Essential Interior Accessories

Jamb Extension - Stone White

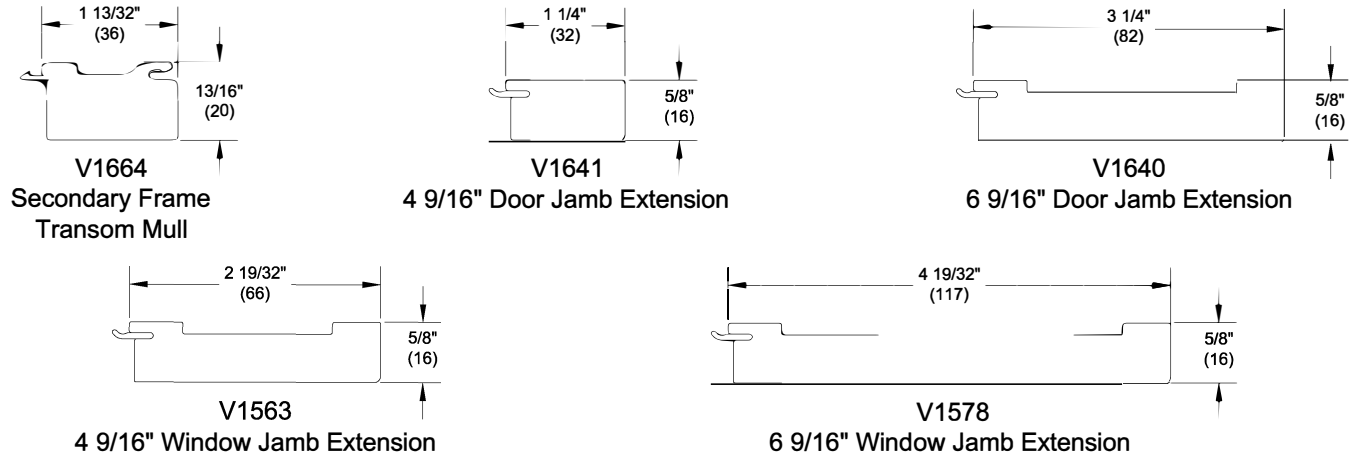

Jamb Extension - Dark Interior

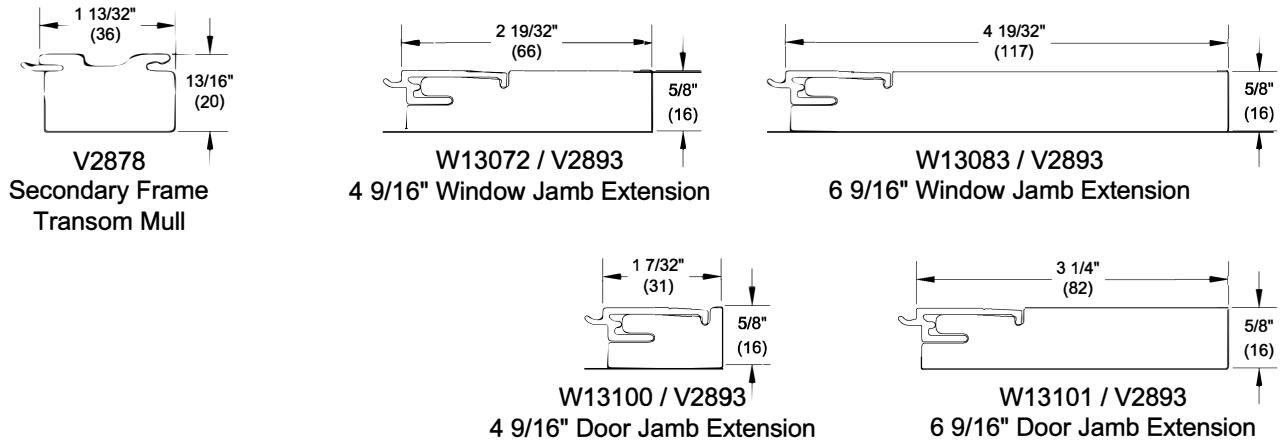

Drywall Return and Receiver - Available In Stone White, Bronze and Ebony



Interior Frame Filler - Available In Stone White, Bronze and Ebony

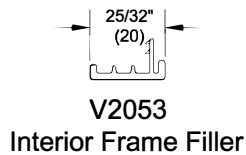

Elevate and Essential Exterior Casing Elevations

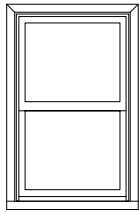

BMC - Flush
With Sill Nosing

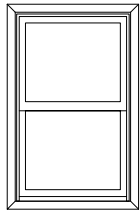

BMC - Mitered
Casing Four Sides

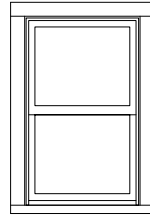

Flat Casing - Flush
With Sill Nosing

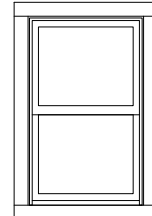

Flat Casing - Flush
Casing Four Sides

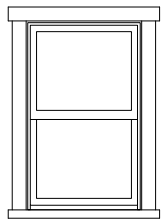

Flat Casing - Ranch Style
With Sill Nosing

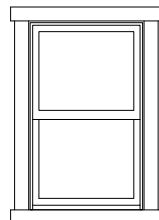

Flat Casing - Ranch Style
Casing Four Sides

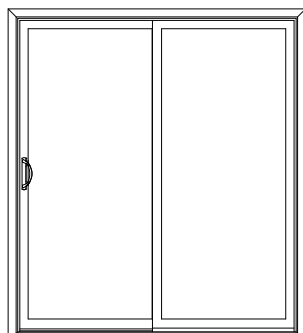

BMC

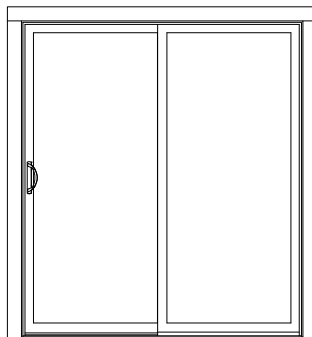

Flat

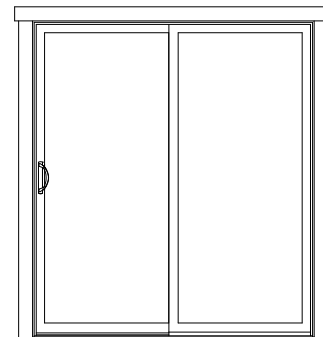

Ranch Style

NOTE: Ranch Style casing overhangs each side by 1" (25)

Elevate and Essential Exterior Casing Profiles and Parts

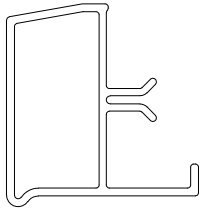

F9107
Sill Nosing - 2"

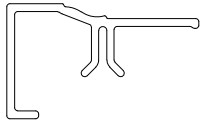

F9105
BMC - 2"

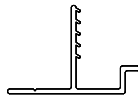

V2177
Elevate
Connection Barb

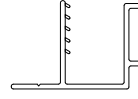

V2691
Essential
Connection Barb

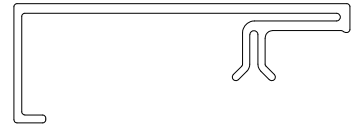

F9108
Flat Casing - 3.5"

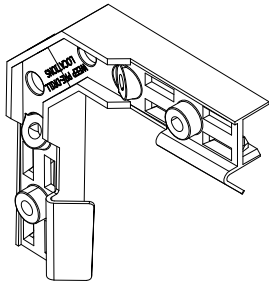

Exterior Casing
Corner Key

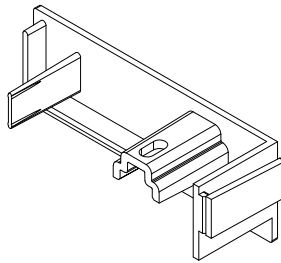

End Cap
Flat Casing, 3.5"

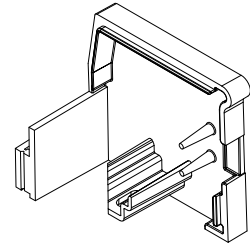

End Cap
Sill



#7 X .750" Type A-17 PH full thread



Reticulated Foam
.625" X .625"

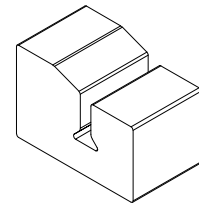

BMC
Plug

Elevate Exterior Casing Measurement Conversions

Frame Outside Measurement (Elevate) to Exterior Casing Individual Part Finished Overall Length		
Elevate Windows		
Exterior Casing Configuration	Part	WU Conversion
BMC (all four sides)	Header & Sill 45° end cuts	+ 3 3/8"
	Jambs 45° end cuts	+ 3 3/8"
BMC w/ Sill Nosing	Header 45° end cuts	+ 3 3/8"
	Sill 90° end cuts	+ 2 7/8"
	Jambs 45° end cuts on header end 90° end cuts on sill end	+ 1 3/8"
3.5" Flat Casing (all four sides)	Header & Sill 90° end cuts	+ 6 7/32"
	Jambs 90° end cuts	- 5/8"
3.5" Flat Casing w/ Sill Nosing	Header 90° end cuts	+ 6 7/32"
	Sill 90° end cuts	+ 5 7/8"
	Jambs 90° end cuts	- 5/8"
3.5" Flat Casing - Ranch Style	Header & Sill 90° end cuts	+ 8 7/32"
	Jambs 90° end cuts	- 5/8"
3.5" Flat Casing - Ranch Style w/ Sill Nosing	Header 90° end cuts	+ 8 7/32"
	Sill 90° end cuts	+ 7 7/8"
	Jambs 90° end cuts	- 5/8"
Elevate Doors		
Exterior Casing Configuration	Part	WU Conversion
BMC	Header 45° end cuts	+ 3 3/8"
	Jambs 45° end cuts on header end 90° end cuts on sill end	+ 1 11/16"
3.5" Flat Casing	Header 90° end cuts	+ 6 7/32"
	Jambs 90° end cuts	- 3/8"
3.5" Flat Casing - Ranch Style	Header 90° end cuts	+ 8 7/32"
	Jambs 90° end cuts	- 3/8"
Frame Outside Measurement (Wood Ultrex) to Exterior Casing Outside Measurement Conversion		
Elevate Windows		
Exterior Casing Configuration	Width	Height
BMC (all four sides)	+ 3 3/8"	+ 3 3/8"
BMC w/ Sill Nosing	+ 3 3/8"	+ 3 3/8"
3.5" Flat Casing (all four sides)	+ 6 3/8"	+ 6 3/8"
3.5" Flat Casing w/ Sill Nosing	+ 6 3/8"	+ 4 7/8"
3.5" Flat Casing — Ranch Style	+ 8 3/8"*	+ 6 3/8"
3.5" Flat Casing — Ranch Style w/ Sill Nosing	+ 8 3/8"*	+ 4 7/8"
Elevate Doors		
Exterior Casing Configuration	Width	Height
BMC (header & jambs)	+ 3 3/8"	+ 1 11/16"
3.5" Flat Casing (header & jambs)	+ 6 3/8"	+ 3 3/16"
3.5 Flat Casing — Ranch Style (header & jambs)	+ 8 3/8"*	+ 3 3/16"
* Ranch Style header overhangs each jamb & does not have square or rectangle outer shape — see diagrams on page 6		

Essential Exterior Casing Measurement Conversions

Frame Outside Measurement (Essential) to Exterior Casing Individual Part Finished Overall Length		
Essential Windows		
Exterior Casing Configuration	Part	AU Conversion
BMC (all four sides)	Header & Sill 45° end cuts	+ 3 11/16"
	Jambs 45° end cuts	+ 3 11/16"
BMC w/ Sill Nosing	Header 45° end cuts	+ 3 11/16"
	Sill 90° end cuts	+ 3 3/16"
	Jambs 45° end cuts on header end 90° end cuts on sill end	+ 1 11/16"
3.5" Flat Casing (all four sides)	Header & Sill 90° end cuts	+ 6 17/32"
	Jambs 90° end cuts	- 5/16"
3.5" Flat Casing w/ Sill Nosing	Header 90° end cuts	+ 6 17/32"
	Sill 90° end cuts	+ 6 3/16"
	Jambs 90° end cuts	- 5/16"
3.5" Flat Casing - Ranch Style	Header & Sill 90° end cuts	+ 8 17/32"
	Jambs 90° end cuts	- 5/16"
3.5" Flat Casing - Ranch Style w/ Sill Nosing	Header 90° end cuts	+ 8 17/32"
	Sill 90° end cuts	+ 8 3/16"
	Jambs 90° end cuts	- 5/16"
Essential Doors		
Exterior Casing Configuration	Part	AU Conversion
BMC	Header 45° end cuts	+ 3 11/16"
	Jambs 45° end cuts on header end 90° end cuts on sill end	+ 1 27/32"
3.5" Flat Casing	Header 90° end cuts	+ 6 17/32"
	Jambs 90° end cuts	- 1/4"
3.5" Flat Casing - Ranch Style	Header 90° end cuts	+ 8 17/32"
	Jambs 90° end cuts	- 1/4"

Frame Outside Measurement (All-Ultrex) to Exterior Casing Outside Measurement Conversion		
Essential Windows		
Exterior Casing Configuration	Width	Height
BMC (all four sides)	+ 3 11/16"	+ 3 11/16"
BMC w/ Sill Nosing	+ 3 11/16"	+ 3 11/16"
3.5" Flat Casing (all four sides)	+6 11/16"	+6 11/16"
3.5" Flat Casing w/ Sill Nosing	+6 11/16"	+5 3/16"
3.5" Flat Casing — Ranch Style	+8 11/16"*	+6 11/16"
3.5" Flat Casing — Ranch Style w/ Sill Nosing	+8 11/16"*	+5 3/16"
Essential Doors		
Exterior Casing Configuration	Width	Height
BMC (header & jambs)	+3 11/16"	+1 13/16"
3.5" Flat Casing (header & jambs)	+6 11/16"	+3 11/32"
3.5 Flat Casing — Ranch Style (header & jambs)	+8 11/16"*	+3 11/32"

* Ranch Style header overhangs each jamb & does not have square or rectangle outer shape — see diagrams on page 6

Elevate and Essential Exterior Casing Applications for Windows

Direct Glaze Double Hung Polygon with BMC and Sill Casing

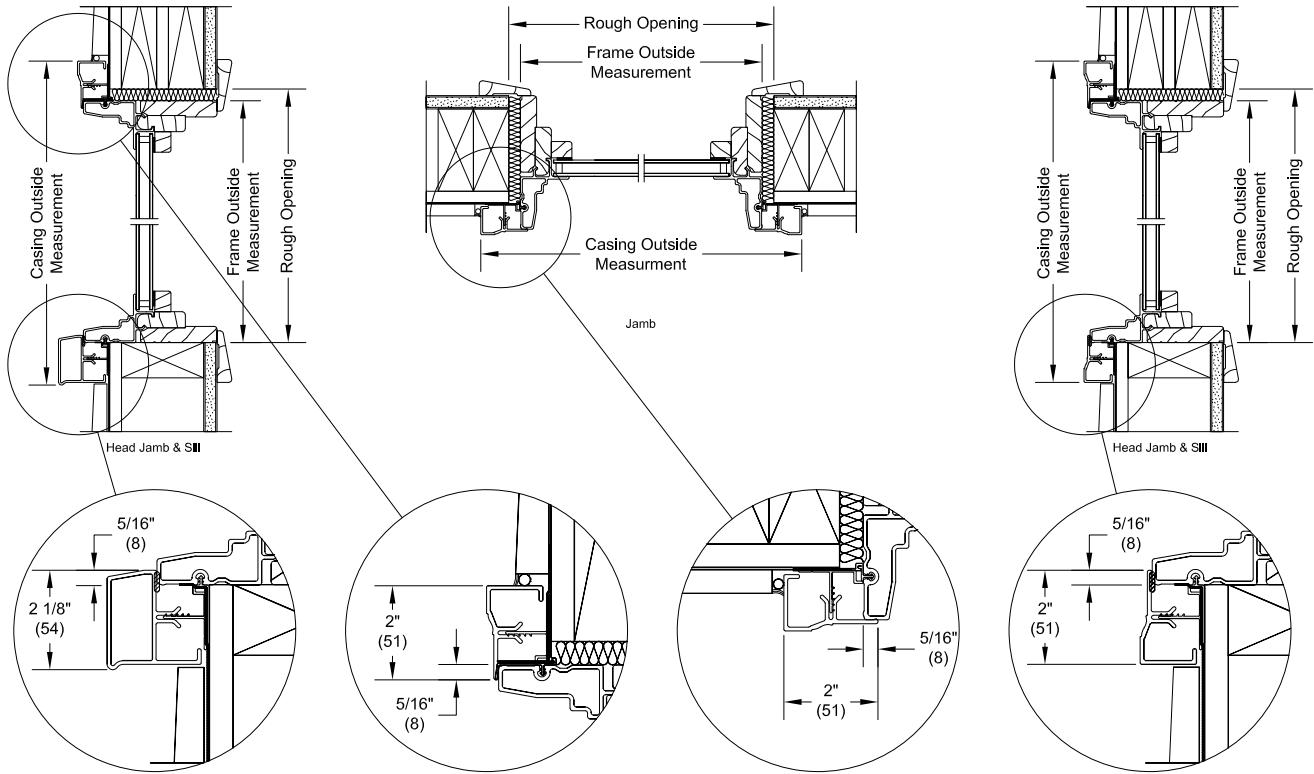

NOTE: Installation requires a minimum of 1" (25). Projections greater than 1" (25) may require connection bars to be shimmed away from sheeting for compensation.

Direct Glaze Double Hung Polygon with Flat Casing and Sill Casing

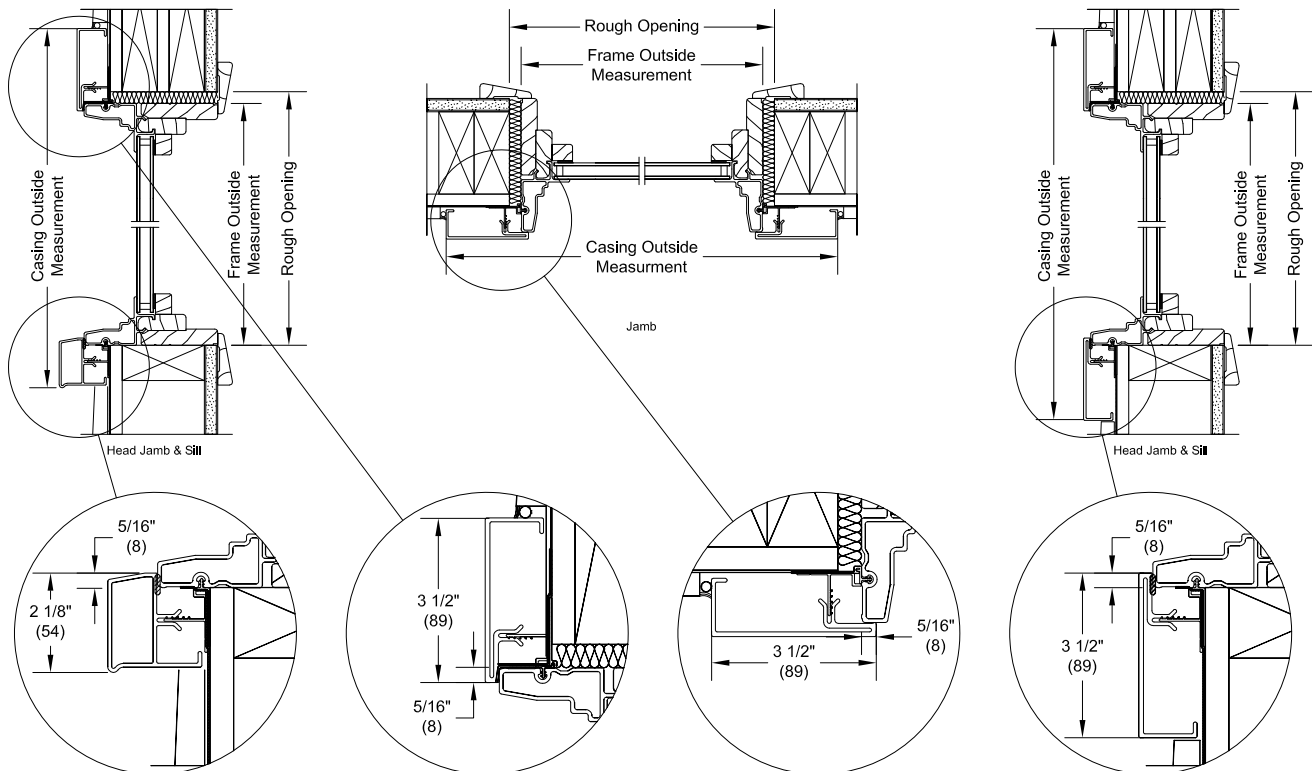

NOTE: The 5/16" measurement shown is for Elevate. The dimension for Essential is 5/32".

Elevate and Essential Exterior Casing Applications for Doors

ELSFD with BMC

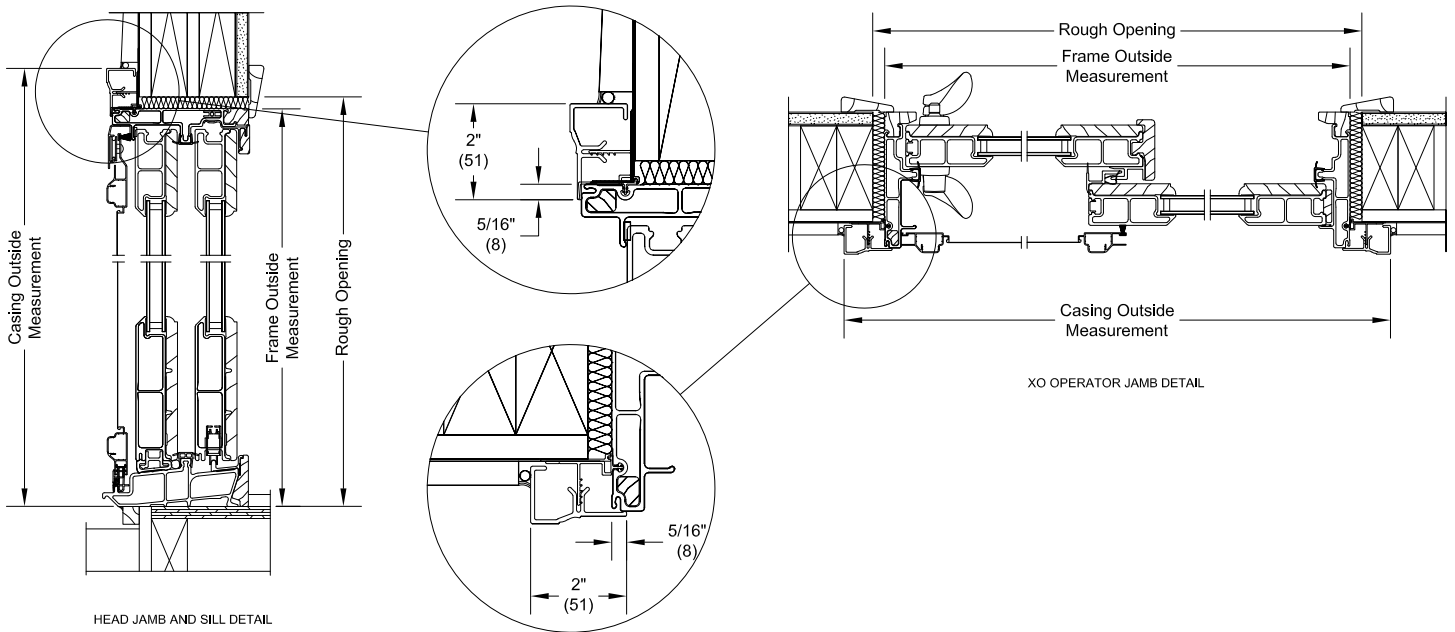

NOTE: Installation requires a minimum of 1" (25). Projections greater than 1" (25) may require connection bars to be shimmed away from sheeting for compensation.

ELSFD with Flat Casing

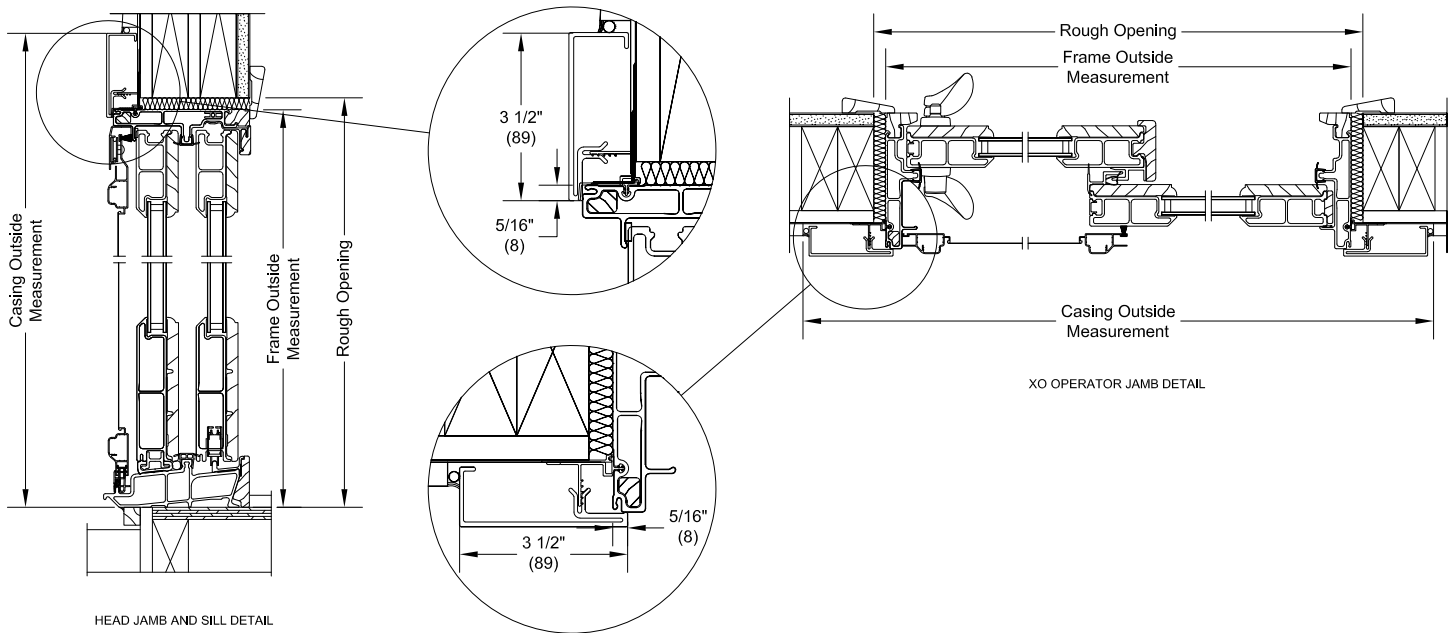

The 5/16" measurement shown is for Elevate. The dimension for Essential is 5/32".