



Ultimate Double Hung and Single Hung Insert G2

Replacement Parts

Specifications and technical data are subject to change without notice.

Numbers listed in () parentheses are metric equivalents in millimeters rounded to the nearest whole number.

Suggested fasteners are not included and must be ordered separately.

Illustrations are not to scale.

Contents

Product History.....	2
Part Identification - Ultimate Double/Single Hung Insert - Head Jamb/Sill	3
Part Identification - Ultimate Double/Single Hung Insert - Jambs.....	4
Part Identification - Ultimate Double/Single Hung - LSS and Lift Lock Options.....	5
Part Identification - Ultimate Double Hung Insert G2 - Picture	6
Part Identification - Ultimate Double Hung Insert G2 - Transom	7
Installation Parts.....	8
Miscellaneous Parts	9
Lock Status Sensor Parts.....	18
WOCD Field Applied and Replacement Parts	19
Jamb Liner.....	20
Balance Tubes - Block and Tackle	21
Balance Tubes - Spiral.....	22
Balance Tubes - Spiral - UL Series.....	23
Balance Tubes - Spiral - ULX Series	28
Default Vinyl Match for Interior Finishes and Aluminum Exterior	30
Aluminum Parts	31
Wood Parts.....	33
Weather Strip	35
Screen Replacement and Parts	36
Retractable Screen Parts - Configured Parts in OMS	38
Retractable Screen Parts.....	39
Retractable Screen Parts - No Longer Available (DISC NA).....	42
Tools	43

Produced	Unit Type	Features and Changes
2018	Ultimate Double Hung Insert G2 Ultimate Single Hung Insert G2	8/27/2018: Introduced the Ultimate Double Hung/Single Hung Insert G2. The Ultimate Double Hung/Single Hung Insert G2 will provide customers with a narrow jamb insert window that is designed to be installed into an existing window frame in replacement construction.
2020	Ultimate Double Hung Insert G2	4/27/2020: Added WOCD Field Applied and Replacement Kits (see Product Bulletin 758).
2021	All	10/25/2021: Standard screen mesh changed to Marvin Bright View™. See Product Bulletin 793 for more details.
2022	All	06/27/2022: The Aluminum Screen will be the standard for units with a frame size height of $\leq 54 \frac{1}{2}$ ", with an option of the Extruded Aluminum Screen available. The standard screen for any unit with a frame size height $> 54 \frac{1}{2}$ " will be the Extruded Aluminum Screen. This improvement to screen frames includes all Ultimate and Ultimate Wood windows that accept an aluminum screen, including Round Top and Polygon shapes. See Product Bulletin 832 for more details.
		10/24/2022: With OMS version 3.17, V2839 Header Weather Strip, will only be available in Black. White and Beige part numbers in OMS Retail have been directed to use only Black. Beige and White part number have been removed from the Replacement Parts section. See Product Bulletin #847 for more details.
2023	All	04/24/2023: The Retractable Screen was moved to Discontinued - No Availability (DISC-NA). See Product Bulletin 873 for more information.
	Ultimate Double Hung Insert G2 Ultimate Single Hung Insert G2	10/30/2023: An ERS coating became available as a standard option for current Triple Pane offerings. See Product Bulletin 904 for more details.

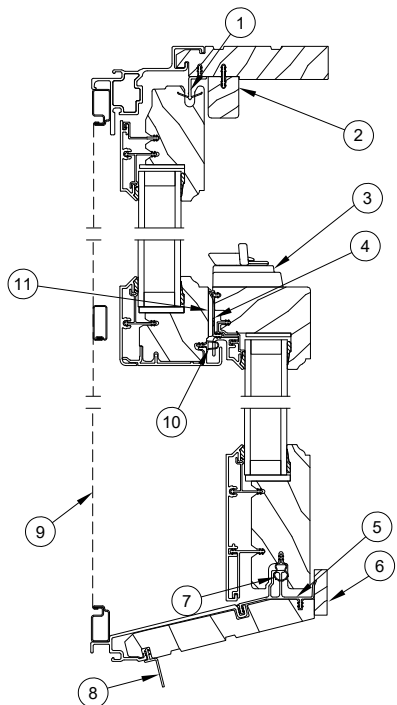

Head Jamb and 14 Degree Sill
Vertical Detail

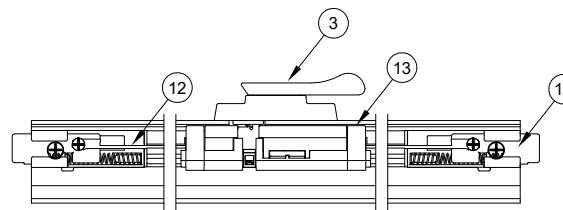

Check Rail

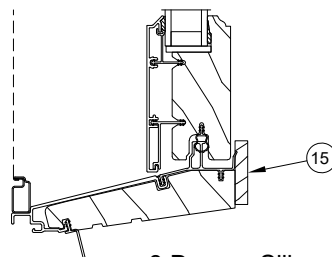

8 Degree Sill

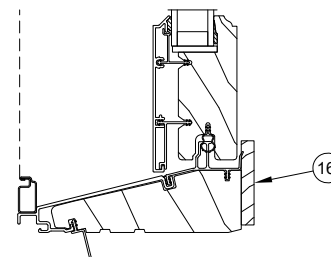

Flat Degree Sill

- | | |
|--|--|
| 1. Head Jamb Weather Strip, V2839 | 9. Full Screen Assembly |
| 2. Parting Stop, W11578 | 10. Top Check Rail Weather Strip, V2803 |
| 3. Sash Lock | 11. Strike Assembly |
| 4. Bottom Check Rail Hardware Cover, V2478 | 12. Operation Cord |
| 5. Sill Thermal Break, V2191 | 13. Cord Guide Assembly |
| 6. Sill Liner, 14 Degree, W12515 | 14. Bottom Sash Latch Assembly |
| 7. Weather Strip, V2779 | 15. Sill Liner, 8 Degree, W11576 |
| 8. Sill Fin, V1007 | 16. Sill Liner, 0 Degree Flat Sill, W12595 |

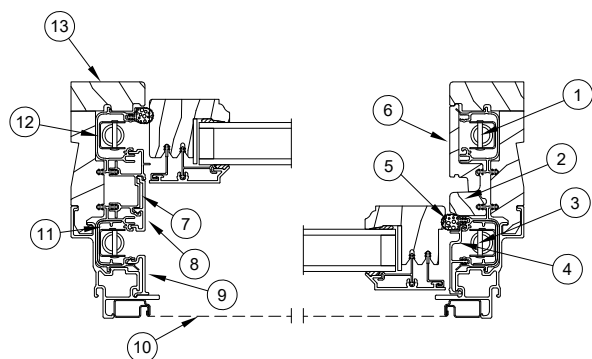

Double Hung
Jamb Detail

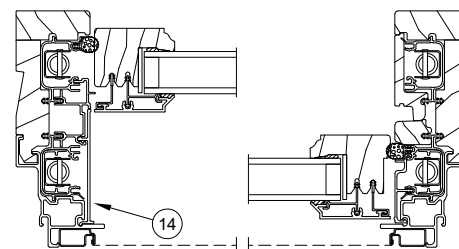

Single Hung
Jamb Detail

1. Bottom Sash Balance Tube
2. Fixed Interior Jamb Cover, W13094
3. Top Sash Balance Tube
4. Exterior Hardware Cover, V2338
5. Frame Weather Strip, V2682
6. Interior Jamb Cover, Removable, W13093
7. Mid Cover Base, V2432

8. Mid Exterior Cover, A2460
9. Exterior Cover, A2615
10. Full Screen Assembly
11. Exterior Sash Stop, V2257
12. Vinyl Jamb Liner, V2655
13. Jamb Liner, W12511
14. Exterior Cover, Single Hung, A2700

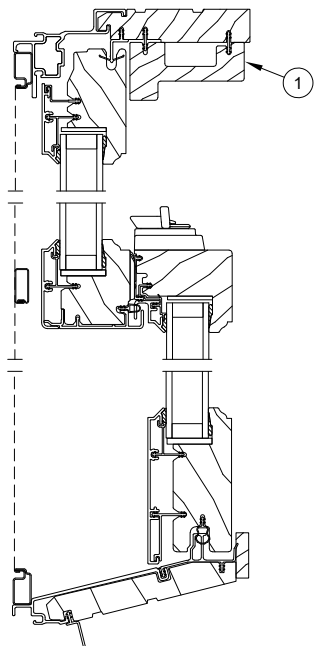

Head Jamb and Sill
With Lock Status Sensor

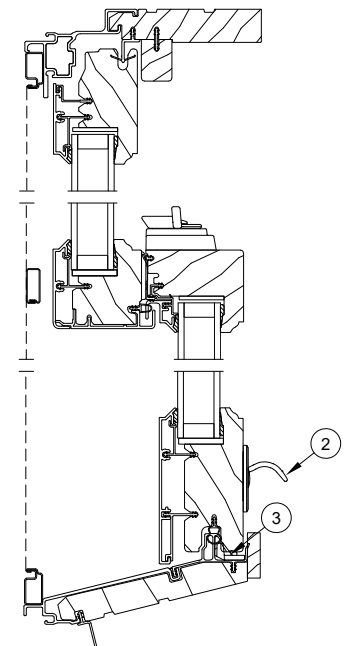

Head Jamb and Sill
Lift Lock (Single Hung Only)

- 1. Transmitter Cover, W12982
- 2. Lift Lock Assembly
- 3. Lift Lock Strike

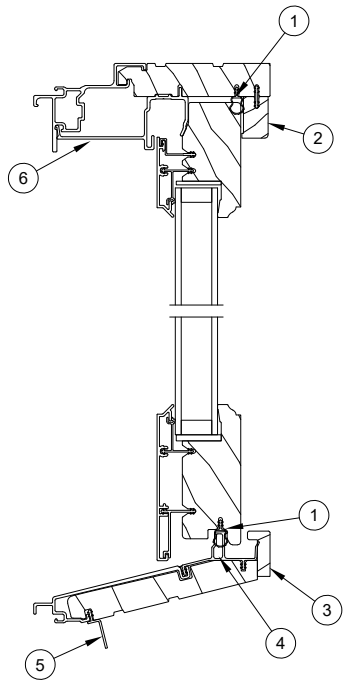

Head Jamb and 14 Degree Sill
Vertical Detail

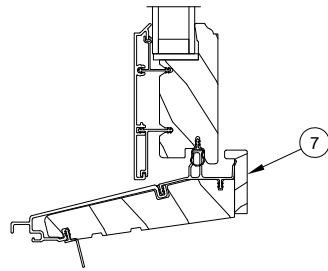

8 Degree Sill
Vertical Detail

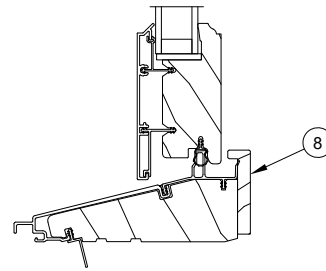

0 Degree Flat Sill
Vertical Detail

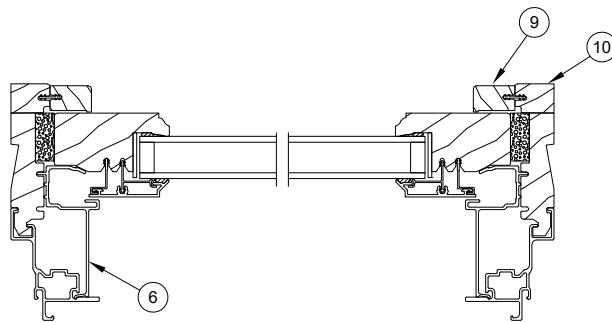

Jamb
Horizontal Detail

1. Weather Strip, V2779
2. Picture Stop, W12407
3. Sill Liner, 14 Degree, W12566
4. Sill Thermal Break, V2191
5. Sill Fin, V1007
6. Picture Exterior Cover, A3077
7. Sill Liner, 8 Degree, W11825
8. Sill Liner, 0 Degree, W12597
9. Picture Stop, W12407
10. Picture Jamb Liner, W12569

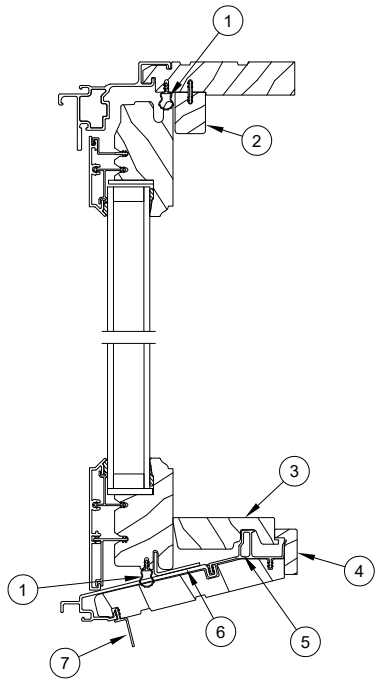

Head Jamb and 14 Degree Sill
Vertical Detail

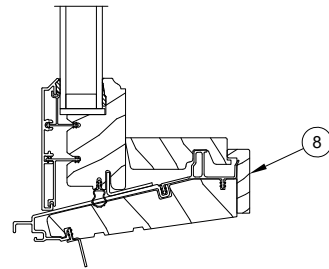

8 Degree Sill
Vertical Detail

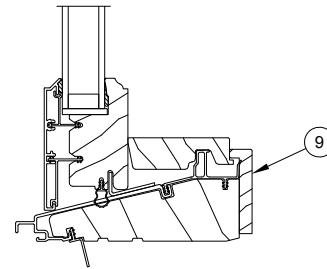

0 Degree Flat Sill
Vertical Detail

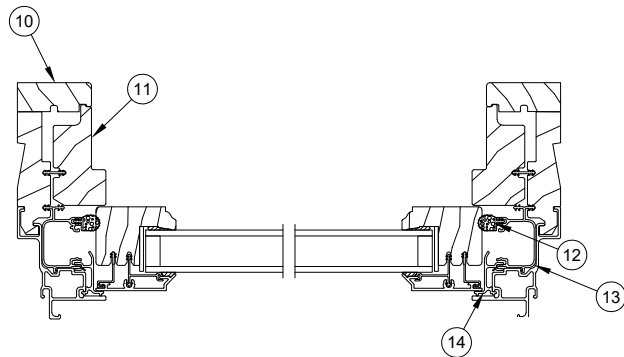

Jamb
Horizontal Detail

1. Weather Strip, V2779
2. Parting Stop, W11578
3. Transom Sill Filler, W12061
4. Sill Liner, 14 Degree, W12566
5. Sill Thermal Break, V2191
6. Transom Sill Bracket
7. Sill Fin, V1007
8. Sill Liner, 8 Degree, W11825
9. Sill Liner, 0 Degree, W12597
10. Jamb Liner, W12511
11. Interior Transom Cover, W11906
12. Jamb Weather Strip, V2682
13. Vinyl Jamb Liner, V2655
14. Spacer, V2573

Replacement Installation Kit

Includes:

- 1- Installation screw package (qty of 6 or 10 screws)
- Jamb hole plugs (quantity dependent upon unit configuration, type is dependent upon exterior finish)
- 2 - Interior sash stops

NOTE:

Please contact your Marvin representative with the original order and line number to order.

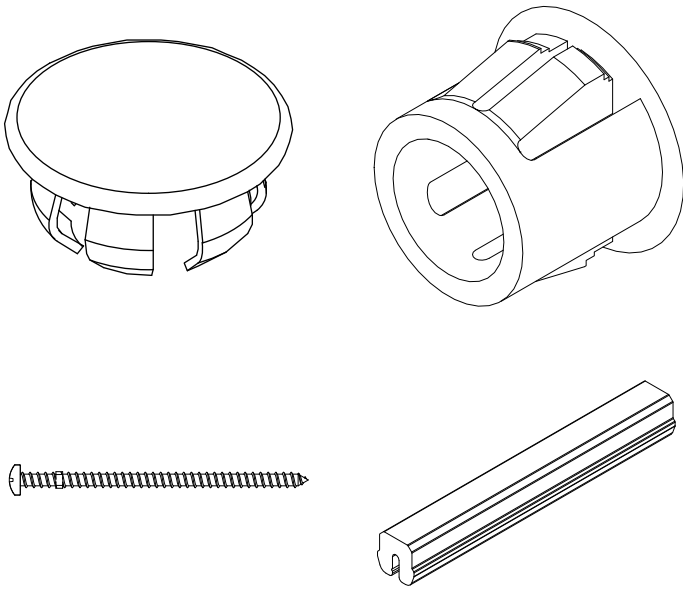

Installation Screw

#8x3 T-20 Torx head

Quantity	PN
6	11101788
10	11101787

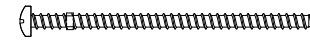

Sash Installation Kit

NOTE: For use with A3077 Exterior Filler

Includes:

- 24 - #9x1 5/8" Torx flat head screws
- 1 - T-20 Insert Bit
- 1 - Instruction

PN
11869268

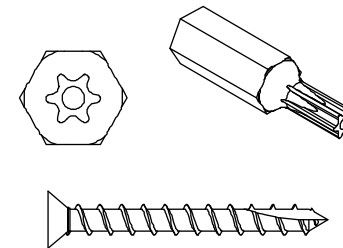

Tilt/Non-Tilt Lock Handle Kit

Includes:

- 1- Lock handle
- 2 - #7 x 1 1/4" color match wood screws

Lock Handle Kit	
Color	PN
Bronze	11851402
Satin Taupe	11851400
White	11851401
Antique Brass	11851403
Brass	11851404
Oil Rubbed Bronze	11851405
Polished Chrome	11851406
Satin Chrome	11851407
Satin Nickel	11851408
Matte Black	11851409

Color Matched Screw	
Color	PN
Bronze	11807118
Satin Taupe	11807122
White	11807115
Antique Brass	11807126
Brass	11807120
Oil Rubbed Bronze	11807132
Polished Chrome	11807128
Satin Chrome	11807127
Satin Nickel	11807133
Matte Black	11807137

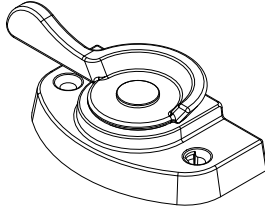

Tilt/Non-Tilt Lock Handle Kit - Custodial

Includes:

- 1 - Lock handle
- 2 - #7 x 1 1/4" color match wood screws
- 1 - Tamper resistant screw kit

Custodial Lock Handle Kit	
Color	PN
Bronze	11869277
Satin Taupe	11869275
White	11869276
Matte Black	11869278

Color Matched Screw	
Color	PN
Bronze	11807118
Satin Taupe	11807122
White	11807115
Matte Black	11807137

Tamper Resistant Screw Kit (each)	
Color	PN
Bronze	11800430
Satin Taupe	11800428
White	11800429
Matte Black	11800432

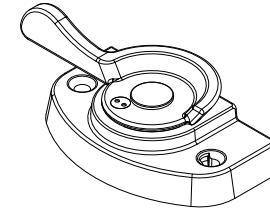

Catch Spring

PN
10501214

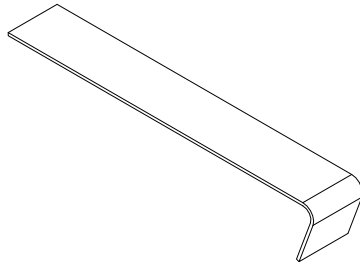

Tool Bit - Tamper Resistant Screw (#4 Spanner Bit)

PN
10500543

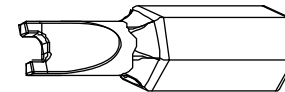

Sash Lift Kit

Includes:

- 1 - Sash lift
- 2 - #8 x 1" slotted oval head sheet metal screws

NOTE: Can not be used with retractable screen.

Color	PN
Bronze	10500557
Satin Taupe	10500598
White	10500556
Antique Brass	10500597
Brass	10500558
Oil Rubbed Bronze	10500601
Polished Chrome	10500595
Satin Chrome	10500596
Satin Nickel	10500602
Matte Black	10500577

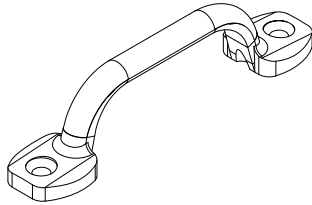

Lift Lock Assembly - Traditional

Single Hung only

Color	PN
Bronze	10501855
Satin Taupe	10501856
White	10501857
Antique Brass	10501860
Brass	10501861
Oil Rubbed Bronze	10501859
Polished Chrome	10501864
Satin Chrome	10501863
Satin Nickel	10501862
Matte Black	10501858

Suggested Fasteners	
2 - #7 x 1" Phillips pan head screws	11800196

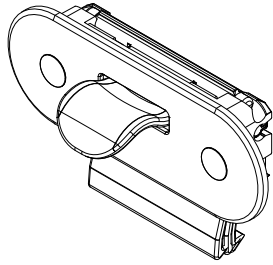

Lift Lock Assembly - Contemporary

Single Hung only

Color	PN
Bronze	10501866
Satin Taupe	10501867
White	10501868
Antique Brass	10501871
Brass	10501872
Oil Rubbed Bronze	10501870
Polished Chrome	10501875
Satin Chrome	10501874
Satin Nickel	10501873
Matte Black	10501869

Suggested Fasteners	
2 - #7 x 1" Phillips pan head screws	11800196

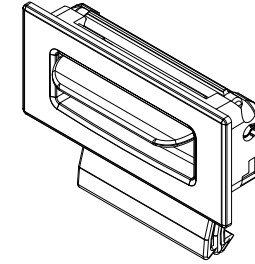

Lift Lock Assembly - Custodial

Single Hung only

Uses (not included):

- #4 Spanner Bit
- 1 - Custodial screw kit (color match)
- 2 - #7x1" Phillips pan head screws

Color	PN
Bronze	10501876
Satin Taupe	10501877
White	10501878
Matte Black	10501879

Suggested Fasteners	
2 - #7 x 1" Phillips pan head screws	11800196

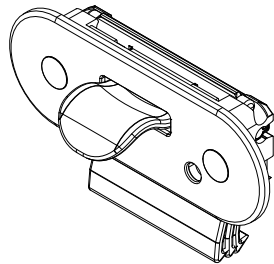

Lift Lock Assembly - Custodial Screw Kit

Single Hung only

Includes:

- 2 - 4-40 flat head machine screws

Color	PN
Bronze	11869256
Satin Taupe	11869254
White	11869255
Matte Black	11869257

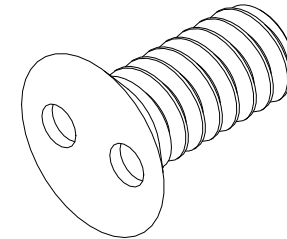

Lift Lock Sill Strike

Single Hung only

Color	PN
White	10501880
Black	10501881
Beige	10501882

Suggested Fasteners	
2 - #7 x 9/16" Phillips pan head screws	
Color	PN
White	11800194
Black	11800193
Beige	11800195

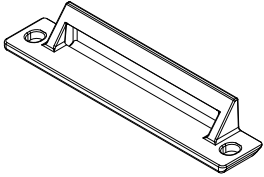

Both Sash Stationary Kit

Single Hung only

Includes:

- 2 – Stop, both sash stationary,
- 2 – #6 x 1 1/4 tamper resistant screw
- 1 – #6 spanner bit
- 1 – Instruction

Color	PN
Beige	11850200
White	11850202
Black	11850201

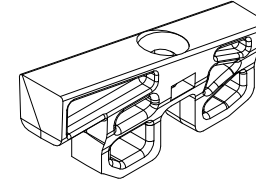

Foam Pad Sill

Color	PN
Black	15350024

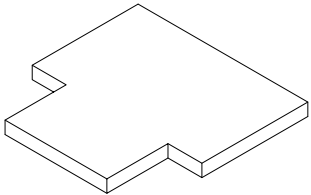

Jamb Filler Foam

Length	Color	PN
Specify LF	Black	15350016

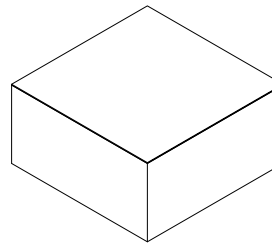

Bottom Sash Latch Assembly

Single Hung only

Handing	PN
LH	10501463
RH	10501464

Suggested Fasteners	PN
1 – #6x1" Phillips flat head screw	11800660
1 – #8x1 1/4" Phillips pan head screw	11800557

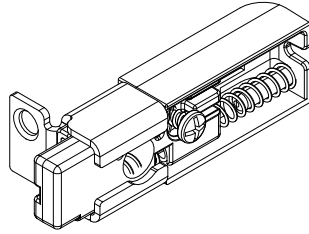

RH shown

Bottom Sash Manual Latch Assembly, Lift Lock

Single Hung only

Color	LH PN	RH PN
Beige	10501508	10501509
White	10501505	10501506
Black	10501511	10501512

Suggested Fasteners	PN
1 – #6x1" Phillips flat head screw	11800660
1 – #8x1 1/4" Phillips pan head screw	11800825
1 – #6x 5/8" Phillips pan head screw	11801625

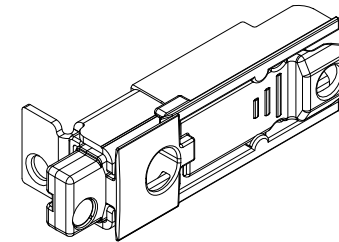

RH shown

Bottom Sash Manual Latch Assembly, Lift Lock with Lock Status Sensor

Single Hung only

Color	PN
Beige	10501510
White	10501507
Black	10501513

Suggested Fasteners	PN
1 – #6x1" Phillips flat head screw	11800660
1 – #8x1 1/4" Phillips pan head screw	11800825
1 – #6x 5/8" Phillips pan head screw	11801625

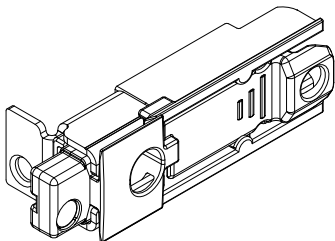

RH shown

Top Sash Tilt Latch Assembly

Color	PN
Beige	10500779

Suggested Fasteners	PN
1 – #6x1 1/2" Phillips flat head screw	11800133

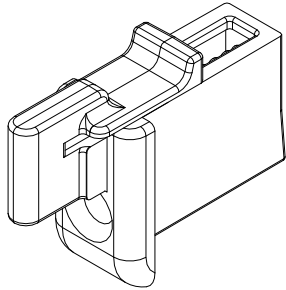

Bottom Sash Tilt Pin

Handing	PN
LH	10500762
RH	10500763

Suggested Fasteners	PN
2 – #7x1 1/4" Phillips flat head wood screws	11806108

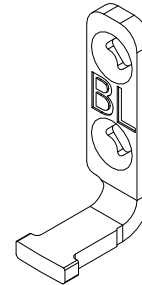

LH shown

Cord Guide Assembly Bottom Sash

Lineal length of cord included.

Color	PN
Beige	10501215
White	10501216
Black	10501217

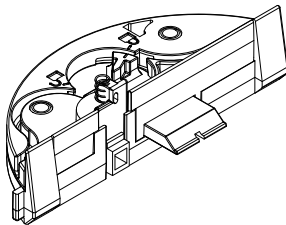

Top Sash Tilt Pin

Handing	PN
LH	10500775
RH	10500776

Suggested Fasteners	PN
2 – #7x3/4" Phillips flat head wood screws	02050321

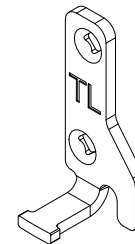

LH shown

Strike Assembly Kit

Includes:

- 1 - Strike base
- 1 - Button
- 2 - Color matched wood screws

Strike Assembly Kit	
Color	PN
Bronze	11851412
Satin Taupe	11851410
White	11851411
Antique Brass	11851413
Brass	11851414
Oil Rubbed Bronze	11851415
Polished Chrome	11851416
Satin Chrome	11851417
Satin Nickel	11851418
Matte Black	11851419

#7 x 7/8" Wood Screw	
Color	PN
Bronze	11807879
Satin Taupe	11807880
White	11807875
Antique Brass	11807883
Brass	11807882
Oil Rubbed Bronze	11807878
Polished Chrome	11807885
Satin Chrome	11807884
Satin Nickel	11807881
Matte Black	11807886

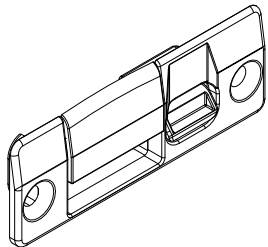

Clutch Assembly

Color	PN
Black	10501430

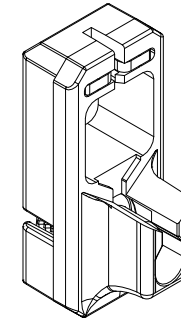

Jamb Adjustment Screw

Color	PN
Black	10501518

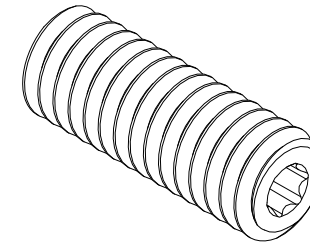

Interior Sash Stop

V2399

Length	Color	PN
2 1/2" (64)	White	15709400
	Beige	15709402
	Black	15709401

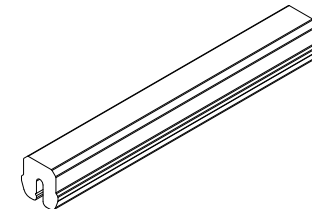

Jamb Hole Plug, Insert, Painted Brass

NOTE: Type is dependent on Exterior Color

Color	PN
Wineberry	11882870
Hampton Sage	11882890
Cascade Blue	11882888
Cadet Gray	11882886
Coconut Cream	11882884
Bright Silver	11882880
Liberty Bronze	11882860
Clay	11882866
Suede	11882864
Gunmetal	11882862

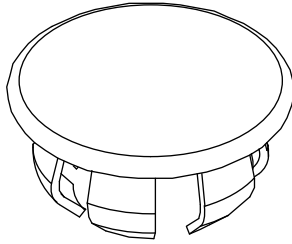

Jamb Hole Plug, Insert, Painted Brass

NOTE: Type is dependent on Exterior Color

Color	PN
Stone White	11882868
Bronze	11882668
Pebble	11882568
Bahama Brown /Copper	11882468
Evergreen	11882768
Black or Ebony	11882168
Cashmere	11882269
Sierra	356868

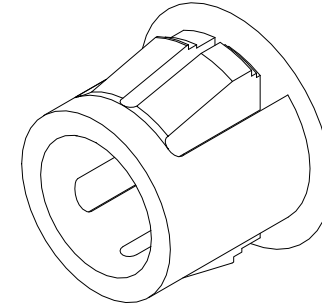

Jamb Receiver Assembly

Includes:

Foam gasket and pile weather strip

Color	Handing	PN
Black	LH	10500765
	RH	10500766

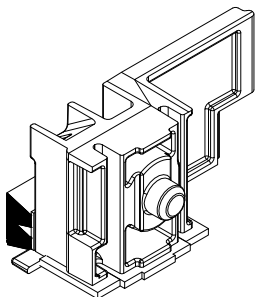

RH shown

Bottom Sash Limiter

NOTE: 2 needed per unit

Color	PN
White	10501517
Beige	10501515
Black	10501516

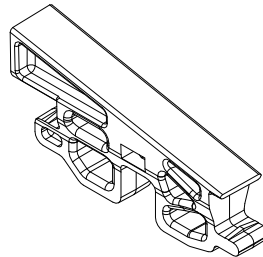

Transom Sill Bracket

Color	PN
Stainless Steel	10500768

Suggested fasteners	PN
2 – #7x3/4" Phillips flat head screw	02050321

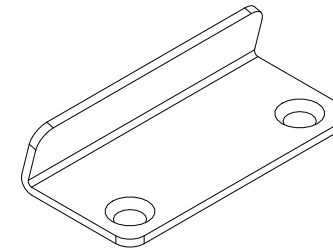

Exterior Sash Lug Retainer, Ogee Profile

Includes:

- 2 – Exterior Sash Lugs – Ogee Profile
- 2 – Exterior Sash Lug Retainers
- 2 – #8–15x3/4" Full thread 410 Stainless Steel screw (11800208)

Color	PN
Sierra White	11894166
Hampton Sage	11894165
Cascade Blue	11894164
Coconut Cream	11894162
Cashmere	11894160
Ebony	11894159
Wineberry	11894157
Stone White	11894155
Evergreen	11894154
Bronze	11894153
Pebble	11894152
Bahama Brown	11894151
Cadet Gray	11894163
Bright Silver	11894168
Copper	11894167
Liberty Bronze	11894171
Clay	11894174
Gunmetal	11894172
Suede	11894173

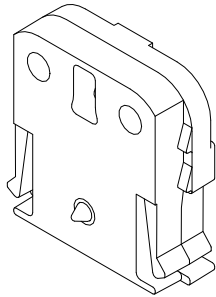

Exterior Sash Lug Retainers

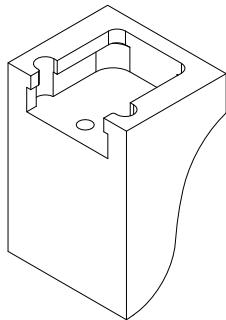

Exterior Sash Lug,
Ogee Profile

Exterior Sash Lug Retainer

Color	PN
Black	10500769

Suggested fasteners	PN
1 – #8–15x3/4" Full thread 410 Stainless Steel screw	11800208

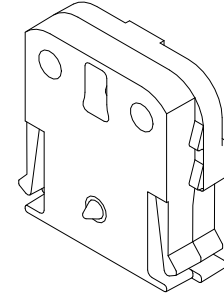

Wire Connector, IDC

NOTE: Holes sized for 22AWG Wire

PN
10501825

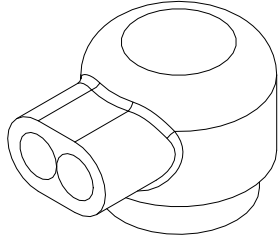

Magnet Housing Assembly

Includes:

- 1- Magnet 1/4" x 1/8" N42
- 1- Magnet Housing

Color	PN
Black	10501834
White	10501835

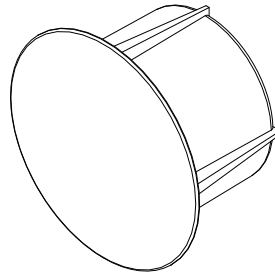

Bottom Sash Latch Assembly

NOTE: Used to make compatible with Lock Status Sensor. Cannot be purchased separately, must be included in the assembled version.

Handing	PN
RH only	10501474

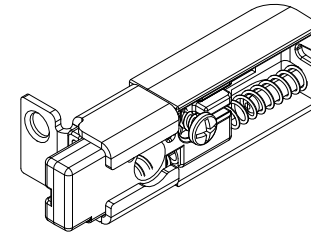

RH shown

Jamb Receiver, Firecracker

Handing	Color	PN
RH only	Black	10500719

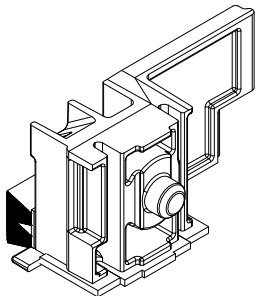

.245 x 1.000 Firecracker Reed Switch

Length	Color	PN
72"	Black	10501827

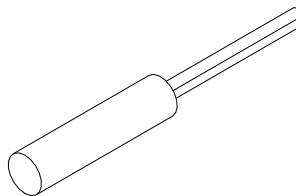

When ordering Wood Replacement Parts, specify:

1. Profile number
2. Unit type
3. Length
4. Finish
5. Species (if applicable)

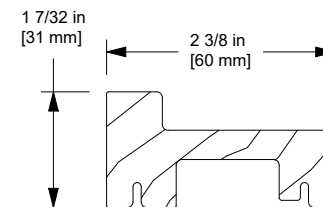

Lock Status Sensor
Transmitter Cover, W12982

NOTE: For windows without factory-applied WOCD, refer to Product Bulletin 758 for more information.

WOCD Field Applied and Replacement Kit, Top Sash

Includes:

- 2 – WOCD Assembly
- 4 – #8 x 1" Phillips flat head screw, full thread
- 1 – WOCD Safety information
- 1 – WOCD Field applied instructions
- 1 – WOCD Hang tag

Color	PN
Satin Taupe	11850690
White	11850691
Bronze	11850692
Brass	11850693
Antique Brass	11850694
Polished Chrome	11850695
Satin Chrome	11850696
Oil Rubbed Bronze	11850697
Satin Nickel	11850698
Matte Black	11850700

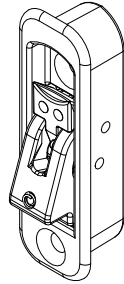

WOCD Field Applied and Replacement Kit, Complete

Ultimate Double Hung G2

Includes:

- 2 – WOCD Assembly
- 4 – #8 x 1" Phillips flat head screw, full thread
- 1 – WOCD Safety Information
- 1 – WOCD Field applied instructions
- 1 – WOCD Hang tag
- 1 – WOCD Sticker
- 1 – WOCD Bumper, RH, bottom check rail
- 1 – WOCD Bumper, LH, bottom check rail

WOCD Color	Bumper Color and Part Number		
	White	Beige	Black
Satin Taupe	11851530	11851540	11851550
White	11851531	11851541	11851551
Bronze	11851532	11851542	11851552
Brass	11851533	11851543	11851553
Antique Brass	11851534	11851544	11851554
Polished Chrome	11851535	11851545	11851555
Satin Chrome	11851536	11851546	11851556
Oil Rubbed Bronze	11851537	11851547	11851557
Satin Nickel	11851538	11851548	11851558
Matte Black	11851539	11851549	11851559

WOCD Field Applied and Replacement Kit, Bottom Sash

Includes:

- 1 – WOCD Bumper, RH, bottom check rail
- 1 – WOCD Bumper, LH, bottom check rail
- 1 – WOCD Safety information
- 1 – WOCD Field applied instructions
- 1 – WOCD Hang tag
- 1 – WOCD Sticker

Bumper Color	PN
White	11850706
Beige	11850707
Black	11850708

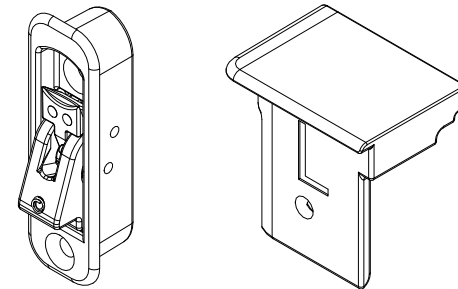
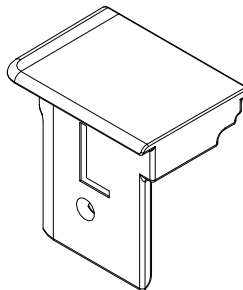

Vinyl Jamb Liner

V2655

NOTE: For units with retractable screens subtract 2" from Finish Overall height for the interior pieces.

To order replacement (use all that apply):

1. Provide the original order number and line number when possible
2. Color
3. Quantity
4. Glass height one sash (daylight opening + 1.25 for the height = glass height)
5. Measure both sash if they are not equal size.

NOTE: If experiencing operational difficulties please contact your Marvin Representative.

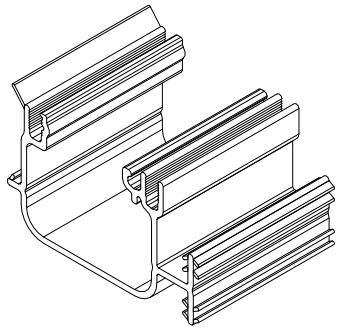

NOTE: Before ordering replacement balance tubes, please contact Marvin Inside Sales or a Customer Care Service Agent to have the balances recalculated.

Block and Tackle balance tubes with ID Code can be ordered by part number (see chart below).

1. Provide the original order number when possible. The ID code is imprinted on the tube (see illustration).
2. Specify top or bottom sash.
3. Specify quantity. Do NOT specify as pairs or sets. If one tube is needed, specify: quantity 1. If two tubes are needed, specify: quantity 2.

NOTE: If experiencing operational difficulties please contact your Marvin Representative.

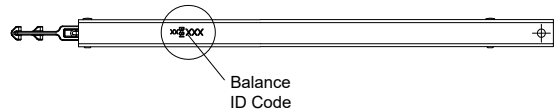

Balance Tube Assembly Part Numbers - Block and Tackle - Post 4/30/2018

Balance ID Code	Part #	Balance ID Code	Part #	Balance ID Code	Part #	Balance ID Code	Part #	Balance ID Code	Part #	Balance ID Code	Part #	Balance ID Code	Part #
A		B		C		D		E		F		G	
8A	10705008	8B	10705108	8C	10705208	16D	10710316	8E	10705408	28F	10710528	12G	10705616
12A	10705012	12B	10705112	12C	10705212	20D	10710320	12E	10705412	36F	10705536	24G	10710624
20A	10705020	16B	10705116	16C	10705216	32D	10710332	16E	10705416	FNU		32G	10705632
24A	10705024	24B	10705124	24C	10705224	40D	10710340	20E	10710420	12FNU	10709512	H	
36A	10705036	28B	10705128	32C	10710232	44D	10710344	40E	10710440			20H	10705720
44A	10705044	32B	10705132	44C	10705244	48D	10710348	48E	10710448				
52A	10705052	36B	10705136	52C	10705252	52D	10710352	ED					
AN		48B	10705148	54C	10705254	DD		16ED	10711416				
16AN	10709016	52B	10705152	CD		28DD	10711628	20ED	10711420				
28AN	10709028	54B	10705154	36CD	10705236	DN		24ED	10710424				
32AN	10709032	BN		CN		28DN	10711325						
36AN	10709036	20BN	10709120	20CN	10711220	DR							
40AN	10709040	36BN	10709136	24CN	10711224	24DR	10711524						
48AN	10709048	40BN	10709140	28CN	10711228								
		44BN	10709144										
		48BN	10709148										

The following info should be used to order ALL balances. Please add/fill in applicable info by product and options.

1. Unit size - RO, IO, GS ,CN - Width X Height / Equal Sash or Cottage
2. Balance for top sash
 - Specify quantity. Do NOT specify as pairs or sets.
3. Balance for bottom sash
 - Specify quantity. Do NOT specify as pairs or sets.
4. Glass Makeup (thickness of glass - if mixed panes, i.e. 3/16" and 1/8")
5. IG - 1 Lite
6. SDL (with or no spacer) / ADL / GBG - Lite Cuts
7. Wood species of the sash, if other than Pine
8. Sill angle if Insert product
9. Retractable screen (NG 1.0 and G2 product only)
10. Refer to original Marvin order number/line number
11. If unable to provide the above, provide as much info as possible
 - Sash weight for top and/or bottom sash

Original Spiral Balance Tube Label Information

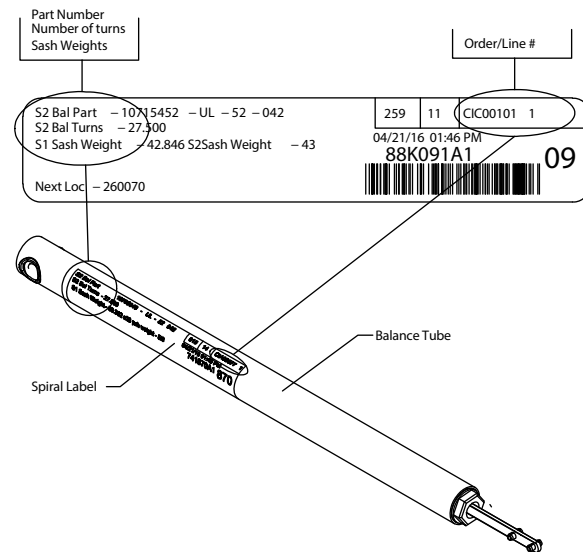

NOTE: Before ordering replacement balance tubes, please contact Marvin Inside Sales or a Customer Care Service Agent to have the balances recalculated.

Part Number	Balance ID Code	Length (In)
10715008	8-24	8
10715009	9-24	9
10715010	10-24	10
10715011	11-24	11
10715012	12-24	12
10715013	13-24	13
10715014	14-24	14
10715015	15-24	15
10715016	16-24	16
10715017	17-24	17
10715018	18-24	18
10715019	19-24	19
10715020	20-24	20
10715108	8-28	8
10715109	9-28	9
10715110	10-28	10
10715111	11-28	11
10715112	12-28	12
10715113	13-28	13
10715114	14-28	14
10715115	15-28	15
10715116	16-28	16
10715117	17-28	17
10715118	18-28	18
10715119	19-28	19
10715120	20-28	20

Part Number	Balance ID Code	Length (In)
10715208	8-32	8
10715209	9-32	9
10715210	10-32	10
10715211	11-32	11
10715212	12-32	12
10715213	13-32	13
10715214	14-32	14
10715215	15-32	15
10715216	16-32	16
10715217	17-32	17
10715218	18-32	18
10715219	19-32	19
10715220	20-32	20
10715309	9-37	9
10715310	10-37	10
10715311	11-37	11
10715312	12-37	12
10715313	13-37	13
10715314	14-37	14
10715315	15-37	15
10715316	16-37	16
10715317	17-37	17
10715318	18-37	18
10715319	19-37	19
10715320	20-37	20

Part Number	Balance ID Code	Length (In)
10715410	10-42	10
10715411	11-42	11
10715412	12-42	12
10715413	13-42	13
10715414	14-42	14
10715415	15-42	15
10715416	16-42	16
10715417	17-42	17
10715418	18-42	18
10715419	19-42	19
10715420	20-42	20
10715421	21-42	21
10715422	22-42	22
10715423	23-42	23
10715424	24-42	24
10715425	25-42	25
10715426	26-42	26
10715427	27-42	27
10715428	28-42	28
10715429	29-42	29
10715430	30-42	30
10715431	31-42	31
10715432	32-42	32
10715433	33-42	33
10715434	34-42	34
10715435	35-42	35

Part Number	Balance ID Code	Length (In)
10715436	36-42	36
10715437	37-42	37
10715438	38-42	38
10715439	39-42	39
10715440	40-42	40
10715441	41-42	41
10715442	42-42	42
10715443	43-42	43
10715444	44-42	44
10715445	45-42	45
10715446	46-42	46
10715447	47-42	47
10715448	48-42	48
10715449	49-42	49
10715450	50-42	50
10715451	51-42	51
10715452	52-42	52
10715453	53-42	53
10715454	54-42	54
10715455	55-42	55
10715456	56-42	56
10715457	57-42	57
10715458	58-42	58
10715459	59-42	59
10715460	60-42	60

NOTE: Before ordering replacement balance tubes, please contact Marvin Inside Sales or a Customer Care Service Agent to have the balances recalculated.

Part Number	Balance ID Code	Length (In)
10715512	12-47	12
10715513	13-47	13
10715514	14-47	14
10715515	15-47	15
10715516	16-47	16
10715517	17-47	17
10715518	18-47	18
10715519	19-47	19
10715520	20-47	20
10715521	21-47	21
10715522	22-47	22
10715523	23-47	23
10715524	24-47	24
10715525	25-47	25
10715526	26-47	26
10715527	27-47	27
10715528	28-47	28
10715529	29-47	29
10715530	30-47	30
10715531	31-47	31
10715532	32-47	32
10715533	33-47	33
10715534	34-47	34
10715535	35-47	35
10715536	36-47	36

Part Number	Balance ID Code	Length (In)
10715537	37-47	37
10715538	38-47	38
10715539	39-47	39
10715540	40-47	40
10715541	41-47	41
10715542	42-47	42
10715543	43-47	43
10715544	44-47	44
10715545	45-47	45
10715546	46-47	46
10715547	47-47	47
10715548	48-47	48
10715549	49-47	49
10715550	50-47	50
10715551	51-47	51
10715552	52-47	52
10715553	53-47	53
10715554	54-47	54
10715555	55-47	55
10715556	56-47	56
10715557	57-47	57
10715558	58-47	58
10715559	59-47	59
10715560	60-47	60

Part Number	Balance ID Code	Length (In)
10715612	12-51	12
10715613	13-51	13
10715614	14-51	14
10715615	15-51	15
10715616	16-51	16
10715617	17-51	17
10715618	18-51	18
10715619	19-51	19
10715620	20-51	20
10715621	21-51	21
10715622	22-51	22
10715623	23-51	23
10715624	24-51	24
10715625	25-51	25
10715626	26-51	26
10715627	27-51	27
10715628	28-51	28
10715629	29-51	29
10715630	30-51	30
10715631	31-51	31
10715632	32-51	32
10715633	33-51	33
10715634	34-51	34
10715635	35-51	35
10715636	36-51	36

Part Number	Balance ID Code	Length (In)
10715637	37-51	37
10715638	38-51	38
10715639	39-51	39
10715640	40-51	40
10715641	41-51	41
10715642	42-51	42
10715643	43-51	43
10715644	44-51	44
10715645	45-51	45
10715646	46-51	46
10715647	47-51	47
10715648	48-51	48
10715649	49-51	49
10715650	50-51	50
10715651	51-51	51
10715652	52-51	52
10715653	53-51	53
10715654	54-51	54
10715655	55-51	55
10715656	56-51	56
10715657	57-51	57
10715658	58-51	58
10715659	59-51	59
10715660	60-51	60

NOTE: Before ordering replacement balance tubes, please contact Marvin Inside Sales or a Customer Care Service Agent to have the balances recalculated.

Part Number	Balance ID Code	Length (In)
10715715	15-56	15
10715716	16-56	16
10715717	17-56	17
10715718	18-56	18
10715719	19-56	19
10715720	20-56	20
10708321	21-56	21
10708322	22-56	22
10708323	23-56	23
10708324	24-56	24
10708325	25-56	25
10708326	26-56	26
10708327	27-56	27
10708328	28-56	28
10708329	29-56	29
10708330	30-56	30
10708331	31-56	31
10708332	32-56	32
10708333	33-56	33
10708334	34-56	34
10708335	35-56	35
10708336	36-56	36
10708337	37-56	37

Part Number	Balance ID Code	Length (In)
10708338	38-56	38
10708339	39-56	39
10708340	40-56	40
10708341	41-56	41
10708342	42-56	42
10708343	43-56	43
10708344	44-56	44
10708345	45-56	45
10708346	46-56	46
10708347	47-56	47
10708348	48-56	48
10708349	49-56	49
10708350	50-56	50
10708351	51-56	51
10708352	52-56	52
10708353	53-56	53
10708354	54-56	54
10708355	55-56	55
10708356	56-56	56
10708357	57-56	57
10708358	58-56	58
10708359	59-56	59
10708360	60-56	60

Part Number	Balance ID Code	Length (In)
10715816	16-61	16
10715817	17-61	17
10715818	18-61	18
10715819	19-61	19
10715820	20-61	20
10706721	21-61	21
10706722	22-61	22
10706723	23-61	23
10706724	24-61	24
10706725	25-61	25
10706726	26-61	26
10706727	27-61	27
10706728	28-61	28
10706729	29-61	29
10706730	30-61	30
10706731	31-61	31
10706732	32-61	32
10706733	33-61	33
10706734	34-61	34
10706735	35-61	35
10706736	36-61	36
10706737	37-61	37
10706738	38-61	38

Part Number	Balance ID Code	Length (In)
10706739	39-61	39
10706740	40-61	40
10706741	41-61	41
10706742	42-61	42
10706743	43-61	43
10706744	44-61	44
10706745	45-61	45
10706746	46-61	46
10706747	47-61	47
10706748	48-61	48
10706749	49-61	49
10706750	50-61	50
10706751	51-61	51
10706752	52-61	52
10706753	53-61	53
10706754	54-61	54
10706755	55-61	55
10706756	56-61	56
10706757	57-61	57
10706758	58-61	58
10706759	59-61	59
10706760	60-61	60

NOTE: Before ordering replacement balance tubes, please contact Marvin Inside Sales or a Customer Care Service Agent to have the balances recalculated.

Part Number	Balance ID Code	Length (In)
10715917	17-66	17
10715918	18-66	18
10715919	19-66	19
10715920	20-66	20
10706821	21-66	21
10706822	22-66	22
10706823	23-66	23
10706824	24-66	24
10706825	25-66	25
10706826	26-66	26
10706827	27-66	27
10706828	28-66	28
10706829	29-66	29
10706830	30-66	30
10706831	31-66	31
10706832	32-66	32
10706833	33-66	33
10706834	34-66	34
10706835	35-66	35
10706836	36-66	36
10706837	37-66	37
10706838	38-66	38

Part Number	Balance ID Code	Length (In)
10706839	39-66	39
10706840	40-66	40
10706841	41-66	41
10706842	42-66	42
10706843	43-66	43
10706844	44-66	44
10706845	45-66	45
10706846	46-66	46
10706847	47-66	47
10706848	48-66	48
10706849	49-66	49
10706850	50-66	50
10706851	51-66	51
10706852	52-66	52
10706853	53-66	53
10706854	54-66	54
10706855	55-66	55
10706856	56-66	56
10706857	57-66	57
10706858	58-66	58
10706859	59-66	59
10706860	60-66	60

Part Number	Balance ID Code	Length (In)
10716020	20-71	20
10706921	21-71	21
10706922	22-71	22
10706923	23-71	23
10706924	24-71	24
10706925	25-71	25
10706926	26-71	26
10706927	27-71	27
10706928	28-71	28
10706929	29-71	29
10706930	30-71	30
10706931	31-71	31
10706932	32-71	32
10706933	33-71	33
10706934	34-71	34
10706935	35-71	35
10706936	36-71	36
10706937	37-71	37
10706938	38-71	38
10706939	39-71	39

Part Number	Balance ID Code	Length (In)
10706940	40-71	40
10706941	41-71	41
10706942	42-71	42
10706943	43-71	43
10706944	44-71	44
10706945	45-71	45
10706946	46-71	46
10706947	47-71	47
10706948	48-71	48
10706949	49-71	49
10706950	50-71	50
10706952	52-71	52
10706953	53-71	53
10706954	54-71	54
10706955	55-71	55
10706956	56-71	56
10706957	57-71	57
10706958	58-71	58
10706959	59-71	59
10706960	60-71	60

NOTE: Before ordering replacement balance tubes, please contact Marvin Inside Sales or a Customer Care Service Agent to have the balances recalculated.

Part Number	Balance ID Code	Length (In)
10707022	22-78	22
10707023	23-78	23
10707024	24-78	24
10707025	25-78	25
10707026	26-78	26
10707027	27-78	27
10707028	28-78	28
10707029	29-78	29
10707030	30-78	30
10707031	31-78	31
10707032	32-78	32
10707033	33-78	33
10707034	34-78	34
10707035	35-78	35
10707036	36-78	36
10707037	37-78	37
10707038	38-78	38
10707039	39-78	39
10707040	40-78	40
10707041	41-78	41
10707042	42-78	42
10707043	43-78	43

Part Number	Balance ID Code	Length (In)
10707044	44-78	44
10707045	45-78	45
10707046	46-78	46
10707047	47-78	47
10707048	48-78	48
10707049	49-78	49
10707050	50-78	50
10707051	51-78	51
10707052	52-78	52
10707053	53-78	53
10707054	54-78	54
10707055	55-78	55
10707056	56-78	56
10707057	57-78	57
10707058	58-78	58
10707059	59-78	59
10707060	60-78	60

NOTE: Before ordering replacement balance tubes, please contact Marvin Inside Sales or a Customer Care Service Agent to have the balances recalculated.

Part Number	Balance ID Code	Length (In)
10716129	29-84	29
10716130	30-84	30
10716131	31-84	31
10716132	32-84	32
10707133	33-84	33
10707134	34-84	34
10707135	35-84	35
10707136	36-84	36
10707137	37-84	37
10707138	38-84	38
10707139	39-84	39
10707140	40-84	40
10707141	41-84	41
10707142	42-84	42
10707143	43-84	43
10707144	44-84	44
10707145	45-84	45
10707146	46-84	46
10707147	47-84	47
10707148	48-84	48
10707149	49-84	49
10707150	50-84	50
10707151	51-84	51
10707152	52-84	52
10707153	53-84	53
10707154	54-84	54
10707155	55-84	55
10707156	56-84	56
10707157	57-84	57
10707158	58-84	58
10707159	59-84	59
10707160	60-84	60

Part Number	Balance ID Code	Length (In)
10716229	29-94	29
10716230	30-94	30
10716231	31-94	31
10716232	32-94	32
10707233	33-94	33
10707234	34-94	34
10707235	35-94	35
10707236	36-94	36
10707237	37-94	37
10707238	38-94	38
10707239	39-94	39
10707240	40-94	40
10707241	41-94	41
10707242	42-94	42
10707243	43-94	43
10707244	44-94	44
10707245	45-94	45
10707246	46-94	46
10707247	47-94	47
10707248	48-94	48
10707249	49-94	49
10707250	50-94	50
10707251	51-94	51
10707252	52-94	52
10707253	53-94	53
10707254	54-94	54
10707255	55-94	55
10707256	56-94	56
10707257	57-94	57
10707258	58-94	58
10707259	59-94	59
10707260	60-94	60

Part Number	Balance ID Code	Length (In)
10716330	30-105	30
10716331	31-105	31
10716332	32-105	32
10707333	33-105	33
10707334	34-105	34
10707335	35-105	35
10707336	36-105	36
10707337	37-105	37
10707338	38-105	38
10707339	39-105	39
10707340	40-105	40
10707341	41-105	41
10707342	42-105	42
10707343	43-105	43
10707344	44-105	44
10707345	45-105	45
10707346	46-105	46
10707347	47-105	47
10707348	48-105	48
10707349	49-105	49
10707350	50-105	50
10707351	51-105	51
10707352	52-105	52
10707353	53-105	53
10707354	54-105	54
10707355	55-105	55
10707356	56-105	56
10707357	57-105	57
10707358	58-105	58
10707359	59-105	59
10707360	60-105	60

NOTE: Before ordering replacement balance tubes, please contact Marvin Inside Sales or a Customer Care Service Agent to have the balances recalculated.

Part Number	Balance ID Code	Length (In)
10716430	30-117	30
10716431	31-117	31
10716432	32-117	32
10707433	33-117	33
10707434	34-117	34
10707435	35-117	35
10707436	36-117	36
10707437	37-117	37
10707438	38-117	38
10707439	39-117	39
10707440	40-117	40
10707441	41-117	41
10707442	42-117	42
10707443	43-117	43
10707444	44-117	44
10707445	45-117	45
10707446	46-117	46
10707447	47-117	47
10707448	48-117	48
10707449	49-117	49
10707450	50-117	50
10707451	51-117	51
10707452	52-117	52
10707453	53-117	53
10707454	54-117	54
10707455	55-117	55
10707456	56-117	56
10707457	57-117	57
10707458	58-117	58
10707459	59-117	59
10707460	60-117	60

Part Number	Balance ID Code	Length (In)
10716530	30-128	30
10716531	31-128	31
10716532	32-128	32
10707533	33-128	33
10707534	34-128	34
10707535	35-128	35
10707536	36-128	36
10707537	37-128	37
10707538	38-128	38
10707539	39-128	39
10707540	40-128	40
10707541	41-128	41
10707542	42-128	42
10707543	43-128	43
10707544	44-128	44
10707545	45-128	45
10707546	46-128	46
10707547	47-128	47
10707548	48-128	48
10707549	49-128	49
10707550	50-128	50
10707551	51-128	51
10707552	52-128	52
10707553	53-128	53
10707554	54-128	54
10707555	55-128	55
10707556	56-128	56
10707557	57-128	57
10707558	58-128	58
10707559	59-128	59
10707560	60-128	60

Default Exterior Vinyl Component Colors	
Exterior Clad Color	Component Color
Stone White, Bright Silver (pearlescent)	White
Pebble Gray, Bahama Brown, Evergreen, Hampton Sage, Sierra White, Coconut Cream, Cashmere, Wineberry, Cascade Blue	Beige
Bronze, Ebony, Cadet Gray, Copper (pearlescent), Gunmetal, Suede, Clay, Liberty Bronze (pearlescent)	Black

Default Interior Vinyl Component Colors	
Factory Interior Finish	Component Color
Prime, Interior Pigmented Top Coat (PIF - WH)	White
Bare: Pine, White Oak, Cherry, Douglas Fir, Maple Interior Clear Top Coat: same as Bare Interior Stain: Wheat, Honey	Beige
Bare: Mahogany, Walnut Interior Clear Top Coat: Same as Bare Interior Stain: Hazelnut, Leather, Cabernet, Espresso Interior Pigmented Top Coat - DBK	Black

To order, specify (use all that apply):

1. Original order/line number
2. Rough opening
3. Profile number
4. Length
5. Color

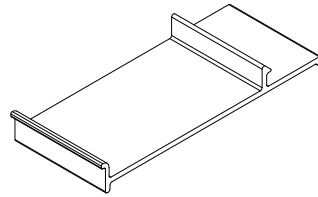

Exterior Cover, A2700

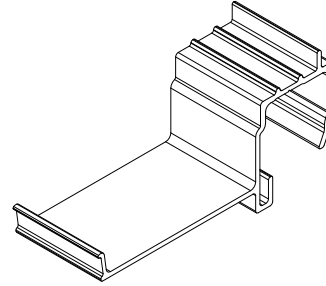

**Exterior Head Jamb or
Jamb Cover, A3077**

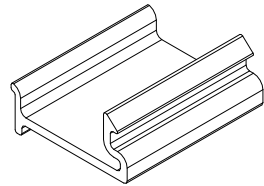

Exterior Jamb Cover, A2615

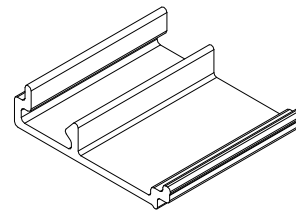

**Mid Exterior Jamb Cover,
A2460**

To order, specify:

1. Original order/line number
2. Profile number
3. Length
4. Call number or rough opening
5. Color

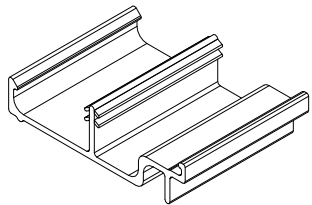

Exterior Hardware Cover, V2338

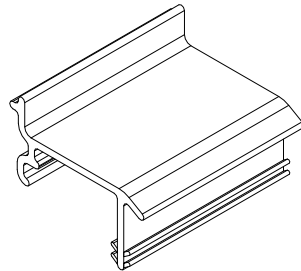

Vinyl Spacer, V2573

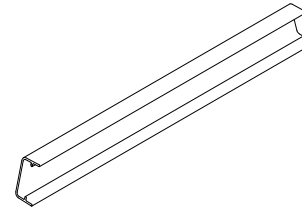

Top Sash Limiter, V2257

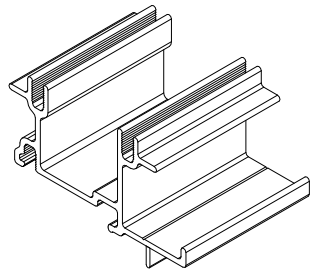

Mid Exterior Cover Base, V2432

If the original unit had performance brackets, then a secondary fabrication is needed to accommodate the brackets.

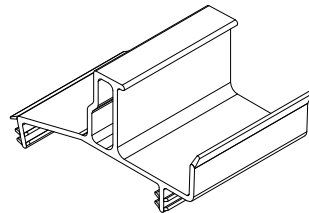

Sill Thermal Break/Liner, V2191

On Custom Color Clad, Sill Thermal Break color will match the exterior weather strip package color selected.

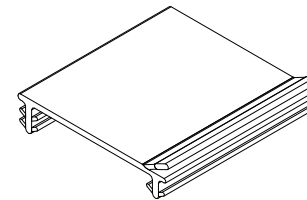

Bottom Check Rail Exterior Hardware Cover, V2478

Exterior Sash Stop

V2257

Length	Color	PN
8" (203)	White	15366608
	Beige	15366708
	Black	15366508

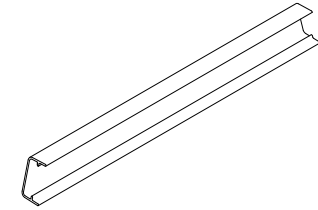

To order, specify (use all that apply):

1. Original order/line number
2. Profile number
3. Length
4. Call number or rough opening
5. Finish

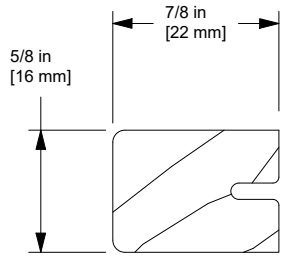

Parting Stop, W11578

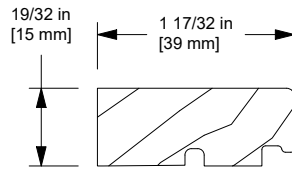

Jamb Liner, W12511

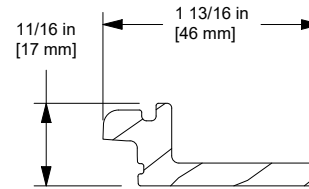

**Removable Interior
Jamb Cover, W13093**

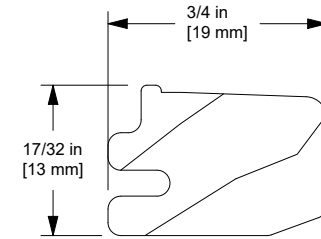

**Fixed Interior Jamb Cover,
W13094**

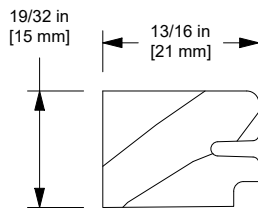

**Jamb Liner, Picture,
W12569**

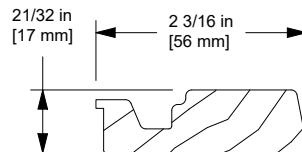

Sill Filler, W12061

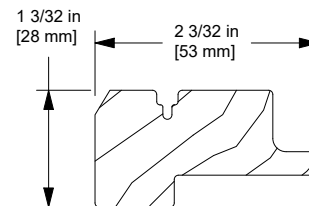

**Interior Cover, Transom,
W11906**

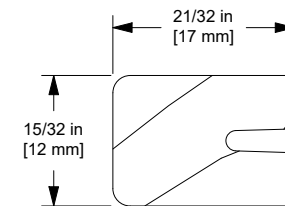

Head Jamb/Jamb Stop, W12407

NOTE: Any picture units will require all stops to be replaced.

To order, specify:

1. Original order/line number
2. Profile number
3. Length
4. Rough opening
5. Finish

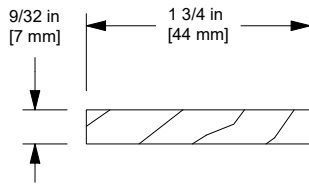

**0 Degree Sill Liner,
Operator, W12595**

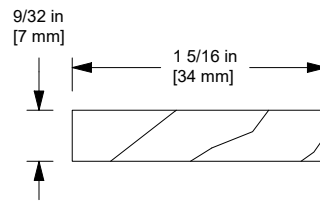

**8 Degree Sill Liner,
Operator, W11576**

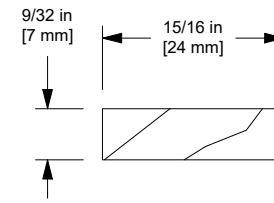

**14 Degree Sill Liner,
Operator, W12515**

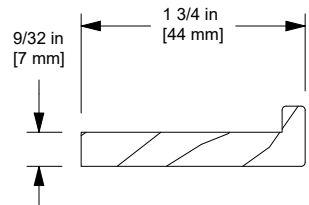

**0 Degree Sill Liner,
Picture/Transom, W12597**

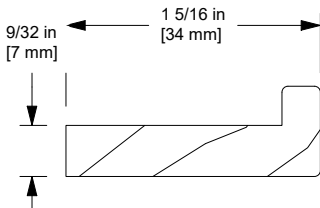

**8 Degree Sill Liner,
Picture/Transom, W11825**

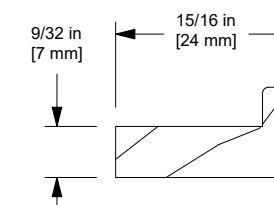

**14 Degree Sill Liner,
Picture/Transom, W12566**

Jamb Weather Strip

V2682

(Operators, Picture and Transom)

Length	Color	PN
Lineal 96" (2438)	White	15262896
	Beige	15363096
	Black	15262996

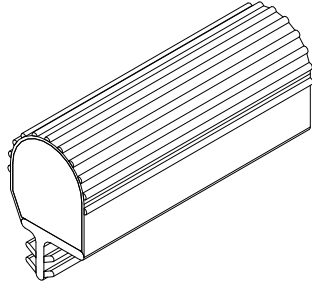

Weather Strip

V2779

Length	Color	PN
65" (1651)	Black	15362965
120" (3048)		15362995

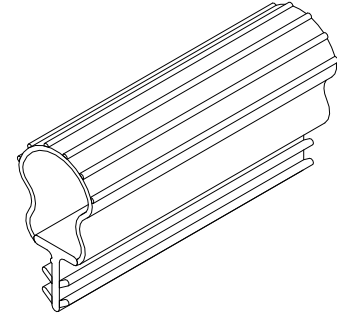

Head Jamb Weather Strip

V2839

Length	Color	PN
Lineal 65" (1651)	White	NA
	Beige	NA
	Black	15363565

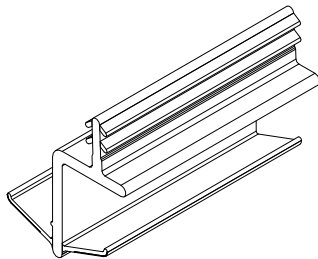

Check Rail Weather Strip

V2803

Length	Color	PN
Lineal 65" (1651)	White	15816165
	Beige	15816265
	Black	15816365

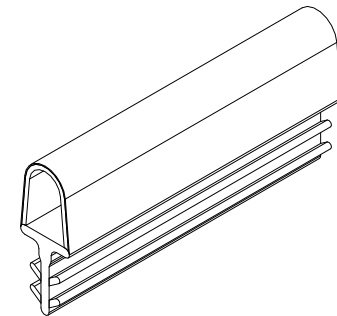

Screen Replacement

Standard screen mesh is Marvin Bright View™. Aluminum mesh is available as an option in black, charcoal, bright aluminum or bright bronze. Determine the outside measurement of the existing screen and find the size that corresponds to the width and height indicated on the following charts. Insert units will use the conversions only, as they are all special sizes. Surrounds are available in bronze, stone white, brown, pebble gray and evergreen.

NOTE: The Aluminum Screen will be the standard for units with a frame size height of $\leq 54 \frac{1}{2}$ ", with an option of the Extruded Aluminum Screen available. The standard screen for any unit with a frame size height $> 54 \frac{1}{2}$ " will be the Extruded Aluminum Screen.

To order, specify:

1. Original order number
2. Size; – If there is no existing screen to obtain the OM of the screen, determine the size of the screen by using the conversions and chart. The daylight opening is the measurement of the visible glass.
3. Surround color
4. Mesh type

Screen Sizes for Ultimate Double Hung Insert G2

Full Screen, Aluminum Screen

Daylight Opening of one sash (if equal height) to OM of screen

Daylight Width + $4 \frac{3}{4}$ " = OM Width of Screen

Daylight Height x 2 + $8 \frac{15}{64}$ " = OM Height of Screen

Half Screen, Aluminum Screen

Daylight Opening to OM of Half Screen

Daylight Width + $4 \frac{41}{64}$ " = OM Width of Screen

Daylight Height + $5 \frac{7}{16}$ " = OM Height of Screen

Full Screen, Extruded Aluminum Screen

Daylight Opening of one sash (if equal height) to OM of screen

Daylight Opening Width + $4 \frac{3}{4}$ " = OM Width of Screen

Daylight Opening Height x 2 + $8 \frac{15}{16}$ " = OM Height of Screen

Half Screen, Extruded Aluminum

Daylight Opening to OM of Half Screen

Daylight Width + $4 \frac{3}{4}$ " = OM Width of Screen

Daylight Height + $5 \frac{45}{64}$ " = OM Height of Screen

Screen Plunger Kit

Aluminum Screen

Includes:

- 1 - Plunger Bolt
- 1 - Plunger Spring
- 1 - Plunger Cap, Black

PN
11851053

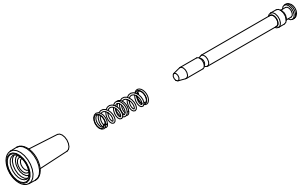

Screen Header Pin

Aluminum Screen

PN
10500876

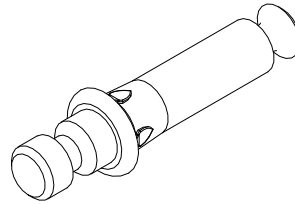

Half Screen Check Rail Weather Strip

Aluminum screen

Length	Color	PN
Specify LF	Gray	15221497

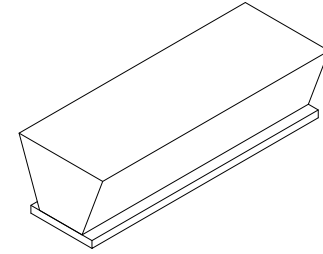

Plunger and Spring Assembly

Extruded Aluminum Screen

Includes:

- 1 - Plunger Bolt
- 1 - Plunger Spring
- 1 - Plunger Cap, Black

PN
10500706

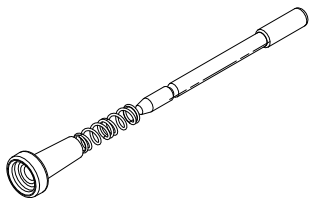

Half Screen T-Slot Weather Strip

Extruded Aluminum Screen

Length	Color	PN
Specify LF	Black	15350100

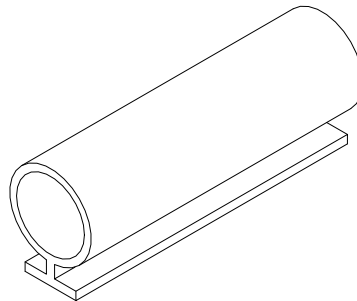

Order through Configured Parts in OMS

NOTE: Service Only Parts

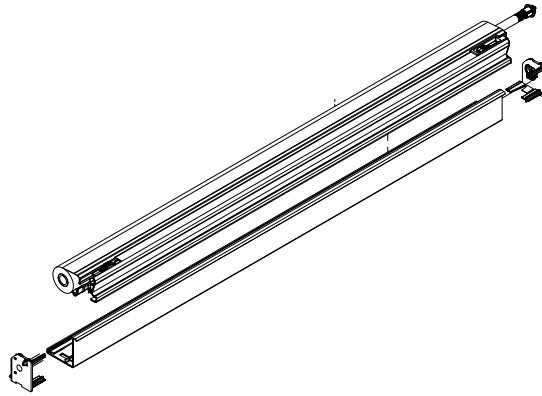

Screen Cartridge Assembly - Full Assembly

Includes: spring assembly, free spin end cap, ratchet end cap, interior housing, pull bar, pull bar backer, pull bar seal, carrier bolt assemblies, screen mesh, spline tube, 4 interior gaskets, screws, warning label, packaging

Carrier Bolt Assembly

Handing	Beige PN	White PN	Black PN
LH	10501387	10501389	10501391
RH	10501386	10501388	10501390

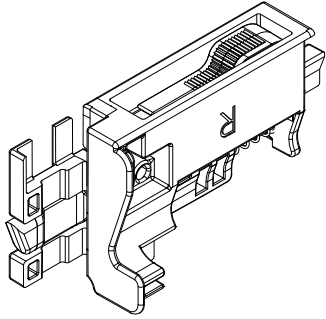

RH shown

Free Spin End with Leaf Spring

Service Only

PN
10501700

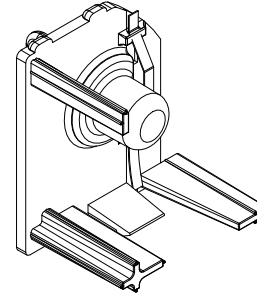

Ratchet End Cap

Service Only

PN
10500879

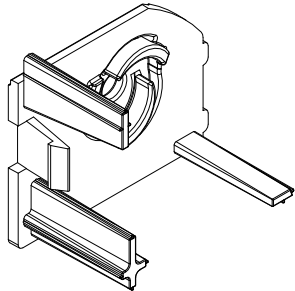

When ordering replacement parts, specify:

1. Original order number
2. Type of unit
3. Description

NOTE: Service Only Parts

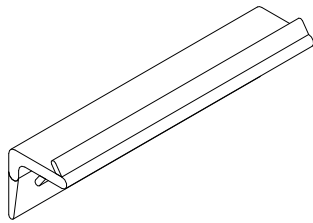

Pull Bar Fin, V2372
(Black or Beige)

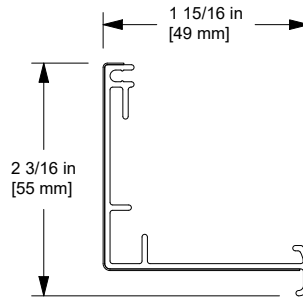

Interior Housing, C0117

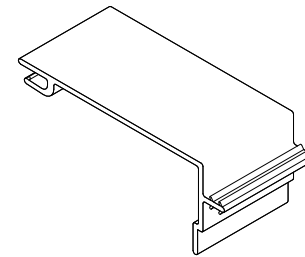

Exterior Housing, V2366

When ordering replacement parts, specify:

1. Original order number
2. Type of unit
3. Description

NOTE: Service Only Parts

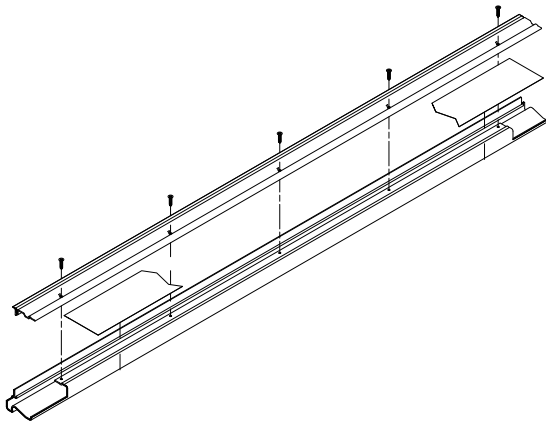

Pull Bar and Backer with Fin and screws

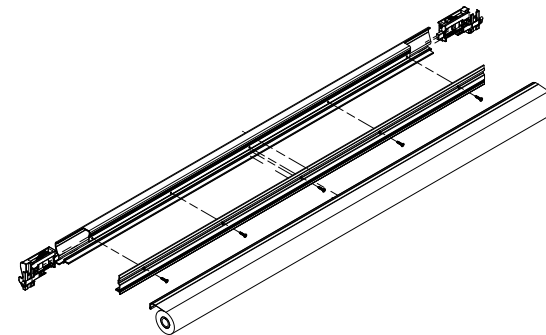

Screen Cartridge Assembly, Partial

Includes: spring assembly, free spin end cap, ratchet end cap, mesh, tube, spline, gaskets, warning label, packaging

Pull bar, backer and screws not included.
Shown for illustration purposes only.

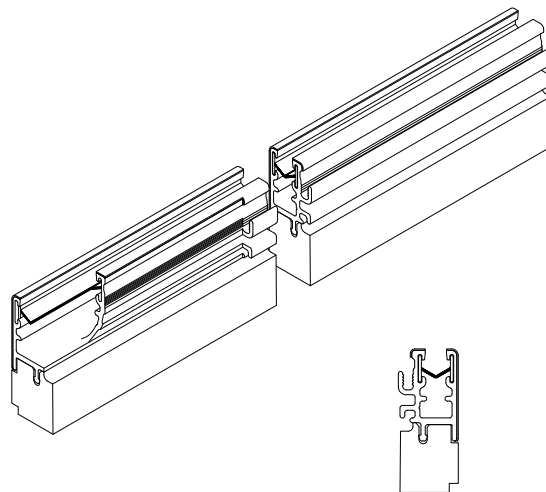

Screen Track Assembly, C0135 and V2627

NOTE: Wood Jamb Liner not included

Balance Tube Tensioning Tool

PN
05570910

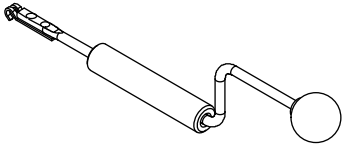

Non-Tilt Sash Removal Tool Kit

Includes:

2 – Non-Tilt sash removal tool

PN
11860094

