



# Ultimate Wood Glider

DISC LA PRE 02/26/2018

## Replacement Parts

Specifications and technical data are subject to change without notice.

Numbers listed in ( ) parentheses are metric equivalents in millimeters rounded to the nearest whole number.

Suggested fasteners are not included and must be ordered separately.

Illustrations are not to scale.

## Contents

Product History.....	2
Part Identification - Operator (XO/OX, XOX) .....	3
Part Identification - Picture .....	4
Locking Hardware .....	5
Miscellaneous Parts .....	7
Vinyl Parts.....	9
Vinyl Parts - Discontinued No Availability (NA) .....	11
Wood Parts.....	12
Weather Strip.....	14
Sash Replacement - Discontinued - No Availability (DISC-NA).....	16
Screen Replacement.....	17
Screen Parts .....	18
Screen Parts - Discontinued - No Availability (DISC-NA) .....	19
Combination Units - Discontinued - No Availability (DISC-NA) .....	20

Produced	Unit Type	Features and Changes
2011	Ultimate Wood Glider DISC LA PRE 2/26/2018	08/29/2011: Ultimate Wood Glider introduced. Wood Glider discontinued.
2012	Ultimate Wood Glider DISC LA PRE 2/26/2018	10/29/2012: Interior Square Sticking/Glazing Bead option introduced. 12/17/2012: Introduced clear interior finish option on all products.
2013	Ultimate Wood Glider DISC LA PRE 2/26/2018	04/29/2013: Introduced interior stain options. Stain colors are Wheat, Honey, Leather, Hazelnut, Cabernet and Espresso.
2014	Ultimate Wood Glider DISC LA PRE 2/26/2018	10/27/2014: Introduced Window Opening Control Device (WOCD).
2015	Ultimate Wood Glider DISC LA PRE 2/26/2018	02/23/2015: Introduced factory installed and replacement kits for the head jamb mount sash limiters.
2016	Ultimate Wood Glider DISC LA PRE 2/26/2018	06/27/2016: Introduced matte Black as a standard hardware color.
2018	Ultimate Wood Glider DISC LA PRE 2/26/2018	02/26/2018: Discontinued the sale of the Ultimate Wood Glider DISC LA PRE 2/26/2018.
2020	Ultimate Wood Glider DISC LA PRE 2/26/2018	04/27/2020: Discontinued (Disc-NA) combination colors with exception of Stone White and Bronze.
2021	Ultimate Wood Glider DISC LA PRE 2/26/2018	10/25/2021: Standard screen mesh changed to Marvin Bright View™ from Charcoal Fiberglass Mesh. For more information see Product Bulletin 793.
2022	Ultimate Wood Glider DISC LA PRE 2/26/2018	06/27/2022: The Aluminum Screen will be the standard for units with a frame size height of $\leq 54 \frac{1}{2}$ ", with an option of the Extruded Aluminum Screen available. The standard screen for any unit with a frame size height $> 54 \frac{1}{2}$ " will be the Extruded Aluminum Screen. This improvement to screen frames includes all Ultimate and Ultimate Wood windows that accept an aluminum screen, including Round Top and Polygon shapes. See Product Bulletin 832 for more details.
2024	Ultimate Wood Glider DISC LA PRE 2/26/2018	02/26/2024: Replacement sash and combinations became Discontinued-No Longer Available (Disc-NA). See Product Bulletin 919 for more details. 06/24/2024: Update for Ultimate Combinations and Ultimate Wood Combinations and Energy Panels were made. See Product Bulletin #937 for more Information.



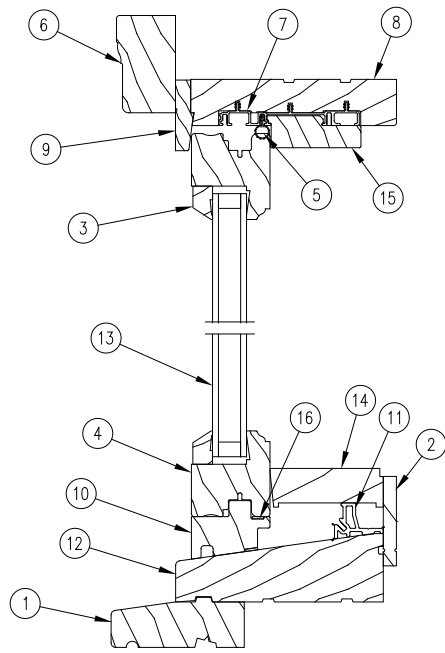

**Head Jamb and Sill Detail**

1. Subsill, W10333
2. Sill Liner, W2146
3. Glazing Bead, W10384
4. Rail
5. Frame Weather Strip, V147
6. Brick Mould Casing, W1047
7. Header Liner, V1969
8. Head Jamb
9. Top Blind Stop, W2125
10. Leveling Block, W11319
11. Sill Track, V2088
12. Sill
13. Insulating Glass
14. Sill Filler, W8591
15. Head Jamb Stop, W11042
16. Foam Tape
17. Jamb
18. Brick Mould Casing, W1047
19. Jamb Liner, V2040
20. Frame Weather Strip, V147
21. Interior Jamb Cover, W10752
22. Glazing Bead, W10384
23. Stile
24. Interior Jamb Liner, W2127
25. Insulating Glass
26. Jamb Blind Stop, W8950

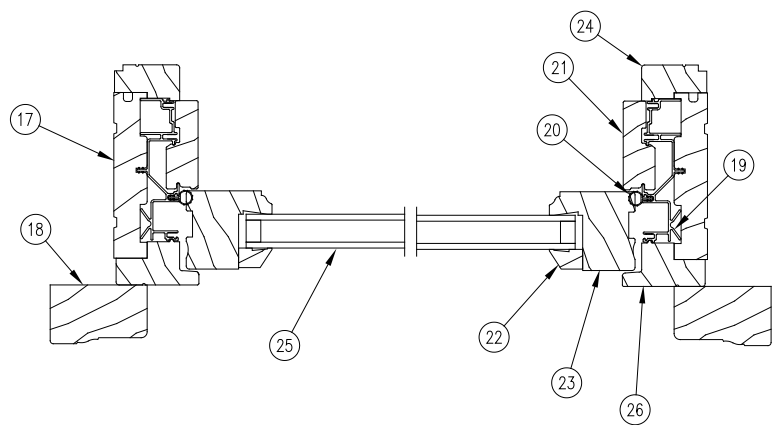

**Jamb Detail**

## Lock Handle Assembly

### Includes:

#8-18 x 5/8" Pan Head screws (11800821)

Color	LH XO PN	RH OX PN
Satin Taupe	10816160	10816170
Bronze	10816161	10816171
Stone White	10816162	10816172
Brass	10816163	10816173
Antique Brass	10816164	10816174
Polished Chrome	10816165	10816175
Satin Chrome	10816166	10816176
Oil Rubbed Bronze	10816167	10816177
Satin Nickel	10816168	10816178
Matte Black	10816169	10816179

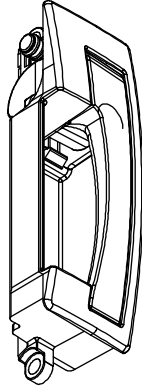

## Keeper

### Includes:

2 - #8-18 x 5/8" Pan Head screws (11800821)

Color	PN
Beige	10816185
White	10816184

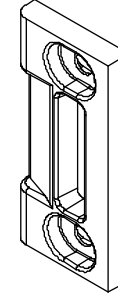

## Latch Assembly

### Includes:

2 - #8-18 x 5/8" Pan Head screws (11800821)

Color	XO PN	OX PN
Beige	10816196	10816198
White	10816197	10816199

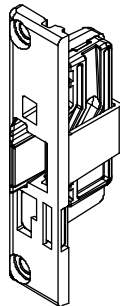

## Sash Retainer Bar Handle

Color	PN
Beige	10813422

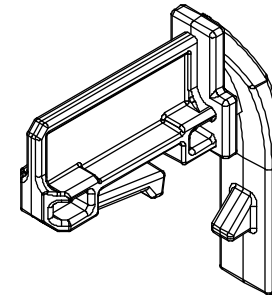

## Lock Cable

Frame OM Height	Cord Length	PN
<b>Handle to Latch</b>		
All Unit Sizes	3.824" (97)	10810016
<b>Latch to Latch</b>		
29.500–47.499"	7.591" (193)	10810017
47.500–65.499"	20.591" (523)	10810018
65.500" and greater	32.591" (828)	10810019

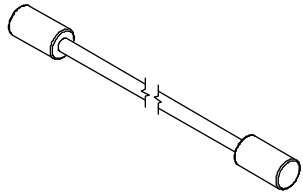

## Retainer Bar Latch

### Includes:

1 - #8-18 x 3/4" AB, Phillips, truss head, full thread screw (11808340)

Color	PN
Beige	10500849

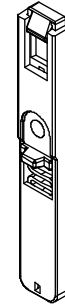

## Sill Corner Weep Block

Color	LH PN	RH PN
White	11867814	11867816
Beige	11867816	11867815

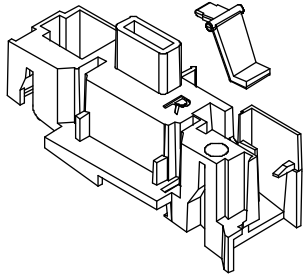

## Sill Bracket

### Includes:

2 - #8-18 x 1" screws (11800551)

Color	PN
Stainless Steel	11861171

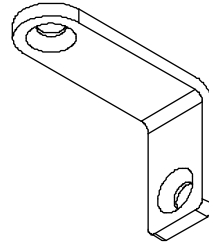

## Stationary Bracket

### Includes:

3 - #7-19 x 3/4" screws (11808750)

Color	PN
Galvanized Steel	11860431

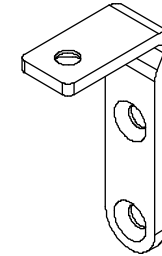

## Sash Limiter Kit, Head Jamb Mount

### Includes:

2 - #8-18 x 1" Phillips pan head stainless steel screws (11805150)

NOTE: XO, OX, XX units require 1 limiter per window. XOX, OXXO units require 2 limiters per window.

Color	PN
Beige	10500458
White	10500459

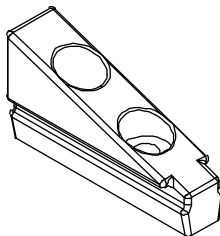

## Meeting Stile Sill Block

### Includes:

Fasteners

NOTE: Order 1 sill dust block with a meeting stile sill block replacement.

Color	PN
Beige	11861172

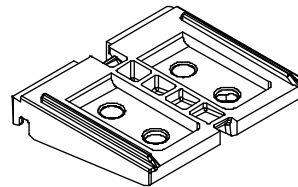

## Subsill Screw

#8 x 1 3/8" type A

#2 Square drive recess pan head, thread forming,  
self tapping, 1/3 thread

Color	PN
Stainless Steel	11881374

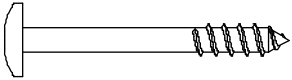
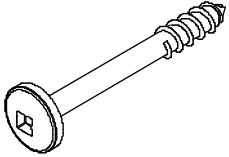



## Interior Sill Cover

V2038

CN	Length	Beige PN	White PN
3-0	15 3/16" (386)	15354430	15354431
4-0	21 3/16" (538)	15354440	15354441
5-0	27 3/16" (690)	15354450	15354451
6-0	33 3/16" (843)	15354460	15354461
Lineal	120" (3048)	15354498	15354499



## Sash Stop

V784

Length	Operation	Beige PN	White PN
3/4"	XO/OX	10500882	10500881
1 3/4"	XOX (order qty 2)	10500524	10500523

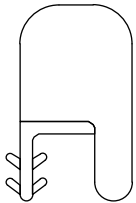

## Glide Channel

V2009

Length	Color	PN
4" (102)	Natural	15221201

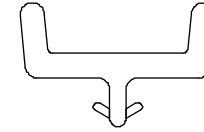

## Sash Retainer Bar

V2048

CN	Length	Beige PN
3-0	13 3/4" (413)	15354630
4-0	19 3/4" (502)	15354640
5-0	25 3/4" (654)	15354650
6-0	31 3/4" (806)	15354660
Lineal	76" (1930)	15354676

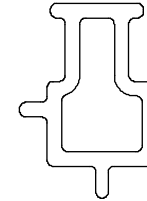

## Connecting Barb

V803

Length	PN
Specify Length	15812999

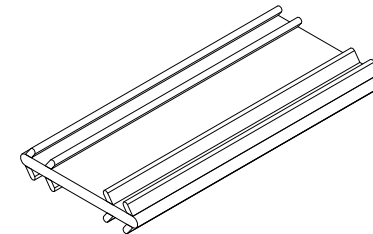

## Primary Sash Interlock

V2071

CN	Length	Beige PN	White PN
Lineal	76" (1930)	15354977	15354976

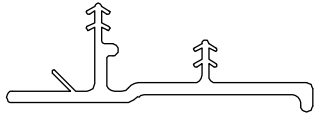

## Jamb Liner

V2040

Order 1 foam hardware gasket with stationary liner replacement.

Order 1 sill track gasket (White, 10500773) or (Beige, 10500772) and 1 foam hardware gasket (10500510) with left side (XO, XOX) or right side (XO, XOX) liner replacement.

\*Operator side jamb liners are handed; XOX configuration requires one of each handing.

CN	Length	Beige PN	White PN
Lineal	76" (1930)	15354276	15354277

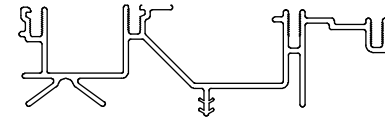

## Secondary Sash Interlock

V2064

CN	Length	Beige PN
2-0	20 1/2" (514)	15914520
3-0	32 1/4" (819)	15914530
3-6	38 1/4" (972)	15914536
4-0	44 1/4" (1129)	15914540
5-0	56 1/4" (1429)	15914550
Lineal	76" (1930)	15914576

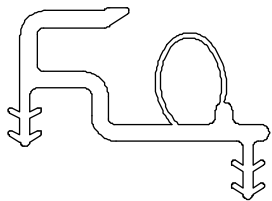

## Interior Sill Track

V2088

NOTE: Also order 1 sill track gasket (10500773 WH) or (10500772 BG)

CN	Length	Beige PN	White PN
6-0	68 19/32" (1742)	15914460	15914461
Lineal	120" (3048)	15914498	15914499
Lineal	175" (4445)	15914497	15914496

Suggested Fasteners	Beige PN	White PN
#8-18 x 5/8" Phillips, pan head screws	11808581	11808580

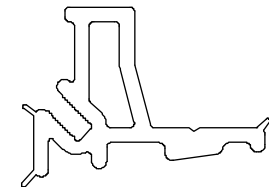

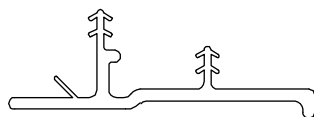

**Primary Sash Interlock,  
V2071**

No longer available

**To order, specify (all that apply):**

1. Original order/line number, if available
2. Profile number
3. Length
4. LH or RH operation (if applicable)
5. Type of product
6. Finish

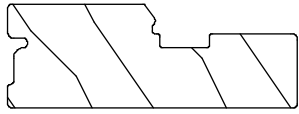

**Jamb Cover, W10752**  
XO, OX, XX, OXXO Picture  
Max length: 76" (1930)

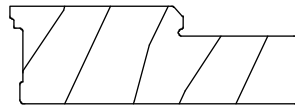

**Head Jamb Stop, W11042**  
Picture  
Max length: 76" (1930)

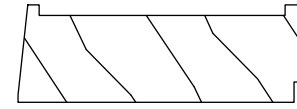

**Sill Filler, W8591**  
Picture  
Max length: 120" (3048)

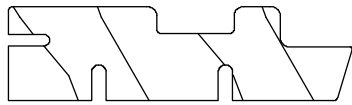

**Exterior Jamb Cover, W11181**  
With V803 applied

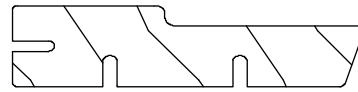

**Exterior Head Jamb Cover, W11097**  
With V803 applied

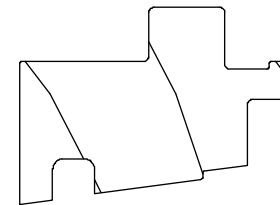

**Leveling Block, W11319**  
With foam tape applied

**To order, specify (all that apply):**

1. Original order/line number, if available
2. Profile number
3. Length
4. LH or RH operation (if applicable)
5. Type of product
6. Finish

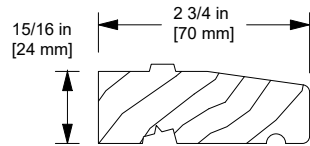

**Subsill, W10333**

Subsill screws are available in the Fasteners section.

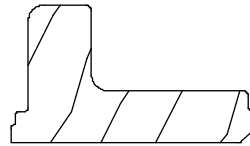

**Head Jamb Stop, W10933**

XO, OX, XOX

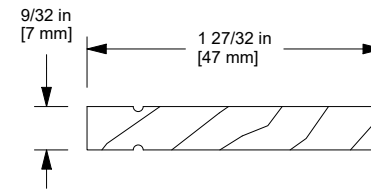

**Sill Liner, W2146**

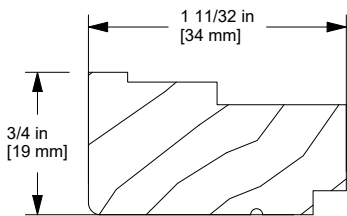

**Interior Jamb Liner, W2127**

Stationary Side

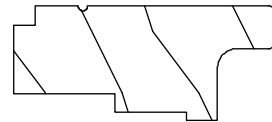

**Interior Jamb Liner, W11085**

Operator Side

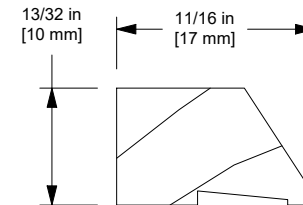

**Putty Bead, W10384**

## Frame Weather Strip

V147

Head/Sill Frame Weather Strip			
CN	Length	Beige PN	White PN
3-0	17 1/4" (438)	15359730	15359630
4-0	23 1/4" (591)	15359740	15359640
5-0	29 1/4" (743)	15359750	15359650
6-0	35 1/4" (895)	15359760	15359660

Jamb Frame Weather Strip				
CN	Length	Beige PN	White PN	Black PN
3-0	32 5/8" (829)	15359430	15359330	15359530
3-6	38 5/8" (981)	15359436	15359336	15359536
4-0	44 5/8" (1133)	15359440	15359340	15359540
5-0	56 5/8" (1438)	15359450	15359350	15359550
Lineal*	150" (3810)	15351699	17002300	17002299
*To receive correct fabrication, order CN 6-0 by R.O. or length, 68 5/8".				

Frame Cover Weather Strip				
CN	Length	Beige PN	White PN	Black PN
Lineal	150" (3810)	15351699	17002300	17002299

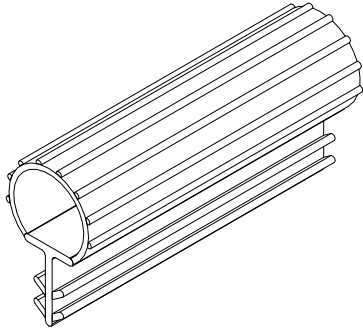

## Foam Hardware Gasket

Color	PN
Beige	10500510

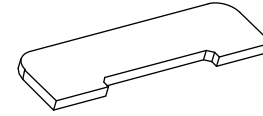

## Sill Track Gasket

Color	PN
Beige	10500772
White	10500773

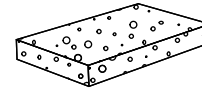

## Clutch Pocket Plug

7/8" x 11/16" x 5/8"

Color	PN
White	10500504

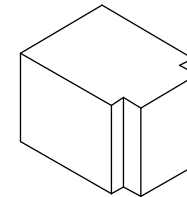

## Foam Tape

150' Roll

Color	PN
Gray	11406218

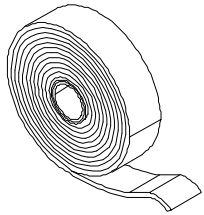

## Header Dust Block

1 1/8" x 1 1/8" x 1/2"

Color	PN
Gray	11869828

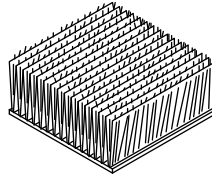

## Sill Dust Block

1 11/32" x 7/8" x 1/2"

Color	PN
Gray	11869856

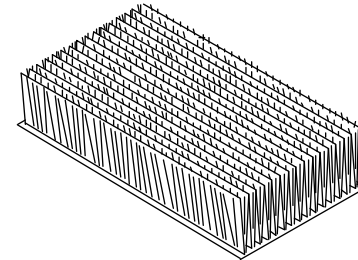

Replacement sash are no longer available.



Screens are standard with aluminum surround, Standard screen mesh is Marvin Bright View™. Aluminum mesh is available as an option in Charcoal, Black, Bright Aluminum, and Bright Bronze. Determine the outside measurement of the existing screen. Find the sizes that correspond to the width and height indicated on the following charts. Surrounds are available in all standard and select colors.

NOTE: The Aluminum Screen will be the standard for units with a frame size height of  $\leq 54 \frac{1}{2}$ " , with an option of the Extruded Aluminum Screen available. The standard screen for any unit with a frame size height  $> 54 \frac{1}{2}$ " will be the Extruded Aluminum Screen.

NOTE: Screens feature clear finger pull/leaf spring mounting system.

**To order, specify:**

1. Size; - If there is no existing screen from which to obtain the OM of the screen, determine the size of the screen by using the conversion charts below. The daylight opening is the measurement of the visible glass
2. color;
3. mesh type (if other than standard).

<b>Screen Sizes for</b> <b>Ultimate Wood Glider DISC LA PRE 2/26/2018</b> <b>Produced 8/29/2011 to 2/26/2018</b> Daylight Width + $1 \frac{27}{32}$ " = OM Width of Screen Daylight Height + $3 \frac{27}{32}$ " = OM Height of Screen			
<b>XO, OX Width</b>		<b>XO, OX, XOX Height</b>	
<b>Size</b>	<b>OM - Width</b>	<b>Size</b>	<b>OM - Height</b>
3-0	15 1/8" (384)	1-6	14 9/16" (370)
3-6	18 1/8" (460)	2-0	20 9/16" (522)
4-0	21 1/8" (537)	2-6	26 9/16" (675)
4-6	24 1/8" (613)	3-0	32 9/16" (827)
5-0	27 1/8" (689)	3-6	38 9/16" (980)
5-6	30 1/8" (765)	4-0	44 9/16" (1132)
6-0	33 1/8" (841)	4-6	50 9/16" (1284)
<b>XOX Width</b>		5-0	56 9/16" (1437)
6-0	15 1/8" (384)	5-6	62 9/16" (1589)
8-0	21 1/8" (537)	6-0	68 9/16" (1742)
10-0	27 1/8" (689)		

## Screen Bump

Color	PN
Black	11861173



## Leaf Spring

PN
11868835

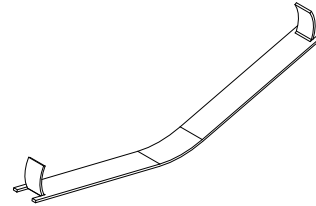

## Screen Plunger Kit

Aluminum Screen

### Includes:

- 1 - Plunger Bolt
- 1 - Plunger Spring
- 1 - Plunger Cap, Black

PN
11851053

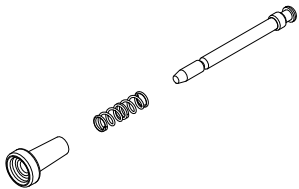

## Plunger and Spring Assembly, Extruded Screen

### Includes:

- 1 - Plunger
- 1 - Plunger spring
- 1 - Plunger cap

PN
10500706

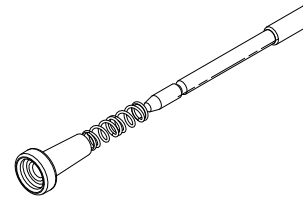

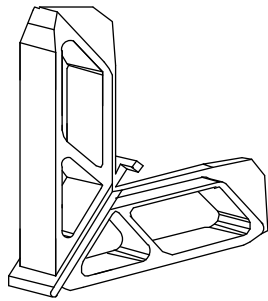

**Corner Key, Screen**

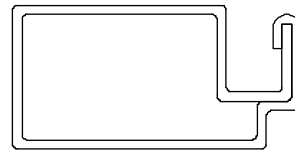

**Screen Surround, A135**

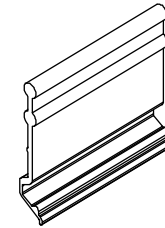

**Screen Pull Tab**

Combination units are no longer available.

Replacement Parts may be available, see Replacement Parts section:  
“Ultimate and Ultimate Wood Window Combinations and Energy Panels”