

# Essential Glider Sash Lead-In Installation

## Field Applied Instruction



### You Will Need to Order

White Sash Lead-In with screws (part number 10502772)  
Black Sash Lead-In with screws for Dark Interiors (part number 10502773)

### You Will Need to Supply

Flat screwdriver Phillips head bit  
1/8" drill bit with power drill/drive

1. Using a flat screwdriver, remove the existing sash pegs from the sash. See figure 1.

*NOTE: Depending on size of unit, there will be either one or three pegs to remove.*

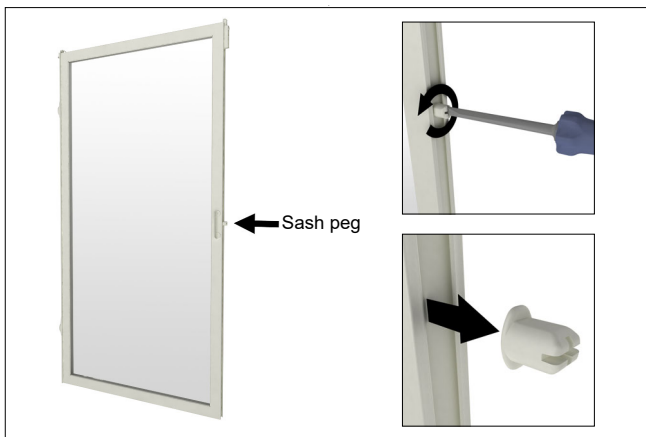

**Figure 1** Remove the sash pegs from the sash.

2. Center the Sash Lead-In with the sash handle. Position it into the sash groove. See figure 2.

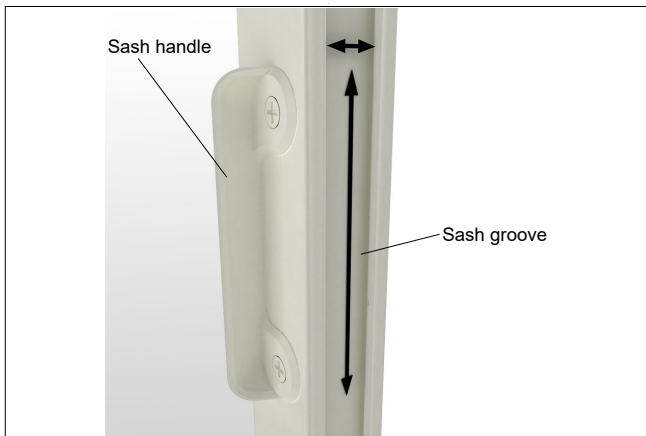

**Figure 2**

3. Once the Sash Lead-In is centered with the handle, use a power driver to fasten with the provided self-tapping screws. See figure 3 and figure 4.

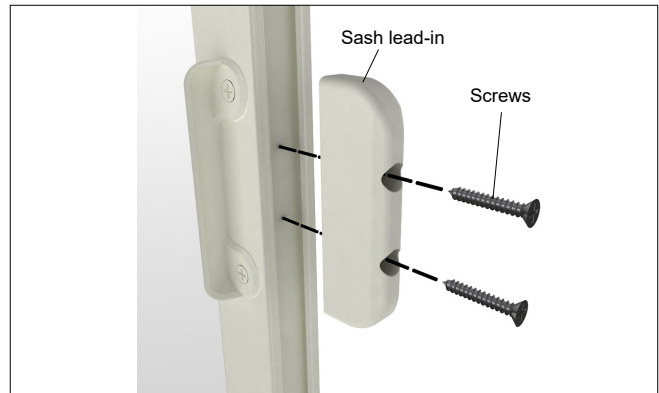

**Figure 3** Install the lead-in.



**Figure 4** View of full sash.