

# ELEVATE + ESSENTIAL

MARVIN ELEVATE™ COLLECTION | MARVIN ESSENTIAL™ COLLECTION



# Table of Contents

---

Introduction .....	2
How To Use This Manual .....	2
Warranty .....	2
Annual Window and Door Checklist .....	3
Hazard Notations .....	3
Window Part Identification .....	4
Window Products .....	5
Door Products .....	6
Glass .....	7
Condensation .....	7
Mildew Removal .....	7
Cleaning the Glass .....	8
Tempered Glass .....	8
Glass Breakage .....	8
Finishing the Interior on Elevate Products .....	9
Painting .....	9
Staining .....	9
Ultrex® and Maintenance .....	9
Cleaning Ultrex .....	9
Repairing Ultrex .....	10
Painting Ultrex .....	10
Screen Care and Maintenance .....	11
Maintenance, Operation, and General Service .....	11
Casement .....	12
Awning .....	13
Essential Casement and Awning Screen Removal .....	13
Double Hung .....	14
Glider .....	15
Removing and Installing the Screen .....	16
Patio and Sliding French Doors .....	16
Removing Sliding Door Panels .....	17
Swinging French Door .....	18
Care of PVD Finishes .....	20

# Introduction

Marvin® thanks you for choosing high performance Ultrex® products for your home. Whether you selected the rich wood interiors of the Elevate collection, or the clean lines of the Essential collection, the energy efficient Low E insulated glass and durable Ultrex construction will provide you windows and doors you'll appreciate for years.

## How To Use This Manual

This owner's manual was created to help keep your Marvin products looking beautiful and performing well for years to come. Take a few minutes to carefully read through this manual. You'll find photos that will help identify your Marvin products, general information on cleaning, and answers to common questions. Included is an annual checklist with recommended maintenance tips that can keep your Marvin products performing perfectly for years to come.



For questions on service or maintenance not covered in this manual please contact your local Marvin dealer or visit our website at [marvin.com](http://marvin.com).

## Warranty

Marvin is committed to bringing you products of the highest quality and value. Our made-to-order manufacturing philosophy is one example of our commitment. Our warranty is another.

Please visit the warranty section of our website [marvin.com/warranty](http://marvin.com/warranty) for full warranty details on your product.



Elevate collection products shown in images unless noted otherwise.



# Annual Window and Door Checklist

Use this checklist as a maintenance reminder for your windows and doors to help keep your product operating properly and prevent future problems. Once a year should be sufficient.

- Safety first: use caution on ladders, and wear protective eyewear and clothing. When working with primers, paints, stains, cleaning solutions, etc., make sure that you use and dispose of these materials according to local codes or manufacturer's instructions.
- Inspect weather strip for damage or loss of performance. Contact the local Marvin retailer if your weather strip requires replacement. Take care when using paints, stains, or varnishes. These products contain solvents which, when coming in even momentary contact with weather strip, can cause it to become brittle and require replacement.
- Examine window and/or door interior and exterior finishes. Periodic cleaning and touchup can extend the life of your finish.
- Inspect exterior caulking around the outer edges of the window or door frame. Trim off any loose caulking and reseal any gaps with a good quality caulk.
- Check all hardware (locks, opening mechanisms, etc.) for smooth operation.
- Inspect exposed hardware screws; tighten if loose.
- Clean sand, dirt, or dust from door and window hinges, sills, and tracks.
- When soiled, wash the exterior of your doors and windows with an approved cleaning solution found at [marvin.com/cleaning](http://marvin.com/cleaning).

## Hazard Notations

Please familiarize yourself with the following hazard notations used throughout this manual.

Caution	Warning	Seek Assistance	Tips/Hints
			
Mistake or misuse could cause damage to the window or result in faulty installation and unit performance.	Mistake or misuse could result in personal injury and/or severe damage to unit, equipment, and/or structure.	Information on alternative procedures, definitions, helpful hints.	Help from another individual is necessary to perform the task safely and correctly.

# Window Part Identification

In the following pages you'll find operation and maintenance information on Marvin® window products. Refer to the product illustrations for the names of your particular windows, and use the illustration below to help identify window components.

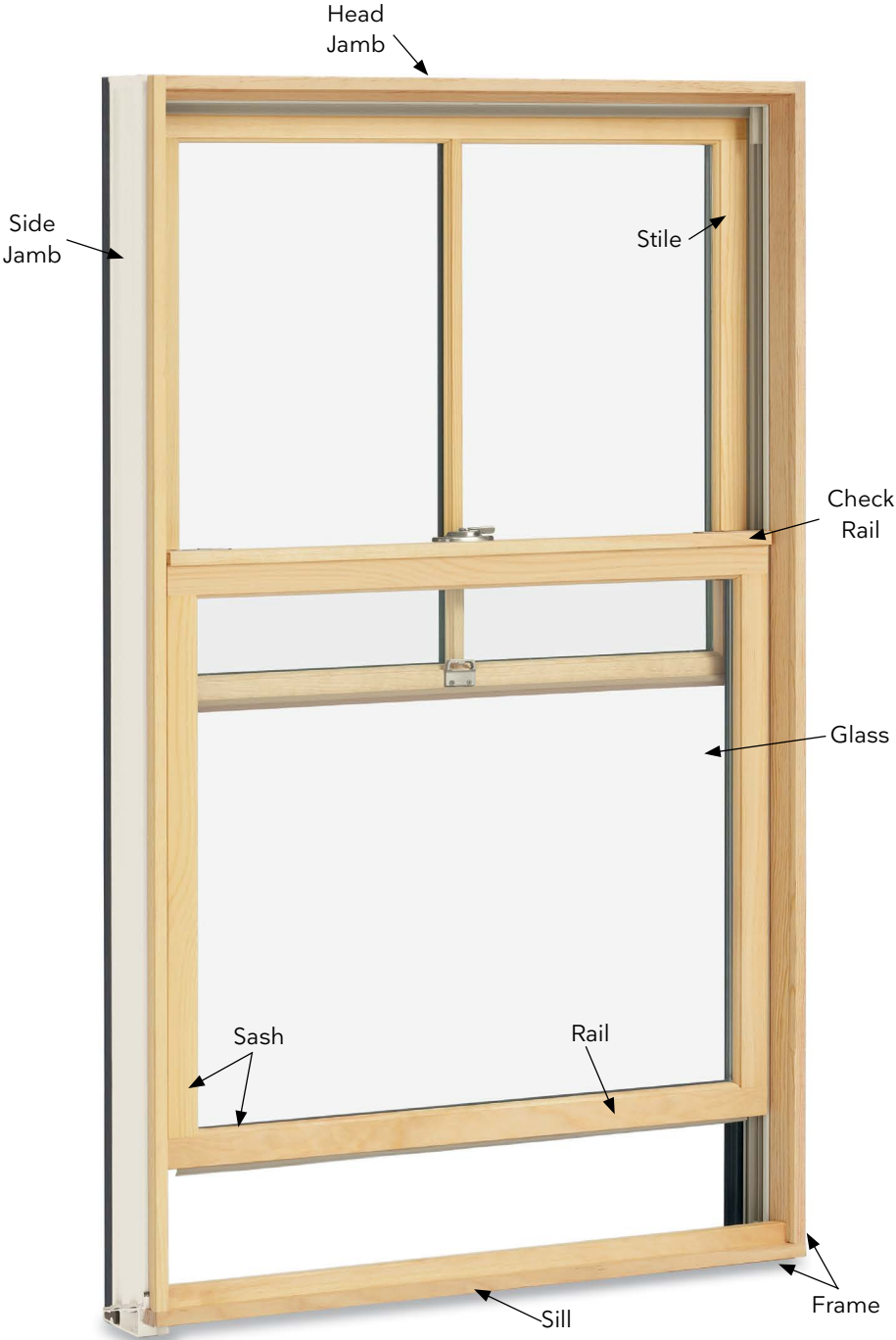

# Window Products

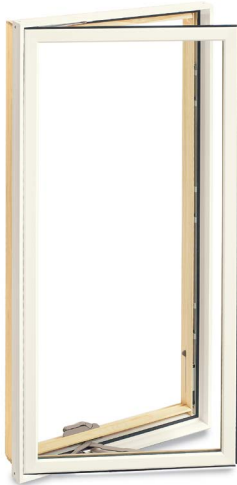

Casement



Awning



Double Hung



Glider



Polygon



Round Top

## Door Products



Sliding Patio Door



Sliding French Door



Inswing French Door



Outswing French Door

# Glass

## Condensation

Before reading this section, pour yourself a nice tall glass of ice water. During cold winters, there is a large temperature difference between the interior and exterior of your home. When the temperature drops outdoors, the glass on your windows tend to have a lower surface temperature than other surfaces in your home and is the first place that you'll notice condensation in your home. This is not due to any defect in your window or door, it's simply a sign of needing to reduce the humidity in your home.

Warm air is capable of holding more moisture than cool air. As warm vapor-filled air comes in contact with a cool surface it loses its ability to hold moisture. When moisture-laden air reaches its dew point, moisture condenses on the nearest cool surface. Generally the most obvious surfaces in your home where you'll notice condensation are on your windows or the glass of ice water sitting in front of you.

Condensation on your windows is an unsightly problem. The last thing you want is a fog blocking the view. But the problem goes deeper than that—if condensation is a chronic occurrence in your home, chances are that you have excessive humidity. If water is accumulating on glass, chances are it is accumulating on other harder to see surfaces such as wall and roof cavities. If left uncontrolled, excess moisture can have serious consequences, including:

- Mold or mildew
- Wood rot and warping
- Roof ice build-up
- Damp, ineffective insulation
- Discolored, blistered or bubbling paint
- Damaging moisture inside walls and attic

Excessive interior humidity is more likely to occur in newer or recently remodeled homes with tight, energy efficient construction, causing a build up of moisture to the interior. Information on excessive humidity and how to reduce condensation on your windows can be found on the Internet by searching for “*window condensation*”.

## Mildew Removal



### Warning:

To prevent personal injury during mildew removal, always wear protective eyewear, skin protection, and keep the area well ventilated.

### Exterior Mildew

Mildew thrives in warm, moist environments and will grow best under these conditions. However mildew can grow to some degree under most climatic conditions. Mildew growth is usually brown or black in color and, for this reason, may be mistaken for dirt on the exterior of your window or door.

Exterior mildew may be removed with an approved cleaning solution found at [marvin.com/cleaning](http://marvin.com/cleaning) applied with a soft bristle brush using medium pressure. Rinse the finish well with clear water after cleaning. Make sure the area is clean and reapply if the discoloration persists.

*Note: Stronger concentrations of cleaner may damage the exterior surface or finish.*

### Interior Mildew

If your home has excessive interior moisture, you may experience some discoloration on building materials in various parts of your home, including the lower portions of your windows or doors. This discoloration may be the result of mildew growth and can be removed with an approved cleaning solution found at [marvin.com/cleaning](http://marvin.com/cleaning). Wear protective eyewear and skin protection, and keep the area well ventilated. Make sure the surface is clean and reapply if the discoloration persists.

*Note: In some cases where the interior finish has been damaged it may be necessary to refinish the damaged area.*



## Cleaning the Glass

The best method to clean the glass on your Marvin® window is to first soak the glass surface with clean water to loosen dirt or debris. Use an approved cleaning solution found at [marvin.com/cleaning](http://marvin.com/cleaning) and apply cleaner with a non-abrasive applicator. Immediately after washing the glass, remove all of the cleaning solution with a squeegee, taking care not to allow any metal surface of the cleaning equipment to touch the glass surface. Make sure that no abrasive particles are trapped between the glass and the cleaning material. Window and door gaskets, sealants, and frames are susceptible to deterioration if cleaning solutions are not rinsed and dried immediately after cleaning.



### Caution:

Do not use razor blades, knives, or scrapers for cleaning glass surfaces.

## Tempered Glass

Certain Marvin windows use tempered glass for safety reasons. Tempered glass is heated and cooled at an accelerated rate, adding strength and shatter resistance. You may notice a slight amount of distortion – this is normal and due to the tempered glass fabrication process. The logo in the corner of each piece of tempered glass is required by code and safety regulations.

## Glass Breakage



### Warning:

Should the glass in your window or door happen to break, make sure you use the appropriate personal protection equipment to remove the broken glass; eyeglasses or goggles, sturdy gloves, and heavy protective clothing. Dispose of broken glass in a secure container. Failure to properly handle and dispose of glass could result in injury. Contact your Marvin retailer for information on sash or panel replacement.

## Glass Care DO's and DON'Ts

DO	DON'T
<ul style="list-style-type: none"> <li>• Clean glass when dirt and residue appear</li> </ul>	<ul style="list-style-type: none"> <li>• Use scrapers of any size or type for cleaning glass</li> </ul>
<ul style="list-style-type: none"> <li>• Determine if coated glass surfaces are exposed</li> </ul>	<ul style="list-style-type: none"> <li>• Allow dirt and residue to remain on glass for an extended period of time</li> </ul>
<ul style="list-style-type: none"> <li>• Exercise special care when cleaning coated glass surfaces</li> </ul>	<ul style="list-style-type: none"> <li>• Clean tinted or coated glass in direct sunlight</li> </ul>
<ul style="list-style-type: none"> <li>• Avoid cleaning tinted and coated glass surfaces in direct sunlight</li> </ul>	<ul style="list-style-type: none"> <li>• Allow water or cleaning residue to remain on the glass or adjacent materials</li> </ul>
<ul style="list-style-type: none"> <li>• Start cleaning at the top of the building and continue to lower levels</li> </ul>	<ul style="list-style-type: none"> <li>• Begin cleaning without rinsing excessive dirt and debris</li> </ul>
<ul style="list-style-type: none"> <li>• Soak the glass surface with clean water to loosen dirt and debris</li> </ul>	<ul style="list-style-type: none"> <li>• Use abrasive cleaning solutions or materials</li> </ul>
<ul style="list-style-type: none"> <li>• Use an approved cleaning solution found at <a href="http://marvin.com/cleaning">marvin.com/cleaning</a></li> </ul>	<ul style="list-style-type: none"> <li>• Allow metal parts of cleaning equipment to contact the glass</li> </ul>
<ul style="list-style-type: none"> <li>• Dry all cleaning materials with approved cleaners</li> </ul>	<ul style="list-style-type: none"> <li>• Trap abrasive particles between the cleaning materials and the glass surface</li> </ul>
<ul style="list-style-type: none"> <li>• Clean one small window and check to see if procedures have caused any damage</li> </ul>	<ul style="list-style-type: none"> <li>• Allow splashed materials to dry on the glass surface</li> </ul>

## Finishing the Interior on Elevate Products

If you have brand new, bare wood Marvin® Elevate collection products, you must finish it immediately to prevent possible damage to the wood. Make sure bare wood interior door surfaces are clean and dry. Remove any handling marks, debris, or effects of exposure to moisture by sanding lightly with fine sandpaper and wiping clean before applying your choice of finish. Marvin uses a rubber-like material between glass panes and wood sash frames to ensure a weather tight seal. Occasionally, an excess of this silicone sealant, called “squeeze out,” appears around the edge of the glass. You can safely scrape off squeeze out with a plastic putty knife without damaging the weather tightness of your unit. It is extremely important that you do not paint locks, hardware, weather strip, or jamb liners. Also, use paints, stains, and varnishes with care; they contain solvents which may come in contact with plastics and vinyl weather strip, cause these materials to lose their flexible qualities.

### Caution:



Do not apply paint to Marvin factory pre-finish without first contacting your Marvin dealer for proper instructions.

## Painting

When painting Elevate collection product interiors, use only a high quality oil base or latex paint. To provide a good adhesion of paint, a compatible prime coat should be applied. Paint with panels open (or removed) and do not close until thoroughly dry. Apply one coat of primer and two coats of top quality paint according to the paint manufacturer’s instructions.

## Staining



Prior to staining it may be desirable to apply a wood conditioner to obtain a more even finish. Follow the manufacturer’s recommended instructions.

When painting Elevate collection product interiors, apply stain according to the manufacturer’s instructions. Apply as many coats of stain as necessary to achieve the desired color. After the stain is thoroughly dry, apply at least two coats of sealer (i.e. varnish or polyurethane).

## Ultrex® and Maintenance

Marvin Elevate and Essential collection products feature Ultrex, an advanced glass fiber reinforced material, with a finish coat applied during the fabrication process. This factory applied durable finish allows the exterior to withstand extreme temperatures and atmospheric pollutants, while retaining its color and gloss. This translates into a beautiful, low-maintenance exterior. Surface dirt can be removed by washing with an approved cleaning solution found at [marvin.com/cleaning](http://marvin.com/cleaning) and rinsing with clear water. Use a soft brush, such as a long-handled car washing brush, to remove any bugs, grime, dirt, or dust. Before using more aggressive cleaners on stubborn stains, test the solution on an inconspicuous area before washing. A thorough clear water rinse should follow.

## Cleaning Ultrex

For regular cleaning and maintenance of Ultrex, use an approved cleaning solution found at [marvin.com/cleaning](http://marvin.com/cleaning).

The approved cleaning solutions, when used as directed, can be used on Ultrex materials.

The approved cleaning solutions are not recommended for use with any abrasive materials or applicators. Extreme pressure or scrubbing action is not recommended. In addition, the approved cleaning solutions may leave a residue on the Ultrex surface following their use.

### Caution:



No solvents, paint thinner, or other chemicals of any type are recommended for use with Ultrex, as they may affect the functionality and appearance of the coating.

## Repairing Ultrex

You will need to supply:

- Utility knife
- Quality exterior grade primer
- Putty knife
- 120-150 grit sandpaper
- Epoxy putty
- 320-400 grit sandpaper

*Note: Consult your Marvin® representative for information on locally available epoxy putty.*

1. Using a utility knife carefully cut around the damaged Ultrex area to remove any jagged edges or loose fibers.
2. Follow manufacturer's instructions for mixing/blending of epoxy. Fill the damaged area thoroughly by pressing epoxy in with a putty knife and remove excess.
3. Once the epoxy has set and cured, sand the repaired area with 120 -150 grit sandpaper, until the desired profile/ depth has been achieved. Finish sanding with 320-400 grit sandpaper.
4. Lightly sand the surrounding area to remove the factory finish with 320-400 grit sandpaper. Coat the repaired and surrounding area with a quality primer per epoxy manufacturer's instructions. When primer has dried and cured, cover with a quality exterior grade acrylic latex coating (See Painting Ultrex).

## Painting Ultrex

You will need to supply:

- Foam paint brush
- 320-400 grit sandpaper
- Masking tape
- Quality exterior grade acrylic latex paint



Spot test a small area using the following procedures. After the seven to ten day Acrylic latex paint cure time check to see if the paint has adhered to the unit. If the paint has not adhered to the surface, recheck the surface preparation procedures.

1. Thoroughly sand the factory finish with 320-400 grit sandpaper.
2. Wash the surface with water and an approved cleaning solution found at [marvin.com/cleaning](http://marvin.com/cleaning) to remove contaminants, rinse with clear water and dry thoroughly.
3. Mask any window components that will not be painted.
4. Coat the Ultrex with a quality exterior grade acrylic latex paint.
5. Acrylic latex products gain full adhesion after seven to ten days cure.

*Note: If the finish is scratched, peeled or otherwise compromised down to the Ultrex substrate see "Repairing Ultrex" section.*

## Screen Care and Maintenance

The most effective method of cleaning the screens on your windows and doors is to remove the screens, lay them on a flat clean area (such as a sidewalk), and spray off any dust or debris with water from your garden hose. Allow the screens to completely air dry before replacing in the window or door. If you live in a cold climate, it is recommended that in the winter you remove the screen from your doors. The mesh may collect snow and ice, causing it to sag. Please see individual sections for instructions on screen removal.

*Note: Certain size screens have a factory bow in the frame; this is to ensure a snug fit and is NOT a defect.*

### Caution:



Marvin screens are designed to stand up to everyday use. However, these screens were not intended to act as a safety device. Do not allow children to sit or play on window sills, or to push or fall against window screens, as this could result in a fall through the window or door opening.

Every screen installed on a Marvin product has a non-removable label affixed to it that states:



### Warning:

Screen will not stop child from falling out window. Keep child away from open window.

## Maintenance, Operation, and General Service

In the following pages you'll find maintenance information on individual Marvin products. Refer to the product illustrations for the names of your particular windows or doors.

Information in this section includes maintenance tips and operational tips, such as removing the window sash. Read completely through the instructions before beginning to work on your windows to make sure you have any necessary tools and parts.

Exterior finishes on doors can be cared for in the same manner as Marvin windows. See interior and exterior maintenance information. Take care with your door's sill—make sure you prevent damage by not getting any paint, solvent, or chemicals on sills. See individual door sections for any specialized sill care.

If you are having problems not explained in this manual, or if the solution seems inappropriate for your problem, contact your local Marvin retailer.



When contacting your Marvin retailer it may be helpful to provide them with the "Glass Part Number" etched on the upper right corner of the glass.

Glass Part Number

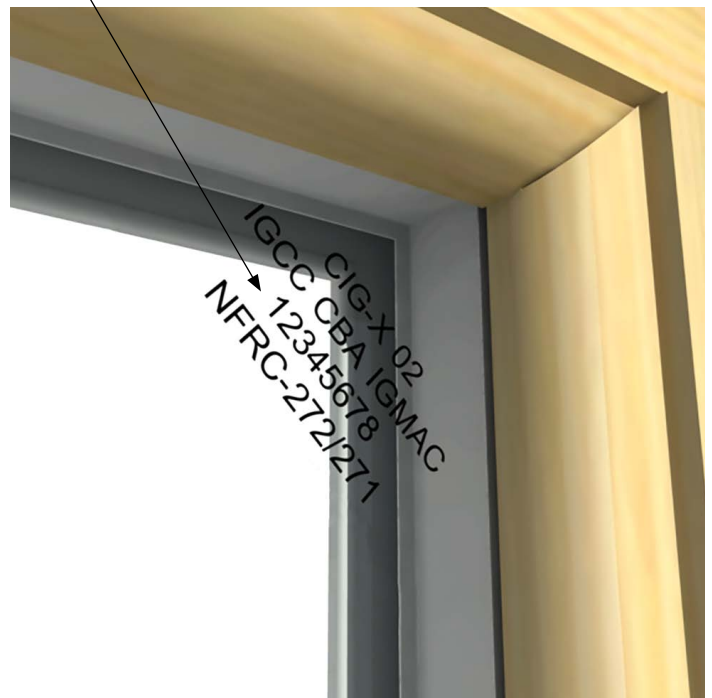

## Casement

### Operation and Maintenance

The roto-gear is the operating mechanism that crank to open and close casement and awning windows. Casement locks seal the window tightly closed. Excessive cranking when closing window does not improve the seal and may damage roto-gear.

Roto-gears should be lubricated once a year with white lithium grease (available at any hardware store) to keep operation smooth. The hinge joints and locking mechanism should be lubricated on occasion with a silicone based spray. Be sure to clean off all dirt, debris or sand before lubricating.

#### Caution:



Excessive lubrication may cause damage to the window's finish. Make sure that any excess is immediately removed.



The sash tracks should be occasionally cleaned out with a soft bristle brush. If the casement window is less than 24 1/4" (622 mm) in width, roto-gear arms and assembly may differ from those shown.

## Removing and Installing the Screen

To remove casement/awning screen, grasp screen plungers. Pull plungers to release. Tilt screen toward you, and lift screen from channel. To install casement/awning screen, reverse above procedure.

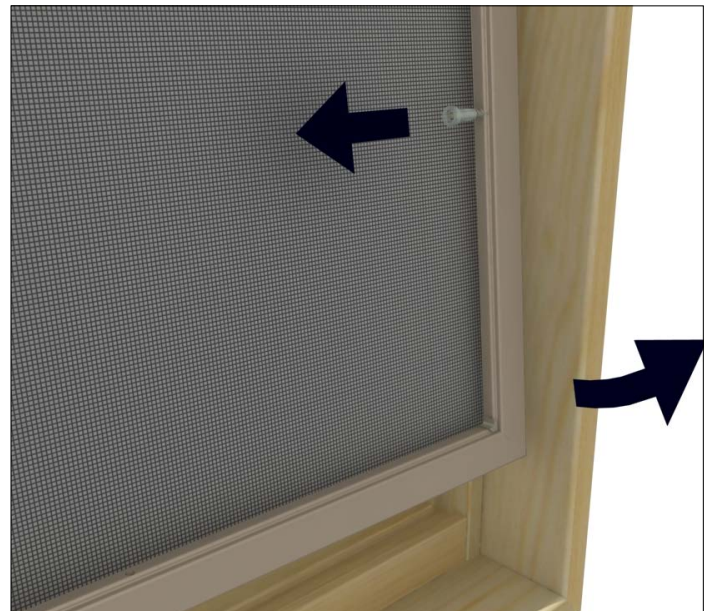

# Awning

## Operation and Maintenance



Awning hinges, roto-gear operator arms, and sash guides can be oiled with a few drops of light household oil or silicone spray. Operating hardware should be lubricated during your annual inspection. Simply crank open the window and lubricate hardware with white lithium grease. Interior and exterior finishes can be cared for in the same manner as any other Marvin® product.

### Caution:



Excessive lubrication may cause damage to the window's finish. Make sure that any excess is immediately removed.

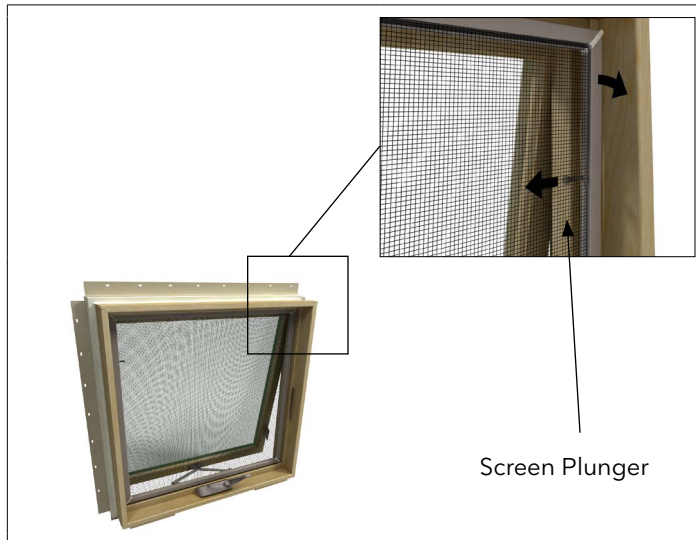

# Essential Casement and Awning Screen Removal

To remove Essential Casement/Awning screen, lift the screen at the bottom to compress the springs at the top. Pull the bottom of the screen out and remove from frame.

*Note: Essential product shown.*

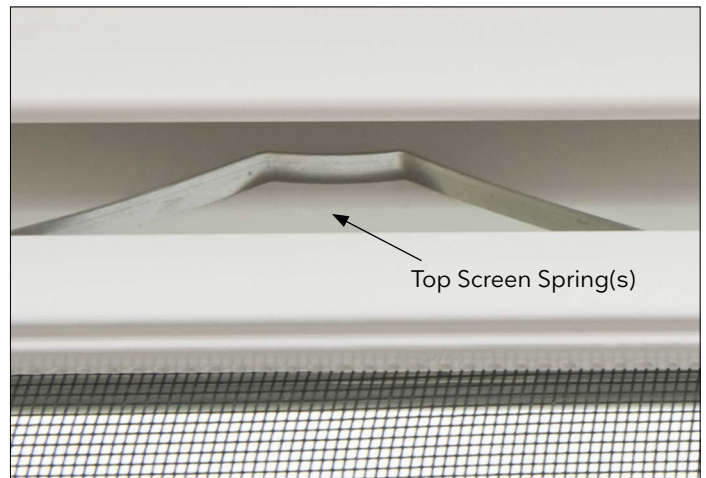
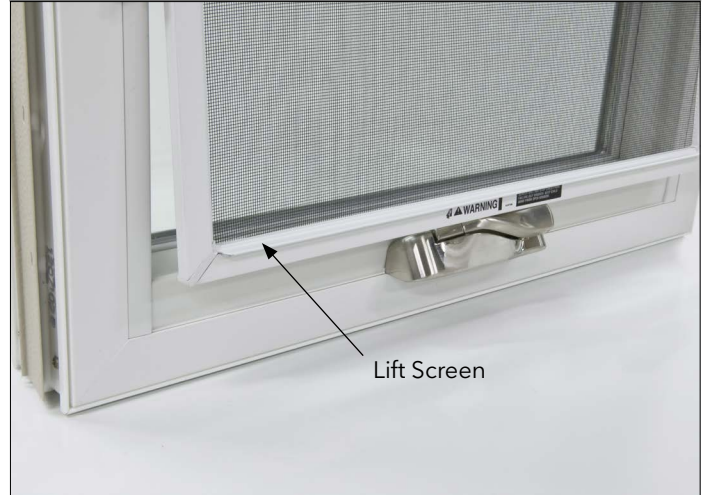

## Double Hung

### Operation and Maintenance

Periodically clean the jamb liners where the sash slides. Keep them dirt and grease free by washing with a gentle dish detergent. Check the exterior caulking on your double hung windows annually.

### How to Tilt Double Hung Sash (for ease of cleaning)

1. To tilt the bottom sash inward, unlock and raise the sash about 3" (76 mm). Grasp both tilt latches (found on the check rail), slide inward and tilt the sash toward you to a horizontal position. See illustrations below.
2. To tilt the top sash inward, lower the sash about 6" (152 mm). Grasp both tilt latches (found on the top rail), slide inward and tilt the sash toward you to a horizontal position. See illustrations below.



### How to Remove the Double Hung Sash

1. To completely remove the sash from the frame, hold the sash at 90 degrees to the frame as shown. Release the sash pivot pins from the clutch assemblies by first raising the entire sash 1"- 2" (25-51 mm). Then raise just one side of the sash further until the sash pivot pins clear the jambs, remove to interior.

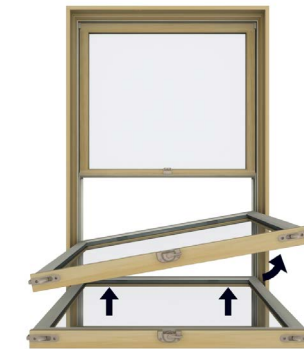

### Installing a Double Hung Sash

1. To install the top sash, hold the sash horizontally at 90 degrees to the frame. Guide the sash pivot pins into the exterior sash track on the jambs above the clutch assemblies, lower both sash pins onto the clutch cams making sure the bottom of the sash is level when pins are completely engaged. Slide each tilt latch release toward the center of the unit and gently ease the sash into position. Release each latch into the exterior sash track, lower the sash slightly then raise to the fully closed position. Check operation of sash.
2. To install the bottom sash repeat the installation procedure used for installing the top sash. Utilize the interior sash track and lower sash into the closed position, check operation of sash and lock.

## Removing the Double Hung Screen

To remove the screen to the interior, grasp the lower screen plungers and pull to release as shown in illustration. Push screen outward and pull down slightly. Turn the screen sideways and bring into dwelling.

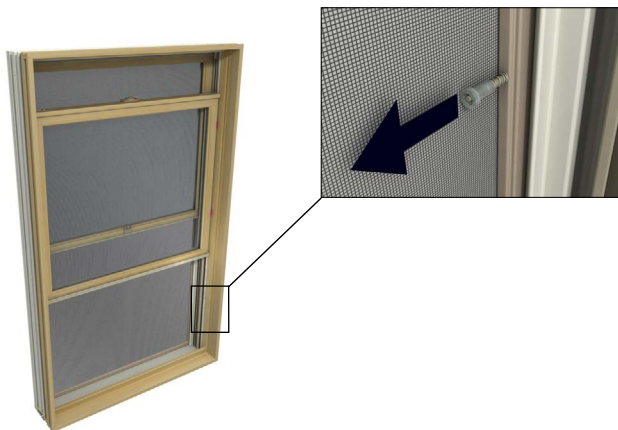

## Resetting a Slipped Clutch Assembly



### Caution:

Clutches are under extreme spring tension.

Measure the clutch dimension from sill on the opposing balance assembly for the same sash and temporarily mark that dimension on the jamb carrier that contains the released clutch, must be within 1/8" (3 mm). Using a flat screwdriver, rotate the balance clutch cam in the clutch assembly to the released position. Hold the screwdriver firmly and slide the clutch assembly down the jamb carrier to the mark. Rotate the balance clutch cam to the open locked position (cam opening up). Release the screwdriver carefully from the clutch assembly (it must lock in place or damage will occur). Compare clutch heights from the sill for the sash affected. They MUST be within 1/8" (3 mm) of each other or damage may occur when sash are reinstalled, adjust height as needed.



## Glider

### Operation and Maintenance

Periodically clean the tracks where the sash must slide. Keep them dirt and grease free, and spray them lightly with furniture wax to prevent sticking. Be sure to wipe off any excess wax.

### Sash Removal

Slide the operating sash to stationary side of the unit (approximately 2"-3" (51-76 mm) from stationary jamb). With latches depressed, located at the top of the sash, tilt the sash inward until it clears the unit frame; lift the sash off the sill track. To replace the sash, reverse the above procedures.

*Note: Only the operating sash of a Glider can be removed from the frame.*

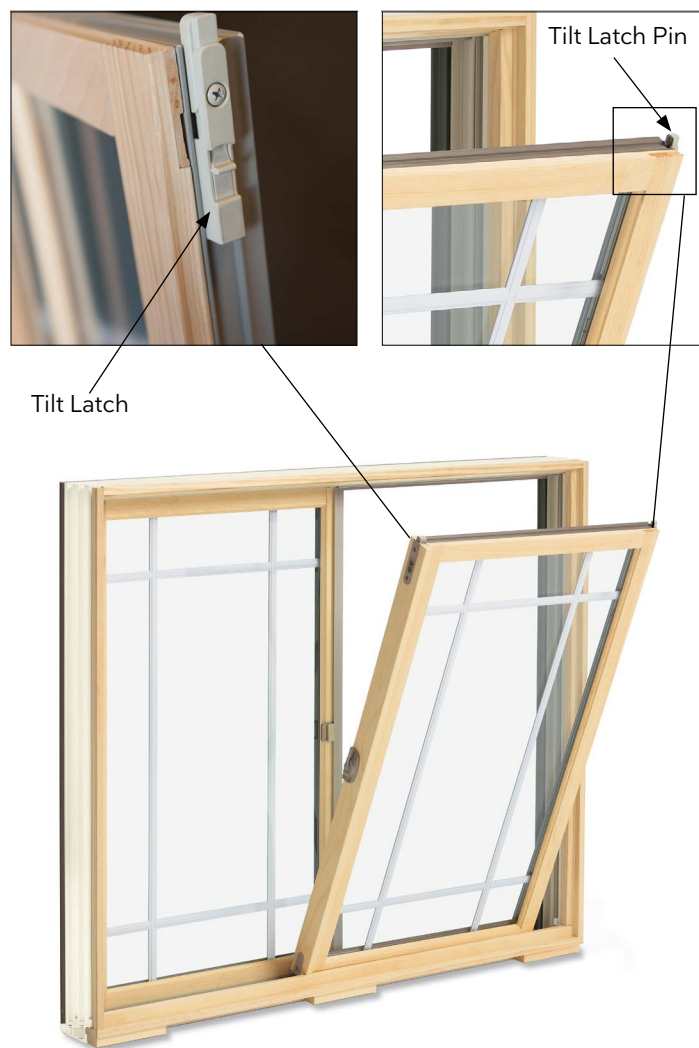



## Removing and Installing the Screen

To remove the screen grasp and pull inward on both plunger bolts and push outward on the screen. Grasp the frame of the screen and pull down slightly on the screen until it clears the screen channel. Turn the screen sideways and bring it in through the bottom sash opening. To replace the screen reverse the above procedure.

Replace the screen with the operator sash completely open and position the screen on the exterior of the window with the springs toward the meeting stile of the unit. Making sure the springs are seated in the screen channel, pull on side tabs until the screen clears the frame. Pull screen in toward the interior until the jamb stile of the screen aligns with screen channel; release pin.

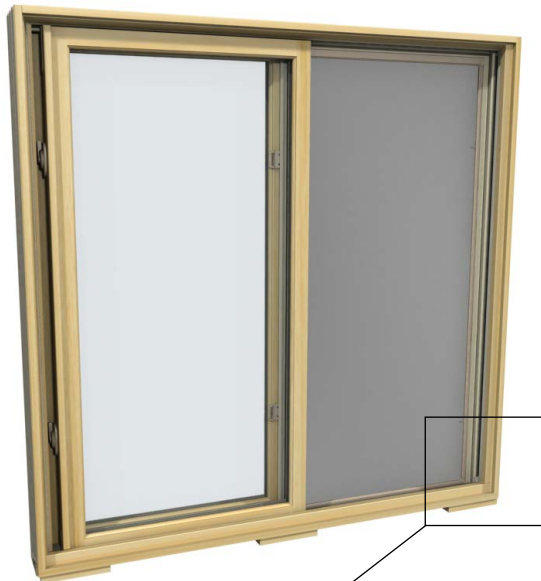

*Note: Pull pin away from frame, then push out.*

## Patio and Sliding French Doors

### Operation and Maintenance

The Patio and Sliding French Doors require very little maintenance to keep them functioning efficiently. Most problems can be eliminated by keeping the sill clean, ensuring smooth door operation. Chemicals, solvents, paints and other harsh substances should never come in contact with the sill. Remove any paint, grease, or caulk with 50% isopropyl alcohol. Door handles can be wiped down with a damp cloth to remove fingerprints and smudges.

It is very seldom that door rollers, lock, and hinges require lubrication. Occasionally use spray lubricant to keep operation smooth (rollers are visible underneath the operator panel). If you live in a cold climate, it is recommended that you remove the screen door in the winter. The screen mesh may collect snow and ice, causing it to sag.

### OXXO Operation

Opening - unlock the primary operator panel from the secondary operator panel, slide open. To unlock the secondary operator panel flip the two actuators, then slide open.

Closing - shut the secondary operator panel first, then flip the two actuators. The secondary operator panel must be locked before trying to shut and lock the primary operator panel.

## Removing the Screen

To remove the screen panel, unlock and partially open the screen door. From the exterior, pry the screen panel guide up with a putty knife starting at one corner. Pull the guide off the track working your way toward the other end. Once the bottom of the screen panel is completely released from the sill track, pivot the bottom of the screen out and push the top of panel approximately 5 degrees toward the head jamb.

This will release the screen panel rollers from the head jamb screen track. Remove the panel from the door.

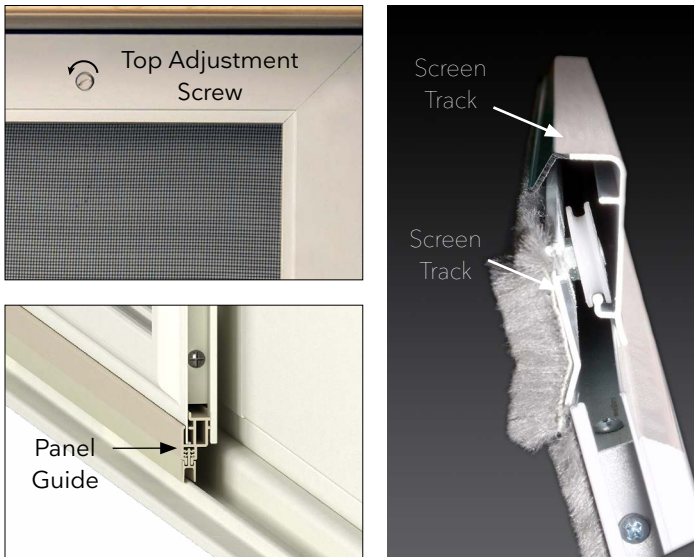

## Installing the Screen

To reinstall the screen, hold the screen panel with the top rollers facing you. While tilting the bottom of the screen panel away from the door, lift the rollers into the screen track and pull the panel toward your body to engage the rollers in the track. Make sure the rollers are seated in the track by moving the screen panel back and forth. Once you are sure the rollers are fully seated, pivot the screen panel into position toward the sill and place the bottom screen panel guide into the sill track by lifting it with your fingers or by lifting with a stiff putty knife.

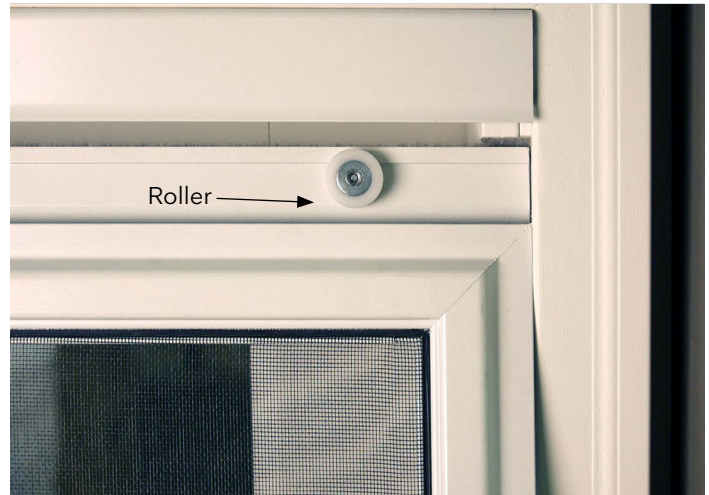

The screen can be adjusted from the interior by loosening or tightening the top roller screw nearest the locking jamb. Adjust the screen so that it is parallel to the locking jamb or casing. An even reveal should be achieved along the entire height of the jamb.

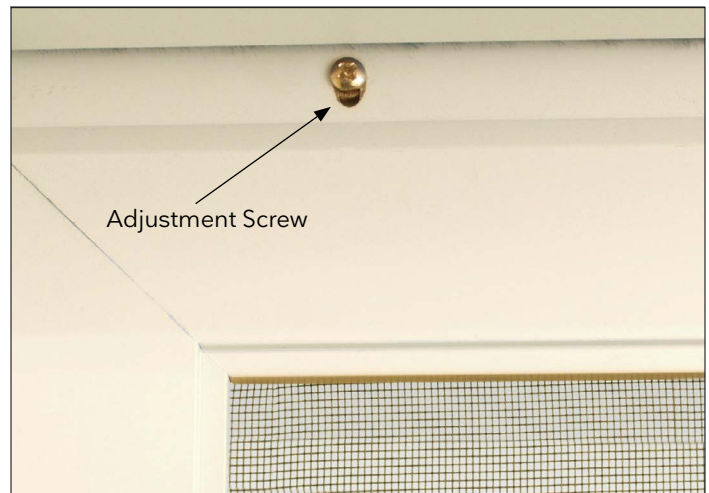

## Removing Sliding Door Panels

Removing door panels is a relatively complicated procedure. If you need them removed, please contact your Marvin retailer for a service person to remove the panel for you, or reference our detailed installation or panel removal instructions online at [marvin.com](http://marvin.com).

# Swinging French Door

## Operation and Maintenance

The French door requires very little maintenance. To maintain sill appearance, wash with a mild soap and water solution.

Remove fresh paint splashes, grease or caulk with 50% isopropyl alcohol. If door panels need to be removed for moving or other reasons, please contact your Marvin® retailer for either detailed instructions or for a service person to remove the panel for you.

Keep the sill weep area clear of debris and sealants.



## Handle Operation for Multi-Point Lock

Always close and lock your passive panel first and the operating panel (with thumb turn) second. Marvin's multi-point hardware has locking bolts at the head and base of the door. Lifting the handle 45 degrees upward will set the head and foot bolts in place for a secure seal. A 90 degrees turn of the key from the outside or the thumb turn on the inside will lock the dead bolt in the handle assembly. When the dead bolt is unlocked, downward pressure on the handle will release the bolts to latch and the door will open. Securely lock by engaging the dead bolt, head and foot bolts; using only one or the other does not offer full security.

### Unlocked Position

Head Bolt Retracted

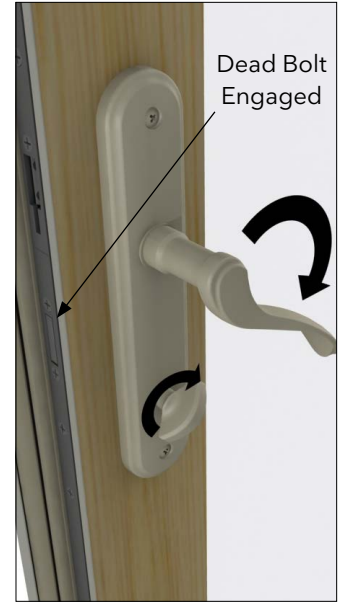

### Locked Position

Head Bolt Engaged

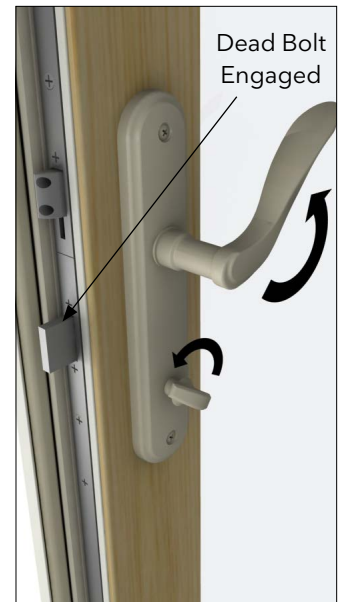

## Hinge Adjustment Procedure

Note: (Inswing door shown) For Outswing door view panel clearance from exterior.

It may be necessary to make minor adjustments to your Marvin Inswing French Door after it has been permanently installed, the adjustable hinge system allows or adjustments to be made.

**IMPORTANT:** Adjustable hinges are not intended to compensate for an improperly installed unit.

1. Adjustment should only be made when panel misalignment is visible or causes poor operation of door/lock. Make any adjustments in small increments, check results, readjust or proceed as required.

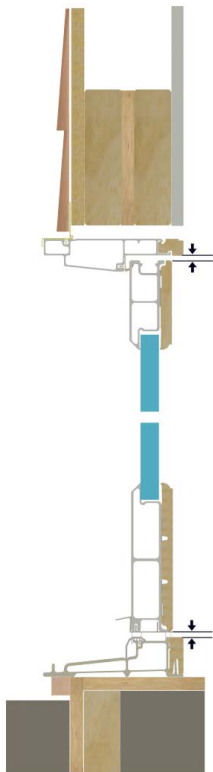

2. Check panel clearance at sill and head jamb. The panel should have 1/8-5/32" (3-4 mm) clearance at head jamb and 5/16-3/8" (8-10 mm) at bottom and 1/8-5/32" (3-4 mm) at side. Align panel vertically as needed by rotating the hinge adjustment screw with a 5/32" hex key, starting with the bottom hinge and working towards the top hinge. Repeat the process as necessary adjusting one rotation at a time. Check results, readjust or proceed as required. See Illustration.

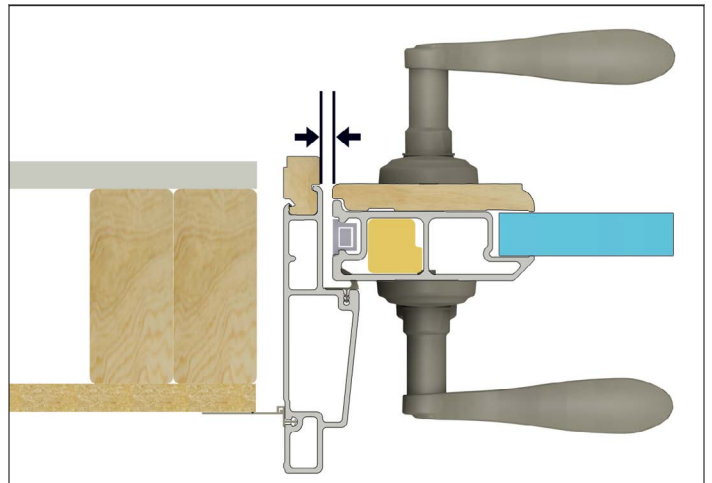
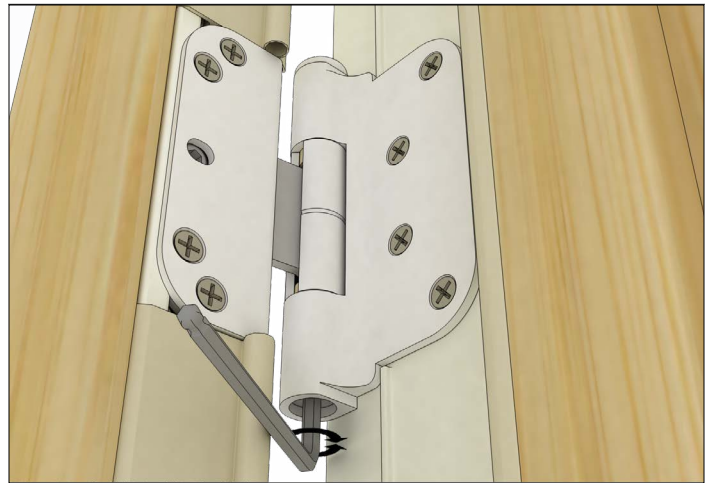

3. Check alignment with locking jamb; panel should have 3/16" (5 mm) clearance along the jamb. Rotate horizontal adjustment screw clockwise to increase, counterclockwise to decrease jamb/panel clearance at the appropriate hinge i.e. if increasing clearance at top, bottom hinge may have to be adjusted to decrease clearance to avoid hinge binding. See Illustration.



4. After panel alignment is corrected, recheck latch and dead bolt operation.

## Inswing Door

### Screen Removal

In cold climates, removal of the screen door is recommended during winter months to avoid snow and ice from collecting, causing the mesh to sag. To remove the swinging screen door, first open the active screen panel and disconnect the auto closer. Remove the #6 x 1/2" screw attaching the closer to the head jamb bracket. Then remove the hinge pins from the active screen panel hinges, remove the panel from the hinges and store. On XX configurations, open the passive screen panel and remove the hinge pins in the same manner as the active.

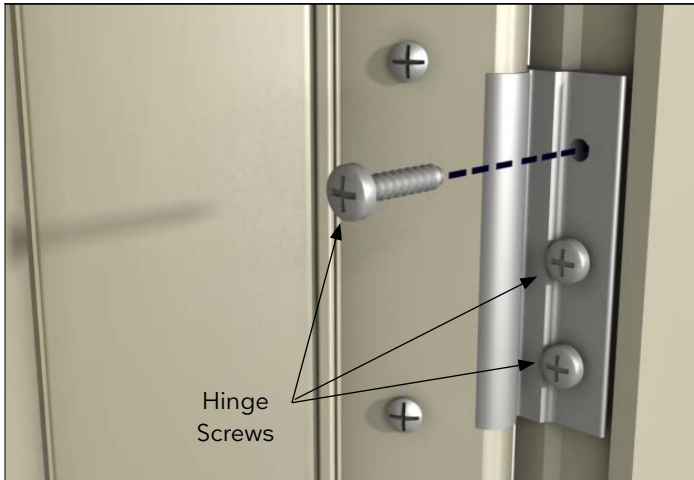

### Adjust Closer Tension

Adjust the closer tension on swinging screen doors by loosening the two screws attaching the door bracket to the screen panel. Slide the bracket and closer left or right as needed and tighten screws. Adjust the closer speed by tightening or loosening the adjusting screw located at the rear of the cylinder assembly.

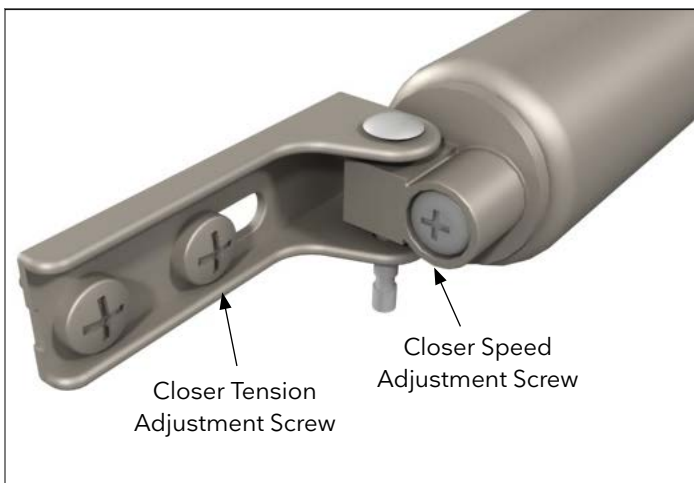

## Care of PVD Finishes

### Hardware with a Physical Vapor Deposition (PVD) Finish

PVD finished products have undergone a state of the art process known as Physical Vapor Deposition. A layer of hard-wearing metals are deposited onto the solid brass substrate which means it has been given a tough finish to resist fading and discoloration by direct sunlight, humidity, and most other environmental factors, even in coastal areas.

To help retain the appearance of PVD products for many years to come, a little periodic maintenance is required to remove any atmospheric deposits from the surface of the product.

- Once every two months clean the surface of the product thoroughly with a soft cloth moistened with light soapy water.
- To remove heavier deposits, an approved cleaning solution found at [marvin.com/cleaning](http://marvin.com/cleaning) may be used with a moistened cloth. Remove traces of water and cleaner and dry thoroughly with a soft cloth.
- When using any proprietary cleaner always follow the advice given by the manufacturers in handling cleaning materials.

Do not use any abrasive cleaning materials or solvents when cleaning PVD products.



Since we opened as a family-owned and -operated lumber and cedar company in 1912, Marvin has designed products to help people live better. We remain committed to bringing beauty and simplicity into people's lives with windows and doors that stand the test of time.

[MARVIN.COM](https://www.marvin.com)