

HORIZONTAL MULLS: The mull pin is attached to the lower unit (1). Use the same procedures as outlined previously.

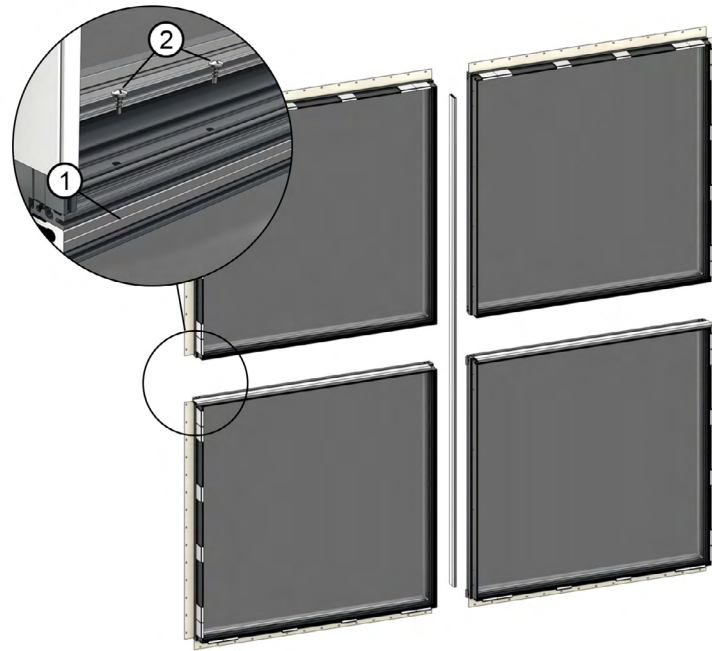

MULTIPLE HIGH/WIDE MULLS: A continuous mull pin (2) must be applied to the mull with the shortest span. Non-continuous pins will be factory installed (1).

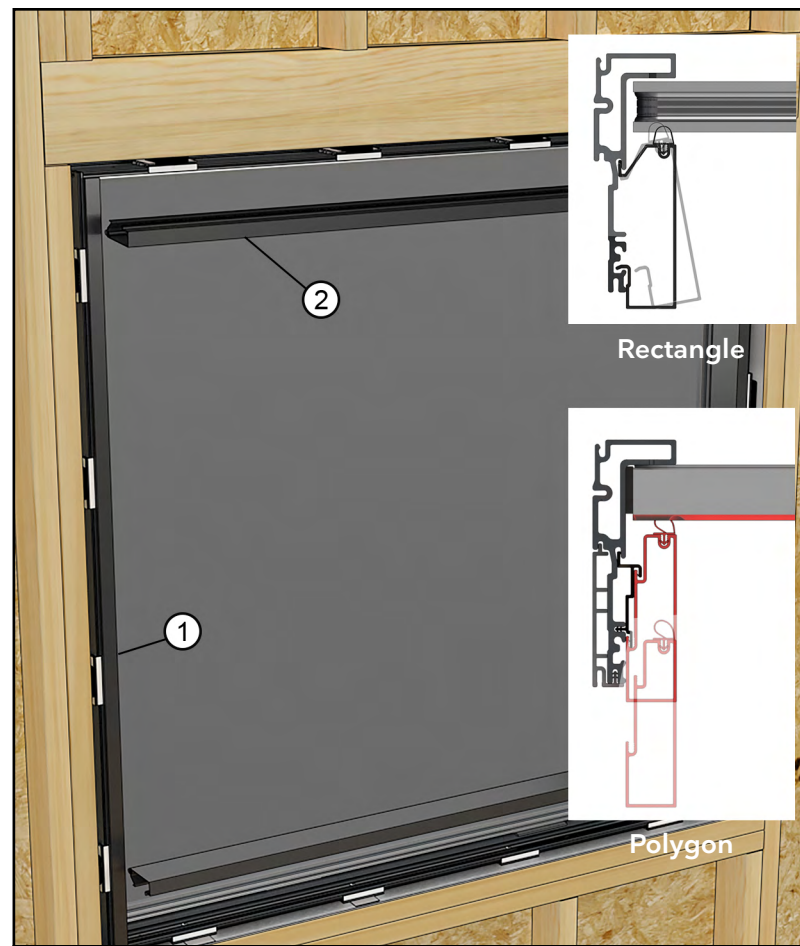

INSTALL THE JAMB COVERS: Slide the front of the glazing stop into the frame kerf, rotate, and push until it snaps into place. Start with the side jambs first (1) then the headjamb and sill next.

Modern Quickstart Guide

Direct Glaze



Installation and Mulling Instruction
19916016 - 2023-03-03

INTRODUCTION

This instruction is a reference tool for installers to quickly summarize the major steps of an installation and to provide links to the full detailed instructions, videos and other tools. The installer **MUST** read the full instructions in their entirety and rely on that document for all warnings, procedures, and standards.

Download a bar code scanner or QR Code scanner for your mobile device and scan the QR code to open a PDF version of the full instructions. Some sections also have QR codes that link to animated videos and other resources.

WARNING! DO NOT lift or move without proper equipment. Read, understand, and follow all lift equipment manufacturers' instructions and safety information.

IMPORTANT LINKS

- Full Instructions: https://www.marvin.com/download?Pub_ID=4334
- Rough Opening: https://www.marvin.com/download?pub_id=366
- Direct Glaze Animations: <https://www.youtube.com/playlist?list=PLUYVRttwmO3TMD9EtSuSv7tumQikb5Qdb>



Open PDF

Installing a Single Wide Assembly



FLASH THE INSTALLATION: Install a rigid head flash, flash the jambs and head jamb and seal appropriately to your wall condition.

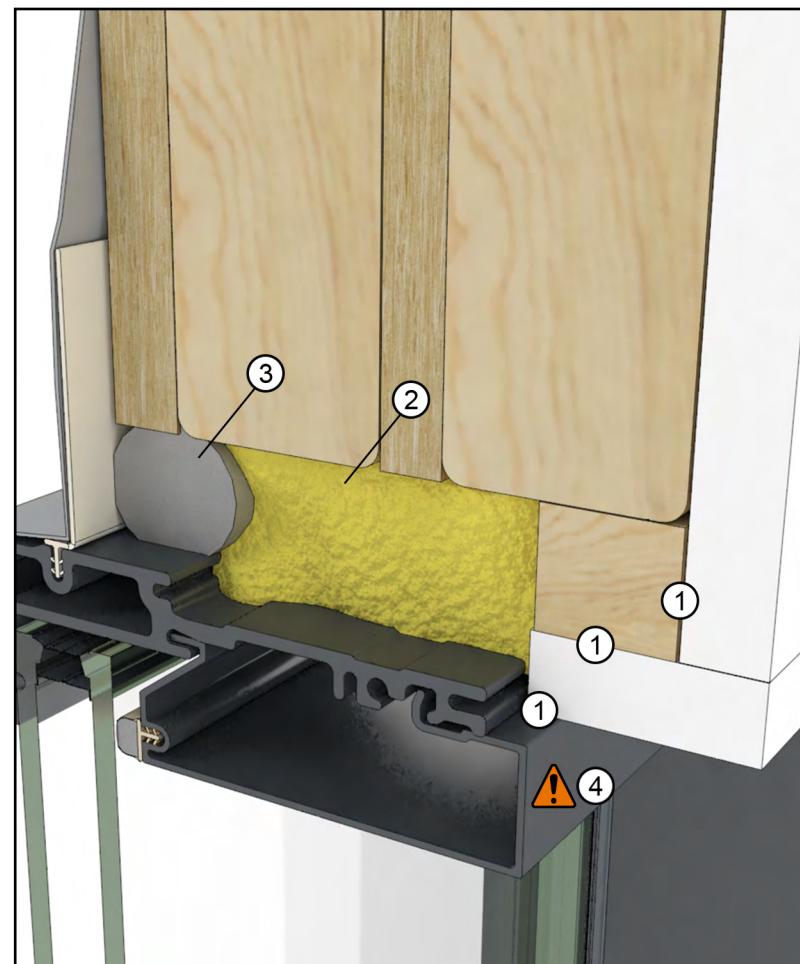

INSULATE THE OPENING. Use backer rod (3) and either loose fill or low compression foam (2). Seal all joints at the interior where sheet rock returns to the window (1).

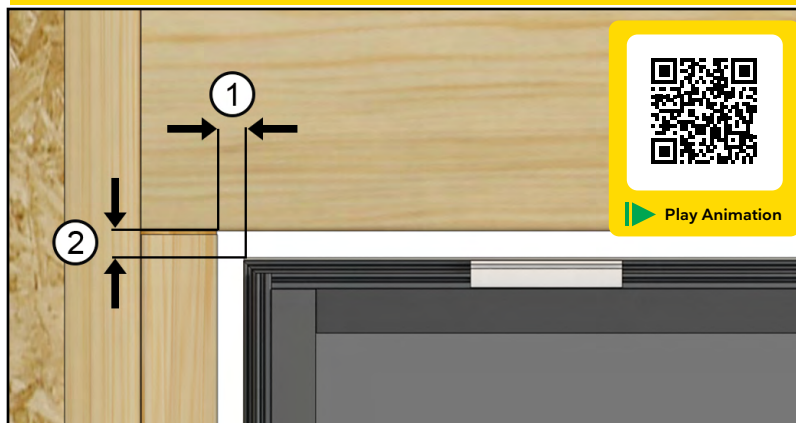

STEP 1 Rough openings may be up to 3/4" wider than the the frame width (1) and height (2).

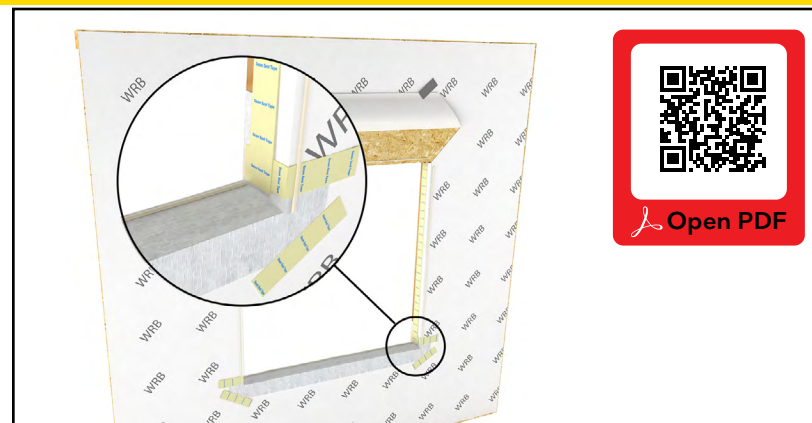

STEP 2 Prepare the opening. Refer to the rough opening preparation instructions found online.

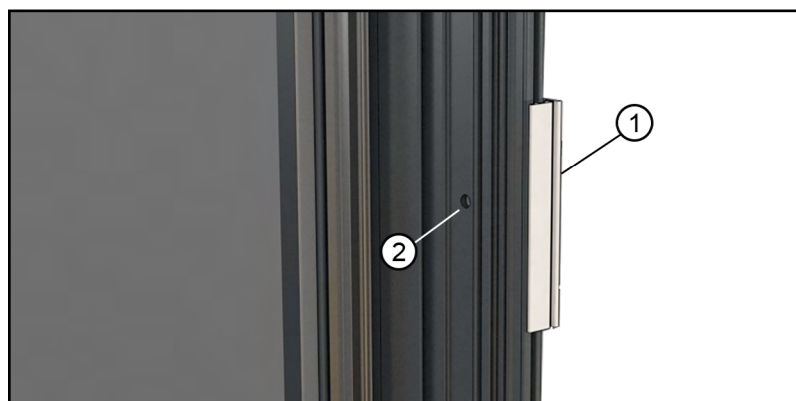

STEP 3 Shim blocks (1) are installed at every hole location. Make sure they are centered over the installation hole. Jamb fastening is required.



STEP 4 Start with a level sill. Shim to adjust if necessary. (Steps continue inside)

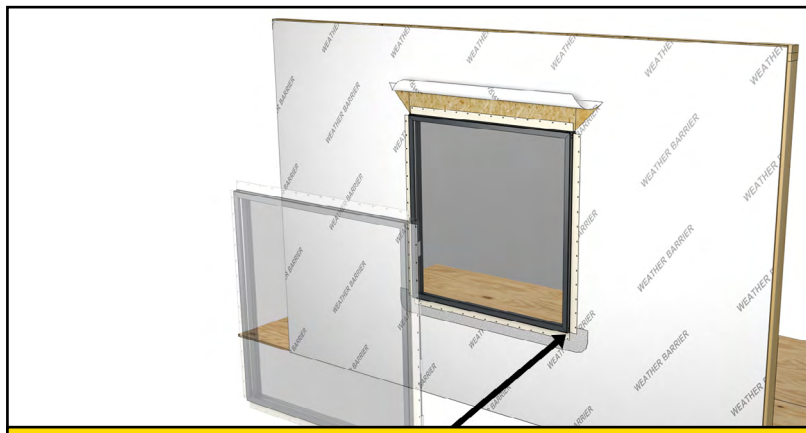

STEP 5 Center the window in the opening.

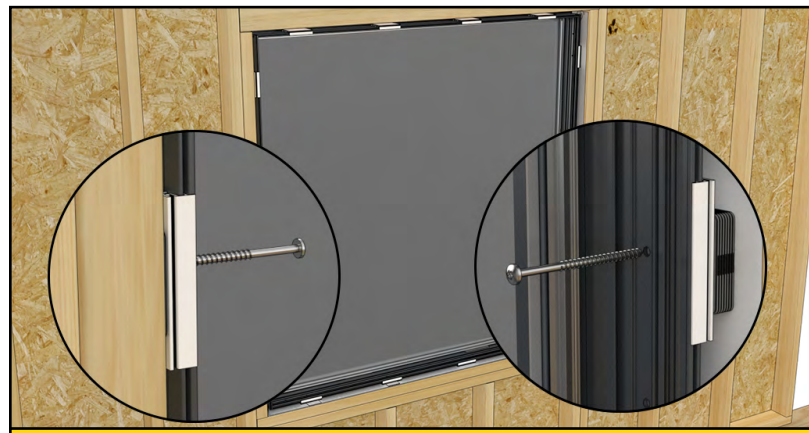

STEP 6 Shim and fasten at the bottom corners.

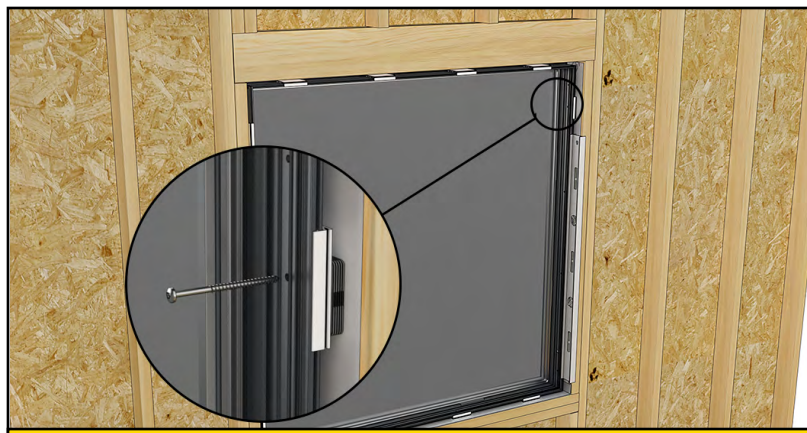

STEP 7 Plumb the jambs then fasten at the top.

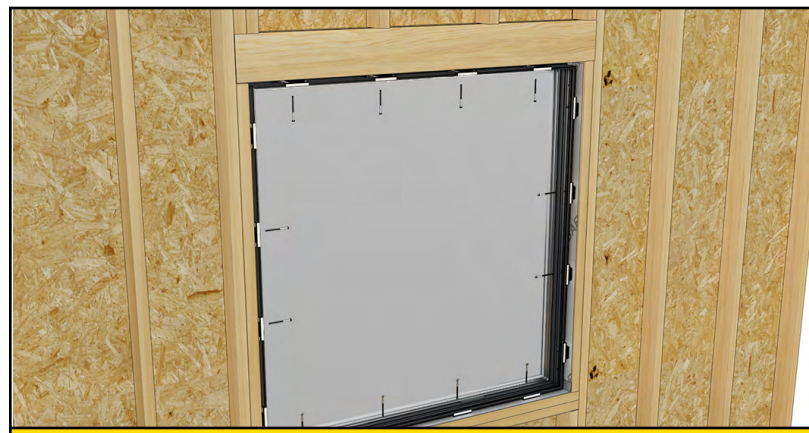

STEP 8 Complete fastening at every installation hole in the frame. Continue to section on cover installation.

Mulling Assemblies in the Rough Opening

The following steps demonstrate mulling assemblies in the opening. Units are prepped for mulling and include an attached mull pin to the right hand side of the left side unit (A1 as seen from the exterior). Subsequent units at the middle of the mull will have the mull pin fastened to the right hand jamb at the factory. Units prepped for mulling will also have the shim blocks attached at the fastener locations, mull foam pads, and nailing fin where applicable.

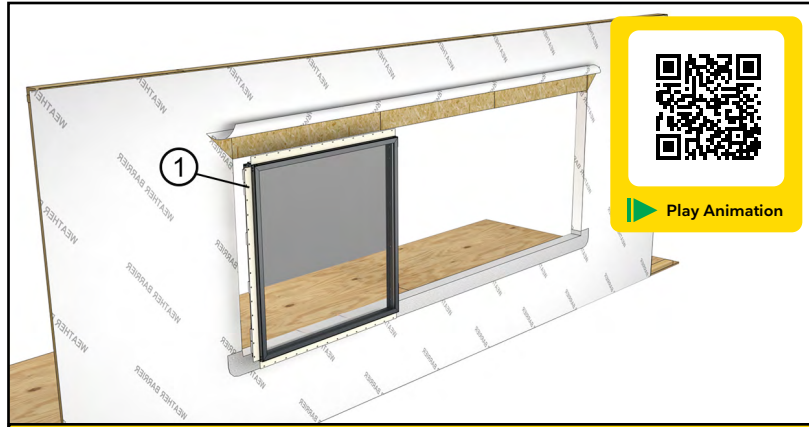

STEP 1 Use the same techniques found in the first section to set the first unit in place.

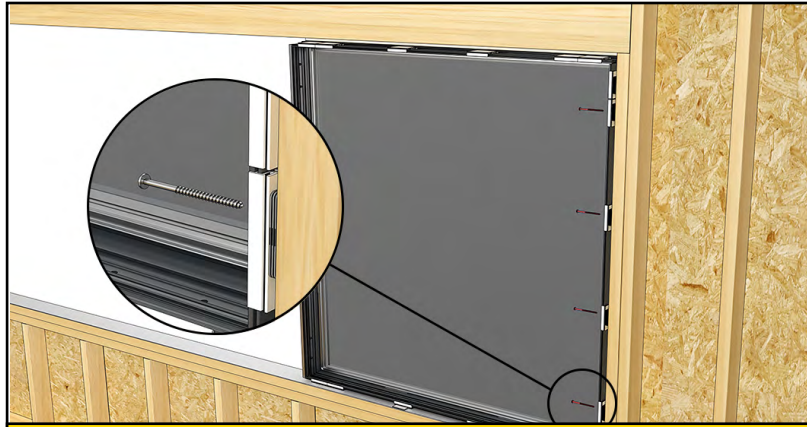

STEP 2 Fasten the jamb side.

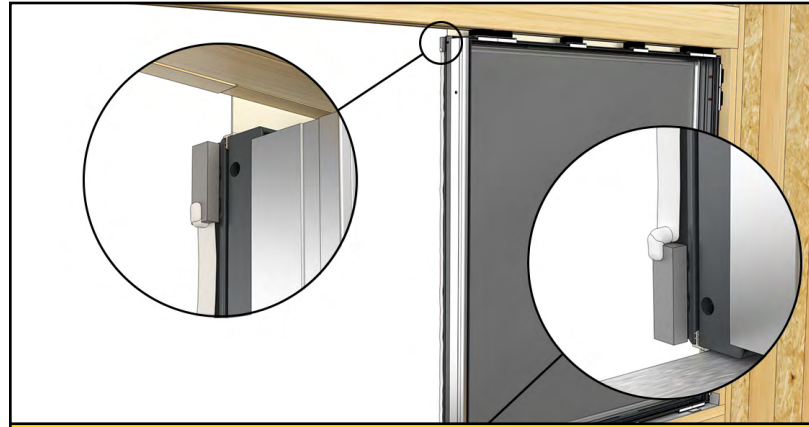

STEP 3 Apply a bead of sealant over the foam pads at the top, down the jamb and over the pad at the bottom.

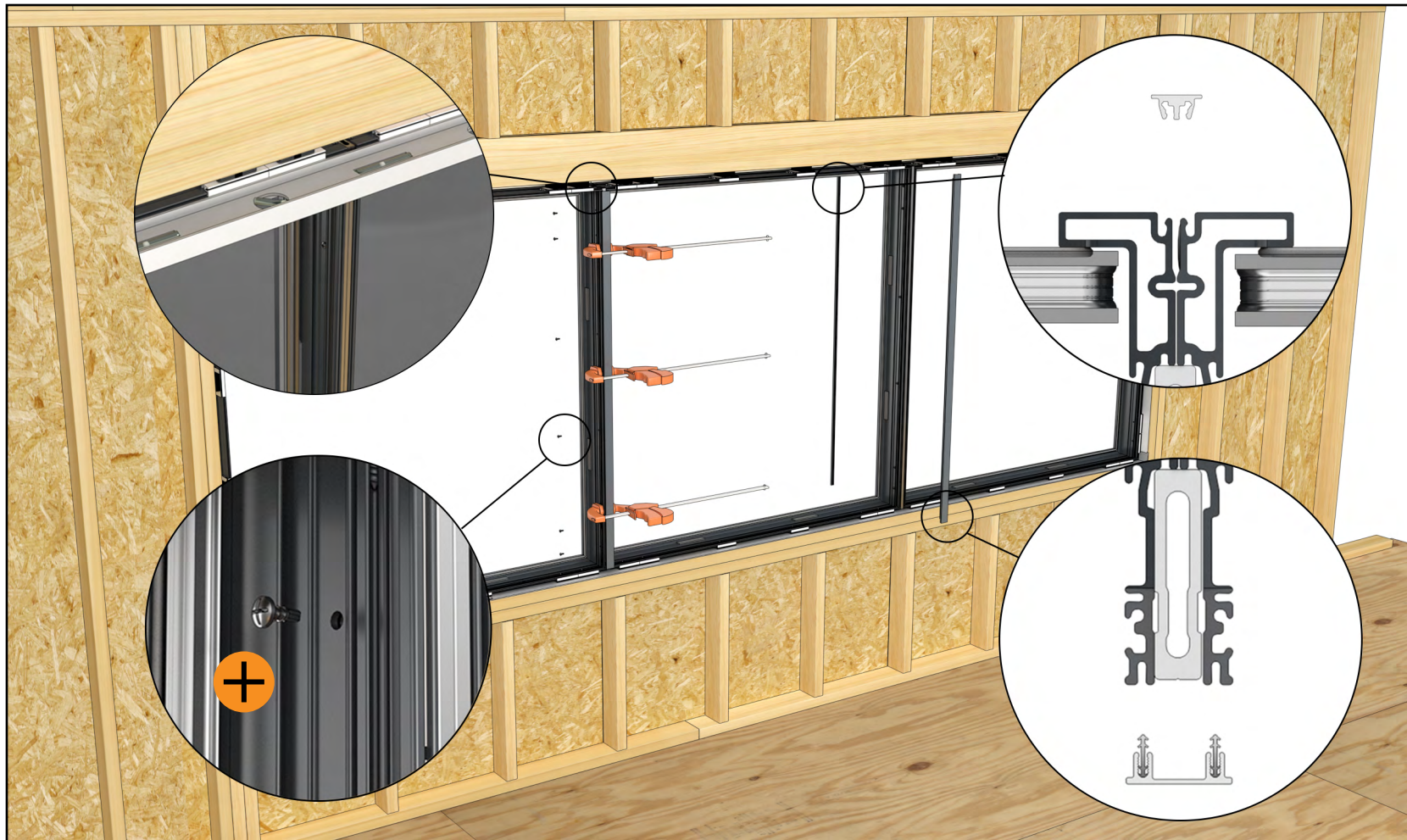

STEP 4 With the first unit pinned at the side jamb, set the next unit in place, clamp and fasten. Attach the exterior mull cap, and repeat until all units are assembled in the opening. Make sure all units are flush with one another on all planes.

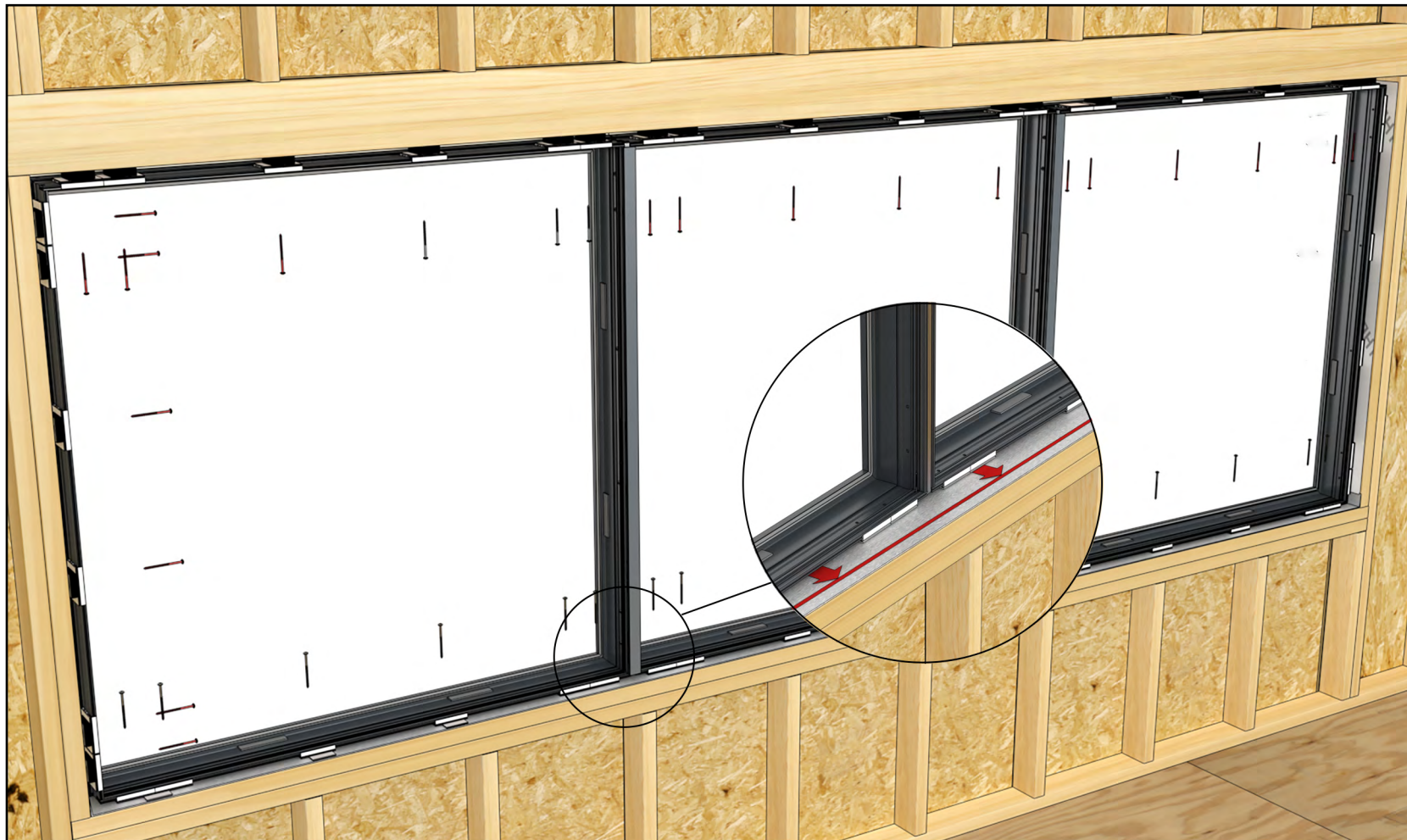

STEP 5 Make sure all units are aligned along the same plane vertically, adjust at the mulls and fasten through the sill. Complete fastening at every installation hole at the head jamb, sill, and jambs.