



Double Hung E-Z Tilt and Single Lift Wood and Clad Double Hung Tilt Pac

Replacement Parts

Specifications and technical data are subject to change without notice.

Numbers listed in () parentheses are metric equivalents in millimeters rounded to the nearest whole number.

Suggested fasteners are not included and must be ordered separately.

Illustrations are not to scale.

Contents

Product History.....	2
Miscellaneous Parts	5
Balance Tubes	8
Weather Strip.....	9
Wood Parts.....	10
Sash Replacement.....	11
Screen Replacement - Configured Parts in OMS.....	12
Screen Parts	13
Energy Panel Replacement.....	14
Combination Replacement and Parts.....	15

Produced	Unit Type	Features and Changes
1955	ARB-400	Unit featured removable sash, heavy aluminum jamb hardware, adjustable spring plug side and one stationary side and all aluminum hardware.
	Wingflex	Unit featured Caldwell type balance, removable jamb liner and reversible blind stop.
1957	ARB Featherlift	Unit featured 2 part balance with spring plugs on one side and coil spring on the other. Double Featherlift had coil springs on both sides.
1959	Springflex	Unit featured aluminum jamb cover, steel coil spring balance and cover tubes.
1960	All-Star and Laker	Unit featured coil spring balance system and non-removable sash.
1963	ARB Remove-A-Tilt	Unit featured tilting sash that was fully balanced and removable. Aluminum jamb hardware standard.
1970	Single Lift	Unit featured direct glaze glass panel and operating bottom sash.
1971	Single Lift	Changed from direct glazed to a stationary top sash with an operating bottom sash. Unit featured ARB Featherlift hardware.
1974	E-Z Tilt	Unit featured bracket mount vinyl jamb hardware.
1979	Single Lift	Unit featured vinyl hardware with coil spring balance, clutch system and operating bottom sash. Change in jamb hardware to white vinyl. Change to spring balance system.
	All-Star	Change to all white jamb hardware in All-Star units.
	Marv-A-Gard E-Z Tilt	Introduced unit with clad frame and Polycron sash. (The term Marv-A-Gard was discontinued in 1986.)
1981	Wood E-Z Tilt, Marv-A-Gard E-Z Tilt	Brown jamb liner introduced.
1982	Wood Double Hung Tilt Pac	Tilt Pac introduced. Replacement kit contained: sash, jamb liners, balance assemblies and sash brackets.
1984	Wood E-Z Tilt, Marv-A-Gard E-Z Tilt	Sash for E-Z Tilt manufactured prior to April 1984 are series 30, after this date series 40 profile. Change in profile resulted in a grille size change and daylight opening change.
1985	Wood E-Z Tilt, Marv-A-Gard E-Z Tilt, Wood Double Hung Tilt Pac	Changed from mousetrap (luggage) style lock to cam style lock.
	Marv-A-Gard Tilt Pac	Marv-A-Gard Tilt Pacs introduced in January with extruded aluminum sash in 3/4" insulating 1 lite glazing only (The term Marv-A-Gard was discontinued in 1986.)
	Marv-A-Gard E-Z Tilt	Redesign in vinyl sill cover to accommodate a non-plowed bottom rail. Formerly a sill cover with weather strip. Extruded aluminum clad sash introduced for Marv-A-Gard E-Z Tilt in November which allowed for 3/4" glazing. Authentic divided lite and single glazed 1-lite remained Polycron sash.
1986	Wood and Clad E-Z Tilt	Flange mount vinyl jamb liner replaced bracket mount. Authentic divided lite insulating glass munts feature new profile.
1987	Wood E-Z Tilt	Transom introduced.
1988	Wood E-Z Tilt	Standard size transoms added to product line.
	Clad E-Z Tilt	Sill extrusion changed to allow horizontal mulling. Single glazed clad sash available for double hung and single picture units.
	Wood and Clad E-Z Tilt	Single track hardware became available.
1989	Wood and Clad E-Z Tilt Wood and Clad Double Hung Tilt Pac	Beige jamb liner standard on pebble gray and bronze exterior. White jamb liner standard on brown and white exterior.
1990	Wood E-Z Tilt	Screen mounting system changed from hangers and bail loops to spring loaded plungers. Screen size changed slightly, does not affect replacements. Locks no longer off set on ADL units with center bar. Munt routed for keeper. Simulated triple hung introduced. Standardized placement of 2 locks. (Insulating and single glazed have different locations).
	Wood and Clad E-Z Tilt	Beige jamb liner standard.
1991	Wood E-Z Tilt	OM frame height changed, side jambs reduced by 3/16".

Produced	Unit Type	Features and Changes
1992	Wood and Clad E-Z Tilt Wood and Clad Double Hung Tilt Pac	Cam pivot redesigned. Brass hardware introduced. Upgraded extra heavy duty balance system to extra heavy duty 2. Bottom rail weather strip profile changed and color changed from white to beige.
	Wood E-Z Tilt Wood and Clad Double Hung Tilt Pac	Simulated Divided Lites introduced.
1993	Wood and Clad Double Hung Tilt Pac	Sash lock changed to spring loaded sash lock.
	Wood and Clad E-Z Tilt	Sash lock changed to spring loaded sash lock. Wood and beige jamb liner with co-extruded flex legs introduced.
	Clad E-Z Tilt	Factory applied brick mould casing introduced. Simulated divided lite introduced. Wood Flexacron ADL sash in clad frame discontinued.
1996	Wood and Clad Double Hung Tilt Pac	Custom sill bevels introduced
1998	Clad E-Z Tilt Double Hung and Single Hung Products Clad Double Hung Tilt Pac	11/98: Units utilizing .75" insulating glass overall thickness reduced to .70". No changes needed to existing glass size (width or height) or glazing system. Replacement glass will be sent .70" for units manufactured utilizing .75" glass.
		12/98-1/99 discontinued, replaced by Ultimate product line (phased out regionally). Clad Tilt Pac remains unchanged.
2000	Wood E-Z Tilt DH/SH Wood Double Hung Tilt Pac	1/30/00 E-Z Tilt sash lift changed to Ultimate style lift.
2001	Wood E-Z Tilt Double Hung and Single Hung Products	After 2/12/01 the Wood E-Z Tilt rectangle products will no longer be available. Wood Tilt Pac remains the unchanged.
2004	Wood and Clad Double Hung Tilt Pac	1/04: Added Oil Rubbed Bronze and Satin Chrome to available hardware finishes. 6/14/04: Satin Nickel hardware introduced.
2008	Clad Double Hung Tilt Pac	7/28/2008 Mixed grain Douglas fir is now a standard option.
2009	Wood E-Z Tilt Double Hung and Single Hung Products	3/23/2009 Added LoE3-366 as a standard option for all products. Added Cedro Macho as a standard option for all clad products.
	Wood and Clad Double Hung Tilt Pac	
2011	Wood E-Z Tilt Double Hung and Single Hung Products Wood and Clad Double Hung Tilt Pac	04/25/2011 Added LoE-180 as a standard option for all products. White painted interior finish option introduced for all products.
2012	Wood and Clad Double Hung Tilt Pac	12/17/2012: Introduced Clear interior finish option on all products.
2013	Wood and Clad Double Hung Tilt Pac	04/29/2013: Introduced interior stain options. Stain colors are Wheat, Honey, Leather, Hazelnut, Cabernet and Espresso.
2015	Wood E-Z Tilt	08/31/2015: Effective August, 31 2015, Marvin will no longer accept orders for Wood Double Hung E-Z Tilt window products or replacement components. All Wood Double Hung EZ Tilt replacement parts will be removed from OMS and the Marvin Parts Manual. Any questions related to Wood Double Hung EZ Tilt product should be directed to your Marvin Service representative. For more information see Product bulletin 611.
2017	Wood E-Z Tilt Double Hung and Single Hung Products	10/30/2017 Discontinued EP colors with exception of Stone White and Bronze.
	Clad and Wood E-Z Tilt	12/18/2017 Discontinued Clad and Wood EZ Tilt 1 3/4", 1 3/8" Transom sash, also Clad 1 3/4", 1 3/8" picture sash and Wood 1 3/4", 1 3/8" and 2 1/2" picture sash. This also includes glass, grilles, storm sash and energy panels.

Produced	Unit Type	Features and Changes
2018	Clad and Wood E-Z Tilt	2/26/2018 Discontinued .484 cope (Offer .375 cope only). Discontinue SG. Discontinue IG & SG ADL. Discontinued Boston Sash. Removed Vertical Grain Douglas Fir and Mahogany as species options in OMS. Plastic Ogee lug standard, integrated Ogee lug supplemental with extended lead time.
2021	Wood and Clad Double Hung Tilt Pac	08/30/2021: The Ultimate Tilt Pac and Ultimate Wood Tilt Pac product line was DISC-NA 8/30/21 (No Longer Available). With the exclusion of sash replacement (DISC-NA), all replacement parts in this section will be DISC-LA (Limited Availability) unless otherwise noted. See Product Bulletins 773, 782 and 783 for more information. NOTE: To order screens or screen parts, reference Ultimate Double Hung screen.
2022	Clad and Wood E-Z Tilt	06/27/2022: The Aluminum Screen will be the standard for units with a frame size height of $\leq 54 \frac{1}{2}$ ", with an option of the Extruded Aluminum Screen available. The standard screen for any unit with a frame size height $> 54 \frac{1}{2}$ " will be the Extruded Aluminum Screen. This improvement to screen frames includes all Ultimate and Ultimate Wood windows that accept an aluminum screen, including Round Top and Polygon shapes. See Product Bulletin 832 for more details.
2023	Clad and Wood E-Z Tilt	06/26/2023: Combined E-Z Tilt and Tilt Pac sections. Updated part availability.
2024	Clad and Wood E-Z Tilt Wood and Clad Double Hung Tilt Pac	06/24/2024 Update for Ultimate Combinations and Ultimate Wood Combinations and Energy Panels were made. See Product Bulletin #937 for more Information.

Sash Lock

Includes:

- 1 - Sash lock
- 2 - #7 x 7/8" Phillips flat head wood screw

Color	PN
Satin Taupe	10818034
Bronze	10818033
White	10840026
Brass	05600082
Antique Brass	05600084
Polished Chrome	05600086
Satin Chrome	05600088
Oil Rubbed Bronze	05600090
Satin Nickel	05600092

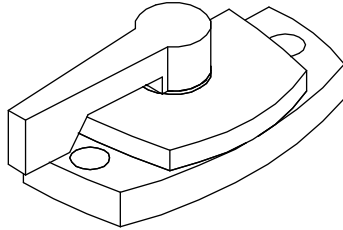

Keeper

Includes:

- 1 - Keeper
- 2 - #7 x 7/8" Phillips flat head wood screw

Color	PN
Satin Taupe	10818052
Bronze	10818051
White	10818050
Brass	10818053
Antique Brass	10818054
Polished Chrome	10818055
Satin Chrome	10818056
Oil Rubbed Bronze	10818057
Satin Nickel	10818058

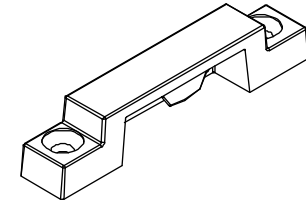

Sash Lift

Includes:

- 1 - Sash lift
- 2 - #8 x 1" Phillips flat head wood screw

Color	PN
Satin Taupe	10818034
Bronze	10818033
White	10840026
Brass	05600082

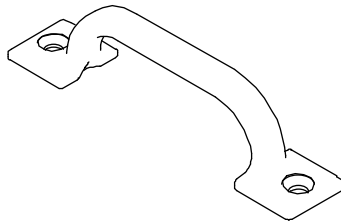

Installation Clip, Jamb Liner

1" x 3 3/8"

PN
11860011

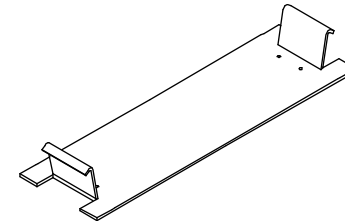

S-Hook Heavy Duty, Short, 3/8"

Used on top sash balance

PN
11870737

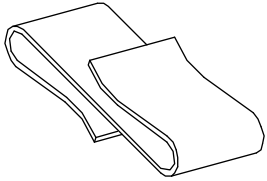

S-Hook Heavy Duty, Long 3/8"

Used on bottom sash balance

PN
11870741

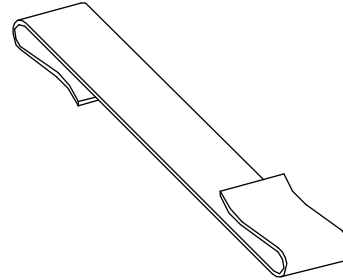

Clutch

Used on bottom sash balance

Strength	Color	PN
Regular	Beige	11870480
Heavy Duty	Black	11870482
Extra Heavy Duty	Blue	11870481
Super Heavy Duty	Brown	11870483

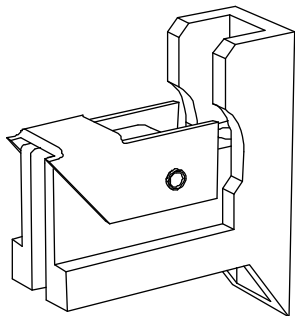

Sash Stop, Vinyl

1 3/4" length

Color	PN
White	11860114
Beige	11860116

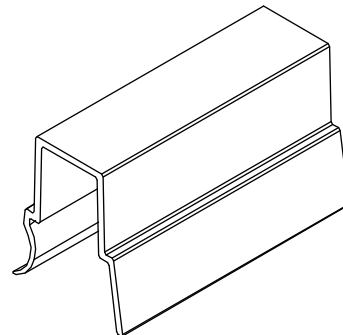

Foam Plug (Chimney Block)

1" x 9/16" x 3/4"

Located at the bottom of the vinyl jamb liner

PN
10502001

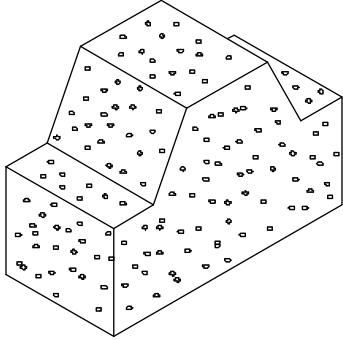

Foam, Adhesive Backed

1/2" x 1/2" x 3/8"

Foam block on the back of the jamb liner

PN
10500200

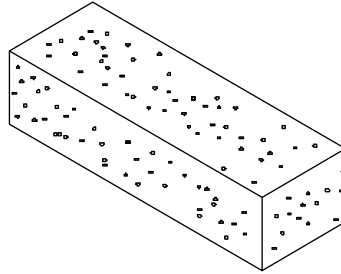

Foam Gasket

Tilt Pac Top Track

NOTE: For Single Hung cut to fit

Usage	PN
Wood	10500100
Clad	10500102

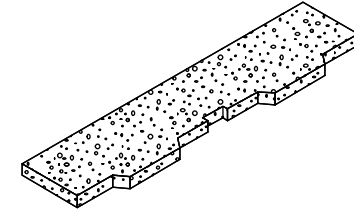

Jamb Liner Foam

1" x 9/16" x 3/4"

Located behind the jamb liner

Length	PN
Specify length	10500009

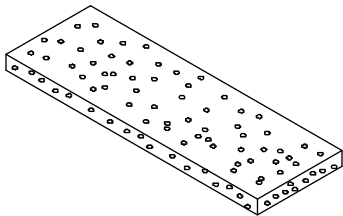

Jamb Liner Foam (Single Hung)

9/16" x 7/16", with PVC edge

Length	PN
Specify length	10500014

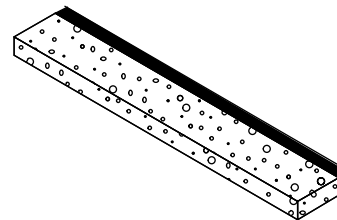

NOTE: Part numbers listed are for one balance tube only. Each sash requires two balance tubes.
 E-Z Tilt balances are color coded. Specify top or bottom sash (T=Top, B=Bottom)

Size, Strength and PN				
Size	Regular (White Clutch)	Heavy Duty (Black Clutch)	Extra Heavy Duty (Blue Clutch)	Super Heavy Duty (Brown Clutch)
8T	10660801	10670801	NA	
8B	10660800	10670800		
10T	10661004	10671001		
10B	10661003	10671000		
12T	10661201	10671201	10681201	10691201
12B	10661200	10671200	10681200	10691200
14T	10661401	10671401	10681401	10691401
14B	10661400	10671400	10681400	10691400
16T	10661601	10671601	10681601	10691601
16B	10661600	10671600	10681600	10691600
18T	10661801	10671801	10681801	10691801
18B	10661800	10671800	10681800	10691800
20T	10662001	10672001	10682001	10692001
20B	10662000	10672000	10682000	10692000
22T	10662201	10672201	10682201	10692201
22B	10662200	10672200	10682200	10692200
24T	10662401	10672401	10682401	10692401
24B	10662400	10672400	10682400	10692400
26T	10662601	10672601	10682601	10692601
26B	10662600	10672600	10682600	10692600

Size, Strength and PN				
Size	Regular (White Clutch)	Heavy Duty (Black Clutch)	Extra Heavy Duty (Blue Clutch)	Super Heavy Duty (Brown Clutch)
28T	10662801	10672801	10682801	10692801
28B	10662800	10672800	10682800	10692800
30T	10663001	10673001	10683001	10693001
30B	10663000	10673000	10683000	10693000
32T	10663201	10673201	10683201	10693201
32B	10663200	10673200	10683200	10693200
34T	10663401	10673401	10683401	10693401
34B	10663400	10673400	10683400	10693400
36T	10663601	10673601	10683601	10693601
36B	10663600	10673600	10683600	10693600
38T	10663801	10673801	10683801	10693801
38B	10663800	10673800	10683800	10693800
40T	10664001	10674001	10684001	10694001
40B	10664000	10674000	10684000	10694000
42T	10664201	10674201	10684201	10694201
42B	10664200	10674200	10684200	10694200
44T	10664401	10674401	10684401	10694401
44B	10664400	10674400	10684400	10694400

Bulb Weather Strip, Bottom Rail

V192

Color	Length	PN
Beige	84" (2134)	15900058

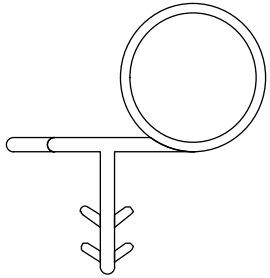

Dual Seal Weather Strip, Check Rail

V116

Color	Length	PN
White	84" (2134)	15828400

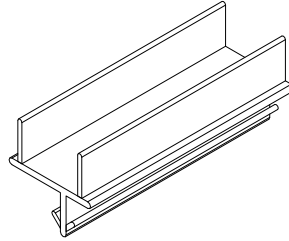

Hinged Leaf Weather Strip, Head Jamb Parting Stop

V245

Color	Length	PN
White	84" (2134)	15818400

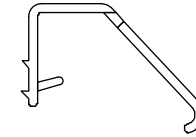

Pile Weather Strip (Dust Fuzzy), Jamb Hardware

3/8" x 1 1/4" x 1/8"

Color	PN
White	10600000

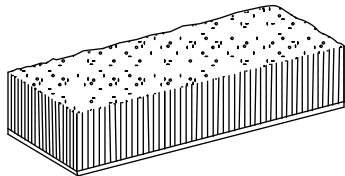

Pile Weather Strip, Top Blind Stop and Sash Stiles

3/16" x 5/32", Clad Units only

Color	Length	PN
Beige	Specify length	15607560

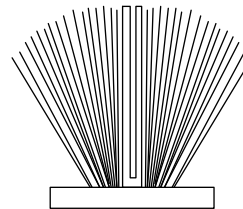

Wood Parts for E-Z Tilt Double Hung and Single Hung are no longer available

Replacement Sash for E-Z Tilt Double Hung and Single Hung
are no longer available

Current Ultimate Wood Double Hung screens are the replacement option.
Refer to Configured Parts in OMS.

Screen Plunger Kit

Includes:

- 1 - Plunger bolt
- 1 - Plunger spring
- 1 - Plunger cap, Black

PN
11851053

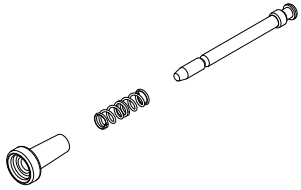

Plunger and Spring Assembly, Extruded Screen

Includes:

- 1 - Plunger
- 1 - Plunger spring
- 1 - Plunger cap

PN
10500706

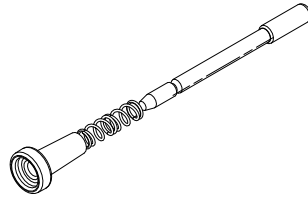

Leaf Spring

For Aluminum Screens

PN
11868835



Current Ultimate Wood Double Hung Energy Panels are the replacement option.
For Combinations and Energy Panel Availability and Replacement Parts, see Replacement Parts section:

“Ultimate and Ultimate Wood Combinations and Energy Panels”

Replace with current combinations for Ultimate Wood Double Hung and Ultimate Double Hung/Single Hung DISC LA Pre 6/29/15.

For Combinations and Energy Panel Availability and Replacement Parts, see Replacement Parts section:

“Ultimate and Ultimate Wood Window Combinations and Energy Panels”