

Elevate Sliding French Door (Generation 3)

Installation Instructions

ABSTRACT: Read all instructions in their entirety. These instructions are intended as a supplement to the door installation instructions included with the door. Note the installation differences for each door configuration.

Usage Dates: This instruction is relevant for product produced after 4/25/2016.

NOTE: Images are for illustrative purposes only.

WARNING!

This product can expose you to chemicals including titanium oxide, which is known to the state of California to cause cancer. For more information, go to www.P65Warnings.ca.gov.

WARNING!

This product can expose you to chemicals including methanol, which is known to the state of California to cause birth defects or other reproductive harm. For more information, go to www.P65Warnings.ca.gov.

WARNING!

Drilling, sawing, sanding or machining wood products can expose you to wood dust, a substance known to the State of California to cause cancer. Avoid inhaling wood dust or use a dust mask or other safeguards for personal protection. For more information go to www.P65Warnings.ca.gov/wood.

WARNING!

Always practice safety! Wear the appropriate eye, ear, and hand protection, especially when working with power tools.

NOTE: Numbers listed in parentheses () are metric equivalents in millimeters rounded to the nearest whole number.

Table of Contents

Installation Kits	2
Removing Shipping Blocks	3
Permanently Securing the Unit	4
Permanently Securing an OXXO Unit and installing OXXO Panels.....	7
Installing/Adjusting the Handle Strike	8
OXXO Adjustable Sill and Head Jamb Strike Installation	9
Installing Panel Bumpers	13
Bracket Cover and Leveling Block End Cap Installation	14
Screen Dust Block Application	15
IZ3 Unit Prep-Installation Clips with Nailing Fin	15
Structural Brackets.....	16
OXXO Handle Set Prep	17

Installation Kits

	Description	xoox	oxo	xoo/ oox	oxxo	HP/ IZ3
1	Operator stop block	2	2	1	4	
2	Thumb Tack Bumper	2	2		4	
3	OOX/XOO Operator Stop Block			2		
4	Operator adjustment hole plug	2	2	2	4	
5	#8 x 5/8" Truss head screw				8-16	
6	#8 x 2-1/2" Flat head screw				5	
7	#8 x 3" Pan head screw	18	20	14	16	3-5
8	15 x 2-1/2" Type A/TF 2/3 or full thread				2	8 or 12
9	#10 x 1-1/2" Pan head screw (color matched)	4	4	4	4	
10	Keeper	1	1	1	1	
11	Top stationary bracket cover	1	2	1	2	
12	Screen dust block	2	2	2		
13	Leveling block end cap	1	2	1	2	
14	Interior jamb cover (vinyl or wood)	1	2	1	2	
15	8 X1" Phil. Flat ASMS18-8SS (Not shown)				2	

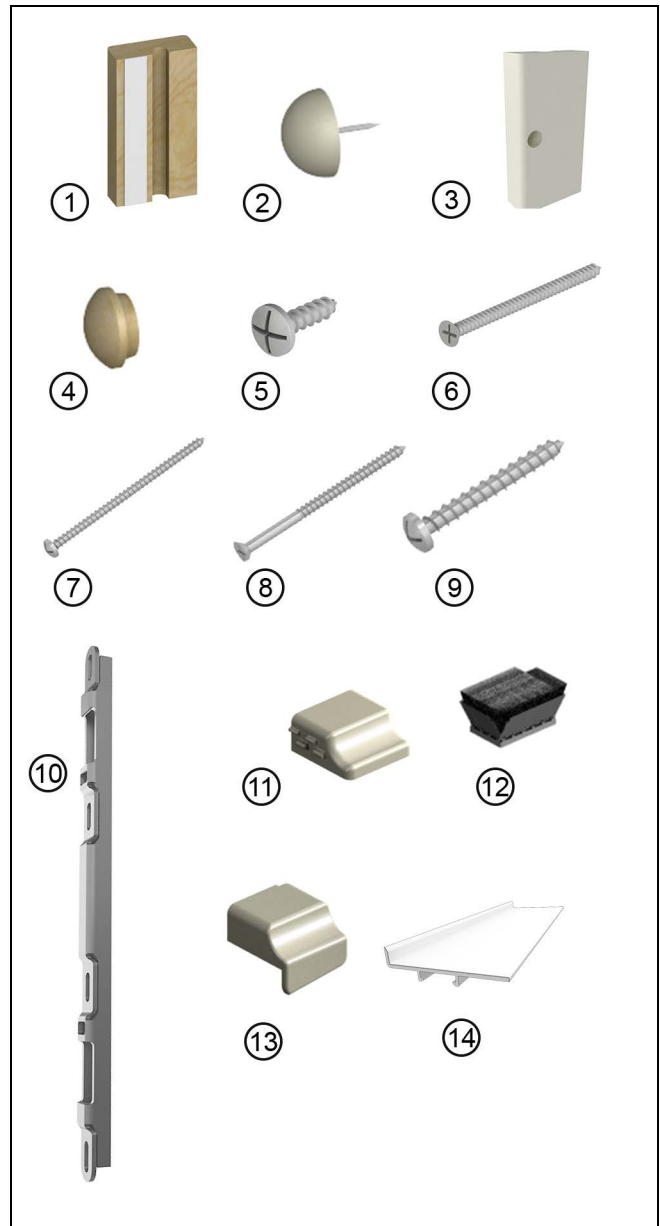

Figure 1

Removing Shipping Blocks

1. From interior side of unit, remove wing nut, machine screw and shipping block from the head jamb. See [Figure 2](#).

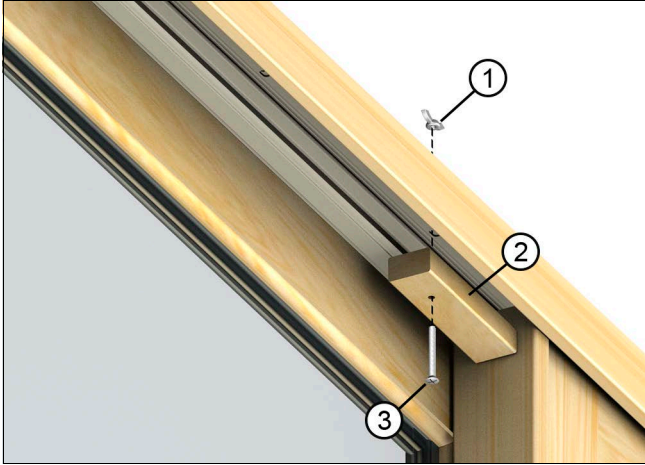

Figure 2

1	Wing nut
2	Shipping block
3	Machine screw

2. Remove shipping block from the sill between the operator panel and stationary side jamb. See [Figure 3](#).

NOTE: For doors greater than CN 9-0 width, remove the shipping brace or stationary panel spacer.

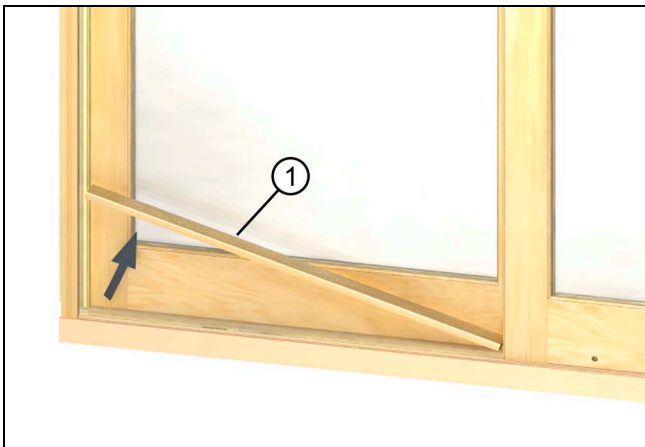

Figure 3

1	Shipping block
---	----------------

3. Adjust the operator panel up by turning clockwise 1 or 2 clicks or just enough to allow panel to roll freely. (For optimal performance operator panel should not be raised more than needed for smooth operation.) See [Figure 4](#)

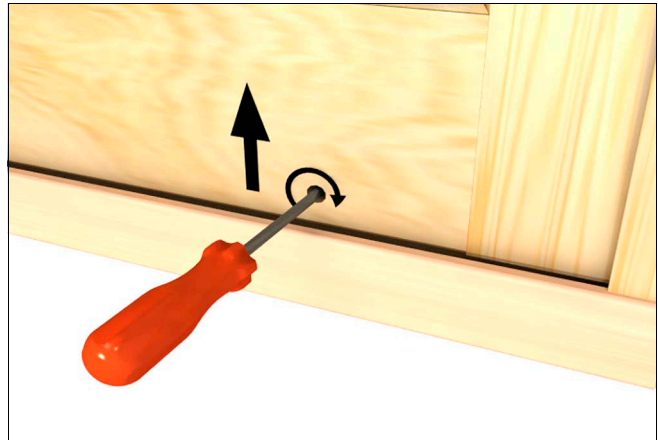

Figure 4

4. When you are done adjusting the panel, cover the holes with the plugs provided.

Permanently Securing the Unit

1. Refer to the [General Door Installation Instructions](#) 19970479. Ensure unit is level, square and plumb in the door opening. Then shim between the rough opening header and the unit head jamb within 1"-2" (25-51) of the top stationary panel bracket(s). Check the head jamb to be sure it is not bowed up or down. [See Figure 5](#).



Figure 5

1	Horseshoe shim
2	Installation screw

2. On non mulled units, remove the 1" screw (1) with label and discard. Use the #8 x 3" SS pan head screw (2) to fasten the unit to the rough opening through all top stationary panel brackets. [See Figure 6](#).

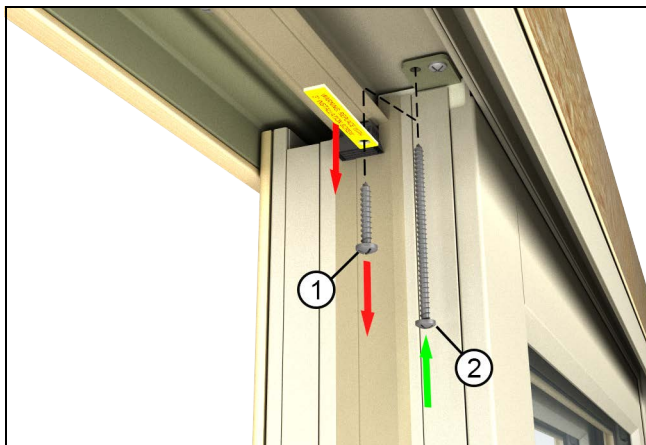

Figure 6

1	#8 x 1" pan head screw
2	#8 x 3" pan head screw

3. Using the #8 x 3" pan head screws, fasten jambs through pre-drilled holes. Make sure to add shims within 1"-2" of each hole location. [See Figure 7](#). For more information on shimming, please refer to the [General Door Installation Instructions](#).

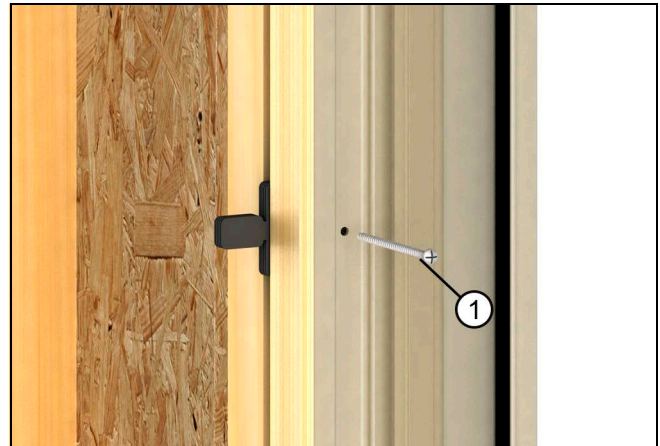

Figure 7

1	#8 x 3" pan head screw
---	------------------------

4. **Painted Units Only:** Snap interior jamb cover onto jamb cover bases stapled to the stationary jamb. Make sure cover is fully seated into channel. [See Figure 8](#).

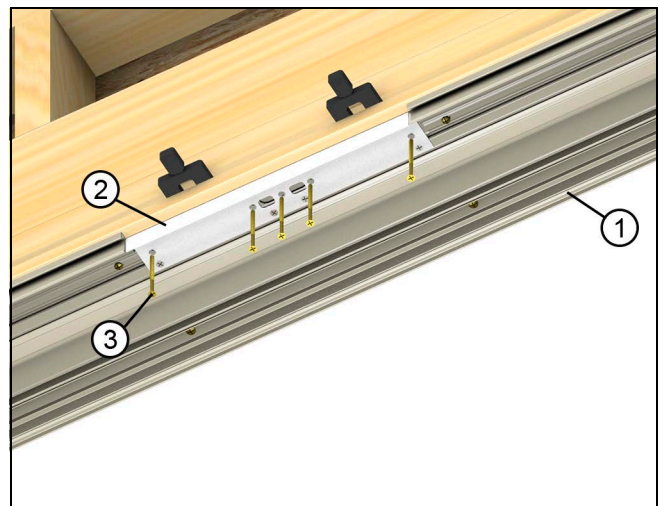

Figure 8

1	Interior jamb cover
2	Jamb cover base

5. Leave specified pre-drilled holes on operator jamb open for keeper installation. Check jambs to be sure they are not bowed. Adjust shims and installation screws as necessary. See Figure 9.

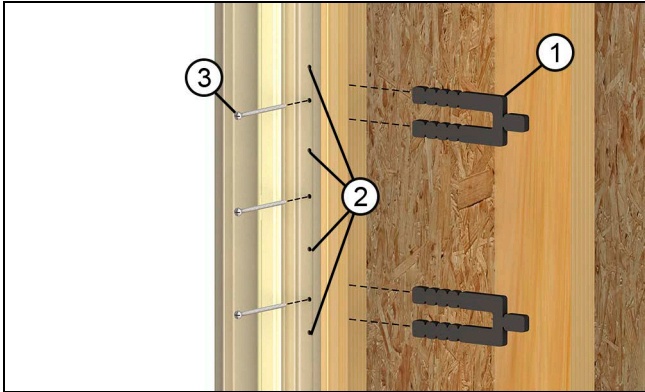

Figure 9

1	Horseshoe shim
2	Leave these holes open for the keeper
3	#8 x 3" pan head screws

6. **Wood and Clear Lacquer Units Only:** Wipe down the stationary jamb pocket and remove the tape backing from the stationary jamb at two locations. Insert the wood interior jamb cover by pivoting from the jamb liner towards exterior and compressing frame weatherstrip. Firmly press the wood jamb cover with a roller along the length of the stationary jamb. See Figure 10.

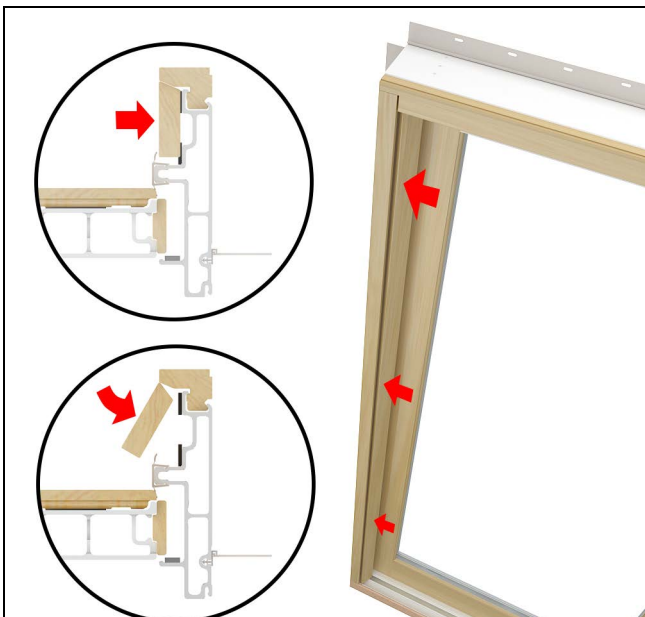

Figure 10

1	Adhesive tape
2	Interior jamb liner

7. **FOR HP/IZ3 Only:** Secure the sill to the sub floor with two 3/16" x 2-3/4" flat head masonry anchor screws in each bracket. First, pre-drill the outer two holes using 1/8" drill bit and then drive the two screws through the outer two holes of every sill installation clip. Installation clips should be positioned 6" (152) from both ends of sill and 6" on either side of each meeting stile. See Figure 11.

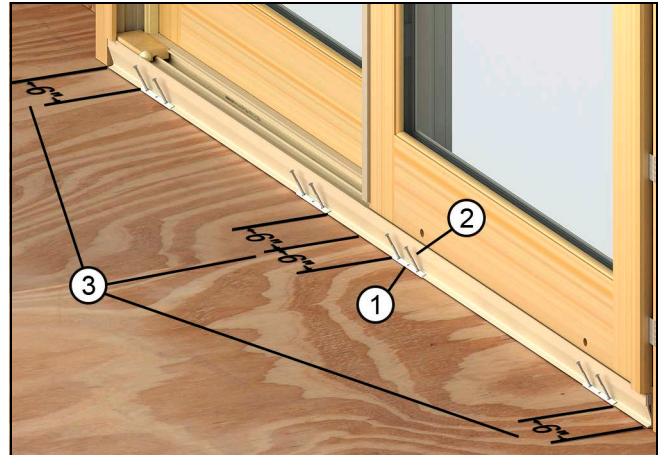

Figure 11

1	Sill installation clip
2	3/16" x 2 3/4" flat head masonry screw
3	6" (152)

8. Wipe down the interior side of sill and apply the sill liner by peeling the backing off the tape, aligning with the end of the sill and flush with the top of the sill dam. Apply pressure to allow tape to make good contact and adhesion with sill. See Figure 12.

! CAUTION!

Proper use and installation of the provided sill liner is required to meet advertised structural performance. It is also designed to prevent damage to roller track due to foot traffic.

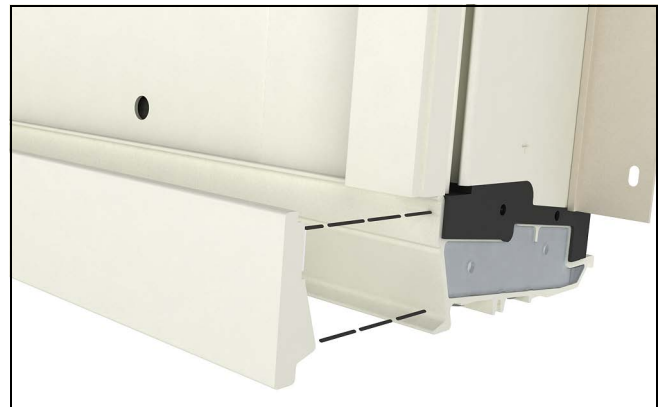

Figure 12 Applying the sill liner provided from Marvinvo

9. All Configurations EXCEPT OXXO: Finish securing the head jamb by driving a #8 x 3" pan head screw through panel guide in the hole closest to the operator panel when it is in the closed position.

10. OXO Configurations: Drive additional #8 x 3" pan head screw through the panel guide in the hole above the operator panel closest to the locking astragal. See Figure 13.



Figure 13

1	Horseshoe shim
2	#8 x 3" pan head screw

11. OOX/XOO Configurations: Drive additional #8 x 3" pan head screws through the panel guide on both sides of the stationary panel mull trim. See Figure 14.



Figure 14

12. For HP/IZ3: Fasten through every other hole in the head jamb panel guide into the rough opening with the #8 x 3" screws provided. See Figure 15.



Figure 15

Permanently Securing an OXXO Unit and installing OXXO Panels

1. Shim above head jamb strike plate and fasten to rough opening using two #8 x 2-1/2" flathead screws through the empty holes in the head jamb strike plate. Check the head jamb to be sure it is not bowed up or down. See Figure 16.



Figure 16

2. Secure the sill to the sub floor with provided 3/16" x 2-3/4" flat head masonry anchor screws through all three pre-drilled holes. See Figure 17.

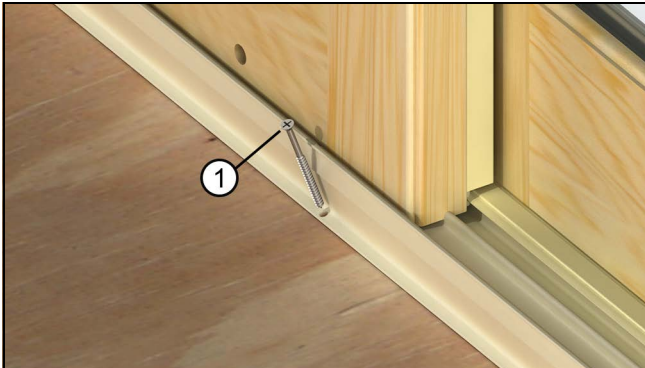

Figure 17

1	3/16" x 2 3/4" flat head masonry anchor
---	---

3. Wipe down the interior side of sill and apply provided sill liner by peeling the backing off the tape, aligning with the end of the sill and flush with the top of the sill dam. Apply pressure to allow tape to make good contact and adhesion with sill. See Figure 18. Note: for OXXO units, the sill liner will need to be applied after panels and strikes have been installed.

! CAUTION!

Proper use and installation of the provided sill liner is required to meet advertised structural performance. It is also designed to prevent damage to roller track due to foot traffic.



Figure 18

IMPORTANT

Once the frame is fastened, install the operating panels one at a time following these steps for each panel to ensure safety.

4. Set one operating panel on the roller track and slide in under the header strike (this will hold the panel so the panel guide can be installed).

5. Be sure the panel rollers are at the lowest setting to allow clearance of the panel guide. Slide the aluminum panel guide in above the panel and start fastening from the jamb with the provided 5/8" (16) truss head screws. With the operator panel in the closed position, install a #8 x 3" screw through the hole closest to the operator panel. See Figure 19.

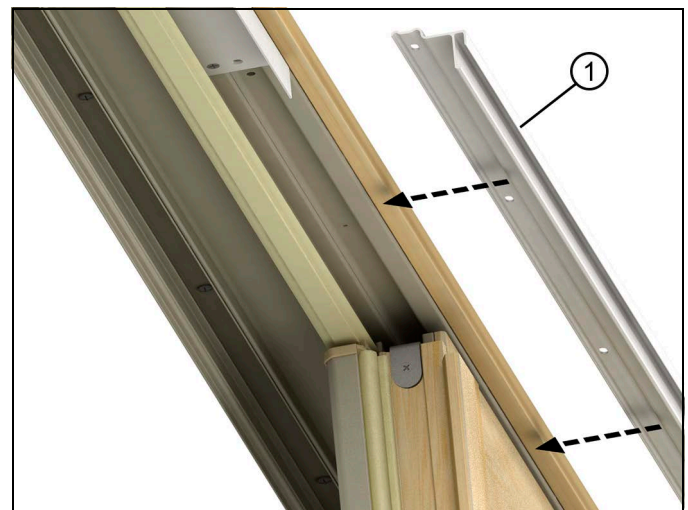

Figure 19

1	Aluminum panel guide
---	----------------------

6. Repeat these steps for the second operator panel installation.

7. Once both operator panels have been installed (recheck the head jamb to verify it is not bowed). Adjust rollers up by turning clockwise 1 or 2 clicks or just enough to allow panel to roll freely. (For optimal performance operator panel should not be raised more than needed for smooth operation.) Attach the wood panel guide trim by snapping into the aluminum panel guide. See Figure 20.

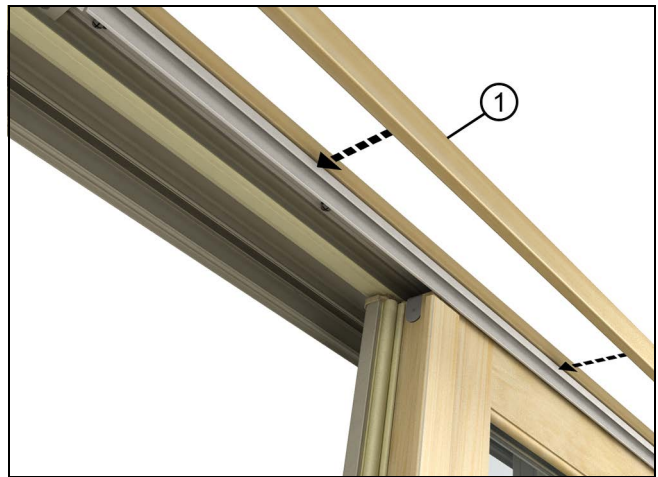

Figure 20

1	Wood panel guide trim
---	-----------------------

Installing/Adjusting the Handle Strike

1. Before installing or adjusting strikes on OXXO unit, ensure unit is prepped correctly and ready for handle installation. If you need to prep for handle, please refer to OXXO Handle Set Prep on page 17.

Install the strike with four #8 x 3" pan head screws (#10 x 1 1/2" for OXO configurations) provided. Position strike to center screws in adjustment slots and tighten. Adjust the strike vertically for proper latch engagement if needed. See Figure 21.

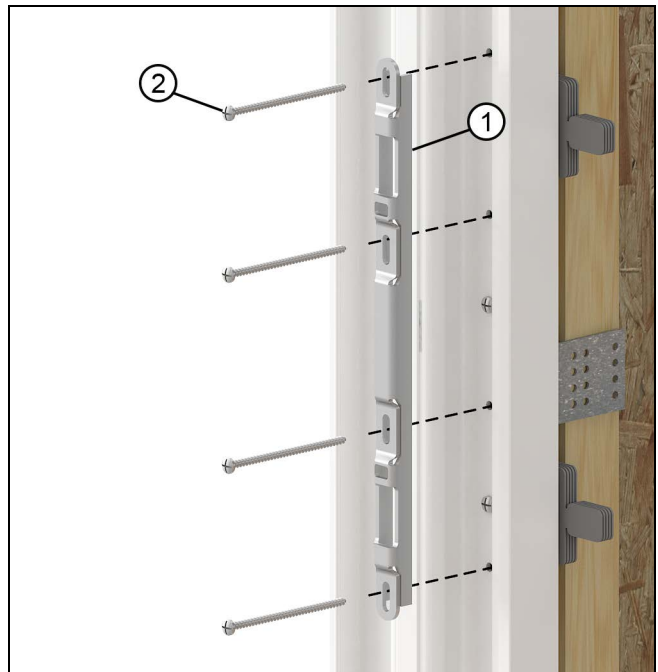

Figure 21

1	Strike
2	A.) All Configurations but the OXO: #8 x 3" pan head screw B.) OXO: #10 x 1-1/2" pan head screw

2. After the door and strike are aligned, adjust the latch hooks by turning the adjustment screws counterclockwise to move the hooks in or clockwise to move the hooks out of the mortise lock. Each hook has a separate adjustment screw. See Figure 22.

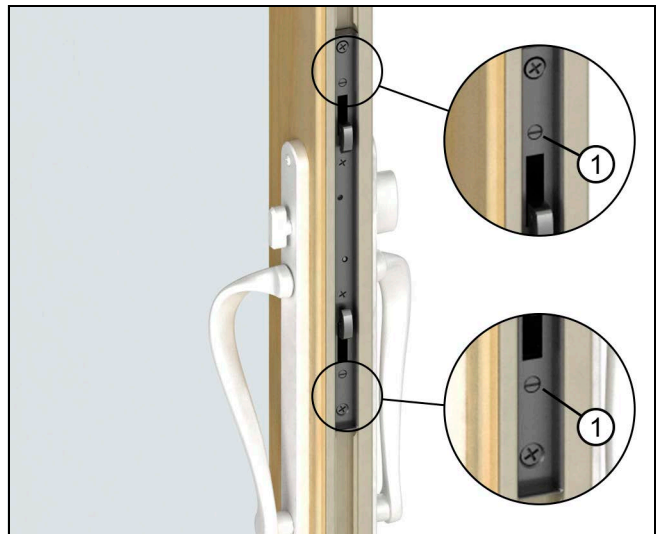

Figure 22

1	Adjustment screws
---	-------------------

OXXO Adjustable Sill and Head Jamb Strike Installation

1. Using a smartphone or similar device, scan the QR code or click [here](#) to play a video of this procedure.



1. Once both operators and panel guides are installed, remove the interior astragal cover and close both the primary and secondary doors.

2. Check the reveal of the interlocks at the head jamb and sill. Verify the interlocks are able to engage. See Figure 23.

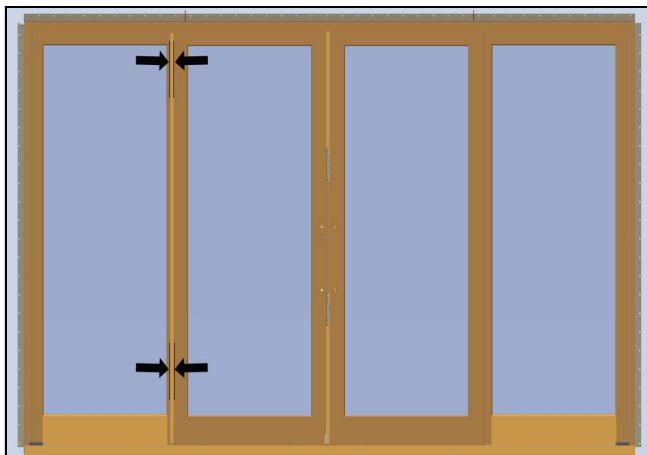

Figure 23

3. While both doors are closed and locked together, shift doors all the way to the left jamb and mark sill with line at the edge of the secondary panel. See Figure 24.



Figure 24

WARNING!

Make certain to lock the two operator doors together. Do **not** throw shoot bolts.

4. Shift both doors to the right jamb and mark the sill where the secondary panel location is. See Figure 25.



Figure 25

5. After both marks have been made, unlock the doors so that they are no longer connected. Slide both doors out of the way, then slide the secondary door back until it engages the interlock on the stationary panel and gently comes to a stop. See Figure 26.

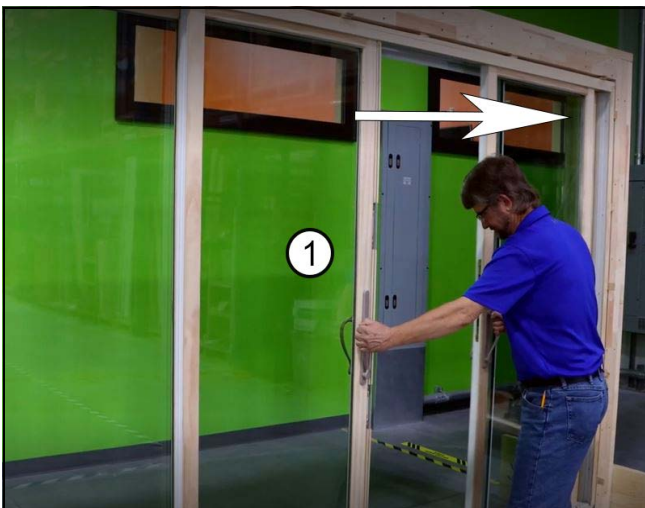

Figure 26

1	Secondary door in locked position
---	-----------------------------------

! CAUTION!

Do not over seat the operator interlock into stationary interlock.

6. Mark a line at the edge of secondary panel. The line should be roughly at the center of the 2 lines made previously. This will ensure that both interlocks are properly engaged when the doors are closed. See Figure 27.



Figure 27

7. Move both doors out of way.

8. Begin at sill strike and loosen center screw. See Figure 28.



Figure 28

9. Move the secondary panel to close position and engage lower shoot bolt into sill strike route. See Figure 29.



Figure 29

10. Disengage the lower shoot bolt and slide secondary door aside. See Figure 30.



Figure 30

11. Secure the sill strike in position by tightening the center screw. The other two screws in the flange will not be installed until later. [See Figure 31.](#)



Figure 31

12. Loosen the center screw of the head jamb plate. Bring the secondary door to the locked position. [See Figure 32.](#)



Figure 32

13. Using a quick clamp, gently hold the secondary door panel against head jamb weather strip. [See Figure 33.](#)

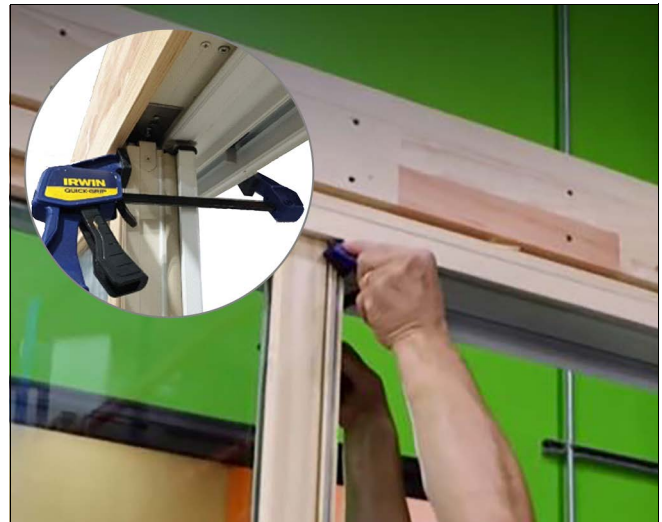

Figure 33

14. Engage the upper shoot bolt into head jamb plate strike and mark location. [See Figure 34.](#)



Figure 34

15. Move the secondary panel out of way and align head jamb strike plate with mark and tighten center screw. [See Figure 35.](#)



Figure 35

16. Close secondary door and engage both upper and lower shoot bolt, verify strikes are in the correct position.

17. Move the secondary door out of way. Use a centering drill bit to mark a pilot hole in the outside holes of the head jamb strike plate. See [Figure 36](#).



Figure 36

18. Using 1/8" drill bit, drill two pilot holes in the two outside holes of head jamb strike plate. See [Figure 37](#).



Figure 37

19. Install two color matched #8 x 2-1/2" screws in the pilot holes of the head jamb strike plates. See [Figure 38](#).



Figure 38

20. Install two #8 x 1" screws into sill strike. Close primary door and engage both upper and lower shoot bolts to ensure engagement of both head jamb and sill strikes. See Figure 39.

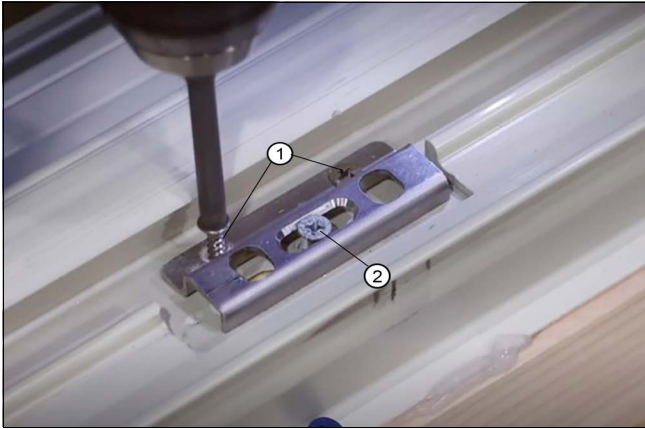

Figure 39

1	Two #8 x 1" screws
2	One 1-1/4" screw

⚠ CAUTION!

Make sure the sill strike does not twist when fastening the screw. Do not drill too deep through the backer and into the sill.

Installing Panel Bumpers

1. For bumper installation on OX/XO, OXO, and OXXO configurations, See Figure 40. (For reference, adhesive tape is applied to the interior side of the block and is pressed against the head jamb or sill to attach.) Hold each block in place and determine which end to install the bumper in (bumper toward operator panel). Center the bumper on the interior side of the end and tap into block. Remove adhesive tape backing from block. Position against the stationary side jamb and press into place.



Figure 40

2. For stop block installation on OOX/XOO, install stop block using #10 x 1 1/2" pan head screw into pre-drilled

hole on the sill. Cover the stop block hole with a jamb hole plug. See Figure 41.

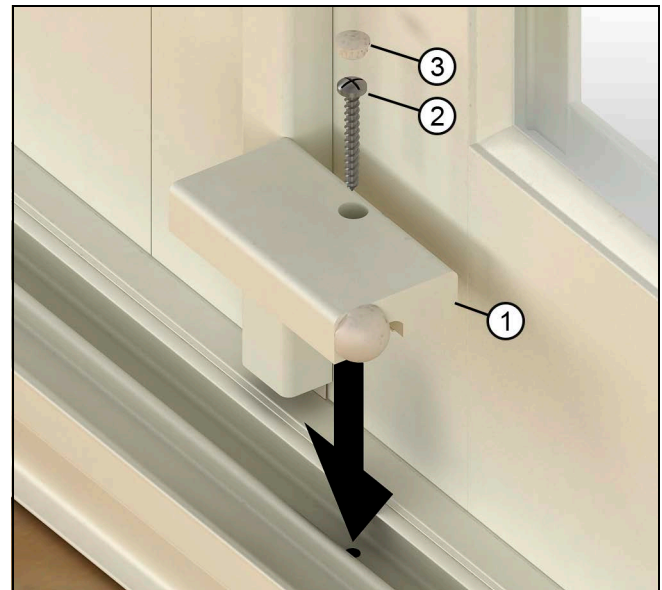

Figure 41

1	Stop block
2	#10 x 1 1/2" pan head screw
3	Jamb hole plug

Bracket Cover and Leveling Block End Cap Installation

1. Install the leveling block end caps by sliding firmly onto the end of leveling block(s). [See Figure 42.](#)



Figure 42

2. Install the top stationary bracket cover by pushing firmly up into place. [See Figure 43.](#)



Figure 43

Screen Dust Block Application

Before the screen is installed into the unit, add two dust blocks to OX/XO, OOX/XOO, and OXO configurations. See [Supplemental Instructions](#) for more details on OXXO configurations.

1. Place a dust block sitting vertically approximately 2" (51) from each end cap tight to the sill. See [Figure 44](#).

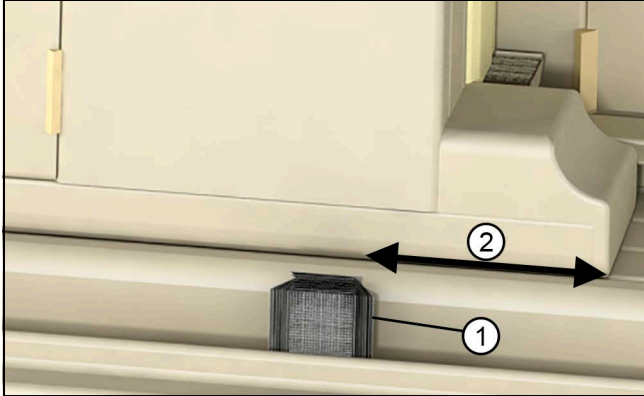

Figure 44

1	Dust block
2	2" (51)

2. Place a dust block horizontally attaching it to the leveling block above the previous dust block as shown. See [Figure 45](#).

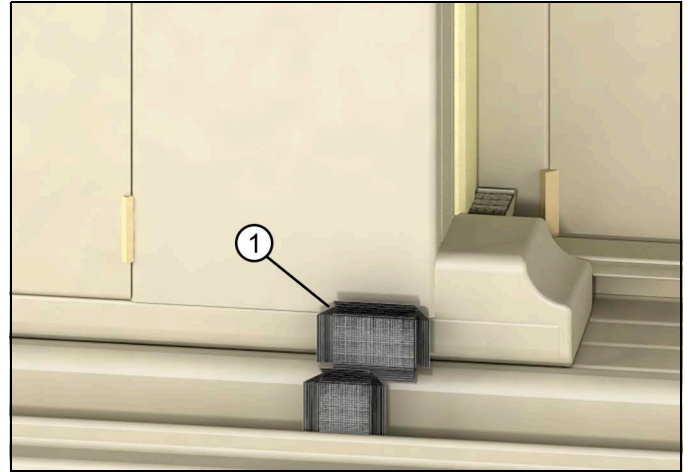

Figure 45

1	Horizontal dust block
---	-----------------------

IZ3 Unit Prep-Installation Clips with Nailing Fin

Fasten IZ3 rated products to the rough opening using either installation clips and nailing fin or structural brackets.

1. Attach clips to the unit jambs and head jamb with #7 x 5/8" wood screws 6" (152) maximum from each corner and 18" (457) maximum around the unit perimeter for mullied units attach clips at maximum 6" from each side of the mullion. See [Figure 46](#).



Figure 46

1	6" max
2	18" max

2. When using clips, use the screw holes in the clip as a guide and drill through the nailing fin with a 1/8" (3) drill bit. This will give you the location of the screw holes when you fasten the unit to the rough opening. See [Figure 47](#).



Figure 47

1	1/8" holes
---	------------

Structural Brackets

1. Attach structural brackets and structural mull brackets to the jambs and head jambs following the attachment method and spacing specified with the [structural bracket instructions](#).

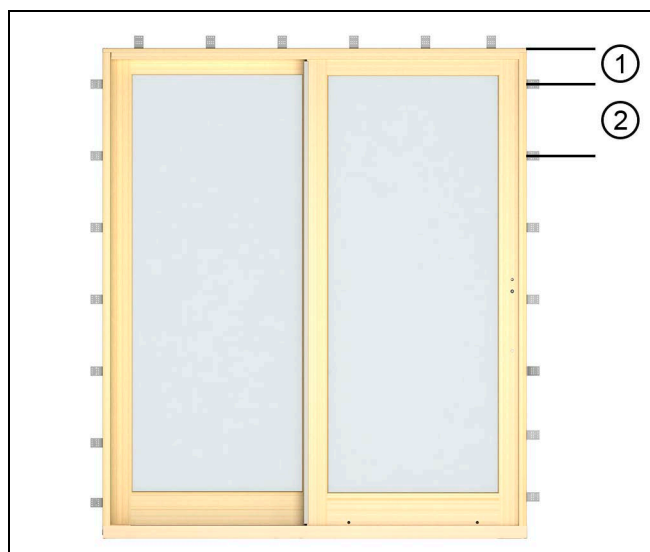

Figure 48

1	6"
2	12"

OXXO Handle Set Prep

NOTE: It is important that the handle sets be installed prior to installing the strike.

1. Using a 13/32" (10) drill bit, drill through the wood backer in the secondary panel stile by using the existing exterior holes in the Ultrex as a guide. See Figure 49.



Figure 49

1	13/32" (10) drill bit
---	-----------------------

2. Refer to the instructions included with the handle sets to finish the installation