

Ultimate Wood Swinging French Door 2 1/4"

- Standard Unit Measurements..... 1
- Minimum and Maximum Guidelines 2
- Measurement Conversions 3
- Net Clear Opening: Inswing 4
- Net Clear Opening: Outswing..... 5
- Inswing Section Details: Operating 6
- Inswing Section Details: Stationary and Sidelite 7
- Inswing Section Details: Panel Configurations..... 8
- Inswing Section Details: Ultimate Swinging Screen..... 9
- Inswing Section Details: Flat Panel Placement..... 10
- Inswing Section Details: Raised Panel Placement..... 11
- Outswing Section Details: Operating..... 12
- Outswing Section Details: Stationary and Sidelite 13
- Outswing Section Details: Panel Configurations..... 14
- Outswing Section Details: Flat Panel Placement..... 15
- Outswing Section Details: Raised Panel Placement..... 16

Standard Unit Measurements

Standard Inswing and Outswing Unit Measurements													
Width													
Unit Type	Call Number	Masonry Opening		Rough Opening		Frame Size		Panel OM		Daylight Opening		Glass Size	
		ft - in	mm	ft - in	mm	ft - in	mm	ft-in	mm	ft - in	mm	ft-in	mm
1 Panel	2-6	2-10 9/16	(878)	2-8 7/16	(824)	2-7 7/16	(799)	2-5 1/16	(738)	1-5 3/32	(434)	1-6 13/32	(468)
	2-8	3-0 9/16	(929)	2-10 7/16	(875)	2-9 7/16	(849)	2-7 1/16	(789)	1-7 3/32	(485)	1-8 13/32	(518)
	3-0	3-4 9/16	(1030)	3-2 7/16	(976)	3-1 7/16	(951)	2-11 1/16	(891)	1-11 3/32	(587)	2-0 13/32	(620)
2 Panel	5-0	5-3 3/4	(1619)	5-1 5/8	(1565)	5-0 5/8	(1540)	2-5 1/16	(738)	1-5 3/32	(434)	1-6 13/32	(468)
	5-4	5-7 3/4	(1721)	5-5 5/8	(1667)	5-4 5/8	(1641)	2-7 1/16	(789)	1-7 3/32	(485)	1-8 13/32	(518)
	6-0	6-3 3/4	(1924)	6-1 5/8	(1870)	6-0 5/8	(1845)	2-11 1/16	(891)	1-11 3/32	(587)	2-0 13/32	(620)
Height													
Unit Type	Call Number	Masonry Opening		Rough Opening		Frame Size		Panel OM		Daylight Opening		Glass Size	
		ft - in	mm	ft - in	mm	ft - in	mm	ft-in	mm	ft - in	mm	ft - in	mm
All Configurations	8-0	8-1 1/16	(2465)	8-0	(2438)	7-11 1/2	(2426)	7-8 1/2	(2350)	6-6 3/8	(1991)	6-7 11/16	(2024)
	10-0	10-1 1/16	(3075)	10-0	(3048)	9-11 1/2	(3035)	9-8 1/2	(2959)	8-6 3/8	(2600)	8-7 11/16	(2634)

Minimum and Maximum Guidelines

Door Minimum and Maximum Frame Size - Certified								
Unit Configuration	Min Width		Min Height		Max Width		Max Height	
	in	mm	in	mm	in	mm	in	mm
1 - Panel Stationary	20 5/16	(516)	25 1/8	(638)	37 7/16	(951)	119 1/2	(3035)
1 - Panel Operator	20 5/16	(516)	70 5/16	(1786)	37 7/16	(951)	119 1/2	(3035)
2 - Panel Operator	38 3/8	(975)	70 5/16	(1786)	72 5/8	(1845)	119 1/2	(3035)

Door Minimum and Maximum Frame Size - Extended Sizes				
Unit Configuration	Max Width		Max Height	
	in	mm	in	mm
1 - Panel Stationary	57 3/8	(1457)	119 1/2	(3035)
1 - Panel Operator	50 3/8	(1280)	119 1/2	(3035)
2 - Panel Operator	98 1/2	(2502)	119 1/2	(3035)

Measurement Conversions

Unit Measurements		Width			Height	
From	To					
Frame		in	mm		in	mm
OM of Frame	Rough Opening	+ 1	(25)		+ 1/2	(13)
Masonry Opening w/BMC	Rough Opening	-2 1/8	(54)		-1 1/16	(27)
Operating Panel		in	mm		in	mm
OM of Frame	OM of Panel (x1)	-2 3/8	(60)		-3	(76)
OM of Frame	OM of Panel (x2)	-2 1/2	(304)	+ 2	-3	(76)
Daylight Opening	OM of Panel	+ 11 31/32	(304)		+ 14 1/8	(359)
Glass		in	mm		in	mm
Daylight Opening	Glass	+ 1 5/16	(33)		+ 1 5/16	(33)

Net Clear Opening: Inswing

Net Clear Opening Ultimate Wood Inswing French Door 2 1/4"			
Width			
Unit Type	Call Number	Net Clear Openings	
		ft-in	mm
1 Panel Operator	2-6	2-1 15/32	(647)
	2-8	2-3 15/32	(698)
	3-0	2-7 15/32	(799)
2 Panel Operator	5-0	4-4 3/16	(1325)
	5-4	4-8 3/16	(1427)
	6-0	5-4 3/16	(1630)
Height			
Unit Type	Call Number	Net Clear Openings	
		ft - in	mm
All Configurations	8-0	7-7 23/32	(2329)
	10-0	9-7 23/32	(2939)

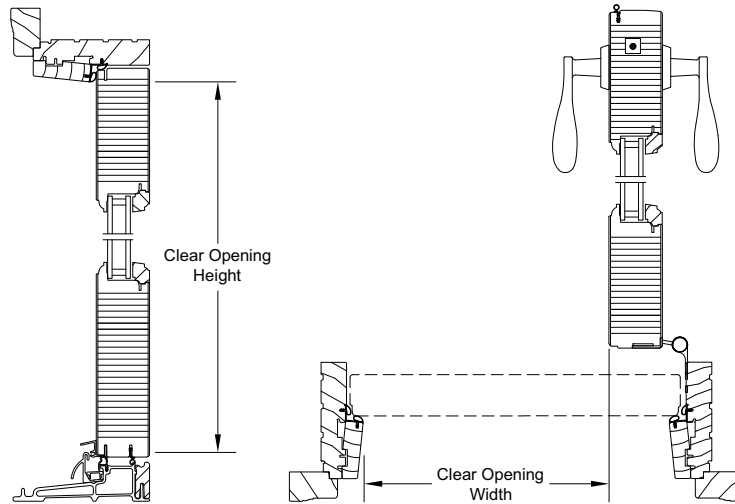

Net Clear Opening: Outswing

Net Clear Opening Ultimate Wood Outswing French Door 2 1/4"			
Width			
Unit Type	Call Number	Net Clear Openings	
		ft-in	mm
1 Panel Operator	2-6	2-1 15/32	(647)
	2-8	2-3 15/32	(698)
	3-0	2-7 15/32	(799)
2 Panel Operator	5-0	4-4 3/16	(1325)
	5-4	4-8 3/16	(1427)
	6-0	5-4 3/16	(1630)
Height			
Unit Type	Call Number	Net Clear Openings	
		ft - in	mm
All Configurations	8-0	7-8 1/8	(2340)
	10-0	9-8 1/8	(2950)

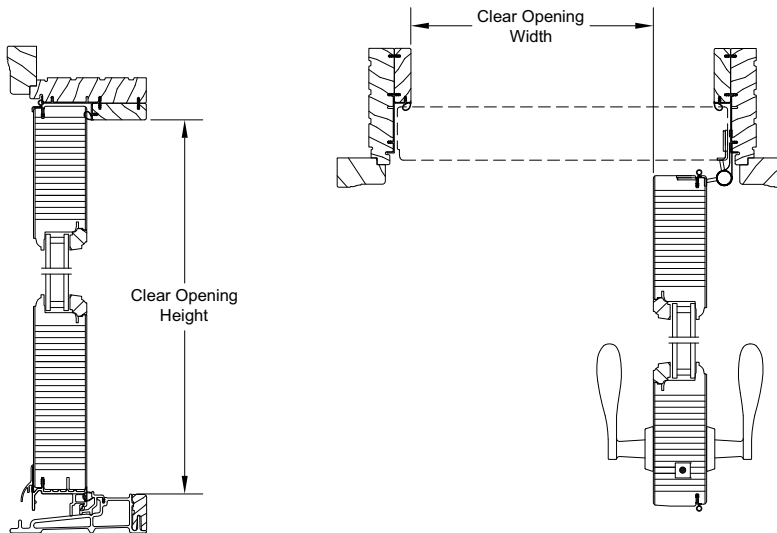

Inswing Section Details: Operating

Scale: 3" = 1' 0"

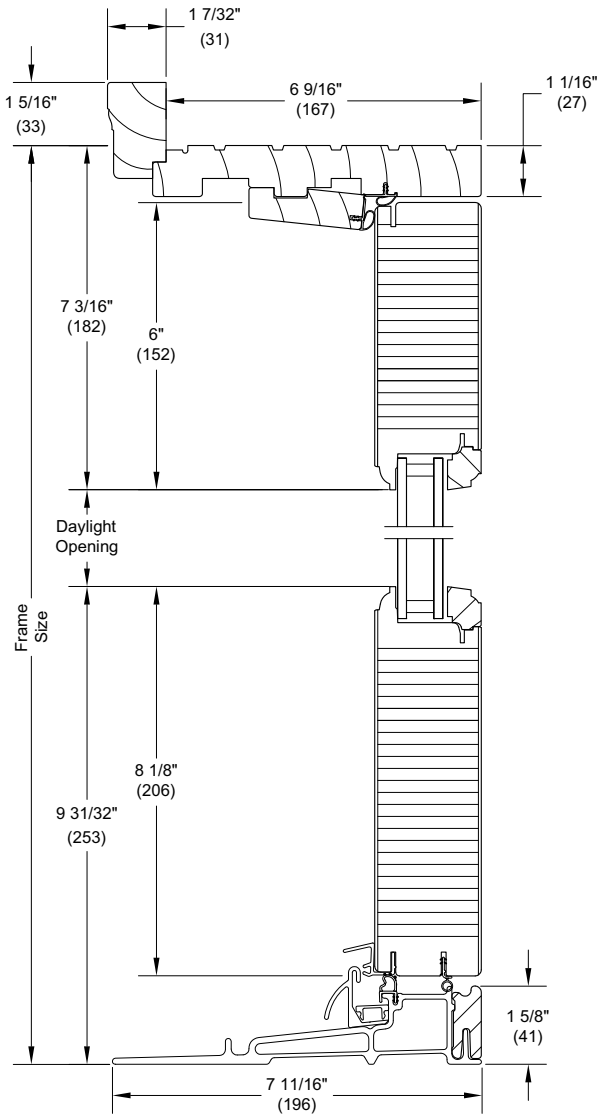

Head Jamb and Sill

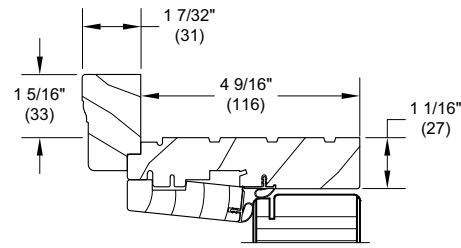

4 9/16" Head Jamb

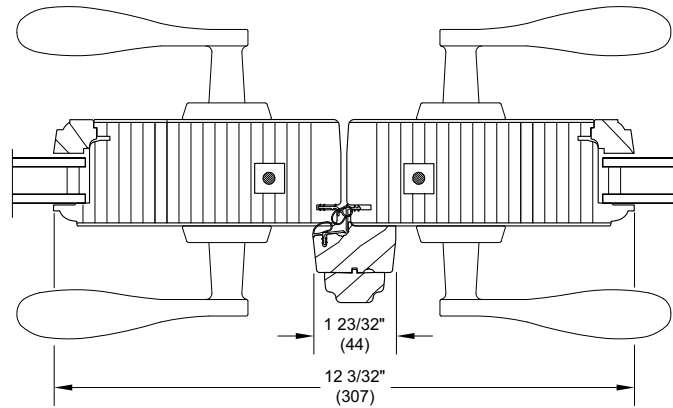

XX L Meeting Stiles

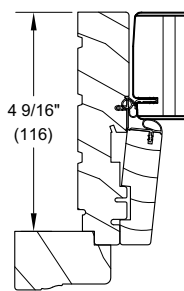

4 9/16" Jamb

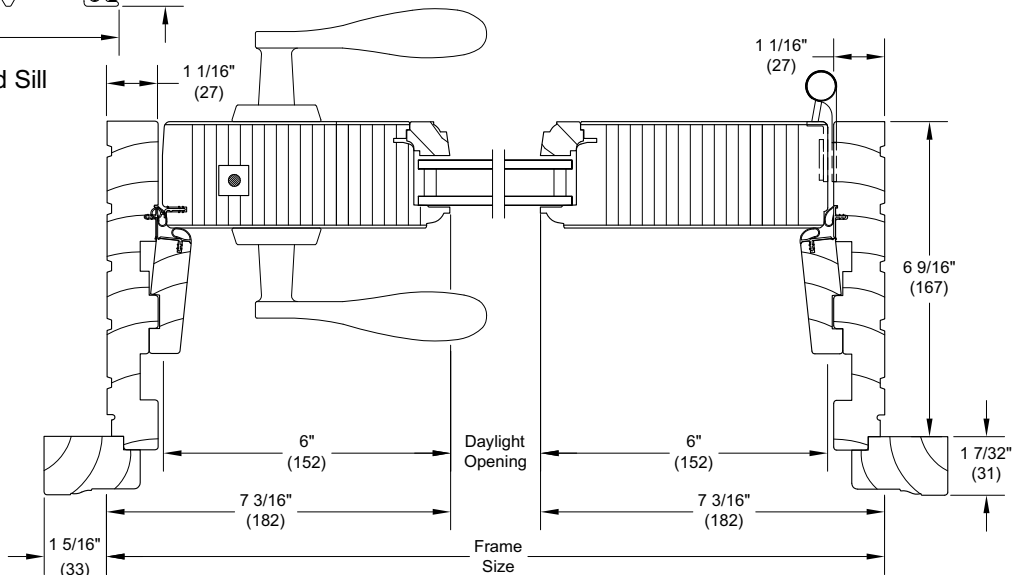

X R Jamb

Inswing Section Details: Stationary and Sidelite

Scale: 3" = 1' 0"

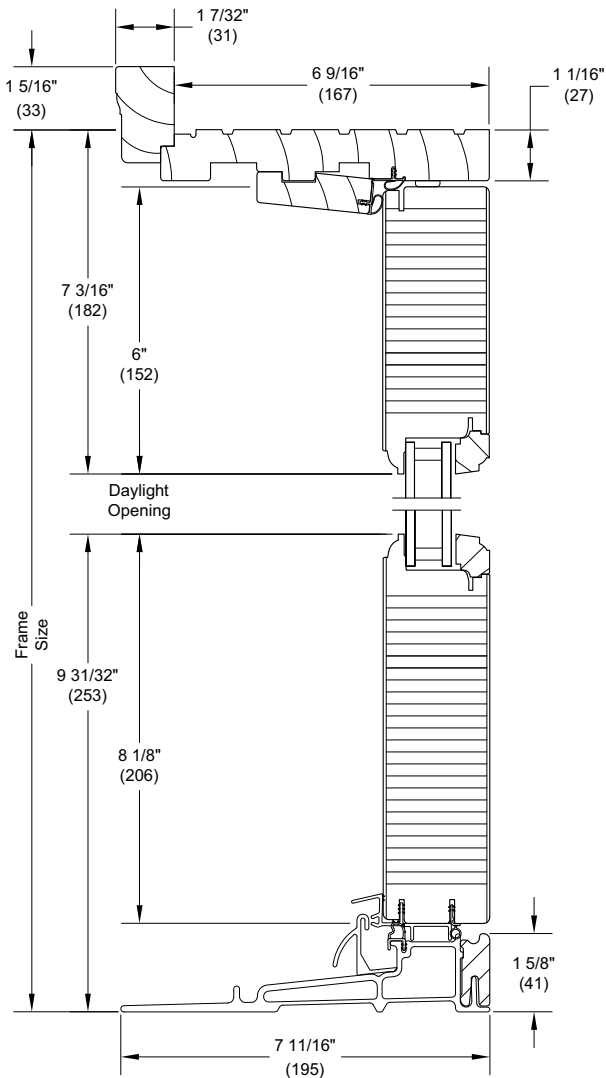

Head Jamb and Sill

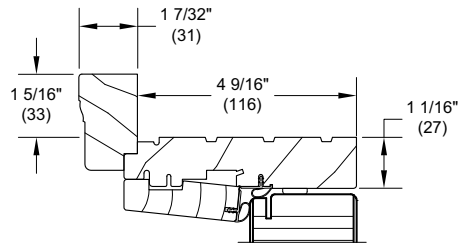

4 9/16" Head Jamb

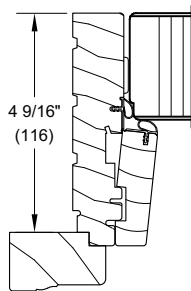

4 9/16" Jamb

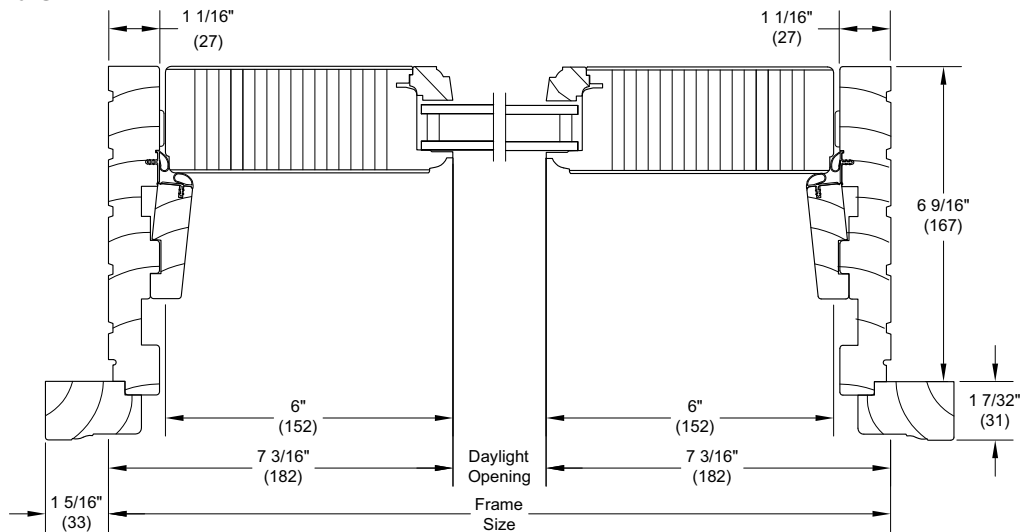

O - Jamb

Inswing Section Details: Panel Configurations

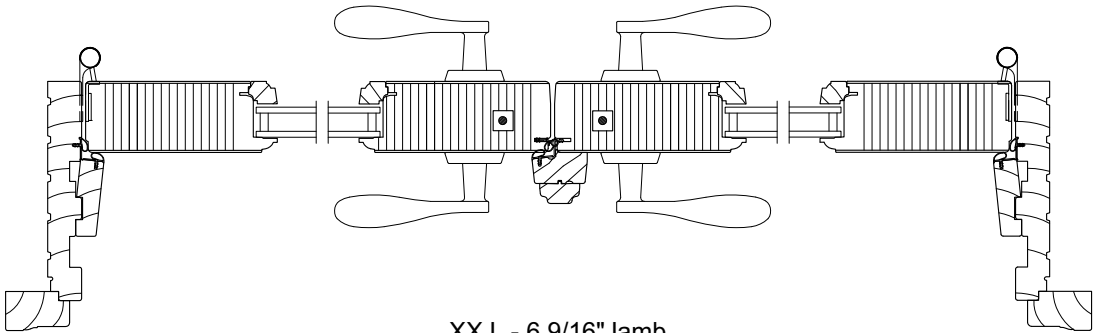
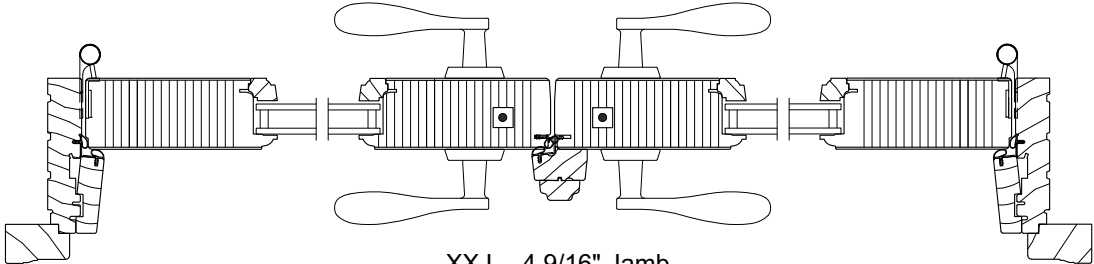

Inswing Section Details: Ultimate Swinging Screen

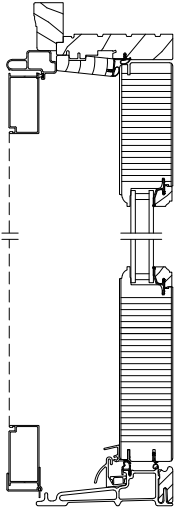

4 9/16" Head
Jamb and Sill

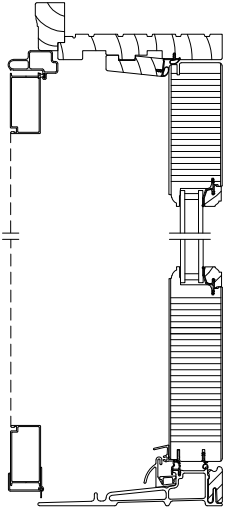

6 9/16" Head
Jamb and Sill

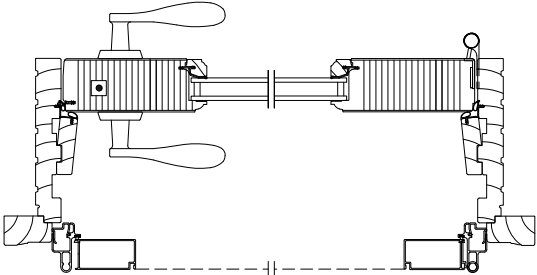

X R Jamb

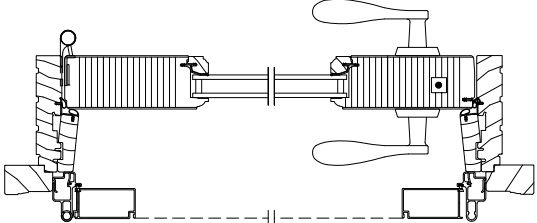

X L Jamb

Inswing Section Details: Flat Panel Placement

Scale: 3" = 1' 0"

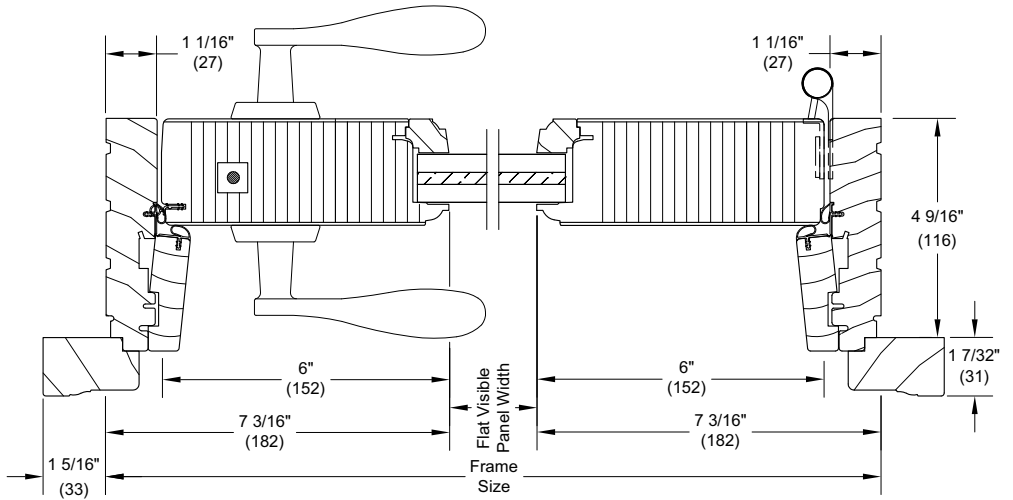
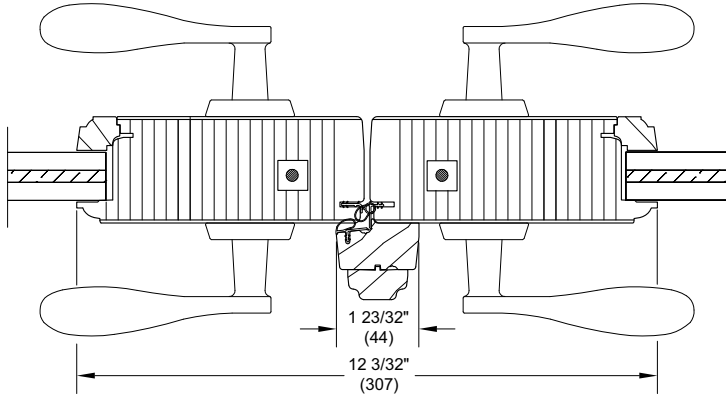
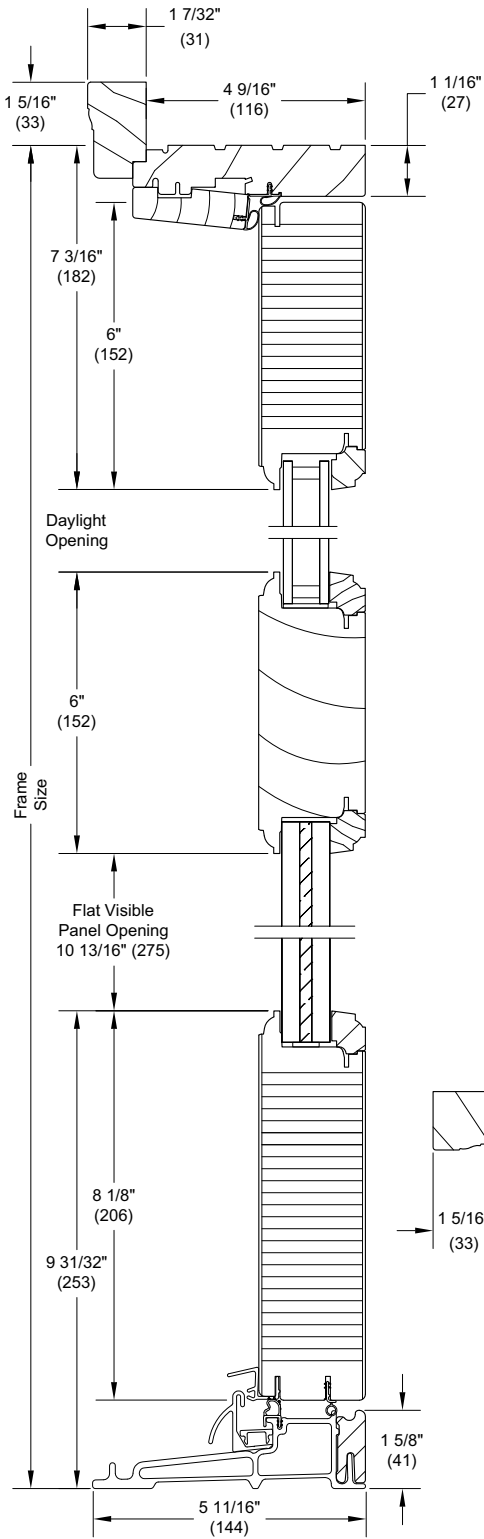

Inswing Section Details: Raised Panel Placement

Scale: 3" = 1' 0"

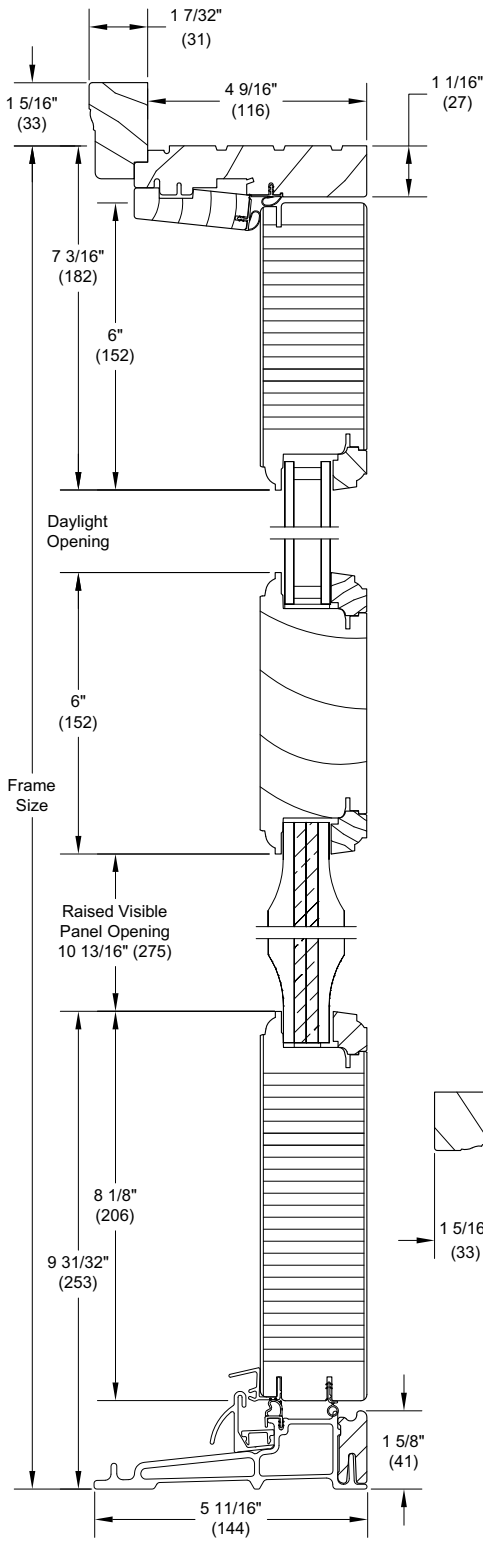

Head Jamb and Sill

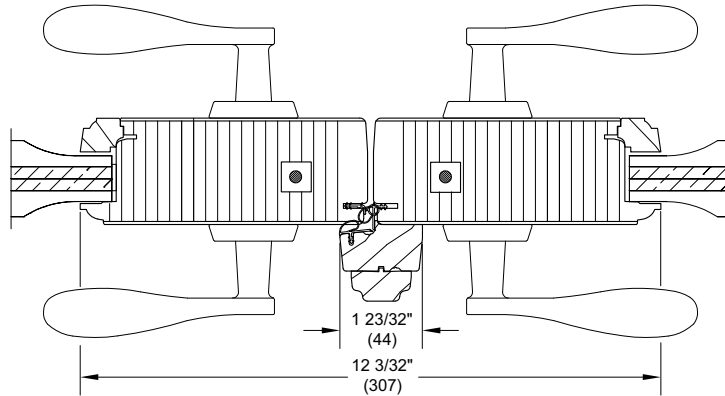

XX L Meeting Stiles

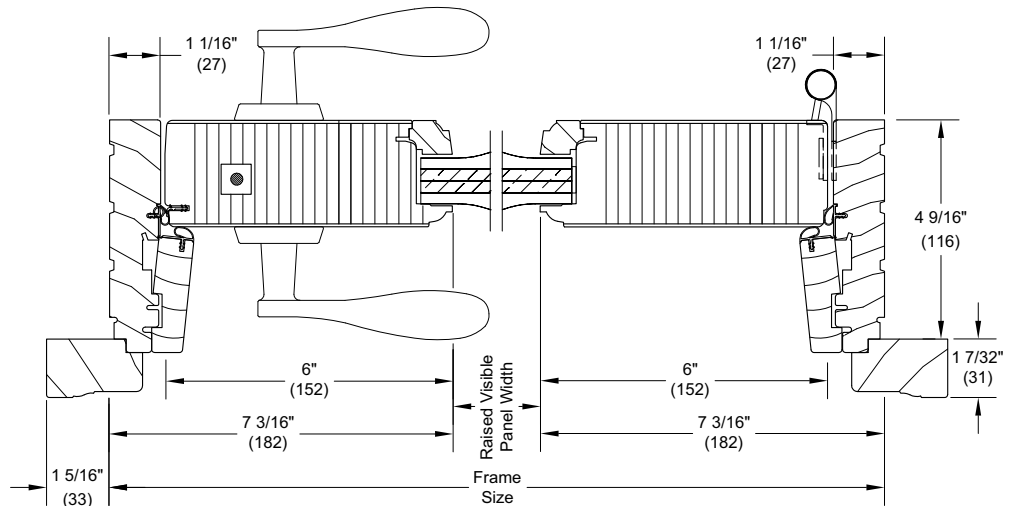

X R Jamb

Outswing Section Details: Operating

Scale: 3" = 1' 0"

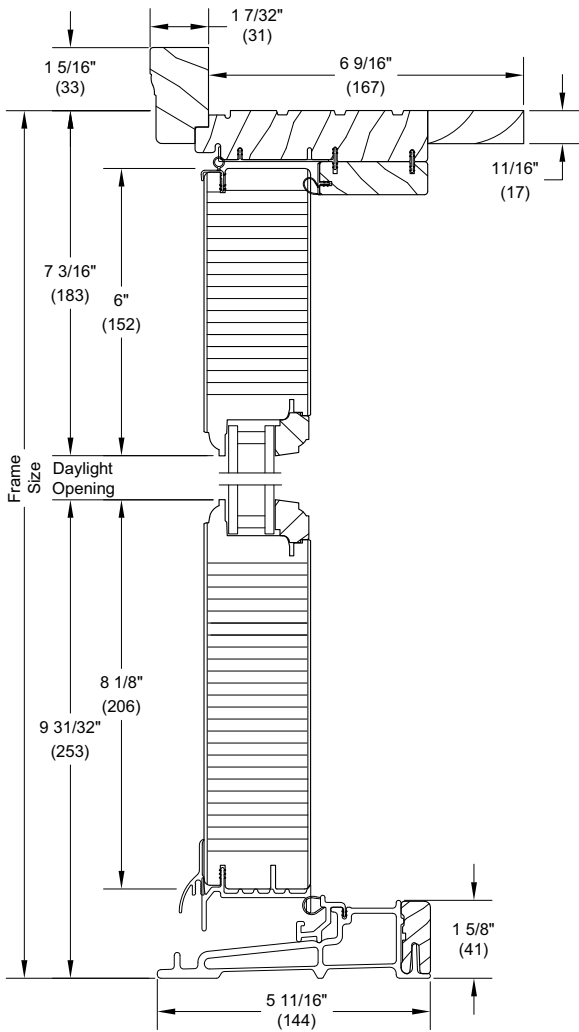

Head Jamb and Sill

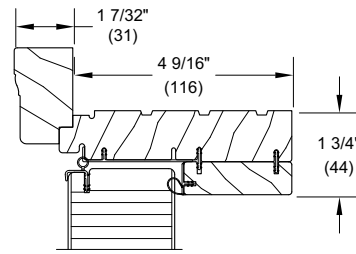

4 9/16" Head Jamb

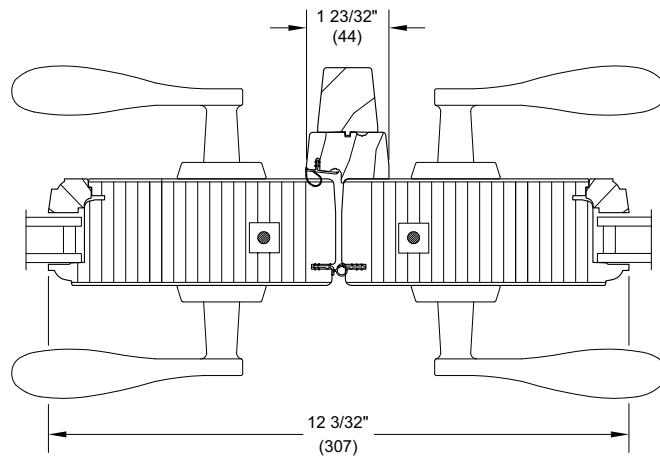

XX R - Meeting Stiles

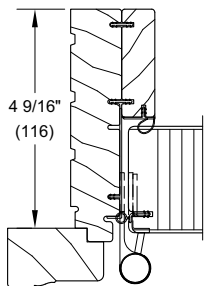

4 9/16" Jamb

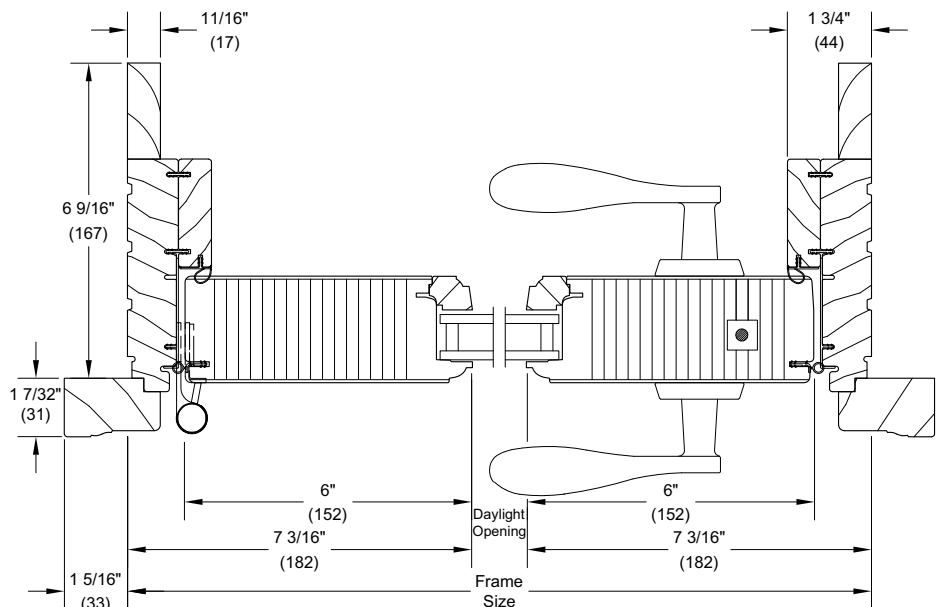

X R - Jamb

Outswing Section Details: Stationary and Sidelite

Scale: 3" = 1' 0"

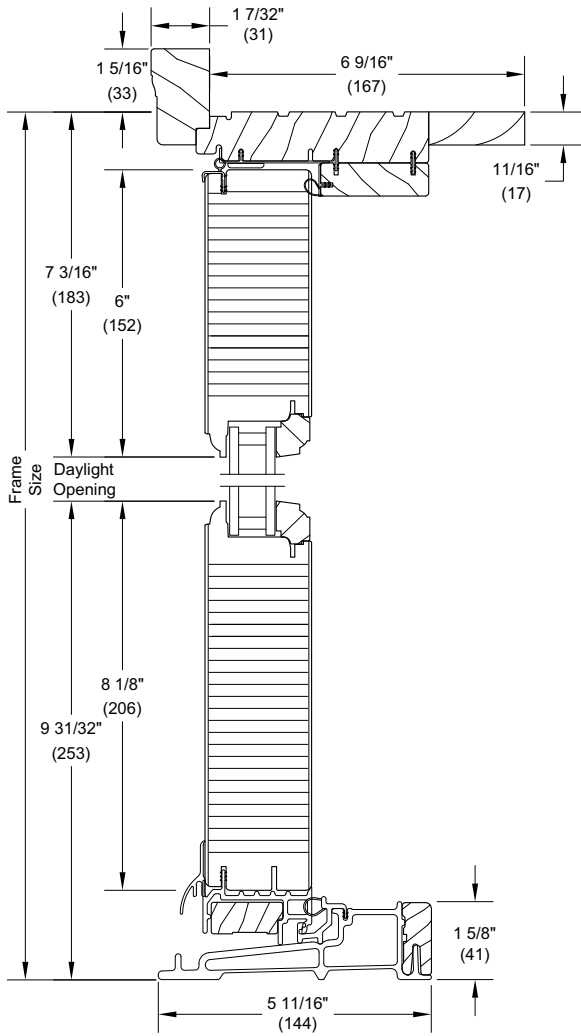

Head Jamb and Sill

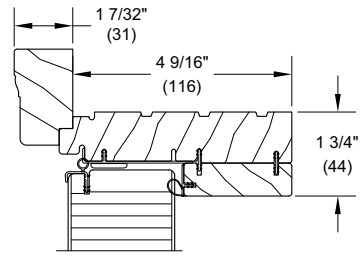

4 9/16" Head Jamb

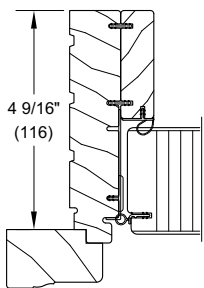

4 9/16" Jamb

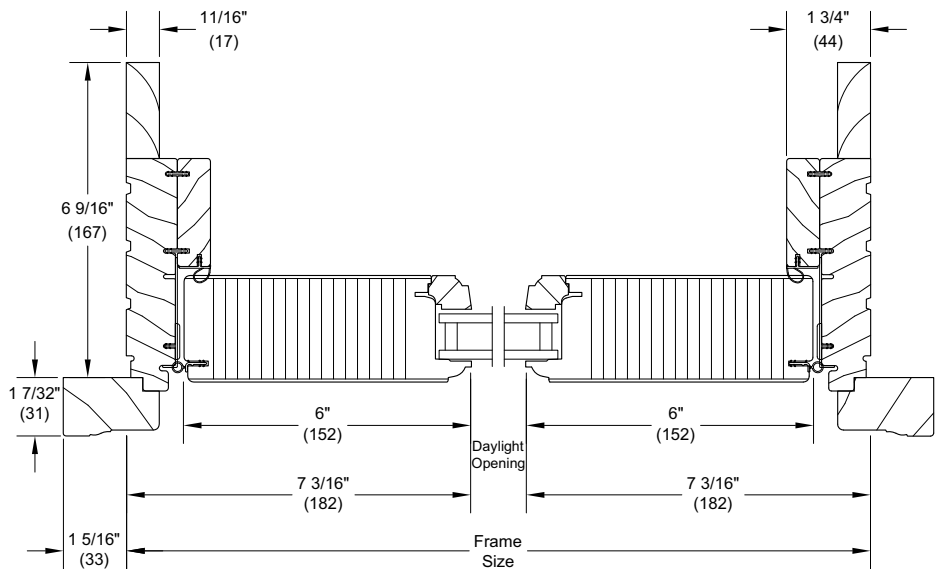

O - Jamb

Outswing Section Details: Panel Configurations

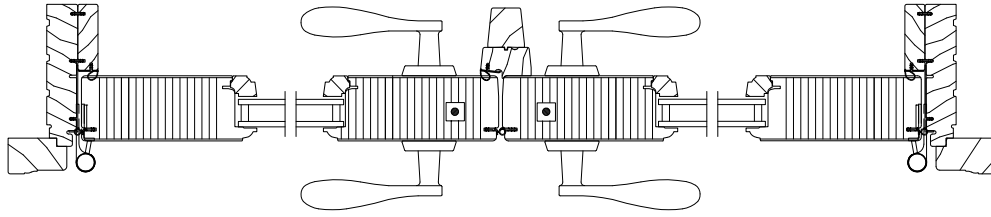

XX R - 4 9/16" Jamb

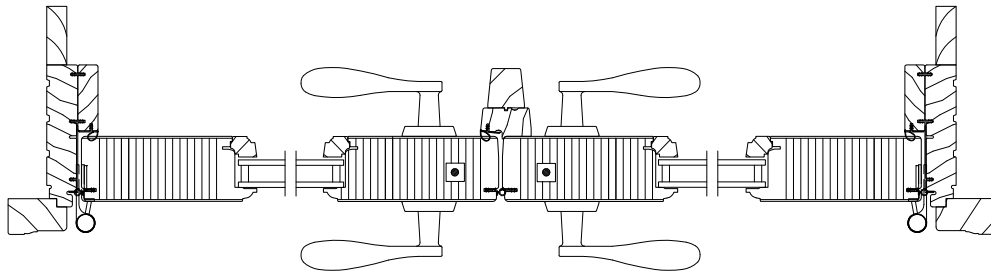

XX R - 6 9/16" Jamb

Outswing Section Details: Flat Panel Placement

Scale: 3" = 1' 0"

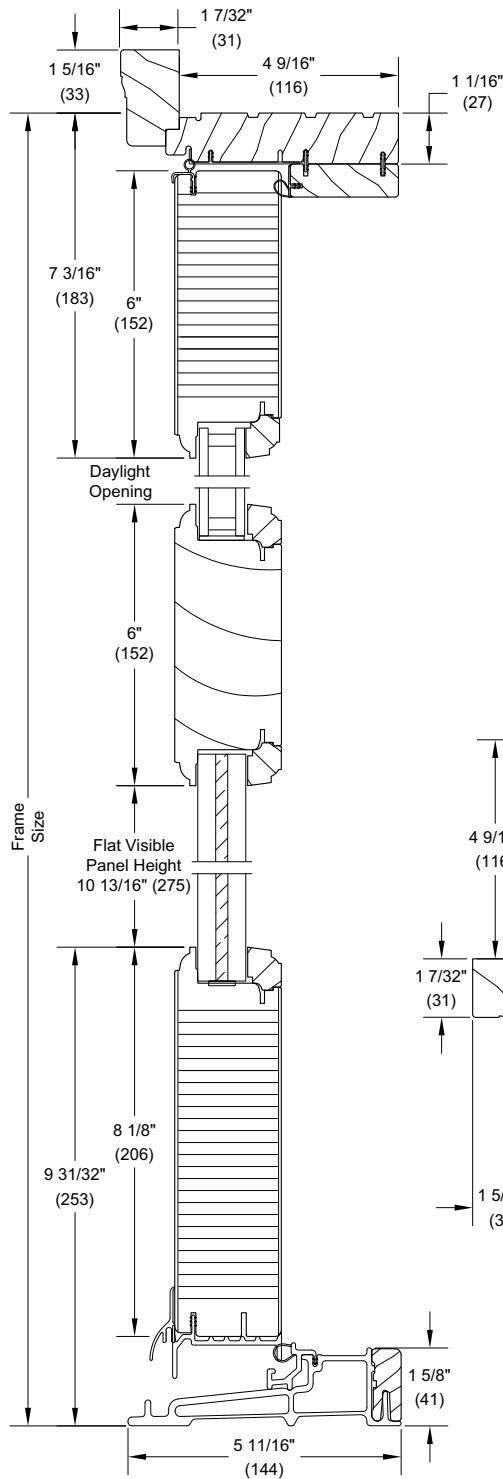

Head Jamb and Sill

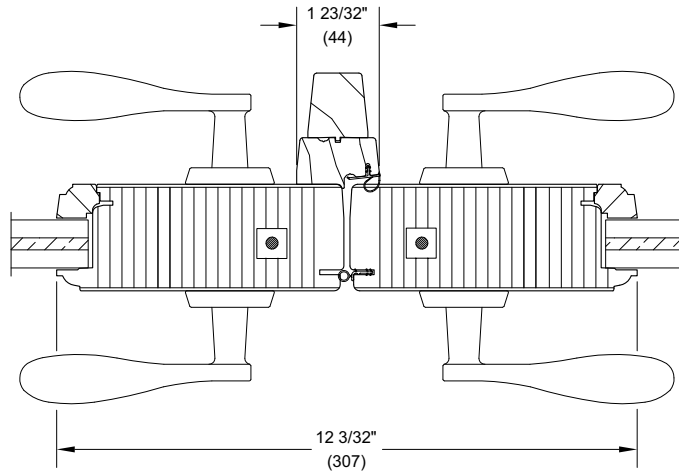

XX L - Meeting Stiles

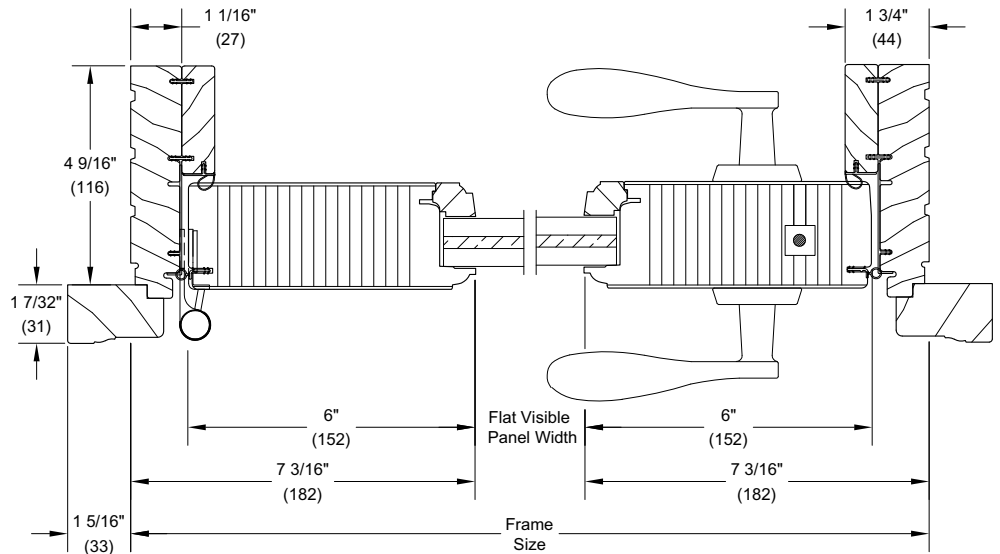

X R - Jamb

Outswing Section Details: Raised Panel Placement

Scale: 3" = 1' 0"

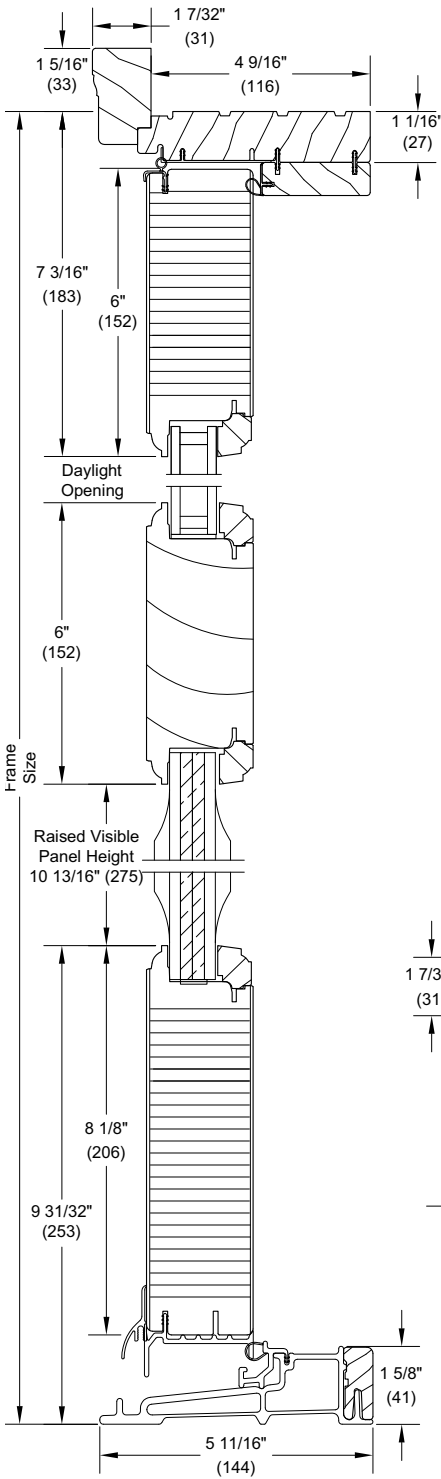

Head Jamb and Sill

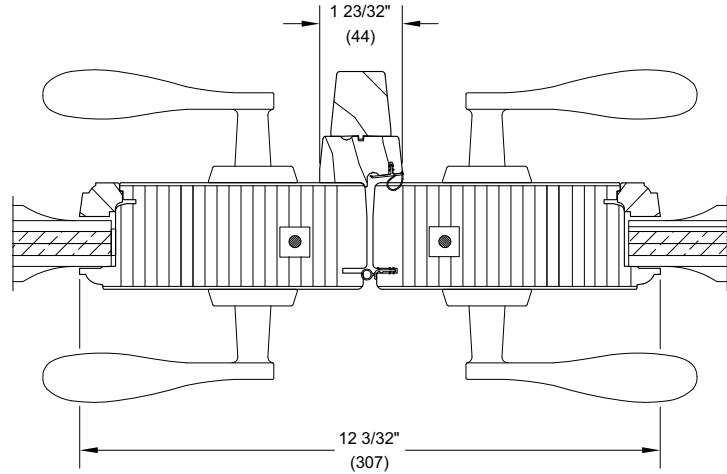

XX L - Meeting Stiles

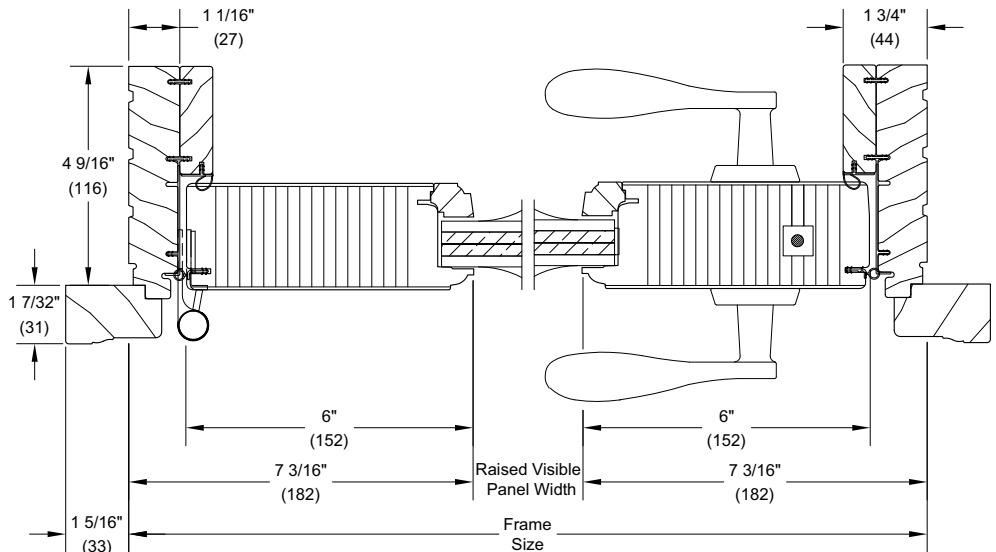

X R - Jamb